

2/25/02 Water/Wastewater-IST94.31



Compliance Inspection Form for Existing Individual Sewage Treatment Systems

Minnesota Pollution Control Agency

Completion of this form fulfills the minimal requirements of Minn. Stat. § 116.55 (2001) and Minnesota R. ch. 7080 (1999). Please refer to local ordinances for other requirements or information, especially for compliance requirements for bedroom additions.

General:

Date of Inspection: 3-19-05 Reason for inspection: Property Sale
 Property Owner(s): Sheehan Telephone (): _____
 Person requesting inspection: Same Telephone (): _____
 Site Address: 3322 Perimeter Dr. S.W. M/M Zip Code _____
 Fire No./ Parcel No. _____ County: Wash. Township _____
 Legal Description _____
 Local Regulatory Authority: Wash. County
 Date system constructed: 1980's System in Shoreland Area: yes no System in Wellhead Protection Area: yes no System serving a MDH licensed facility: yes no Local Permit # (if any) _____

Systems built prior to April 1, 1996 and not located in Shoreland or Wellhead Protection Area or Serving a Food, Beverage or Lodging Establishment	Systems located in Shoreland or Wellhead Protection Areas or Serving a Food, Beverage or Lodging Establishment, or systems built after March 31, 1996
<p>Is the system an imminent threat to public health or safety? (a yes answer is an ITPHS system)</p> <ul style="list-style-type: none"> - Discharge of sewage to the ground surface? YES <input type="checkbox"/> NO <input checked="" type="checkbox"/> - Discharge of sewage to drain tile or surface waters? YES <input type="checkbox"/> NO <input checked="" type="checkbox"/> - Sewage backup into dwelling? YES <input type="checkbox"/> NO <input checked="" type="checkbox"/> - Situation with the potential to immediately and adversely impact or threaten public health or safety? YES <input type="checkbox"/> NO <input checked="" type="checkbox"/> 	<p>Is the system an imminent threat to public health or safety? (a yes answer is an ITPHS system)</p> <ul style="list-style-type: none"> - Discharge of sewage to the ground surface? YES <input type="checkbox"/> NO <input checked="" type="checkbox"/> - Discharge of sewage to drain tile or surface waters? YES <input type="checkbox"/> NO <input checked="" type="checkbox"/> - Sewage backup into dwelling? YES <input type="checkbox"/> NO <input checked="" type="checkbox"/> - Situation with the potential to immediately and adversely impact or threaten public health or safety? YES <input type="checkbox"/> NO <input checked="" type="checkbox"/>
<p>Is the system failing? (a yes answer is a failing system)</p> <ul style="list-style-type: none"> - Less than TWO feet of vertical separation between system bottom and saturated soil or bedrock? YES <input type="checkbox"/> NO <input checked="" type="checkbox"/> - A seepage pit, cesspool, drywell, or leaching pit? YES <input type="checkbox"/> NO <input checked="" type="checkbox"/> 	<p>Is the system failing? (a yes answer is a failing system)</p> <ul style="list-style-type: none"> - Less than THREE feet of vertical separation between system bottom and saturated soil or bedrock? YES <input type="checkbox"/> NO <input checked="" type="checkbox"/> - A seepage pit, cesspool, drywell, or leaching pit? YES <input type="checkbox"/> NO <input checked="" type="checkbox"/>
<p>Is the system non-compliant?</p> <ul style="list-style-type: none"> - Is the system regulated under a monitoring plan or operating permit? (if no, go to page 2) YES <input type="checkbox"/> NO <input checked="" type="checkbox"/> <i>If yes,</i> - Has the required monitoring taken place? YES <input type="checkbox"/> NO <input checked="" type="checkbox"/> <i>(if no, the system is non-complying)</i> - Does the monitoring indicate that the system meets performance expectations? YES <input type="checkbox"/> NO <input checked="" type="checkbox"/> <i>(if no, the system is non-complying)</i> 	<p>Is the system non-compliant?</p> <ul style="list-style-type: none"> - Is the system regulated under a monitoring plan or operating permit? (if no, go to page 2) YES <input type="checkbox"/> NO <input checked="" type="checkbox"/> <i>If yes,</i> - Has the required monitoring taken place? YES <input type="checkbox"/> NO <input checked="" type="checkbox"/> <i>(if no, the system is non-complying)</i> - Does the monitoring indicate that the system meets performance expectations? YES <input type="checkbox"/> NO <input checked="" type="checkbox"/> <i>(if no, the system is non-complying)</i>

Property Owner(s) Sheehan Fire No./ Parcel No. _____

System Components (Please describe the system components and attach site sketch showing system location):
Solid poly tank pump tank
+ rock trench downfield

What methods were used to make the determinations for the compliance inspection? (Note: No standard protocol exists. The following list is not exhaustive, or in sequential order nor indicates which combinations may necessary to make a determination)

- | | | |
|------------------------------------------------------------------------------------------------------------------------------------------------------------------------------------------------------------------------------------------------------------------------------------------------------------------------------------------------------------------------------------------------------------------------------|--------------------------------------------------------------------------------------------------------------------------------------------------------------------------------------------------------------------------------------------------------------------------------------------------------------------------------------------------------------------------------------------------------------------------------------------------------------------------------------------------------------------------------------------------------------------------------------------------------------|------------------------------------------------------------------------------------------------------------------------------------------------------------------------------------------------------------------------------------------------------------------------------------------------------------------------------|
| Watertight tank(s)
<input checked="" type="checkbox"/> Probed tank bottom
<input type="checkbox"/> Observed low liquid level
<input type="checkbox"/> Examined const. records
<input checked="" type="checkbox"/> Examined empty (pumped) tank
<input type="checkbox"/> Probed outside tank for "black soil"
<input type="checkbox"/> Pressure/vacuum check
<input type="checkbox"/> Other _____ | Hydraulic Functioning
<input checked="" type="checkbox"/> Searched for surface outlet
<input type="checkbox"/> Performed hydraulic test
<input type="checkbox"/> Searched for seeping in yard
<input checked="" type="checkbox"/> Checked for back-up in home
<input type="checkbox"/> Excessive ponding in soil system/D-boxes
<input checked="" type="checkbox"/> Homeowner testimony
<input type="checkbox"/> Examined for surging in tank
<input type="checkbox"/> "Black soil" above soil system
<input checked="" type="checkbox"/> Other <u>lig. levels in drop</u> | Vertical Separation Distance
<input checked="" type="checkbox"/> Conducted soil borings
Depth to limiting layer <u>+5'</u>
Depth to system bottom <u>2'</u>
<input type="checkbox"/> Examined records
<input type="checkbox"/> LGU Limiting Layer Verification
<input type="checkbox"/> Other _____ |
|------------------------------------------------------------------------------------------------------------------------------------------------------------------------------------------------------------------------------------------------------------------------------------------------------------------------------------------------------------------------------------------------------------------------------|--------------------------------------------------------------------------------------------------------------------------------------------------------------------------------------------------------------------------------------------------------------------------------------------------------------------------------------------------------------------------------------------------------------------------------------------------------------------------------------------------------------------------------------------------------------------------------------------------------------|------------------------------------------------------------------------------------------------------------------------------------------------------------------------------------------------------------------------------------------------------------------------------------------------------------------------------|

Status of the system

Based on the compliance criteria, the system status is (check one) failing (to protect groundwater) an imminent threat to public health or safety (ITPHS), non-compliant (monitoring issue), compliant (none of the 3 previous conditions). Therefore, this document is an Certificate of Compliance Notice of Noncompliance
Is this system an EPA Class V Injection Well? Yes No

Certification
I hereby certify as a State of Minnesota Licensed Inspector and/or Designer I or Qualified Employee Inspector and/or Qualified Employee Designer I that I conducted an investigation that accurately determined the compliance status of this system and that my recorded observations are accurate as of this date. No determination of future hydraulic performance has been nor can be made due to unknown conditions during system construction, abuse of the system, inadequate maintenance, or future water usage.

Inspector's name (print) Jack E. Gill Phone (651)426-0880
License and/or Registration Number 604 Address 118 Forest Ave., Mahtomedi, MN 55115
Employed by PBI Environmental Services Address 128 Forest Ave., Mahtomedi, MN 55115
Signature Jack E. Gill Date 3-20-05

Upgrade Requirements (derived from Minnesota Statutes § 115.05)
An ITPHS must be upgraded, replaced, or its use discontinued within ten months of receipt of this notice or within a shorter period if required by local ordinance. If the system fails to provide sufficient groundwater protection, then the system must be upgraded, replaced, or its use discontinued within the time required by rule or the local ordinance. If an existing system is not failing as defined in law, and has at least two feet of design soil separation, then the system need not be upgraded, repaired, replaced, or its use discontinued, notwithstanding any local ordinance that is more strict. This does not apply to systems in shoreland areas, wetland protection areas, or those used in connection with food, beverage, and lodging establishments as defined in law.

- Suggested Attachments**
- 1) Site sketch could also include: well, well setback to system, dwelling or other buildings, tank(s), reserved soil treatment area, surface water and soil boring locations. Include as-built drawing if available.
 - 2) Soil boring logs, showing each horizon. Indicate the texture, color, metamorphic features depth to bedrock, standing water and whether the material is fill.
 - 3) A list of any and all requirements of the local ordinance that are different from the state requirements referred to on this form.
 - 4) A homeowner survey of system performance, signed by the homeowner as being factual.
 - 5) Monitoring data as appropriate.

THIS SITE DRAWING IS NOT "DRAWN TO SCALE"

Do not use this drawing to determine measurements, or to calculate areas, etc. This drawing is to provide only a rough location of the house, septic system, water well, etc. The size of the drainfield has not been determined or verified, only the approximate thickness and depth of the drainfield has been determined, for the purposes of assisting to determine MPCA drainfield separation (to seasonally saturated soil) requirements. No size, area, or location of the drainfield is implied by this drawing.

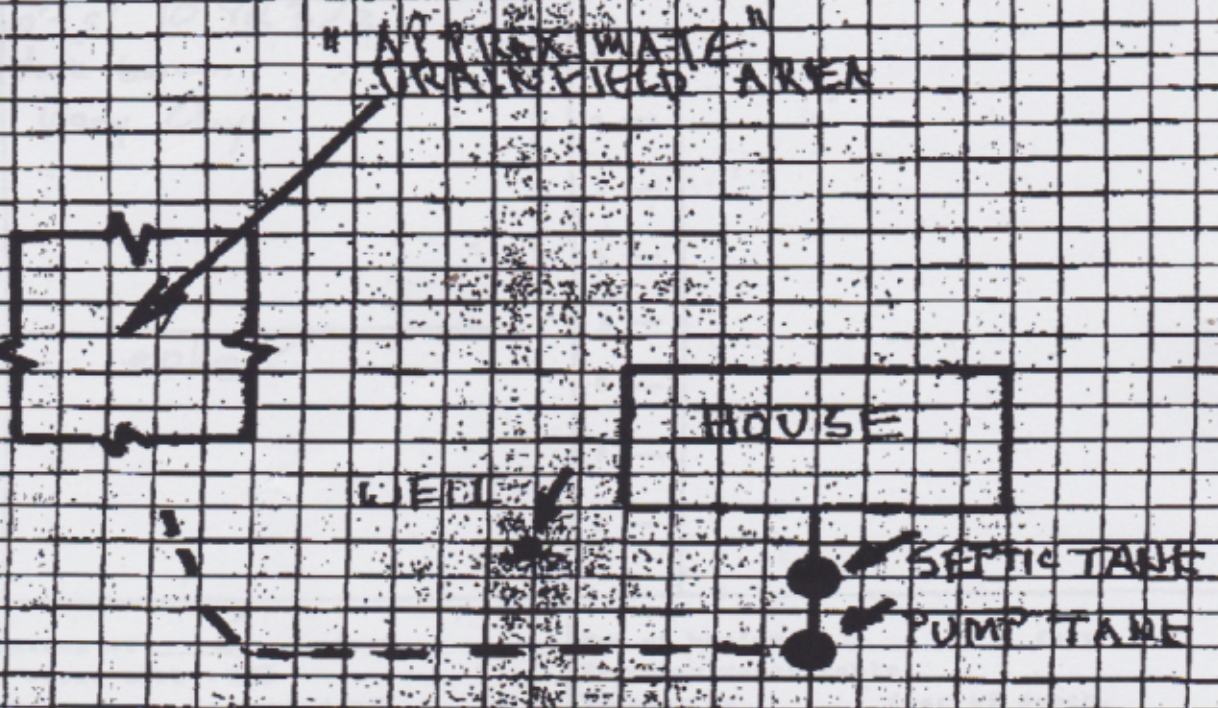

PBI

Professional Building
Inspection and
Environmental Services

"SITE DRAWING"
Property Address

3322 Pennington

DRAWN BY
CHECKED BY JEO
FILE
SCALE NO SCALE
FIGURE NO.