

MAC'S Sewer Service

34918 Falcon Ave., North Branch, MN. 55056
macsewer12@gmail.com

Date: 5-9-18 Time: A-T

651-462-1510

1580

Phone:	Cell:
Email:	
Name: Pat Rogowski	
Address: 10665 213 [#] St. N	
City/State/Zip: Scandia Mn 55073	LUG Wash

Septic Inspection	300-
Wash Cty Filing fee	40-
Standard Water test	125-
Jerry McKay @ Remax	
210-5669	TOTAL

PAID CK# _____ VISA MASTER CARD A/R _____

PAYMENT DUE UPON RECEIPT—\$20 LATE FEE DUE after 7 days.
A \$30 NSF fee will be charged for returned checks.

Septic Inspection Septic Design Perc/Soil Tests Water Tests

Ross' Sewer Service, Inc.

9288 Co. Rd. 5 NE
North Branch, MN 55056
651-674-4349
M.P.C.A. # L3448

Pat Rogowski
10665 213th St North

Scandia

1-11500

5-9-18

Septic Pumping (1 Tank)	\$ 315. ⁰⁰
Main Sewer Line Cleaning	
Kitchen Drain Cleaning	
Floor Drain Cleaning	
Sand Trap Pumping	
Steaming	
Permit Fee	\$ 22. ⁰⁰
Service Fee	
TOTAL	\$ 337. ⁰⁰

PDCC

Thank You...

Mac's Sewer Service

"You Dump It... We Pump It"

Tank Pumping

Compliance Inspections

Septic Designs

Perc/Soil Tests

May 9, 2018

Pat Rogowski
10665-213th St. N.
Scandia, MN. 55073

RE: same

Enclosed please find the following documents:

Certificate of Compliance per MPCA Ch. 7080 Compliance Code

Comments- see comment sections of report.
 Repairs

Design

Perc/Soil Testing Results

Water Test Results to follow

Invoice/Bill
 Balance Due upon receipt
 Paid in full

We appreciate your business.

Sincerely,

Michael D. McElhatton
Inspector/Designer



Minnesota Pollution Control Agency

520 Lafayette Road North
St. Paul, MN 55155-4194

Compliance Inspection Form
Existing Subsurface Sewage Treatment Systems (SSTS)

Doc Type: Compliance and Enforcement

Instructions: Inspection results based on Minnesota Pollution Control Agency (MPCA) requirements and attached forms - additional local requirements may also apply.

For local tracking purposes: 8

Submit completed form to Local Unit of Government (LUG) and system owner within 15 days

System Status

System status on date (mm/dd/yyyy): 5/9/2018

[X] Compliant - Certificate of Compliance
(Valid for 3 years from report date, unless shorter time frame outlined in Local Ordinance.)

[] Noncompliant - Notice of Noncompliance
(See Upgrade Requirements on page 3)

Reason(s) for noncompliance (check all applicable)

- [] Impact on Public Health (Compliance Component #1) - Imminent threat to public health and safety
[] Other Compliance Conditions (Compliance Component #3) - Imminent threat to public health and safety
[] Tank Integrity (Compliance Component #2) - Failing to protect groundwater
[] Other Compliance Conditions (Compliance Component #3) - Failing to protect groundwater
[] Soil Separation (Compliance Component #4) - Failing to protect groundwater
[] Operating permit/monitoring plan requirements (Compliance Component #5) - Noncompliant

Property Information

Parcel ID# or Sec/Twp/Range:

Property address: 10665-213TH ST. N., SCANDIA, MN. 55073 Reason for inspection: PROPERTY SALE

Property owner: PAT ROGOWSKI Owner's phone: 612-685-5157

or

Owner's representative: TERRY MACKAY/REMAX SYNERGY Representative phone: 651-464-7070

Local regulatory authority: WASHINGTON COUNTY Regulatory authority phone: 651-430-6655

Brief system description: GRAVITY TRENCH WITH 1200-1500 GAL. SEPTIC TANK

Comments or recommendations: SYSTEM APPEARS TO BE ORIGINAL & 26 YRS. OLD.

Any system, old or new, can be hydraulically overloaded with improper use, abuse, lack of maintenance, or sudden and heavy usage. The average life of a drainfield is 20-30 years. ***COMPLIANCE DOES NOT WARRANT FUTURE USE***

Certification

I hereby certify that all the necessary information has been gathered to determine the compliance status of this system. No determination of future system performance has been nor can be made due to unknown conditions during system construction, possible abuse of the system, inadequate maintenance, or future water usage.

Inspector name: MICHAEL D. MCELHATTON Certification number: R4089

Business name: MAC'S SEWER SERVICE License number: L1476

Inspector signature: [Signature] Phone number: 651-462-1510

Necessary or Locally Required Attachments

- [X] Soil boring logs [X] System/As-built drawing [] Forms per local ordinance
[] Other information (list):

1. Impact on Public Health – Compliance component #1 of 5

Compliance criteria:

System discharge sewage to the ground surface.	<input type="checkbox"/> Yes <input checked="" type="checkbox"/> No
System discharge sewage to drain tile or surface waters.	<input type="checkbox"/> Yes <input checked="" type="checkbox"/> No
System cause sewage backup into dwelling or establishment.	<input type="checkbox"/> Yes <input checked="" type="checkbox"/> No

Any "yes" answer above indicates the system is an Imminent Threat to Public Health and Safety.

Comments/Explanation:

Verification method(s):

- Searched for surface outlet
- Searched for seeping in yard/backup in home
- Excessive ponding in soil system/D-boxes
- Homeowner testimony (See Comments/Explanation)
- "Black soil" above soil dispersal system
- System requires "emergency" pumping
- Performed dye test
- Unable to verify (See Comments/Explanation)
- Other methods not listed (See Comments/Explanation)

2. Tank Integrity – Compliance component #2 of 5

Compliance criteria:

System consists of a seepage pit, cesspool, drywell, or leaching pit. <i>Seepage pits meeting 7080.2550 may be compliant if allowed in local ordinance.</i>	<input type="checkbox"/> Yes <input checked="" type="checkbox"/> No
Sewage tank(s) leak below their designed operating depth.	<input type="checkbox"/> Yes <input checked="" type="checkbox"/> No
If yes, which sewage tank(s) leaks:	

Any "yes" answer above indicates the system is Failing to Protect Groundwater.

Comments/Explanation:

TANK PUMPED BY ROSS' SEWER SVC. AT TIME OF INSPECTION. PRECAST TANK; APPROX. 1200-1500 gal

Verification method(s):

- Probed tank(s) bottom
- Examined construction records
- Examined Tank Integrity Form (Attach)
- Observed liquid level below operating depth
- Examined empty (pumped) tanks(s)
- Probed outside tank(s) for "black soil"
- Unable to verify (See Comments/Explanation)
- Other methods not listed (See Comments/Explanation)

3. Other Compliance Conditions – Compliance component #3 of 5

- a. Maintenance hole covers are damaged, cracked, unsecured, or appear to structurally unsound. Yes* No Unknown
- b. Other issues (electrical hazards, etc.) to immediately and adversely impact public health or safety. Yes* No Unknown
***System is an imminent threat to public health and safety**

Explain:

- c. System is non-protective of ground water for other conditions as determined by inspector Yes* No
***System is failing to protect groundwater**

Explain:

4. Soil Separation – Compliance component #4 of 5

Date of installation: 1992 Unknown
 Shoreland/Wellhead protection/Food Beverage Lodging? Yes No

Compliance criteria:

For systems built prior to April 1, 1996, and not located in Shoreland or Wellhead Protection Area or not serving a food, beverage or lodging establishment: Yes No
 Drainfield has at least a two-foot vertical separation distance from periodically saturated soil or bedrock.

Non-performance systems built April 1, 1996, or later or for non-performance systems located in Shoreland or Wellhead Protection Areas or serving a food, beverage, or lodging establishment: Yes No
 Drainfield has a three-foot vertical separation distance from periodically saturated soil or bedrock.*

“Experimental”, “Other”, or “Performance” systems built under pre-2008 Rules; Type IV or V systems built under 2008 Rules (7080.2350 or 7080.2400 (Advanced Inspector License required) Yes No
 Drainfield meets the designed vertical separation distance from periodically saturated soil or bedrock.

Any “no” answer above indicates the system is Failing to Protect Groundwater.

Verification method(s):

Soil observation does not expire. Previous soil observations by two independent parties are sufficient, unless site conditions have been altered or local requirements differ.

- Conducted soil observation(s) (Attach boring logs)
- Two previous verifications (Attach boring logs)
- Not applicable (Holding tank(s), no drainfield)
- Unable to verify (See Comments/Explanation)
- Other (See Comments/Explanation)

Comments/Explanation:

DRAINFIELD MEETS COMPLIANCE

Indicate depths of elevations

A. Bottom of distribution media	36"
B. Periodically saturated soil/bedrock	60"
C. System separation	24"
D. Required compliance separation*	24"

*May be reduced up to 15 percent if allowed by Local Ordinance.

5. Operating Permit and Nitrogen BMP* – Compliance component #5 of 5 Not applicable

Is the system operated under an Operating Permit? Yes No **If “yes”, A below is required**
 Is the system required to employ a Nitrogen BMP? Yes No **If “yes”, B below is required**

BMP=Best Management Practice(s) specified in the system design

If the answer to both questions is “no”, this section does not need to be completed.

Compliance criteria

a. Operating Permit number: _____ Yes No
 Have the Operating Permit requirements been met?
 b. Is the required nitrogen BMP in place and properly functioning? Yes No

Any “no” answer indicates Noncompliance.

Upgrade Requirements (Minn. Stat. § 115.55) An imminent threat to public health and safety (ITPHS) must be upgraded, replaced, or its use discontinued within ten months of receipt of this notice or within a shorter period if required by local ordinance. If the system is failing to protect ground water, the system must be upgraded, replaced, or its use discontinued within the time required by local ordinance. If an existing system is not failing as defined in law, and has at least two feet of design soil separation, then the system need not be upgraded, repaired, replaced, or its use discontinued, notwithstanding any local ordinance that is more strict. This provision does not apply to systems in shoreland areas, Wellhead Protection Areas, or those used in connection with food, beverage, and lodging establishments as defined in law.

SITE SKETCH + BORING LOG
ATTACHMENT TO MPCA COMPLIANCE INSPECTION FORM wq.wwwists4-31

Property: 10665-213TH St. N.

By Mac's Sewer Service 5/9/18

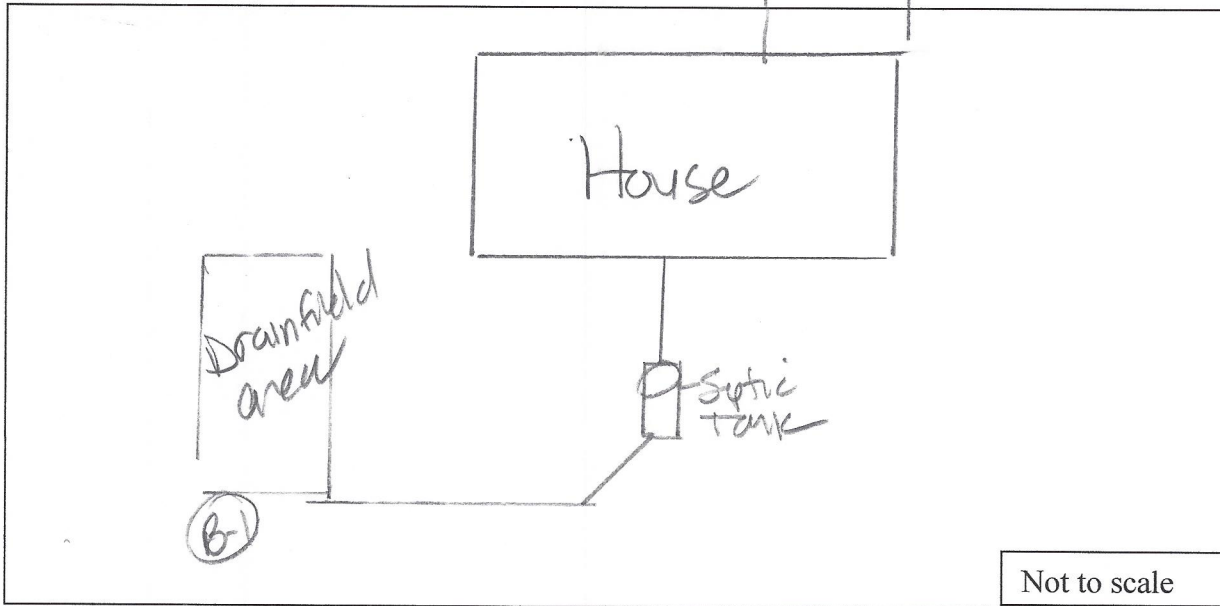

SOIL BORING #1

0-18"	10yr 3/2 dark brown sandy loam
18-30"	10yr 4/4 dark brown sandy loam
30-60"	10yr 3/6 dark brown sand & gravel

NO MOTTLING

COMMENTS: System MEETS MPCA CH. 7080 compliance code.

BANK OWNED or VACANT PROPERTY: If property is bank owned or vacant, there is no owner testimony or current use to determine if there is, or has been, a history of back up into the house or surface discharge, although none was observed at the time of this inspection. **Also, Mac's Sewer does not assume any liability for limits of the inspection due to property being vacant, winterized or no power on. Buyer & Seller accept the inspection as performed**

PURPOSE: The purpose and results of this inspection are only to determine if there is, or is not, adequate treatment of wastewater to protect against ground water pollution via tank(s) and drain field at the time of Inspection per the MPCA CH. 7080 Compliance Code. No other determination has been, or is made or implied, including system longevity, the inside plumbing & function, future performance or warranty of system due to unknown conditions during system construction, hydraulic performance, the use of the system, it's age or size, inadequate maintenance, or future water usage. **Liability is limited to the cost of this inspection.**

Requirements to bring system into compliance if deemed not in compliance NONE