



**WASHINGTON COUNTY, MINNESOTA**  
 Department of Health, Environment,  
 and Land Management 612/430-6708

HAY TOWNSHIP

PERMIT NUMBER 9297031 SEWAGE PERMIT

Owner : PETER HORD  
 3107 LAKE ONASSO BLVD W  
 ROSEVILLE MN 55113  
 Applicant : PETER HORD 612-481-8375

NEW DRAINFIELD PERMIT 150.00  
 Total Fees : 150.00  
 Total Paid : 150.00  
 Total Due : .00

92.97031

**PERMISSION IS HEREBY GRANTED**

To execute the work specified in this permit on the following described property upon express condition that said persons and their agents, employees and workmen shall conform in all respects to the provisions of the Building Code, and/or Ordinances.  
 This permit may be revoked at any time upon the violation of any of the provisions of said code and ordinances.

Project Address : 14423 136TH ST N STILLWATER MN 55082

Flow Capacity 600 Gal/Day

Soil Conditions: Depth to Restriction 72 Inches Perc Rate 2 Min/Inch

**Soil Treatment Area Type:**

In Ground Y In Fill N Bed II Drain Field Y

**Authorized Work / Special Conditions**

- Install individual sewage treatment system as per approved design in area tested and shown on site plan.
- THIS SYSTEM MUST BE INSTALLED BY A CERTIFIED/LICENSED SEWAGE TREATMENT SYSTEM INSTALLER HOLDING A CURRENT LICENSE WITH THE MINNESOTA POLLUTION CONTROL AGENCY. (A list of installers is available at your request.)
- Rope off and protect tested area from all vehicle traffic.
- Maximum trench depth 36 inches into natural soil.

\*\* Permit Expiration Date : Sewage Treatment : 7/25/98

A CERTIFICATE OF OCCUPANCY MUST BE REQUESTED AND ISSUED PRIOR TO USE OR OCCUPANCY OF WORK PERMITTED BY A BUILDING PERMIT.

\*\* This permit shall expire and be null and void if the work authorized by the Building Permit is not commenced within 60 days of the date of issuance or if work is abandoned or suspended for a period of 120 days. Term of the Building Permit is 12 months from date of issue. Term of sewage treatment permit is 6 months from date of issue.

Penalty for violation of any of the provisions of building code: Fine not to exceed five hundred dollars (\$500.00) or imprisonment for not more than ninety (90) days, or both.

Permit Issue Date 7/25/97 Code Enforcement Officer *Allen Brooks*

# INSPECTION RECORD

BUILDING	DATE	INSP.	COMMENTS
Foundation .....			
Foundation Wall .....			
Plumbing (Groundwork) .....			
Heating (Groundwork) .....			
Rough Plumbing .....			
Rough Gas Piping .....			
Rough Heating and Ventilation .....			
Framing .....			
Insulation .....			
Fireplace .....			
Chimney .....			
Wallboard or Lath and Plaster .....			
Final Electrical .....			
Final Plumbing .....			
Final Gas Piping .....			
Final Heating and Ventilation .....			
Final Building .....			

SEWAGE TREATMENT SYSTEM	DATE	INSP.	COMMENTS
Installation .....	8-25-90	JOS	Tank Size: 2-1000 Treatment Area: 2004 <del>32</del>
As Built .....			Installer: <i>Round Cross Country</i> 167 <del>26</del>

DRIVEWAY	DATE	INSP.	COMMENTS
Access .....			
Installation .....			

**NOTES:**



# STANDARD SYSTEM DESIGN INDIVIDUAL SEWAGE TREATMENT SYSTEM

WASHINGTON COUNTY HEALTH, ENVIRONMENT & LAND MANAGEMENT  
14900 N. 61ST STREET, P.O. BOX 3803, STILLWATER, MN 55082-3803  
612/430-6708 OR 612/430-6656 FAX 612/430-6730

RECEIVED

JUL 15 1997

HELM

Owner's Name	Peter Nord
Job Site Address	
City or Township	Sec. 26, May Twp.
Use of Building	single family-residential

Design Flow Rate	600 gpd	Land Slope	15-18	Percent
Required Tank Sizes	1000 Gallons	and	1000	Gallons
Type of System (standard, at grade or bed)	standard			
System Size:	500 -Square Feet	167 -Lineal Feet	36"	-Trench Width
Depth of rock below pipe	12"	Depth of Rock Above Pipe	2"	
MINimum Depth of Trench From Existing Grade	30" Inches	MAXimum Depth of Trench From Existing Grade	36" Inches	
Recommended Number of Trenches	4	Recommended Length of Trenches	42'	
Trench Spacing Measured Center to Center		8	Feet	
Any Other Special Conditions	Keep the initial system in the upper part of the test area. This will allow for future backup systems.			

IF PRESSURE DISTRIBUTION IS USED, COMPLETE THE PRESSURE DISTRIBUTION WORK SHEET ATTACHED.

This design must be accompanied by a site plan that clearly shows the location of the area tested and approved by the following:

1. Use an appropriate scale and indicate direction by use of a north arrow.
2. Show ALL property boundaries, rights-of-way, easements, wetlands. If necessary, an enlarged detail of the house site may also be required.
3. Show location of house, garage, driveway and all other improvements existing or proposed.
4. Show location and layout of sewage treatment system.
5. Show location of water supply (well and/or community supply line).
6. Dimension all setbacks and separation distances.

This system has been designed by a Pollution Control Agency (PCA) Certified Professional.

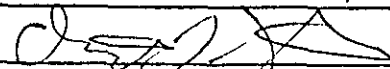
Designer Name Christopher Zierke PCA Certification # 00998  
Address 27072 Flintwood Circle, Wyoming, MN. 55092 Phone # 462-2294  
Signature  Date 5/19/96

Over for Sketch

An Equal Employment Opportunity/Affirmative Action Employer

If You Need Assistance Due to Disability or Language Barrier, Please Call 430-6656 OR 430-6708 (TDD 439-3220)



# SOIL REVIEW/SEPTIC PERMIT APPLICATION

RECEIVED  
JUL 15 1997  
HELM

Washington County Health, Environment & Land Management  
14900 61st Street N., P.O. Box 3803  
Stillwater, MN 55082-3803  
612/430-6708 or 612/430-6656 FAX 612/430-6730

FEE Pd \$150 DJ  
#27885  
FOR COUNTY USE ONLY

Make checks payable to WASHINGTON COUNTY TREASURER

92-97031  
89700-2500

- \$100 - Application Fee (site review)
- ~~\$100~~ Drainfield System Permit Fee
- \$150 - Mound System Permit Fee
- \$25 - Additional Review Fee (1 hour minimum)
- \$100 base fee, plus \$50 per lot - Subdivision Fee

Legal Description and Parcel Identification Number  
Part of Lot 6, Block 2, Tatanka, Sec. 26, May Twp. Geo: 26031-2023-0013

Applicant	Address	City	State	Zip	Phone
Owner (if different from applicant)	Address	City	State	Zip	Phone
Peter Nord	3107 W. Lake Owasso Blvd.,	Roseville, MN.		55113	481-8375

Use of Building: single family-residential Number of Bedrooms: 4 Gallons Per Day: 600

Check the following fixture(s) which are or will be installed: Garbage Disposal \_\_\_\_\_ Recreational Bathing Facility: (jacuzzi, hot tub, etc.) \_\_\_\_\_

New System X Approval Only \_\_\_\_\_ Previously Approved \_\_\_\_\_ Denied \_\_\_\_\_ Existing System Repair \_\_\_\_\_ Existing System Alteration \_\_\_\_\_ Fill Site \_\_\_\_\_  
If this site has been previously approved, please attach a copy of the approval letter

The following exhibits are required as part of this application and shall be attached hereto: Percolation Test Reports; Soil Boring Logs; Site Plan drawn to scale showing location of buildings, lot lines, percolation test holes, soil boring holes, proposed location of system and well; two (2) copies of the System Design; and one (1) copy of the Final Building Plan. The house and the drainfield areas must be staked. Inaccurate or incomplete information will result in delays in processing.

AGREEMENT: The undersigned hereby makes Application for Permit to Install or Extend Sewage Treatment System herein specified, agreeing that all such work shall be done in strict accordance with ordinances and regulations of the County of Washington, Minnesota. Applicant agrees that the Site Plan, Sketches and Design submitted herewith, and which are reviewed by the Washington County Building Official or his agent, together with any requirement and/or restriction made necessary by conditions peculiar to a particular location, shall become a part of the permit. Applicant further agrees to provide access, at reasonable times, to the Building Official or his agent for the purpose of performing inspections required and that no part of the system shall be covered until it has been inspected and accepted. APPLICATION IS FOR AN INSTALLATION AT A SPECIFIC LOCATION; ANY DEVIATION FROM THE APPROVED LOCATION WILL VOID THE PERMIT. It shall be the responsibility of the applicant for the permit to notify the Office of the Building Official that the installation is ready for inspection.

[Signature] 7-3-96  
Signature of Applicant (Owner or Builder) Date

### FOR OFFICE USE ONLY

REVIEWS: PLANNER \_\_\_\_\_ INSPECTOR \_\_\_\_\_ DATE \_\_\_\_\_

SITE EVALUATION:  
Soil Boring Evaluation: Depth of Water Table, Seasonal Water Table (Mottled Soil), Impervious Layer or Bedrock: \_\_\_\_\_

Soils Map Data: _____	Percolation Test Evaluation: _____	
Setbacks:	Required [circle appropriate item(s)]	Actual
Well (including adjacent property)	50' 75' 100' 150'	1
Wetland, Pond, Lake, Stream, River, or Bluffline	20' 40' 75' 100' 150'	1

CONCLUSIONS: Site Suitable: \_\_\_\_\_ Site Unsuitable: \_\_\_\_\_ Additional Tests Required: \_\_\_\_\_ Verify Use: \_\_\_\_\_

NOTES: Lot Size 4.00 acres Year Built \_\_\_\_\_  
14423 136 TH STN

Soils approved on 92-97001 1/10/97 by ARG



**WASHINGTON COUNTY**  
**DEPARTMENT OF HEALTH, ENVIRONMENT**  
**AND LAND MANAGEMENT**

Mary L. McGlothlin  
Director

Rose Green  
Office Manager

**GOVERNMENT CENTER**

14900 61ST STREET NORTH, P.O. BOX 3803 • STILLWATER, MN 55082-3803  
Office (612) 430-6655 • TDD (612) 439-3220 • Facsimile Machine (612) 430-6730

January 29, 1997

MT-26-97  
89700-2500  
92-97001

Peter Nord  
3107 W Lake Owasso Blvd  
Roseville MN 55113

Dear Mr. Nord:

Results of the soil test submitted for the site described as **Part of Lot 6, Block 2, Tatanka** in Section 26 of May Township have been reviewed.

The soil tester's demonstration of site suitability for installation of an individual sewage treatment system is in concurrence with present codes. The area found to be suitable is approximately a 100 foot by 100 foot area located 180 feet east of the west lot line and 95 feet south of the north property line. The design submitted is suitable for a 4 bedroom house. This assessment of suitability applies to soil in the tested area only and does not guarantee that the lot complies with applicable zoning requirements.

A sewage treatment system permit may be issued when we receive permit application, final site plan, and a copy of the final building plan.

Sincerely,

A handwritten signature in cursive script that reads "Allan Goodman".

Allan R. Goodman  
Washington County Building Official

ARG/sfw

CC: Tod Drescher





RECEIVED  
 JAN 02 1997  
 HELM

# SOIL REVIEW/SEPTIC PERMIT APPLICATION

Washington County Health, Environment & Land Management

14900 61st Street N., P.O. Box 3803

Stillwater, MN 55082-3803

612/430-6708 or 612/430-6656 FAX 612/430-6730

14423-136th St N

FEE \$150.00  
 Receipt # 20187  
 FOR COUNTY USE ONLY

Make checks payable to WASHINGTON COUNTY TREASURER

- \$100 - Application Fee (site review)
- \$100 - Drainfield System Permit Fee
- \$150 - Mound System Permit Fee
- \$25 - Additional Review Fee (1 hour minimum)
- \$100 base fee, plus \$50 per lot - Subdivision Fee

92-97001

Legal Description and Parcel Identification Number Geo:26-031-20-23-0013  
 Part of Lot 6, Block 2, Tatanka, Sec. 26, May Twp. 89700-2500

Applicant	Address	City	State	Zip	Phone
Owner (if different from applicant)	Address	City	State	Zip	Phone
Peter Nord	3107 W. Lake Owasso Blvd.,	Roseville, MN.		55113	481-8375

Use of Building: single family-residential Number of Bedrooms: 4 Gallons Per Day: 600

Check the following fixture(s) which are or will be installed: Garbage Disposal \_\_\_\_\_ Recreational Bathing Facility: (jacuzzi, hot tub, etc.) \_\_\_\_\_

New System  Approval Only \_\_\_\_\_ Previously Approved \_\_\_\_\_ Denied \_\_\_\_\_ Existing System Repair \_\_\_\_\_ Existing System Alteration \_\_\_\_\_ Fill Site \_\_\_\_\_

If this site has been previously approved, please attach a copy of the approval letter

The following exhibits are required as part of this application and shall be attached hereto: Percolation Test Reports; Soil Boring Logs; Site Plan drawn to scale showing location of buildings, lot lines, percolation test holes, soil boring holes, proposed location of system and well; two (2) copies of the System Design; and one (1) copy of the Final Building Plan. The house and the drainfield areas must be staked. Inaccurate or incomplete information will result in delays in processing.

AGREEMENT: The undersigned hereby makes Application for Permit to Install or Extend Sewage Treatment System herein specified, agreeing that all such work shall be done in strict accordance with ordinances and regulations of the County of Washington, Minnesota. Applicant agrees that the Site Plan, Sketches and Design submitted herewith, and which are reviewed by the Washington County Building Official or his agent, together with any requirement and/or restriction made necessary by conditions peculiar to a particular location, shall become a part of the permit. Applicant further agrees to provide access, at reasonable times, to the Building Official or his agent for the purpose of performing inspections required and that no part of the system shall be covered until it has been inspected and accepted. APPLICATION IS FOR AN INSTALLATION AT A SPECIFIC LOCATION; ANY DEVIATION FROM THE APPROVED LOCATION WILL VOID THE PERMIT. It shall be the responsibility of the applicant for the permit to notify the Office of the Building Official that the installation is ready for inspection.

[Signature] 2 JAN 97  
 Signature of Applicant (Owner or Builder) Date

## FOR OFFICE USE ONLY

REVIEWS: PLANNER \_\_\_\_\_ INSPECTOR [Signature] DATE 1-28-97

SITE EVALUATION:  
 Soil Boring Evaluation: Depth of Water Table, Seasonal Water Table (Mottled Soil), Impervious Layer or Bedrock:

Soils Map Data: _____	Percolation Test Evaluation: <u>2 MPI</u>	
Setbacks:	Required [circle appropriate item(s)]	Actual
Well (including adjacent property)	50' 75' 100' 150'	1
Wetland, Pond, Lake, Stream, River, or Bluffline <u>36" depth</u>	20' 40' 75' 100' 150'	1

CONCLUSIONS: Site Suitable:  Site Unsuitable: \_\_\_\_\_ Additional Tests Required: \_\_\_\_\_ Verify Use: \_\_\_\_\_

NOTES: Lot Size 4.00 acres Year Built \_\_\_\_\_

open area gradual slope about 12% all sand to be expected  
OK  
NEW CONST.

RECEIVED  
 JAN 02 1997  
 HELM

# Percolation Test data Sheet

Name Peter Nord Address 3107 W. Lake Owasso Blvd., Roseville, MN.

Location Part of Lot 6, Block 2, Tatanka, Sec. 26, May Twp., Wash. Co. Date 5/16/96

Method of scratching sidewall: 1x2 with nails. Depth of pea-sized gravel in bottom of hole: 2"

Date and hour of initial water filling 5/16/96 2:20pm., filled with 12" of water above hole bottom.

Method used to maintain at least 12" of water sand test

8" maximum water depth above hole bottom during test. Readings by Chris Zierke, on date 5/16/96

## Percolation Test #1

Depth to bottom of hole 30 inches  
 Diameter of hole 6 inches

Soil data from test hole:

Depth, inches	Soil Texture
0-12"	Sandy loam
12-30"	Sand

Time, minutes	Time Interval	Measurement, inches	Drop, inches	Perc Rate, (min./inch)
2:42		7 5/8"		
2:48	6	2 3/8"	5 1/4	1.14
2:49		7 5/8"		
2:55	6	2"	5 5/8	1.07
2:56		8"		
3:02	6	2 1/2"	5 1/2	1.09

Percolation Rate = 1.1 minutes per inch.

## Percolation Test #2

Depth to bottom of hole 48 inches  
 Diameter of hole 6 inches

Soil data from test hole:

Depth, inches	Soil Texture
0-12"	Loam
12-36"	Silt loam
36-48"	Sand

Time, minutes	Time Interval	Measurement, inches	Drop, inches	Perc Rate, (min./inch)
2:44		7 7/8"		
2:50	6	1 7/8"	6	1.0
2:51		8"		
2:57	6	2"	6	1.0
2:58		8"		
3:04	6	2"	6	1.0

Percolation Rate = 1.0 minutes per inch.

# Logs of Soil Borings

Location of Project Peter Nord prop., Part of Lot 6, Block 2, Tatanka, Sec. 26, May Twp.

Borings made by Chris Zierke

Date 5/16/96

Hand bucket auger used for borings; USDA - SCS Soil Classification used.

Depth, in feet	Boring Number 1	Depth, in feet	Boring Number 2
0 4"	<del>Dark-brown sandy loam(10YR 3/3)</del> Brown sandy loam(10YR-5/3)	0 6"	Dark-brown sandy loam
1 —	Dark yellowish-brown gravelly sand (10YR-4/6), numerous pebbles	1 14"	Brown sandy loam
2 —	Yellowish-brown medium to coarse- gr. sand(10YR-5/6)	2 —	Yellowish-brown silt loam(10YR-5/6)
3 42"		3 —	Yellowish-brown medium sand
4 —	Light yellowish-brown medium sand, (10YR-6/4), occasional pebbles	4 —	Brown medium to coarse-gr. sand (10YR-5/3)
5 —		5 —	Brown coarse gravelly sand, numerous pebbles
6 —		6 —	
7 —		7 —	
8 —		8 —	
End of boring at <u>7</u> feet. Standing water table: Present at _____ feet of depth, _____ hours after boring. Standing water not present in hole <input checked="" type="checkbox"/> . Mottled Soil: Observed at _____ feet of depth. Mottled soil not present in bore hole <input checked="" type="checkbox"/> . Comments:		End of boring at <u>7</u> feet. Standing water table: Present at _____ feet of depth, _____ hours after boring. Standing water not present in hole <input checked="" type="checkbox"/> . Mottled Soil: Observed at _____ feet of depth. Mottled soil not present in bore hole <input checked="" type="checkbox"/> . Comments:	
Depth, in feet	Boring Number 3	Depth, in feet	Boring Number 4
0 4"	<del>Dark-brown loam(10YR 3/3)</del> Brown loam(10YR-5/3)	0 4"	Dark-brown sandy loam
1 14"		1 18"	Brown sandy loam
2 —	Yellowish-brown silt loam	2 30"	Yellowish-brown medium sand
3 42"		3 —	
4 —	Dark yellowish-brown medium sand, occasional pebbles	4 —	Brown medium sand, occasional pebbles
5 —		5 —	
6 —		6 —	
7 —		7 —	
8 —		8 —	
End of boring at <u>7</u> feet. Standing water table: Present at _____ feet of depth, _____ hours after boring. Standing water not present in hole <input checked="" type="checkbox"/> . Mottled Soil: Observed at _____ feet of depth. Mottled soil not present in bore hole <input checked="" type="checkbox"/> . Comments:		End of boring at <u>7</u> feet. Standing water table: Present at _____ feet of depth, _____ hours after boring. Standing water not present in hole <input checked="" type="checkbox"/> . Mottled Soil: Observed at _____ feet of depth. Mottled soil not present in bore hole <input checked="" type="checkbox"/> . Comments:	



# Site Plan

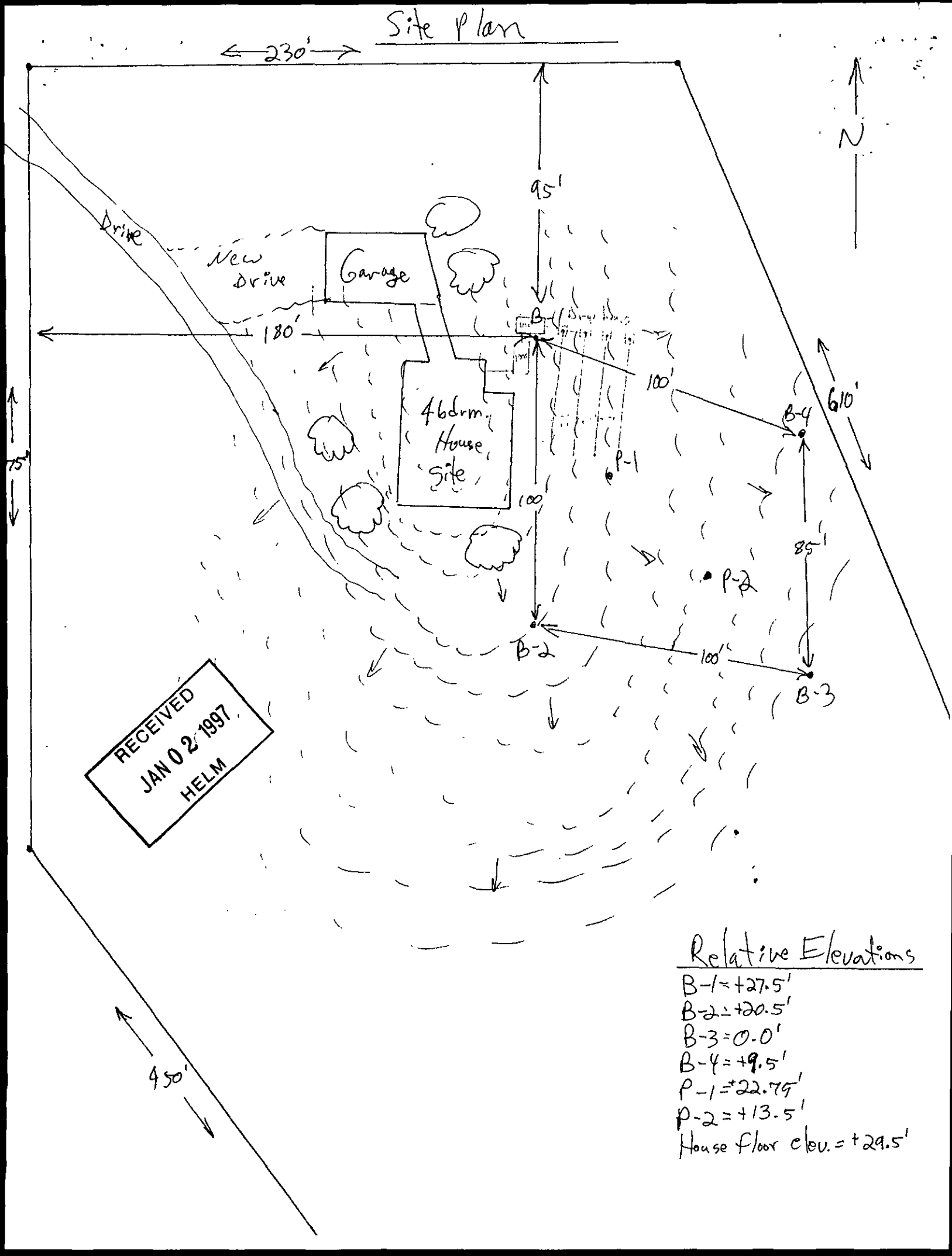

RECEIVED  
 JAN 02 1997  
 HELM

## Relative Elevations

- B-1 = +27.5'
- B-2 = +20.5'
- B-3 = 0.0'
- B-4 = +9.5'
- P-1 = +22.75'
- P-2 = +13.5'
- House floor elev. = +29.5'



# STANDARD SYSTEM DESIGN INDIVIDUAL SEWAGE TREATMENT SYSTEM

WASHINGTON COUNTY HEALTH, ENVIRONMENT & LAND MANAGEMENT  
14900 N. 61ST STREET, P.O. BOX 3803, STILLWATER, MN 55082-3803  
612/430-6708 OR 612/430-6656 FAX 612/430-6730

RECEIVED  
JAN 02 1997  
HELM

Owner's Name	Peter Nord
Job Site Address	
City or Township	Sec. 26, May Twp.
Use of Building	single family-residential

Design Flow Rate	600 gpd	Land Slope	15-18	Percent
Required Tank Sizes	1000 Gallons	and	1000	Gallons
Type of System (standard, at grade or bed)	standard			
System Size:	500 -Square Feet	167	-Lineal Feet	36" -Trench Width
Depth of rock below pipe	12"	Depth of Rock Above Pipe	2"	
MINimum Depth of Trench From Existing Grade	30" Inches	MAXimum Depth of Trench From Existing Grade	36" Inches	
Recommended Number of Trenches	4	Recommended Length of Trenches	42'	
Trench Spacing Measured Center to Center	8			Feet
Any Other Special Conditions	Keep the initial system in the upper part of the test area. This will allow for future backup systems.			

IF PRESSURE DISTRIBUTION IS USED, COMPLETE THE PRESSURE DISTRIBUTION WORK SHEET ATTACHED.

This design must be accompanied by a site plan that clearly shows the location of the area tested and approved by the following:

1. Use an appropriate scale and indicate direction by use of a north arrow.
2. Show **ALL** property boundaries, rights-of-way, easements, wetlands. If necessary, an enlarged detail of the house site may also be required.
3. Show location of house, garage, driveway and all other improvements existing or proposed.
4. Show location and layout of sewage treatment system.
5. Show location of water supply (well and/or community supply line).
6. Dimension all setbacks and separation distances.

This system has been designed by a Pollution Control Agency (PCA) Certified Professional.

Designer Name Christopher Zierke PCA Certification # 00998

Address 27072 Flintwood Circle, Wyoming, MN. 55092 Phone # 462-2294

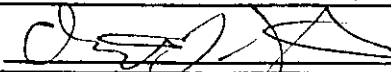
Signature  Date 5/19/96

Over for Sketch  
An Equal Employment Opportunity/Affirmative Action Employer  
If You Need Assistance Due to Disability or Language Barrier, Please Call 430-6656 OR 430-6708 (TDD 439-3220)



# AS-BUILT REPORT INDIVIDUAL SEWAGE TREATMENT SYSTEM



Washington County Health, Environment & Land Management  
14900 61ST ST N, PO BOX 3803, STILLWATER, MN 55082-3803  
612/430-6708 or 612/430-6656 FAX 612/430-6730

RECEIVED  
SEP 05 1997  
HELM

Legal Description or Complete Street Address		City or Township	
14423 136th St N. Part of Lot 6 Block 2 TATANKA Sec 26 May Twp.			
Owner Name	Mail Address	City	State Zip
Peter Nord	3107 W. Lake	Owasso	Blud, Roseville MN 55113
Installer	Mail Address	City	State Zip
Cross Country Excav. Greg Rivard	104 Clark Rd, PO Box 295 35985 Wild Mt. Rd. Taylor Falls	Dresser WI 54009 MN	55084
Septic Tank Information		Liquid Capacity:	
Tank Manufacturer: Superior tank (Centerville, mn.)		2 (1000)	

PUMP CHAMBER (if installed)			
Tank Manufacturer:	Liquid Capacity:	Horsepower of Pump:	Type of Warning Device:
Pump Discharge in Gallons Per Minute:	at	Feet of	Number of Gallons Pumped Per Cycle:
Head			

DRAINFIELD TRENCH		BED OR MOUND		
Width:	Length of Each Trench:	Rock Bed Length:	Width:	Area:
10" gravelless	40			
Depth of Trench Bottom from Finished Grade:		Bed Depth from Grade:		
20" - 26"				
Method of Distribution:		MOUND:		
<input type="checkbox"/> Pressure <input type="checkbox"/> Distribution Box <input checked="" type="checkbox"/> Drop Box		Upslope Sand Base Depth: _____ Downslope Sand Base Depth: _____		
Depth of Rock Under Distribution Pipe:		Depth of Rock Under Pipe:		
NONE				
Square Footage of Tested Area Used:		PRESSURE DISTRIBUTION SYSTEM:		
500				
Trench Bottom Square Footage Required:	Area As Built:	Lateral Inside Diameter:	Length:	Perforation Size:
10" Gravelless				
		Spacing:	Number:	Perforation Spacing:

Complete site plan on attached sheet. On the site plan, include location of the following items.  
Structures, septic tank, pump chamber, line from house to tank treatment system, distribution lines, distribution or drop boxes, well, and driveway. Show all distances applicable to the sewage treatment system (distance from structure to tank, tank to treatment system, distance between distribution lines, length of distribution lines, and distance between well and sewage treatment system). Indicate NORTH on the site plan and the scale of the plan.

I hereby certify that the system at the above referenced address was installed according to the Washington County Individual Sewage Treatment System Ordinance requirements.

Signed: [Signature] MPCA License #: 1290 Dated: 9/2/97

WASHINGTON COUNTY SEPTIC PERMIT NUMBER 92 970 31

RECEIVED  
SFP 05 1997  
HELM

↑ W

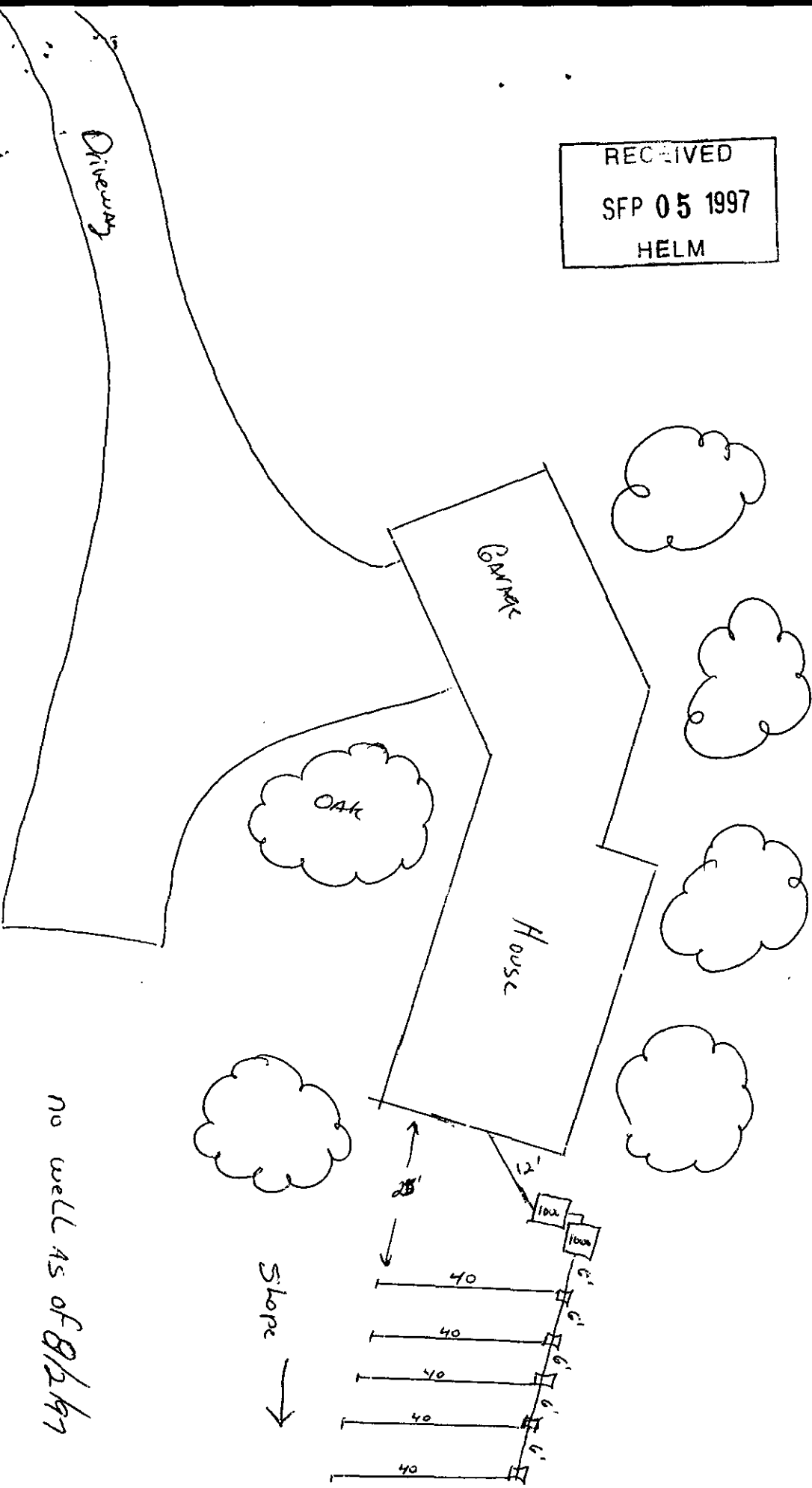

no well as of 8/2/97