

# Compliance Inspection Form

## Existing Subsurface Sewage Treatment System (SSTS)

Doc Type: Compliance and Enforcement

Inspection results based on Minnesota Pollution Control Agency (MPCA) requirements and attached forms - additional local requirements may also apply.

Submit completed form to Local Unit of Government (LUG) and system owner within 15 days.

### System Status

System status on date (mm/dd/yyyy): 11/5/2018

Compliant - Certificate of Compliance  Noncompliant - Notice of Noncompliance

(Valid for 3 years from report date, unless shorter time frame outlined by Local Ordinance.)

(See upgrade requirements on page 3)

Reason(s) for noncompliance (check all applicable):

- Impact on Public Health (Compliance Component #1) - Imminent threat to public health and safety
- Other Compliance Conditions (Compliance Component #3) - Imminent threat to public health and safety
- Tank Integrity (Compliance Component #2) - Failing to protect groundwater
- Other Compliance Conditions (Compliance Component #3) - Failing to protect groundwater
- Soil Separation (Compliance Component #4) - Failing to protect groundwater
- Operating Permit/Monitoring Plan Requirements (Compliance Component #5) - Noncompliant

### Property Information

Property address: 13450 122nd st. east Hastings Mn 55031

Reason for inspection: Sale

Property owner: Larry Schiomka

Owner's phone: 651-775-5782

OR

Owner's representative: NA

Representative's phone:

Local regulatory authority: Washington County

Regulatory authority phone:

Brief system description: two septic tank and lift station with pressure bed ( drainfield)

Comments or recommendations:

### Certification

I hereby certify that all the necessary information has been gathered to determine the compliance status of this system. No determination of the future system performance has been nor can be made due to unknown conditions during system construction, possible abuse of the system, inadequate maintenance, or future water usage

Inspector name: Bob Freiermuth

Bob Freiermuth

Business name: Bob Freiermuth

Bob Freiermuth

Inspector signature: 

### Necessary or Locally Required Attachments

Soil Boring Logs  System/As-Built Drawings  Forms Per Local Ordinance

Other Information (list):  pump cert.

Certification number: C818

License number: L492

Phone number: 651 437-5566

1. Impact on Public Health - Compliance component #1 of 5

Property address: 13450 122nd st. east Hastings Mn 55031

Inspector Initials/Date

11/5/2018 (mm/dd/yyyy)

Compliance Criteria:

System discharges sewage to the ground surface	<input type="checkbox"/> Yes <input checked="" type="checkbox"/> No
System discharges sewage to drain tile or surface waters	<input type="checkbox"/> Yes <input checked="" type="checkbox"/> No
System causes sewage backup into dwelling or establishment	<input type="checkbox"/> Yes <input checked="" type="checkbox"/> No

Any "yes" answer above indicates that the system is an imminent threat to public health and safety.

Comments/Explanation:

2. Tank Integrity - Compliance component #2 of 5

Compliance Criteria:

System consists of seepage pit, cesspool, drywell, or leaching pit	<input type="checkbox"/> Yes <input checked="" type="checkbox"/> No
Seepage pits meeting 7080.2550 may be compliant if allowed in local ordinance	
Sewage tank(s) leak below their designed operating depth.	<input type="checkbox"/> Yes <input checked="" type="checkbox"/> No
If yes, which sewage tank(s) leaks:	

Any "yes" answer above indicates that the system is failing to protect groundwater.

Comments/Explanation:

3. Other Compliance Conditions - Compliance component #3 of 5

a. Maintenance hole covers are damaged, cracked, unsecured, or appear to be structurally unsound

Yes\*  No  Unknown

b. Other issues (electrical hazards, etc.) to immediately and adversely impact public health or safety

Yes\*  No  Unknown

\*System is an imminent threat to public health and safety.

Explain:

c. System is non protective of groundwater for other conditions as determined by the inspector

Yes\*  No

\*System is failing to protect groundwater

Explain:

Upgrade Requirements (Minn. Stat. § 115.55). An imminent threat to public health and safety (TPHS) must be upgraded, replaced, or its use discontinued within ten months of receipt of this notice or within a shorter period if required by local ordinance. If the system is failing to protect groundwater, the system must be upgraded, replaced, or its use discontinued within the time required by local ordinance. If an existing system is not falling as defined in law, and has at least two feet of design soil separation, then the system need not be upgraded, repaired, replaced, or its use discontinued, notwithstanding any local ordinance that is more strict. This provision does not apply to systems in shoreland areas, Wellhead Protection Areas, or those used in connection with food, beverage, and lodging establishments as defined in law.

Any "no" answer above indicates Noncompliance

Table with 2 columns: Question (a, b) and Answer (Yes/No) for Operating Permit number and BMP in place and properly functioning.

Compliance Criteria:

If the answer to both questions is "no", this section does not need to be completed.

BMP = Best Management Practice(s) specified in the system design.

Form with two rows of questions: 'Is the system required to employ Nitrogen BMP?' and 'Is system operating under an Operating Permit?' with Yes/No options.

5. Operating Permit and Nitrogen BMP - Compliance component #5 of 5

Not applicable

Any "no" answer above indicates the system is failing to protect groundwater.

Table with 2 columns: Question (A, B, C, D) and Answer (Yes/No) regarding drainage field separation and performance.

Compliance Criteria:

Form for Shoreland/Wellhead Protection/Food, beverage, lodging? with Yes/No options.

Date of installation: 23-Jun-05

Unknown

4. Soil Separation - Compliance component #4 of 5

Property address: 13450 122nd st. east Hastings Mn 55031

Inspector Initials/Date

11/5/2018

Handwritten signature

(mm/dd/yyyy)

5 Nov 18

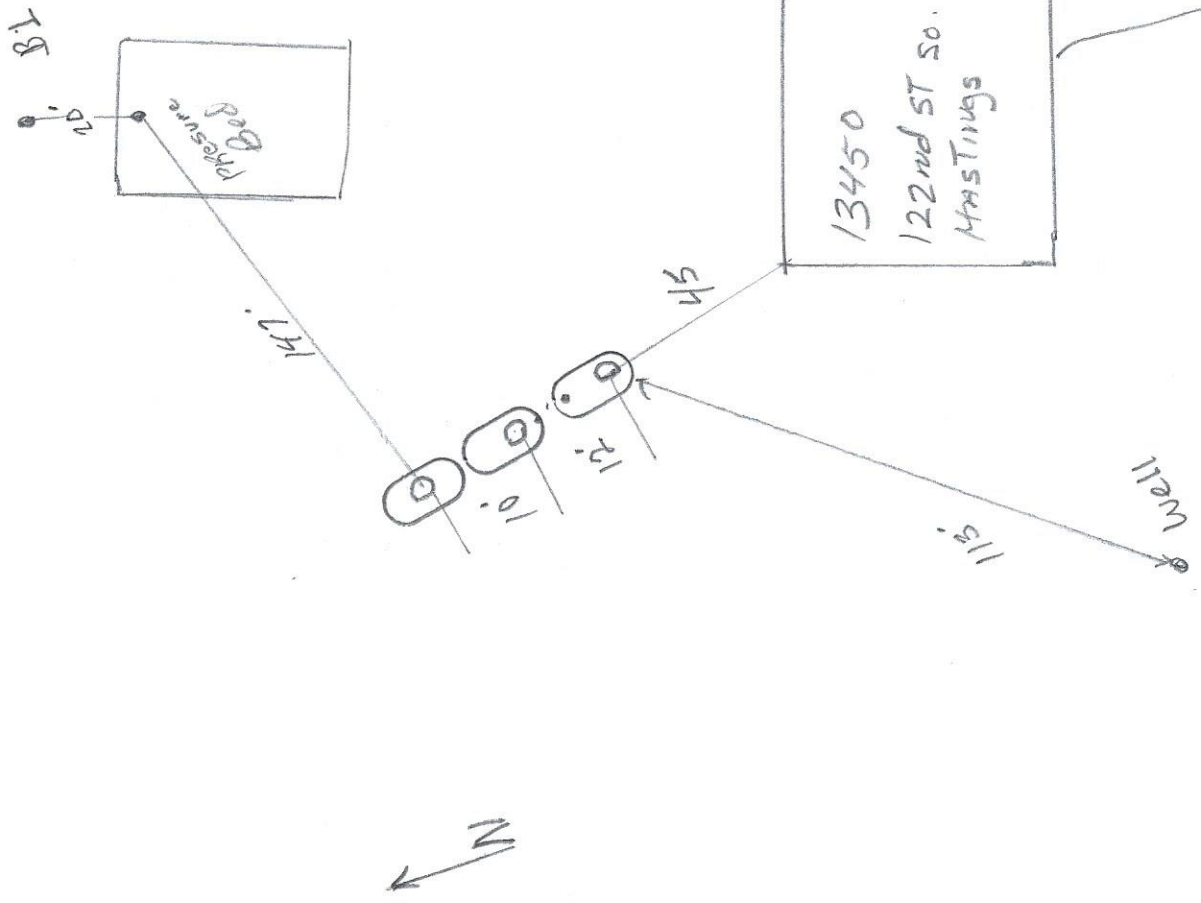

Date:

5-Nov-18

Customer Name:

Larry schlomka

Street Address:

13450 122nd St. East hastings Mn. 55033

City, State, Zip:

Phone Number:

651-775-5782

COMPANY DISCLAIMER

Based on what we were able to observe and on our experience with on-site wastewater technology, we submit this Onsite Sewage Treatment System Inspection Report based on the present condition of the onsite sewage disposal system. *Bob Freiermuth* has not been retained to warrant, guarantee, or certify the proper functioning of the system for any period of time in the future. Because of the numerous factors (usage, soil characteristics, previous failures, etc.) which may affect the proper operation of a septic system, this report shall not be construed as a warranty by our company that the system will function properly for any particular buyer. *Bob Freiermuth* hereby DISCLAIMS ANY WARRANTY, either expressed or implied, arising from the inspection of the septic system or this report. We are not also ascertaining any affect the system is having on the groundwater.

Inspecting Company

Bob Freiermuth

License No

818

Phone

651 437-5566

Owners Signature

I have studied the information contained herein and certify that my assessment is honest, thorough, and to the best of my ability, correct.

Name:



Title:

SSTS Inspector 818

**Tank Integrity and Safety Compliance**  
Compliance Issue #2 of 4

Parcel number: \_\_\_\_\_  
System status:  Compliant  Noncompliant  
(as determined by this form)

Date of observation: **10/31/2018**  
Reason for observation: **Routine Pumping**  
This form expires on (three years): **10/30/2021**

Compliance questions/criteria: (Required) (Check the appropriate box)

Does the system consist of a seepage pit*, cesspool, drywell, or leaching pit?	<input type="checkbox"/> Yes <input checked="" type="checkbox"/> No
Do any sewage tank(s) leak below their designed operating depth?	<input type="checkbox"/> Yes <input checked="" type="checkbox"/> No

- Verification Method\*\* (Optional) (Check the appropriate box)
- Probed tank bottom
  - Observed low liquid level
  - Examined construction records
  - Examined empty (pumped) tank
  - Probed outside tank for "black soil"
  - Pressure/vacuum check
  - Other: \_\_\_\_\_

If yes, identify which sewage tank leaks.  
Any "yes" answer indicates that the system is failing to protect ground water.  
\* Seepage pits meeting 7080.2550 may be compliant if allowed in ordinance by local permitting authority.

\*\* No standard protocol exists. This list is not exhaustive, in sequential order, nor does it indicate which combinations are necessary to make this determination.

**Safety Check**

1. Are any maintenance hole covers damaged, cracked, or appeared to be structurally unsound?  
 Yes\*  No
2. Were all maintenance hole covers replaced in a secured manner (e.g., all screws replaced)?  
 Yes  No\*
3. Was secondary access restraint present (safety pan, second cover, or safety netting) – highly recommended.  
 Yes  No
4. Was any other safety/health issue present?  
 Yes\*  No

\*System is an imminent threat to public health and safety.

**Certification**

This form is to be completed and attached to the Summary Form of the Minnesota Pollution Control Agency's (MPCA) Compliance Inspection Form for Existing Subsurface Sewage Treatment Systems. Observations, interpretations, and conclusions must be completed by an inspector, maintainer, or service provider. Completed form must be submitted to the local unit of government within 15 days.

Property owner name(s): **Larry Schlomka**  
Property address: **13450 122nd Street S**  
County: **Washington**  
Phone: \_\_\_\_\_  
Name: **Larry Schlomka**  
Business license name and number: **Schlomka Services LLC**  
or **2989**  
Certification number: **C4253**  
Signature: *[Signature]*  
Date: **10/31/2018**

I hereby certify that I personally made the observations, interpretations, and conclusions reported on this form and that they are correct.

## Log Of Soil Borings

Location of Project: 13450 122nd St S, Denmark Township, MN 55033		Borings Made By: Inspect Minnesota		Date: 9/11/14	
Auger Used: Hand/Bucket		Classification System: USDA		Boring Number: 1	
Surface Elevation of Boring: 106.30'		Surface Elevation of Boring: 106.30'		Boring Number: 1	
Elevation of Benchmark = 100.00' basement patio door threshold		Elevation of Benchmark = 100.00' basement patio door threshold		Boring Number: 1	
Depth In Inches		Soils Encountered		Soils Encountered	
0-20		10YR 2/2 Silt Loam		10YR 2/2 Silt Loam	
20-30		10YR 3/6 Silt Loam		10YR 3/6 Silt Loam	
30-48		10YR 4/4 Silt Loam		10YR 4/4 Silt Loam	
48-51		10YR 4/4 Silt Loam With Limestone Pieces		10YR 4/4 Silt Loam With Limestone Pieces	
104.78'		Elevation To Bottom Of Drainfield		Elevation To Bottom Of Drainfield	
-102.05'		Depth To Redox Or End Of Boring		Depth To Redox Or End Of Boring	
=2.73'/33" Of Separation		Of Separation		Of Separation	
End Of Boring At: 51"		End Of Boring At: 51"		End Of Boring At: 51"	
Redox Present At: None		Redox Present At: None		Redox Present At: None	
Standing Water Present At: None		Standing Water Present At: None		Standing Water Present At: None	

Bottom Of Distribution Medium At: 23" Or Elevation 104.78' At Soil Probe

Project Location: XXXX 122<sup>nd</sup> St. S.

Client: \_\_\_\_\_  
Address: \_\_\_\_\_

Borings made by: GARY M. BOHN  
1043

Twp. \_\_\_\_\_

Boring method: Auger  
City \_\_\_\_\_ State \_\_\_\_\_ Zip \_\_\_\_\_

Color classification system: Munsell Other

Boring Number B1  
Surface Elevation \_\_\_\_\_  
Soil type at system depth: \_\_\_\_\_

Boring Number B2  
Surface Elevation \_\_\_\_\_  
Soil type at system depth: \_\_\_\_\_

Depth (Feet)	Texture	Color	Depth (Feet)	Texture	Color
7			7		
6			6		
5			5		
4			4	Sand	loam sly
3	loam	loam sly	3	loam	loam sly
2	5.1t loam	loam sly	2	5.1t loam	loam sly
1	loam	loam sly	1	loam	loam sly

Structure: Blocky Platy Prismatic None

Structure: Blocky Platy Prismatic None

Slope: \_\_\_\_\_%  
End of boring at \_\_\_\_\_ feet.

Slope: \_\_\_\_\_%  
End of boring at \_\_\_\_\_ feet.

Standing water table: yes no  
Present at \_\_\_\_\_ feet of depth,  
\_\_\_\_\_ hours after boring.

Standing water table: yes no  
Present at \_\_\_\_\_ feet of depth,  
\_\_\_\_\_ hours after boring.

Mottled soil:  
Observed at \_\_\_\_\_ feet of depth,  
Not present in boring hole.

Mottled soil:  
Observed at \_\_\_\_\_ feet of depth,  
Not present in boring hole.

Observations and comments: \_\_\_\_\_