

MAC'S Sewer Service

34918 Falcon Ave., North Branch, MN. 55056

macsewer12@gmail.com

651-462-1510

Date: 11-26-18 Time

Phone:	651-705-6312	Cell:	
Email:	assist@mkt-msp.com (Billing)		
Name:	Aaron Rosell-Keller Williams		
Address:	aaron@mkt-msp.com		
City/State/Zip:			Wash. Co.

owner:	Paul G. Lamos	
Site:	9989-110 th St. N.	
	still water, mtr	
Compliance Inspection		350-
Wash. Co. Report fee		40-
(Tank Pumping deferred)		
	Due Upon Receipt TOTAL	390-
PAID CK#	VISA MASTER CARD A/R	
PAYMENT DUE UPON RECEIPT—\$20 LATE FEE DUE after 7 days. A \$30 NSF fee will be charged for returned checks.		

Septic Inspection Septic Design Perc/Soil Tests Water Tests

Mac's Sewer Service

Compliance Inspections

Water Tests

Septic Designs

Perc/Soil Tests

November 26, 2018

Aaron Rosell
Keller Williams Integrity Lakes

651-705-6312

aaron@mkt-msp.com

RE: Paul Glamos 9989-110th St. N., Stillwater, MN.

Enclosed you will find the following Documents:

- Notice of Non-Compliance**
 - Drain field does not meet vertical separation requirement.**
 - Surfacing Septage-Imminent Health Threat
 - Tank(s) not water tight-cracked
 - Drain field failing to accept or treat wastewater-running overfull
 - Tank pumping deferred until upgrade due to failing status.*
 - Repairs-see comment sections of report or site sketch
- Comments- see comment sections of report and site sketch.**
- Design
- Perc/Soil Testing Results
- Water Test Results sent prior
- Invoice
 - Submit to lender for payment
 - Due upon receipt**
 - Paid in full

Thank you. We appreciate your business.

Sincerely,

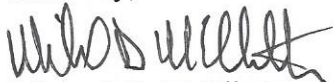

Michael D. McElhatton
Inspector/Designer



Minnesota Pollution Control Agency

520 Lafayette Road North
St. Paul, MN 55155-4194

Compliance Inspection Form
Existing Subsurface Sewage Treatment Systems (SSTS)

Doc Type: Compliance and Enforcement

Instructions: Inspection results based on Minnesota Pollution Control Agency (MPCA) requirements and attached forms - additional local requirements may also apply.

Submit completed form to Local Unit of Government (LUG) and system owner within 15 days

For local tracking purposes:

System Status

System status on date (mm/dd/yyyy): 11/26/2018

[] Compliant - Certificate of Compliance
(Valid for 3 years from report date, unless shorter time frame outlined in Local Ordinance.)

[x] Noncompliant - Notice of Noncompliance
(See Upgrade Requirements on page 3)

Reason(s) for noncompliance (check all applicable)

- [] Impact on Public Health (Compliance Component #1) - Imminent threat to public health and safety
[] Other Compliance Conditions (Compliance Component #3) - Imminent threat to public health and safety
[] Tank Integrity (Compliance Component #2) - Failing to protect groundwater
[] Other Compliance Conditions (Compliance Component #3) - Failing to protect groundwater
[x] Soil Separation (Compliance Component #4) - Failing to protect groundwater
[] Operating permit/monitoring plan requirements (Compliance Component #5) - Noncompliant

Property Information

Parcel ID# or Sec/Twp/Range:

Property address: 9989-10TH ST. N, STILLWATER, MN. 55082 Reason for inspection: PROPERTY SALE
Property owner: PAUL GLAMOS Owner's phone:

Owner's representative: AARON ROSELL/KELLER WILLIAMS RE Representative phone: 651-705-6312
Local regulatory authority: WASHINGTON COUNTY Regulatory authority phone: 651-430-5566
Brief system description: PRESSURIZED TRENCHES IN FILL SOILS WITH SEPTIC TANK & LIFT TANK

Comments or recommendations:

DRAINFIELD DOES NOT HAVE THE VERTICAL SEPARATION REQUIRED FOR THE PROPER TREATMENT OF WASTEWATER, AND THEREFORE DOES NOT MEET MPCA CH. 7080 COMPLIANCE CRITERIA. TANK PUMPING DEFERRED UNTIL UPGRADE-SEE SEC. #2 RE TANKS.

Certification

I hereby certify that all the necessary information has been gathered to determine the compliance status of this system. No determination of future system performance has been nor can be made due to unknown conditions during system construction, possible abuse of the system, inadequate maintenance, or future water usage.

Inspector name: MICHAEL D. MCELHATTON Certification number: R4089
Business name: MAC'S SEWER SERVICE License number: L1476
Inspector signature: [Signature] Phone number: 651-462-1510

Necessary or Locally Required Attachments

- [x] Soil boring logs [x] System/As-built drawing [] Forms per local ordinance
[] Other information (list):

1. Impact on Public Health – Compliance component #1 of 5

Compliance criteria:

System discharge sewage to the ground surface.	<input type="checkbox"/> Yes <input checked="" type="checkbox"/> No
System discharge sewage to drain tile or surface waters.	<input type="checkbox"/> Yes <input checked="" type="checkbox"/> No
System cause sewage backup into dwelling or establishment.	<input type="checkbox"/> Yes <input checked="" type="checkbox"/> No

Any "yes" answer above indicates the system is an Imminent Threat to Public Health and Safety.

Comments/Explanation:

NOTHING ELSE OBSERVED AT THE TIME OF INSPECTION. HOME IS VACANT

Verification method(s):

- Searched for surface outlet
- Searched for seeping in yard/backup in home
- Excessive ponding in soil system/D-boxes
- Homeowner testimony (See Comments/Explanation)
- "Black soil" above soil dispersal system
- System requires "emergency" pumping
- Performed dye test
- Unable to verify (See Comments/Explanation)
- Other methods not listed (See Comments/Explanation)

2. Tank Integrity – Compliance component #2 of 5

Compliance criteria:

System consists of a seepage pit, cesspool, drywell, or leaching pit. <i>Seepage pits meeting 7080.2550 may be compliant if allowed in local ordinance.</i>	<input type="checkbox"/> Yes <input checked="" type="checkbox"/> No
Sewage tank(s) leak below their designed operating depth.	<input type="checkbox"/> Yes <input checked="" type="checkbox"/> No
If yes, which sewage tank(s) leaks:	

Any "yes" answer above indicates the system is Failing to Protect Groundwater.

Comments/Explanation:

TANK PUMPING DEFERRED UNTIL DRAINFIELD IS REPLACED AT WHICH TIME TANKS SHOULD BE PUMPED & CHECKED FOR SIZE & INTEGRITY. PER INSTALLATION RECORDS TANKS ARE PRECAST TANK APPROX. 1250 GAL. SEPTIC TANK & 1000 GAL. LIFT TANK. TANKS MAY BE REUSED IF DEEMD GOOD BUT IS SUBJECT TO NEW DRAINFIELD DESIGN, LAYOUT & SIZING FACTORS.

Verification method(s):

- Probed tank(s) bottom
- Examined construction records
- Examined Tank Integrity Form (Attach)
- Observed liquid level below operating depth
- Examined empty (pumped) tanks(s)
- Probed outside tank(s) for "black soil"
- Unable to verify (See Comments/Explanation)
- Other methods not listed (See Comments/Explanation)

3. Other Compliance Conditions – Compliance component #3 of 5

- a. Maintenance hole covers are damaged, cracked, unsecured, or appear to structurally unsound. Yes* No Unknown
- b. Other issues (electrical hazards, etc.) to immediately and adversely impact public health or safety. Yes* No Unknown
***System is an imminent threat to public health and safety**

Explain:

- c. System is non-protective of ground water for other conditions as determined by inspector Yes* No
***System is failing to protect groundwater**

Explain:

4. Soil Separation – Compliance component #4 of 5

Date of installation: 1991 Unknown

Shoreland/Wellhead protection/Food Beverage Lodging? Yes No

Compliance criteria:

For systems built prior to April 1, 1996, and not located in Shoreland or Wellhead Protection Area or not serving a food, beverage or lodging establishment: Yes No

Drainfield has at least a two-foot vertical separation distance from periodically saturated soil or bedrock.

Non-performance systems built April 1, 1996, or later or for non-performance systems located in Shoreland or Wellhead Protection Areas or serving a food, beverage, or lodging establishment: Yes No

Drainfield has a three-foot vertical separation distance from periodically saturated soil or bedrock.*

“Experimental”, “Other”, or “Performance” systems built under pre-2008 Rules; Type IV or V systems built under 2008 Rules (7080.2350 or 7080.2400 (Advanced Inspector License required) Yes No

Drainfield meets the designed vertical separation distance from periodically saturated soil or bedrock.

Any “no” answer above indicates the system is Failing to Protect Groundwater.

Verification method(s):

Soil observation does not expire. Previous soil observations by two independent parties are sufficient, unless site conditions have been altered or local requirements differ.

- Conducted soil observation(s) (Attach boring logs)
- Two previous verifications (Attach boring logs)
- Not applicable (Holding tank(s), no drainfield)
- Unable to verify (See Comments/Explanation)
- Other (See Comments/Explanation)

Comments/Explanation:

DRAINFIELD DOES NOT MEET COMPLIANCE & MUST BE REPLACED TO BRING INTO COMPLIANCE. PER INSTALLATION RECORDS FILL SOILS WERE BROUGHT IN TO INSTALL SEPTIC SYSTEM WHICH DO NOT COMPLY WITH OR MEET COMPLIANCE CRITERIA--SEE COUNTY FOR DETAILED RECORDS OF FILL SOILS.

Indicate depths of elevations

A. Bottom of distribution media	30"
B. Periodically saturated soil/bedrock	30"
C. System separation	0"
D. Required compliance separation*	36"

*May be reduced up to 15 percent if allowed by Local Ordinance.

5. Operating Permit and Nitrogen BMP* – Compliance component #5 of 5 Not applicable

Is the system operated under an Operating Permit? Yes No **If “yes”, A below is required**

Is the system required to employ a Nitrogen BMP? Yes No **If “yes”, B below is required**

BMP=Best Management Practice(s) specified in the system design

If the answer to both questions is “no”, this section does not need to be completed.

Compliance criteria

a. Operating Permit number: _____ Yes No
Have the Operating Permit requirements been met?

b. Is the required nitrogen BMP in place and properly functioning? Yes No

Any “no” answer indicates Noncompliance.

Upgrade Requirements (Minn. Stat. § 115.55) An imminent threat to public health and safety (ITPHS) must be upgraded, replaced, or its use discontinued within ten months of receipt of this notice or within a shorter period if required by local ordinance. If the system is failing to protect ground water, the system must be upgraded, replaced, or its use discontinued within the time required by local ordinance. If an existing system is not failing as defined in law, and has at least two feet of design soil separation, then the system need not be upgraded, repaired, replaced, or its use discontinued, notwithstanding any local ordinance that is more strict. This provision does not apply to systems in shoreland areas, Wellhead Protection Areas, or those used in connection with food, beverage, and lodging establishments as defined in law.

SITE SKETCH + BORING LOG
ATTACHMENT TO MPCA COMPLIANCE INSPECTION FORM wq.wwwists4-31

Property: 9989-110TH St. N

By Mac's Sewer Service 11/26/2018

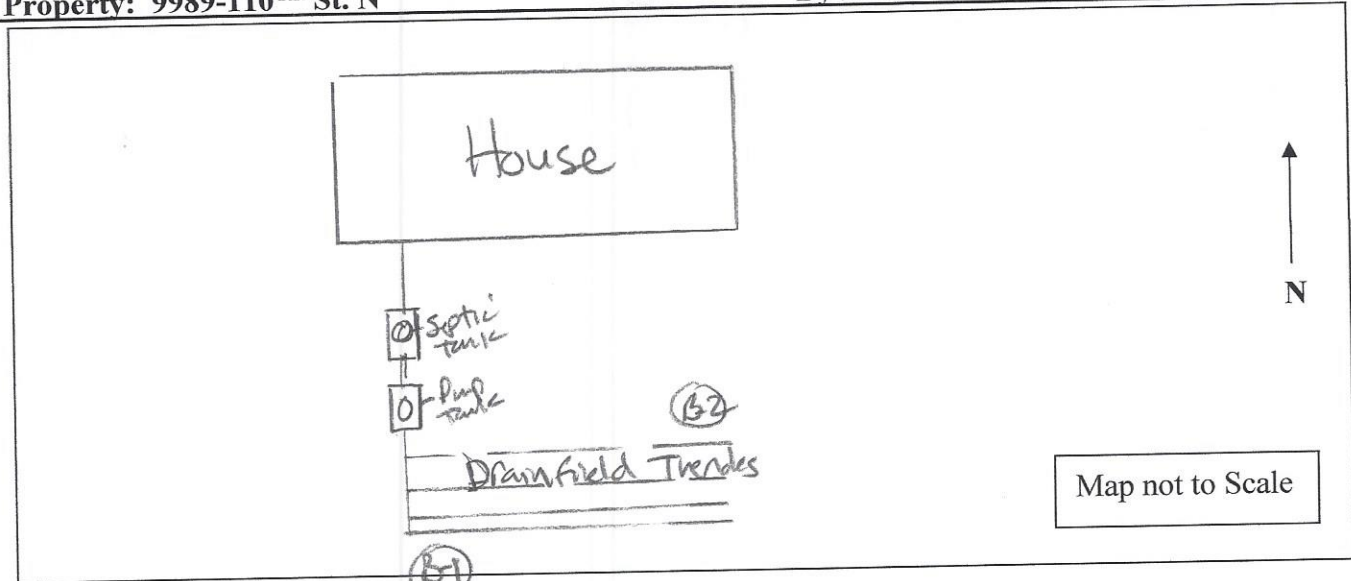

SOIL BORING #1

0-9" 10yr 2/2 dark brown sandy loam
9-36" 10yr 4/6 reddish brown sand-mixed fill soils
36-48" 10yr 2/2 dark brown sandy loam

Red & Grey Mottling 36"+

SOIL BORING #2

0-9" 10yr 2/2 dark brown sandy loam
9-26" 10yr 4/6 reddish brown sand-mixed fill soils
26-36" 10yr 5/3 lgt brown silty loam

Red & Grey Mottling 30"+

COMMENTS: SYSTEM DOES NOT MEET MPCA CH. 7080 compliance code .

WINTER INSPECTION DISCLOSURE: Every effort is made by Mac's Sewer Service to use the same level of standards to perform winter inspections, however, the same level of standards may not be possible due to snow cover and/or frozen soil, and as a result may limit the scope of Inspector's ability to determine compliance but was done to the best of his ability, and which buyer & seller accept as performed and as reported .

BANK OWNED or VACANT PROPERTY: If property is bank owned or vacant, there is no owner testimony or current use to determine if there is, or has been, a history of back up into the house or surface discharge, although none was observed at the time of this inspection. Mac's Sewer does not assume any liability for limits of the inspection due to homes being vacant or winterized. Buyer & Seller accept this and the property as-is.

PURPOSE: The purpose and results of this inspection are only to determine if there is, or is not, adequate treatment of wastewater to protect against ground water pollution via tank(s) and drain field at the time of Inspection per the MPCA CH. 7080 Compliance Code. No other determination has been, or is made or implied, including system longevity, the inside plumbing & function, future performance or warranty of system due to unknown conditions during system construction, hydraulic performance, the use of the system, it's age or size, inadequate maintenance, or future water usage. **Liability is limited to the cost of this inspection.**

REQUIREMENTS to bring system into compliance if deemed not in compliance: REPLACE DRANFIED: Check with local government for specific upgrade requirements and time frames, which are subject to change without notice .