ZIERKE SOIL TESTING

Chad Lemmons
8695 200th St N
Forest Lake, MN 55025

3/23/2020

Dear Chad Lemmons,

At your request, I have conducted a septic inspection to determine the compliance status of your system pursuant to Minnesota Rules Chapter 7080.

The compliance test set out in 7080 has three main inquiries: 1). Is the system functioning hydraulically (disposing of effluent in a manner that prevents it from coming in contact with people)? 2). Are the septic tanks water tight? 3). Does the system have sufficient vertical separation between the bottom of the septic system and restrictive layers (bedrock, standing water, seasonally wet layers, etc) to provide full treatment of effluent?

Based off of these criteria, your system is non-compliant due to a tank that leaks below its operating level and a straight pipe surface discharge. The ground above the tank has started to settle, indicating structural issues with the tank. **Both the tank and the straight pipe discharge are defined as "imminent threat's to public health"** and will need to be addressed in a short time span. I am required by law to provide copies of this report to you and Washington County Public Health and Environment. You should contact them as soon as possible to determine the timeline of the next steps that will be required to bring the system into compliance.

Sincerely,



Benjamin Zierke
MPCA Lic 119, Cert 9594

ADDRESS:
28587 Jeffrey Ave
Chisago City, MN 55013

PHONE 651-249-1346
EMAIL benzierke@gmail.com



Minnesota Pollution Control Agency

520 Lafayette Road North
St. Paul, MN 55155-4194

Compliance Inspection Form
Existing Subsurface Sewage Treatment Systems (SSTs)

Doc Type: Compliance and Enforcement

Inspection results based on Minnesota Pollution Control Agency (MPCA) requirements and attached forms - additional local requirements may also apply.

Submit completed form to Local Unit of Government (LUG) and system owner within 15 days

For local tracking purposes:

System Status

System status on date (mm/dd/yyyy): 3/23/2020

[] Compliant - Certificate of Compliance
(Valid for 3 years from report date, unless shorter time frame outlined in Local Ordinance.)

[x] Noncompliant - Notice of Noncompliance
(See Upgrade Requirements on page 3.)

Reason(s) for noncompliance (check all applicable)

- [x] Impact on Public Health (Compliance Component #1) - Imminent threat to public health and safety
[x] Other Compliance Conditions (Compliance Component #3) - Imminent threat to public health and safety
[x] Tank Integrity (Compliance Component #2) - Failing to protect groundwater
[] Other Compliance Conditions (Compliance Component #3) - Failing to protect groundwater
[] Soil Separation (Compliance Component #4) - Failing to protect groundwater
[] Operating permit/monitoring plan requirements (Compliance Component #5) - Noncompliant

Property Information

Parcel ID# or Sec/Twp/Range:

Property address: 8695 200th St N Forest Lake, MN 55025 Reason for inspection: Sale

Property owner: Chad Lemmons Owner's phone: 651-224-3781

or

Owner's representative: Representative phone:

Local regulatory authority: Washington County Regulatory authority phone: 651-430-6655

Brief system description: Block style septic tank and straight pipe surface discharge

Comments or recommendations:

Area above the septic tank has started to settle and sink the past few years. Tank is a collapsing hazard.

Certification

I hereby certify that all the necessary information has been gathered to determine the compliance status of this system. No determination of future system performance has been nor can be made due to unknown conditions during system construction, possible abuse of the system, inadequate maintenance, or future water usage.

Inspector name: Benjamin Zierke Certification number: C9594

Business name: Zierke Soil Testing License number: L119

Inspector signature: [Signature] Phone number: 651-249-1346

Necessary or Locally Required Attachments

- [x] Soil boring logs [x] System/As-built drawing [] Forms per local ordinance
[] Other information (list):

1. Impact on Public Health – Compliance component #1 of 5

Compliance criteria:

| | |
|---|---|
| System discharges sewage to the ground surface. | <input checked="" type="checkbox"/> Yes <input type="checkbox"/> No |
| System discharges sewage to drain tile or surface waters. | <input type="checkbox"/> Yes <input checked="" type="checkbox"/> No |
| System causes sewage backup into dwelling or establishment. | <input type="checkbox"/> Yes <input checked="" type="checkbox"/> No |

Any "yes" answer above indicates the system is an imminent threat to public health and safety.

Comments/Explanation:

Straight pipe outlet is about 30' downhill from tank.

Verification method(s):

- Searched for surface outlet
- Searched for seeping in yard/backup in home
- Excessive ponding in soil system/D-boxes
- Homeowner testimony (See Comments/Explanation)
- "Black soil" above soil dispersal system
- System requires "emergency" pumping
- Performed dye test
- Unable to verify (See Comments/Explanation)
- Other methods not listed (See Comments/Explanation)

2. Tank Integrity – Compliance component #2 of 5

Compliance criteria:

| | |
|--|---|
| System consists of a seepage pit, cesspool, drywell, or leaching pit. <i>Seepage pits meeting 7080.2550 may be compliant if allowed in local ordinance.</i> | <input checked="" type="checkbox"/> Yes <input type="checkbox"/> No |
| Sewage tank(s) leak below their designed operating depth. If yes, which sewage tank(s) leaks: | <input checked="" type="checkbox"/> Yes <input type="checkbox"/> No |

Any "yes" answer above indicates the system is failing to protect groundwater.

Comments/Explanation:

Examined tank during site visit, tank appears to be block tank with orangeburg pipe entering/exiting the tank. Some sinking has occurred at the ground surface over the tank, indicating structural issues starting to occur with tank.

Verification method(s):

- Probed tank(s) bottom
- Examined construction records
- Examined Tank Integrity Form (Attach)
- Observed liquid level below operating depth
- Examined empty (pumped) tanks(s)
- Probed outside tank(s) for "black soil"
- Unable to verify (See Comments/Explanation)
- Other methods not listed (See Comments/Explanation)

3. Other Compliance Conditions – Compliance component #3 of 5

- a. Maintenance hole covers are damaged, cracked, unsecured, or appear to be structurally unsound. Yes* No Unknown
 - b. Other issues (electrical hazards, etc.) to immediately and adversely impact public health or safety. Yes* No Unknown
- *System is an imminent threat to public health and safety.**

Explain:

- c. System is non-protective of ground water for other conditions as determined by inspector. Yes* No
- *System is failing to protect groundwater.**

Explain:

4. Soil Separation – Compliance component #4 of 5

Date of installation: 1960's Unknown
(mm/dd/yyyy)

Shoreland/Wellhead protection/Food beverage lodging? Yes No

Compliance criteria:

For systems built prior to April 1, 1996, and not located in Shoreland or Wellhead Protection Area or not serving a food, beverage or lodging establishment: Yes No

Drainfield has at least a two-foot vertical separation distance from periodically saturated soil or bedrock.

Non-performance systems built April 1, 1996, or later or for non-performance systems located in Shoreland or Wellhead Protection Areas or serving a food, beverage, or lodging establishment: Yes No

Drainfield has a three-foot vertical separation distance from periodically saturated soil or bedrock.*

"Experimental", "Other", or "Performance" systems built under pre-2008 Rules; Type IV or V systems built under 2008 Rules (7080.2350 or 7080.2400 (Advanced Inspector License required)) Yes No

Drainfield meets the designed vertical separation distance from periodically saturated soil or bedrock.

Any "no" answer above indicates the system is failing to protect groundwater.

Verification method(s):

Soil observation does not expire. Previous soil observations by two independent parties are sufficient, unless site conditions have been altered or local requirements differ.

- Conducted soil observation(s) (Attach boring logs)
- Two previous verifications (Attach boring logs)
- Not applicable (Holding tank(s), no drainfield)
- Unable to verify (See Comments/Explanation)
- Other (See Comments/Explanation)

Comments/Explanation:

NO DRAINFIELD

Indicate depths or elevations

| | |
|--|--|
| A. Bottom of distribution media | |
| B. Periodically saturated soil/bedrock | |
| C. System separation | |
| D. Required compliance separation* | |

*May be reduced up to 15 percent if allowed by Local Ordinance.

5. Operating Permit and Nitrogen BMP* – Compliance component #5 of 5 Not applicable

Is the system operated under an Operating Permit? Yes No **If "yes", A below is required**

Is the system required to employ a Nitrogen BMP? Yes No **If "yes", B below is required**

BMP = Best Management Practice(s) specified in the system design

If the answer to both questions is "no", this section does not need to be completed.

Compliance criteria

- a. Operating Permit number: _____ Yes No
Have the Operating Permit requirements been met?
- b. Is the required nitrogen BMP in place and properly functioning? Yes No

Any "no" answer indicates Noncompliance.

Upgrade Requirements (Minn. Stat. § 115.55) An imminent threat to public health and safety (ITPHS) must be upgraded, replaced, or its use discontinued within ten months of receipt of this notice or within a shorter period if required by local ordinance. If the system is failing to protect ground water, the system must be upgraded, replaced, or its use discontinued within the time required by local ordinance. If an existing system is not failing as defined in law, and has at least two feet of design soil separation, then the system need not be upgraded, repaired, replaced, or its use discontinued, notwithstanding any local ordinance that is more strict. This provision does not apply to systems in shoreland areas, Wellhead Protection Areas, or those used in connection with food, beverage, and lodging establishments as defined in law.

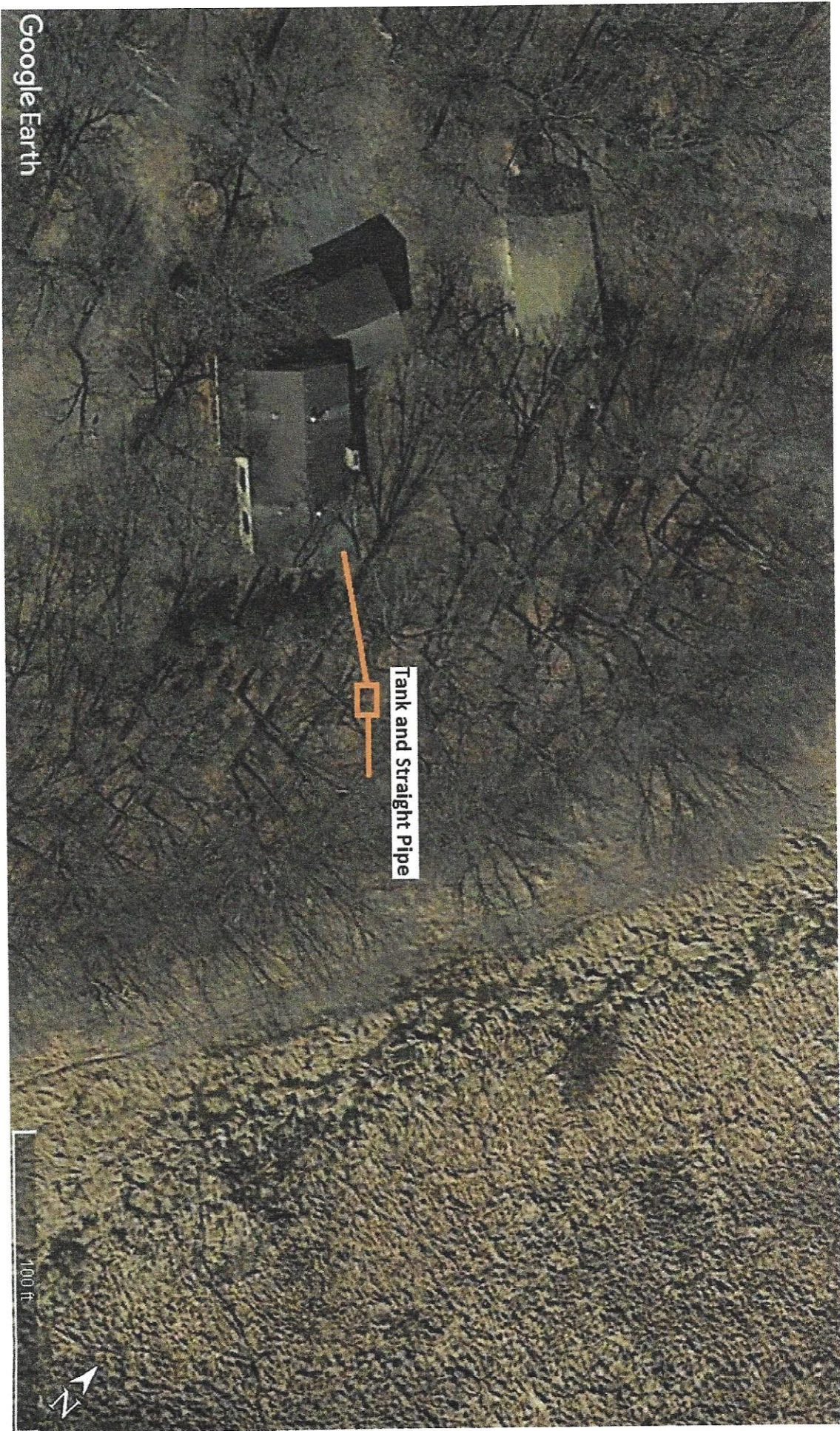

Google Earth

Tank and Straight Pipe

100 ft

