



Minnesota Pollution Control Agency

520 Lafayette Road North
St. Paul, MN 55155-4194

Compliance Inspection Form

Existing Subsurface Sewage Treatment System (SSTS)

Doc Type: Compliance and Enforcement

*EMailed To Washington cty
Apr 13-20
MAiled to Steve 15 Apr 20*

Inspection results based on Minnesota Pollution Control Agency (MPCA) requirements and attached forms - additional local requirements may also apply.

For local tracking purposes:

Submit completed form to Local Unit of Government (LUG) and system owner within 15 days.

System Status

System status on date (mm/dd/yyyy): 4/9/2020

- Compliant - Certificate of Compliance** **Noncompliant - Notice of Noncompliance**
(Valid for 3 years from report date, unless shorter time frame outlined by Local Ordinance.) *(See upgrade requirements on page 3)*

Reason(s) for noncompliance (check all applicable):

- Impact on Public Health (Compliance Component #1) - Imminent threat to public health and safety
- Other Compliance Conditions (Compliance Component #3) - Imminent threat to public health and safety
- Tank Integrity (Compliance Component #2) - Failing to protect groundwater
- Other Compliance Conditions (Compliance Component #3) - Failing to protect groundwater
- Soil Separation (Compliance Component #4) - Failing to protect groundwater
- Operating Permit/Monitoring Plan Requirements (Compliance Component #5) - Noncompliant

Property Information

Parcel ID# or Sec/Twp/Range: _____

Property address: 6335 Bailey Road Woodbury MN.55129
 Property owner: Steve Engler

Reason for inspection: sale
 Owner's phone: 612-307-7169

or
 Owner's representative: Na.
 Local regulatory authority: Washington County

Representative's phone: _____
 Regulatory authority phone: _____

Brief system description: Two nonconforming tanks

Comments or recommendations:

1st tank is a cistern, 2nd tank cesspool 1st tank pumped By Schlomka's services, unaware of tank #2

Certification

I hereby certify that all the necessary information has been gathered to determine the compliance status of this system. No determination of the future system performance has been nor can be made due to unknown conditions during system construction, possible abuse of the system, inadequate maintenance, or future water usage

Inspector name: Bob Freiermuth
 Business name: Bob Freiermuth
 Inspector signature: *Bob Freiermuth*

Certification number: C818
 License number: L492
 Phone number: 651 437-5566

Necessary or Locally Required Attachments

- Soil Boring Logs
- System/As-Built Drawings
- Forms Per Local Ordinance
- Other Information (list): _____

1. Impact on Public Health - Compliance component #1 of 5

Compliance Criteria:

System discharges sewage to the ground surface	<input type="checkbox"/> Yes	<input checked="" type="checkbox"/> No
System discharges sewage to drain tile or surface waters	<input type="checkbox"/> Yes	<input checked="" type="checkbox"/> No
System causes sewage backup into dwelling or establishment	<input type="checkbox"/> Yes	<input checked="" type="checkbox"/> No

Any "yes" answer above indicates that the system is an imminent threat to public health and safety.

Verification method(s)

- Searched for surface outlet
- Searched for seeping in yard/backup into home
- Excessive ponding in soil system/D-boxes
- Homeowner testimony (See Comments/Explanation)
- "Black soil" above soil dispersal system
- System requires "emergency" pumping
- Performed dye test
- Unable to verify (See Comments/Explanation)
- Other methods not listed (See Comments/Explanation)

Comments/Explanation:

2. Tank Integrity - Compliance component #2 of 5

Compliance Criteria:

System consists of seepage pit, cesspool, drywell, or leaching pit <small>Seepage pits meeting 7080.2550 may be compliant if allowed in local ordinance</small>	<input checked="" type="checkbox"/> Yes	<input type="checkbox"/> No
Sewage tank(s) leak below their designed operating depth. If yes, which sewage tank(s) leaks:	<input checked="" type="checkbox"/> Yes	<input type="checkbox"/> No

Any "yes" answer above indicates that the system is failing to protect groundwater.

Verification method(s)

- Probed tank(s) bottom.
- Examined construction records
- Examined Tank Integrity Form (Attach)
- Observed liquid level below operating depth
- Examined empty (pumped) tank(s)
- Probed outside tank(s) for "black soil"
- Unable to verify (See Comments/Explanation)
- Other methods not listed (See Comments/Explanation)

Comments/Explanation:

1st tank is a cistern verified by camera, second tank probed no bottom

3. Other Compliance Conditions - Compliance component #3 of 5

- a. Maintenance hole covers are damaged, cracked, unsecured, or appear to be structurally unsound Yes* No Unknown
- b. Other issues (electrical hazards, etc.) to immediately and adversely impact public health or safety Yes* No Unknown

***System is an imminent threat to public health and safety.**

Explain:

- c. System is non protective of groundwater for other conditions as determined by the inspector Yes* No

***System is failing to protect groundwater**

Explain:

4. Soil Separation - Compliance component #4 of 5

Date of installation: _____ Unknown
 (mm/dd/yyyy)

Shoreland/Wellhead Protection/Food, beverage, lodging? Yes No

Verification method(s)
Soil observation does not expire. Previous soil observations by two independent parties are sufficient, unless site conditions have been altered or local requirements differ.

Compliance Criteria:

For systems built prior to April 1, 1996, and not located in Shoreland or Wellhead Protection Area or not serving a food, beverage or lodging establishment. Yes No

Drainfield has at least a two-foot vertical separation distance from periodically saturated soil or bedrock.

- Conducted soil observation(s) (Attach boring logs)
- Two previous verifications (Attach boring logs)
- Not applicable (Holding tank(s), no drainfield)
- Unable to verify (See Comments/Explanation)
- Other (See Comments/Explanation)

Comments/Explanation:

no soil borrrings done because there is no drainfield the second tank is a cesspool

Non-performance systems built April 1, 1996, or later or for non-performance systems located in Shoreland or Wellhead Protection Areas or serving food, beverage or lodging establishment. Yes No

Drainfield has at least a three-foot vertical separation distance from periodically saturated soil or bedrock.

Indicate depths or elevations

A. Bottom of distribution media	
B. Periodically saturated soil/bedrock	
C. System separation	
D. Required compliance separation*	

"Experimental", "Other", or "Performance" systems built under pre-2008 Rules, Type IV or V systems built under 2008 Rules (7080.2350 or 7080.2400 (Advanced Inspector License required)) Yes No

Drainfield meets the designed vertical separation distance from periodically saturated soil or bedrock.

*May be reduced up to 15 percent if allowed by Local Ordinance

Any "no" answer above indicates the system is failing to protect groundwater.

5. Operating Permit and Nitrogen BMP - Compliance component #5 of 5

Not applicable

Is system operating under an Operating Permit? Yes No If "yes", A below is required.
 Is the system required to employ Nitrogen BMP? Yes No 3 If "yes", B below is required.

BMP = Best Management Practice(s) specified in the system design.

If the answer to both questions is "no", this section does not need to be completed.

Compliance Criteria:

a. Operating Permit number: _____ Yes No
 Have the Operating Permit requirements been met?
 b. Is the required nitrogen BMP in place and properly functioning? Yes No

Any "no" answer above indicates Noncompliance

Upgrade Requirements (Minn. Stat. § 115.55). An imminent threat to public health and safety (ITPHS) must be upgraded, replaced, or its use discontinued within ten months of receipt of this notice or within a shorter period if required by local ordinance. If the system is failing to protect groundwater, the system must be upgraded, replaced, or its use discontinued within the time required by local ordinance. If an existing system is not failing as defined in law, and has at least two feet of design soil separation, then the system need not be upgraded, repaired, replaced, or its use discontinued, notwithstanding any local ordinance that is more strict. This provision does not apply to systems in shoreland areas, Wellhead Protection Areas, or those used in connection with food, beverage, and lodging establishments as defined in law.

9 Apr 20

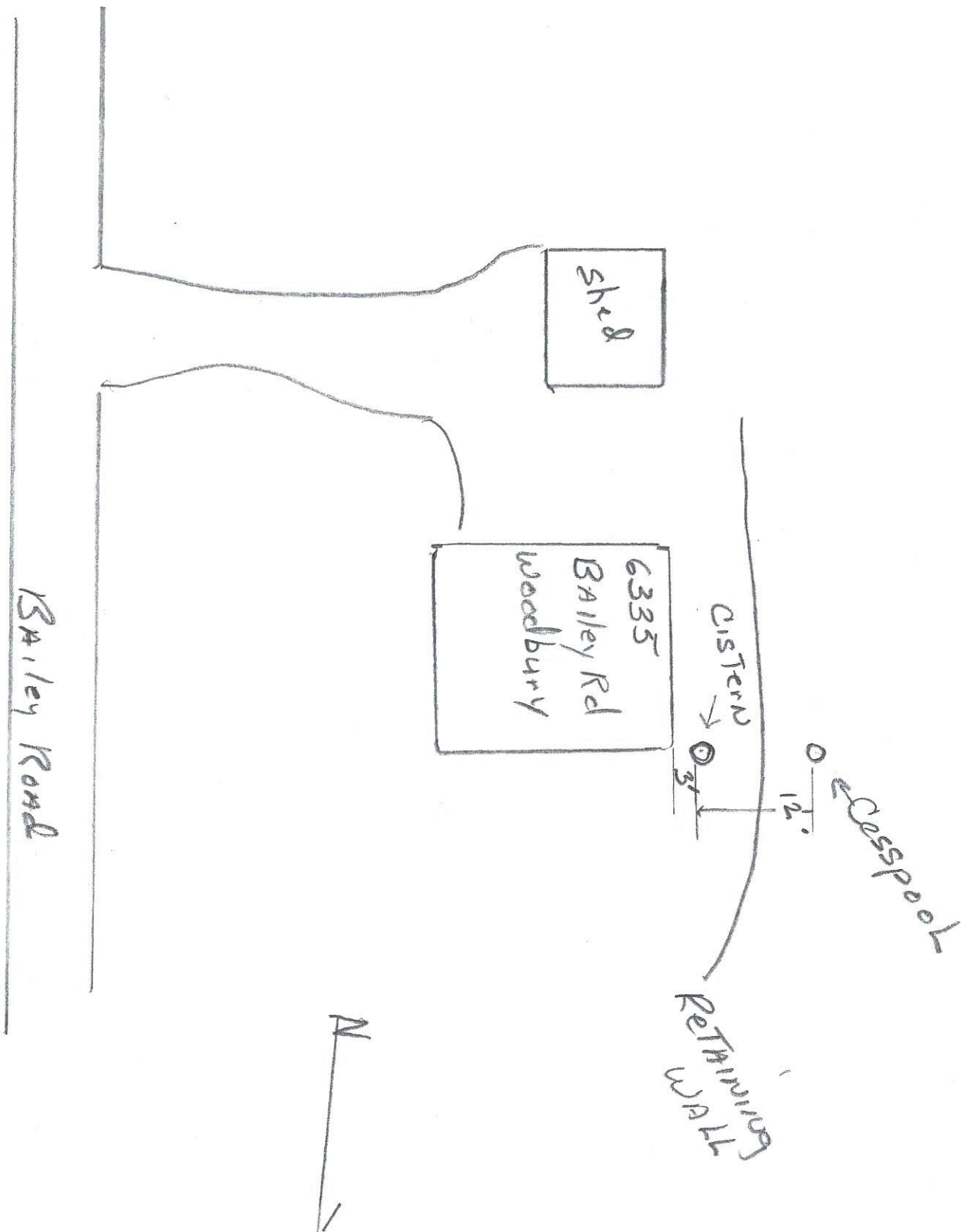

Date: 9 April 2020
Customer Name: Steve Engler
Street Address: 6335 Bailey Road
City, State, Zip: Woodbury Mn. 55129
Phone Number: 612-307-7169

Based on what we were able to observe and on our experience with on-site wastewater technology, we submit this Onsite Sewage Treatment System Inspection Report based on the present condition of the onsite sewage disposal system. Bob Friermuth has not been retained to warrant, guarantee, or certify the proper functioning of the system for any period of time in the future. Because of the numerous factors (usage, soil characteristics, previous failures, etc.) which may affect the proper operation of a septic system, this report shall not be construed as a warranty by our company that the system will function properly for any particular buyer. Bob Friermuth hereby DISCLAIMS ANY WARRANTY, either expressed or implied, arising from the inspection of the septic system or this report. We are not also ascertaining any affect the system is having on the groundwater.

Inspecting Company Bob Friermuth Phone 651 437-5566

License No: 818

Owners Signature

I have studied the information contained herein and certify that my assessment is honest, thorough, and to the best of my ability correct.

Name: Bob Friermuth / 
Title SSTS Inspector 818