



Minnesota Pollution Control Agency

520 Lafayette Road North
St. Paul, MN 55155-4194

Compliance Inspection Form

Existing Subsurface Sewage Treatment Systems (SSTS)

Doc Type: Compliance and Enforcement

Inspection results based on Minnesota Pollution Control Agency (MPCA) requirements and attached forms – additional local requirements may also apply.

Submit completed form to Local Unit of Government (LUG) and system owner within 15 days

For local tracking purposes:

System Status

System status on date (mm/dd/yyyy): 4/25/2020

Compliant – Certificate of Compliance
(Valid for 3 years from report date, unless shorter time frame outlined in Local Ordinance.)

Noncompliant – Notice of Noncompliance
(See Upgrade Requirements on page 3.)

Reason(s) for noncompliance (check all applicable)

- Impact on Public Health (Compliance Component #1) – *Imminent threat to public health and safety*
 - Other Compliance Conditions (Compliance Component #3) – *Imminent threat to public health and safety*
 - Tank Integrity (Compliance Component #2) – *Failing to protect groundwater*
 - Other Compliance Conditions (Compliance Component #3) – *Failing to protect groundwater*
 - Soil Separation (Compliance Component #4) – *Failing to protect groundwater*
 - Operating permit/monitoring plan requirements (Compliance Component #5) – *Noncompliant*

Property Information

Parcel ID# or Sec/Twp/Range: 06.030.21.43.0007

Property address: 6616 Indian Wells Trail Grant, MN 55110 Reason for inspection: routine

Property owner: Brian & Susannah Humpal Owner's phone: 651-492-7550

or
Owner's representative: _____ Representative phone: _____

Local regulatory authority: Washington County Regulatory authority phone: 651-430-6655

Brief system description: Two precast septic tanks and a rock trench drainfield.

Comments or recommendations:

Certification

I hereby certify that all the necessary information has been gathered to determine the compliance status of this system. No determination of future system performance has been nor can be made due to unknown conditions during system construction, possible abuse of the system, inadequate maintenance, or future water usage.

Inspector name: Tom Trooien Certification number: 323

Business name: All State Septic Services LLC License number: 1568

Inspector signature: Phone number: 612-594-4496

Necessary or Locally Required Attachments

- Soil boring logs
- System/As-built drawing
- Forms per local ordinance
- Other information (list): _____

1. Impact on Public Health – Compliance component #1 of 5

Compliance criteria:

System discharges sewage to the ground surface.	<input type="checkbox"/> Yes	<input checked="" type="checkbox"/> No
System discharges sewage to drain tile or surface waters.	<input type="checkbox"/> Yes	<input checked="" type="checkbox"/> No
System causes sewage backup into dwelling or establishment.	<input type="checkbox"/> Yes	<input checked="" type="checkbox"/> No

Any “yes” answer above indicates the system is an imminent threat to public health and safety.

Comments/Explanation:

Verification method(s):

- Searched for surface outlet
- Searched for seeping in yard/backup in home
- Excessive ponding in soil system/D-boxes
- Homeowner testimony (See Comments/Explanation)
- “Black soil” above soil dispersal system
- System requires “emergency” pumping
- Performed dye test
- Unable to verify (See Comments/Explanation)
- Other methods not listed (See Comments/Explanation)

2. Tank Integrity – Compliance component #2 of 5

Compliance criteria:

System consists of a seepage pit, cesspool, drywell, or leaching pit. <i>Seepage pits meeting 7080.2550 may be compliant if allowed in local ordinance.</i>	<input type="checkbox"/> Yes	<input checked="" type="checkbox"/> No
Sewage tank(s) leak below their designed operating depth. If yes, which sewage tank(s) leaks:	<input type="checkbox"/> Yes	<input checked="" type="checkbox"/> No

Any “yes” answer above indicates the system is failing to protect groundwater.

Comments/Explanation:

Reviewed pumping records. Tanks are at normal operating level.

Verification method(s):

- Probed tank(s) bottom
- Examined construction records
- Examined Tank Integrity Form (Attach)
- Observed liquid level below operating depth
- Examined empty (pumped) tanks(s)
- Probed outside tank(s) for “black soil”
- Unable to verify (See Comments/Explanation)
- Other methods not listed (See Comments/Explanation)

3. Other Compliance Conditions – Compliance component #3 of 5

- a. Maintenance hole covers are damaged, cracked, unsecured, or appear to be structurally unsound. Yes* No Unknown
- b. Other issues (electrical hazards, etc.) to immediately and adversely impact public health or safety. Yes* No Unknown
***System is an imminent threat to public health and safety.**

Explain:

- c. System is non-protective of ground water for other conditions as determined by inspector. Yes* No
***System is failing to protect groundwater.**

Explain:

4. Soil Separation – Compliance component #4 of 5

Date of installation: 9/8/1983 Unknown
(mm/dd/yyyy)

Shoreland/Wellhead protection/Food beverage lodging? Yes No

Compliance criteria:

For systems built prior to April 1, 1996, and not located in Shoreland or Wellhead Protection Area or not serving a food, beverage or lodging establishment: Yes No

Drainfield has at least a two-foot vertical separation distance from periodically saturated soil or bedrock.

Non-performance systems built April 1, 1996, or later or for non-performance systems located in Shoreland or Wellhead Protection Areas or serving a food, beverage, or lodging establishment: Yes No

Drainfield has a three-foot vertical separation distance from periodically saturated soil or bedrock.*

“Experimental”, “Other”, or “Performance” systems built under pre-2008 Rules; Type IV or V systems built under 2008 Rules (7080.2350 or 7080.2400 (Advanced Inspector License required) Yes No

Drainfield meets the designed vertical separation distance from periodically saturated soil or bedrock.

Verification method(s):

Soil observation does not expire. Previous soil observations by two independent parties are sufficient, unless site conditions have been altered or local requirements differ.

- Conducted soil observation(s) (Attach boring logs)
- Two previous verifications (Attach boring logs)
- Not applicable (Holding tank(s), no drainfield)
- Unable to verify (See Comments/Explanation)
- Other (See Comments/Explanation)

Comments/Explanation:

Indicate depths or elevations

A. Bottom of distribution media	
B. Periodically saturated soil/bedrock	
C. System separation	
D. Required compliance separation*	

*May be reduced up to 15 percent if allowed by Local Ordinance.

Any “no” answer above indicates the system is failing to protect groundwater.

5. Operating Permit and Nitrogen BMP* – Compliance component #5 of 5 Not applicable

Is the system operated under an Operating Permit? Yes No **If “yes”, A below is required**

Is the system required to employ a Nitrogen BMP? Yes No **If “yes”, B below is required**

BMP = Best Management Practice(s) specified in the system design

If the answer to both questions is “no”, this section does not need to be completed.

Compliance criteria

a. Operating Permit number: n/a Yes No
Have the Operating Permit requirements been met?

b. Is the required nitrogen BMP in place and properly functioning? Yes No

Any “no” answer indicates Noncompliance.

Upgrade Requirements (Minn. Stat. § 115.55) An imminent threat to public health and safety (ITPHS) must be upgraded, replaced, or its use discontinued within ten months of receipt of this notice or within a shorter period if required by local ordinance. If the system is failing to protect ground water, the system must be upgraded, replaced, or its use discontinued within the time required by local ordinance. If an existing system is not failing as defined in law, and has at least two feet of design soil separation, then the system need not be upgraded, repaired, replaced, or its use discontinued, notwithstanding any local ordinance that is more strict. This provision does not apply to systems in shoreland areas, Wellhead Protection Areas, or those used in connection with food, beverage, and lodging establishments as defined in law.

6616 INDIAN WELLS RD
GRANT, MN 55110

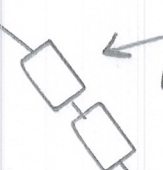
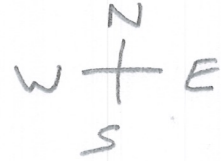

SEPTIC TANKS

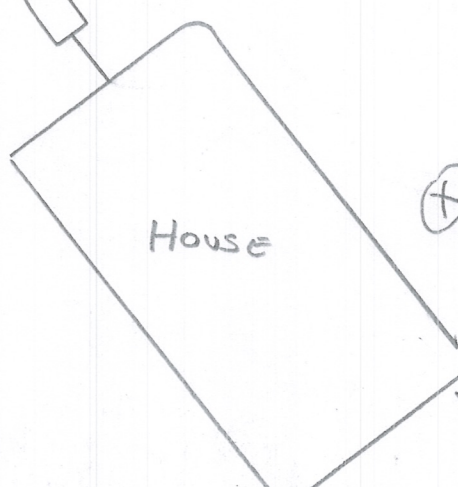

⊕ WELL

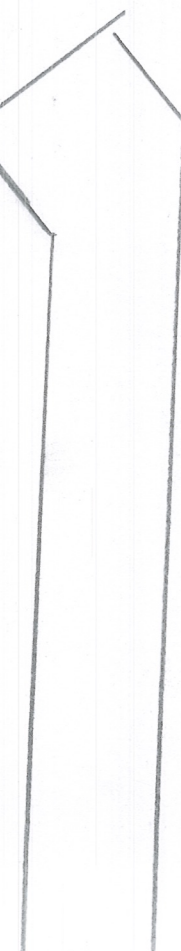

4/16/80

-SOIL BORINGS-

Soil borings are made in order to determine the type and structure of soils at various depths as well as the location of the water table, impervious strata or bedrock.

Borings are most easily made with a hand auger, however other expedients may be utilized - back hoe, post hole auger, etc.

Soils encountered at various depths should be listed as to appearance, texture and composition.

Depth at which water, bedrock or heavy clay layer is encountered should be recorded.

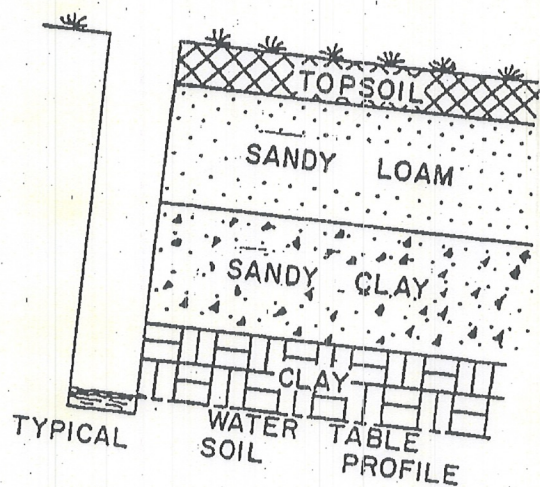

LOG OF SOIL BORINGS

BORING NO. 1		BORING NO. 2		BORING NO. 3		BORING NO. 4	
DEPTH IN FEET	SOIL DESCRIPTION	DEPTH IN FEET	SOIL DESCRIPTION	DEPTH IN FEET	SOIL DESCRIPTION	DEPTH IN FEET	SOIL DESCRIPTION
0		0		0		0	
1/2	LOAMY FINE SAND	1/2	SANDY LOAM	1/2	SANDY LOAM	1/2	SANDY LOAM
1		1		1		1	
1 1/2	LOAMY SAND	1 1/2	LOAMY SAND	1 1/2		1 1/2	
2		2		2		2	
2 1/2		2 1/2		2 1/2		2 1/2	
3	SILT	3	SILT	3	FINE SANDY LOAM	3	FINE SANDY LOAM
3 1/2	LOAM	3 1/2	LOAM	3 1/2		3 1/2	
4		4		4		4	
4 1/2		4 1/2		4 1/2		4 1/2	
5	SANDY LOAM	5	LOAMY SAND	5	TILL	5	TILL
5 1/2	* FINE SANDY LOAM	5 1/2	* SAND	5 1/2		5 1/2	
6		6	LOAMY FINE SAND	6		6	
6 1/2		6 1/2	OBSTRUCTION	6 1/2	OBSTRUCTION	6 1/2	
7		7		7		7	
7 1/2	* MOTTLED AT 63"	7 1/2	* MOTTLED AT 60"	7 1/2		7 1/2	
8		8		8		8	
8 1/2		8 1/2	H2O - 70" 4/10 H2O - 68" 4/17	8 1/2		8 1/2	
9		9		9		9	
						8 1/2	* LOAMY FINE SAND
						9	* MOTTLED AT 102"

APPLICATION FOR PERMIT TO INSTALL SEWAGE DISPOSAL SYSTEM
WASHINGTON COUNTY PLANNING DEPARTMENT

APR 28

1	Legal Description S $\frac{1}{2}$ -W $\frac{1}{2}$ -NW $\frac{1}{2}$ -SE $\frac{1}{2}$ Sec. 6, T30 N R21W			
2	Owner	Mail Address	City	Zip Phone
	Mr. Brian Gruden	Suite 204, 1310 E. Highway 96	White Bear Lake, Mn,	426-2747 55110
3	Tester	Mail Address	City	Zip Phone
	Roger Johnson			
4	Installer	Mail Address	City	Zip Phone
5	Use of Building:	Residential	Number of Bedrooms or Gallons Per Day	3*
6	Type of Work:	<input type="checkbox"/> New	<input type="checkbox"/> Alteration	<input type="checkbox"/> Repair <input checked="" type="checkbox"/> Approval Only
7	Has site previously been reviewed by Washington County? (If previously approved, attach letter of approval)	<input checked="" type="checkbox"/> No	<input type="checkbox"/> Yes	<input type="checkbox"/> Approved <input type="checkbox"/> Denied
<p>The following exhibits are required as a part of this application and shall be attached hereto: Percolation Test Logs; Soil Boring Logs; Site Plan drawn to scale showing location of Buildings, Lot Lines, Percolation Test Holes, Soil Boring Holes, Proposed Location of System, and Well. Also, the house and the drainfield area must be staked. One copy of the final building plan must be made available for review at the time application is processed. Improper or inadequate test or information will result in delays in processing.</p> <p>Agreement: The undersigned hereby makes Application for Permit to Install or Extend Sewage Disposal System herein specified, agreeing that all such work shall be done in strict accordance with ordinances and regulations of the County of Washington, Minnesota and Minnesota Department of Health. Applicant agrees that the Site Plan, Sketches, and Specifications submitted herewith, and which are approved by the Washington County Zoning Administrator, together with any requirement and/or restriction made necessary by conditions peculiar to a particular location, shall become a part of the permit. Applicant further agrees that no part of the system shall be covered until it has been inspected and accepted. Application is for an installation at a specific location on the site; any deviation from the approved location will cause the permit to become void. It shall be the responsibility of the applicant for the permit to notify the Office of the Zoning Administrator that the installation is ready for inspection.</p>				
DATE		SIGNATURE OF APPLICANT		

FOR OFFICE USE ONLY

Reviews: Planner: _____ Inspector: ALB Date: 5-27-80

Soil Boring Evaluation: Depth to Water Table, Seasonal Water Table (Mottled Soil), Impervious Layer or Bedrock:

Soils Map Data:	Percolation Test Evaluation:
Topography: <u>Stage</u>	Pump System Required: <input type="checkbox"/> Yes <input type="checkbox"/> No
Setbacks:	Required (circle) Actual
Well (including adjacent property)	50', 75'
Lake, Pond, Stream, River, or Bluffline	40', 75', 100', 150', 200'
Buildings (including adjacent property)	20'
Property Lines	10'

Conclusions:
Site Suitable: Site Unsuitable: Additional Tests Required: Verify No. Bedrooms:

Avoid B1 + B2 - Move up Hill

FEE: \$ 25⁰⁰

WASHINGTON COUNTY, MINNESOTA

Sewage Treatment Permit No. 3073

Inspection of Installation Must Be Made By the Building Official Before Any Portion of System Is Covered
Contact Planning Department, 439-3220 x-176, 24 HOUR NOTICE REQUIRED

Owner BRIAN COLEMAN
Property Description S 1/2 - W 1/4 - NW 1/4 - SE 1/4 Sec 6 T30N R21W
Property Address _____

Use of Building: Home Flow Rate: 4 B.R./6006 PA Percolation Rate: 40 mpi
Septic Tank 1200 Gal. Liquid Capacity Lift Station (if needed) 1000 Gal.

Type of System: SHALLOW SYSTEM TRENCH (B-1 AND B-2)
Absorption Trench — Square Feet 1200 Lineal Feet 400 Width 36

Depth of Rock Below Lines 12 Inches. Above Lines 2 Inches
Depth of Trench From Existing Grade — Minimum 20 Inches, Maximum 42 Inches *

Recommended Number of Lines 4 @ 100 (Note: Maximum Length of Individual Line Is 100 Feet.)
Minimum Spacing of Lines 7 1/2 Ft. Center to Center

Special Conditions SYSTEM TO BE INSTALLED TESTED AND INSPECTED PER ATTACHED
SITE PLAN. LINE FROM HOUSE TO SEPTIC TANK TO BE CAST IRON. SYSTEM
SHOULD BE MIN. 18" DIA. WITH TUBING BEING B-1 AND B-2; OR 4" DIA. TUBING
MUST BE INSTALLED IN SHALLOW AT THIS LOCATION MAXIMUM DEPTH OF
TRENCH 24" *

PERMIT: Permission is hereby granted to the above named applicant to perform the work described in the application to the minimum specifications shown above and per attached site plan. This permit is granted upon express condition that the person to whom it is granted, and his agents, employees and workmen shall conform in all respects to ordinances of Washington County, Minnesota. This permit may be revoked at any time upon violation of any said ordinance, and permit shall be void if work is not commenced within six (6) months.
INSTALLER MUST HOLD CURRENT SEPTIC INSTALLER LICENSE WITH WASHINGTON COUNTY.

Approved: Keith Wille Date 6-24-83
Zoning Administrator/Authorized Agent

Comments OK mostly as shown 4 lines 100' apart
look for top 2 lines 2 days before (landmark)
Installation Approved R. Cole Date 7-8-83
Inspector

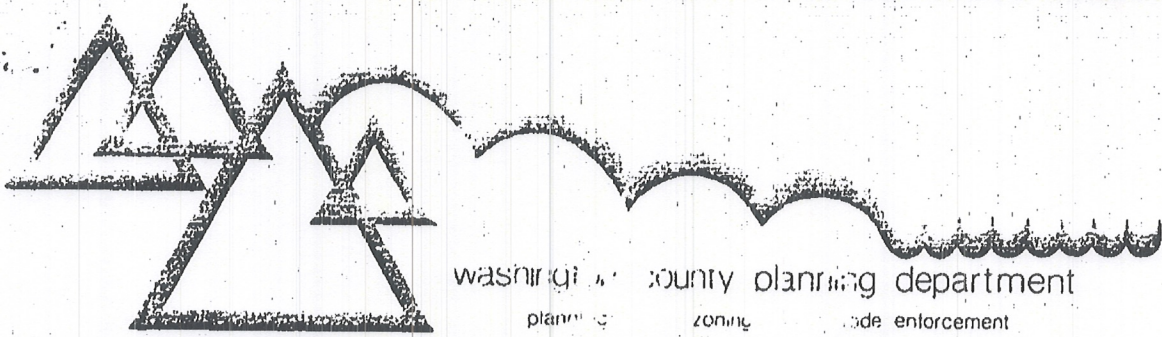

May 30, 1980

Brian Grudem
1310 E. Highway 96
White Bear Lake, MN 55110

Dear Brian,

We have reviewed the soil tests you submitted and have inspected your site described as $S\frac{1}{2}$ - $W\frac{1}{4}$ - $NW\frac{1}{4}$ - $SE\frac{1}{4}$, Section 6, T30N, R21W, Grant Township. It appears that the soils in the area tested are suitable under present codes for the installation of an on-site sewage disposal system.

We will withhold final approval until we receive verification of house size, permit application and final site plan showing house and drainfield location in relation to lot lines, well, and other important topography.

If you have any questions, please do not hesitate to contact me.

Sincerely,

A. Borsheim

Alan M. Borsheim
Building Inspector

AMB/mlp

cc: Roger Johnson