

No well at time
of Installation
9/23/97
Installed By Benson
Septic
Service
18070 218th SE E
Welch, MN
55089
438-9910

* NO property lines *
within 50' of system

Depth of Trench 20-28"

2-1000 gal
septic tanks
manhole low 1st tank
At grade, chained and
locked.

1/2" Inspection
wells

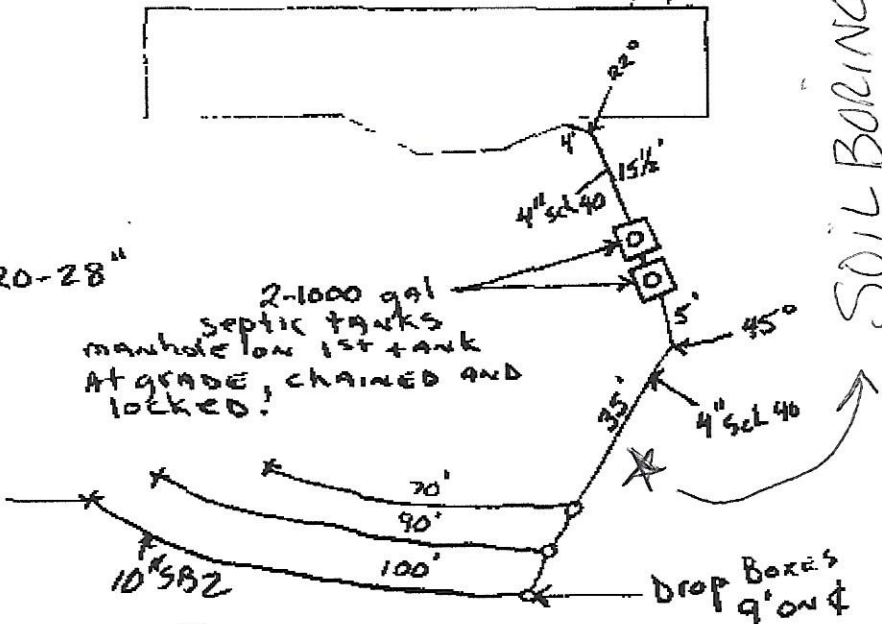

SOIL BORING
FOR COMPLIANCE INSPECTION

17680 LAMAR A.O.
Cottage GROVE RESERVE