Midwest Sewer Services

P.O. Box 10853 White Bear Lake, MN 55110
651-492-7550/Brian@Midwestsoiltesting.com

Brian Humpal
MPCA Licensed Advanced Inspector

SUBSURFACE SEWAGE TREATMENT SYSTEM (SSTS) COMPLIANCE REPORT

Date: January 18, 2021

Time: 9:45 AM

Owner: Lance Smith

Inspection Address: 16864 Jeffrey Ave N, Hugo, MN

Site Conditions: 7" Snow 5" Frost

REPORT SUMMARY

I have performed an "MPCA Compliance Inspection" on this system and have reviewed the original design/permit records on file at Washington County. This system consists of two pre-cast septic tanks, a pre-cast lift tank, and a mound. Meyer Sewer Service pumped the septic tanks and lift tank on January 18, 2021.

Predicated on my inspection of the system and my review of the original design/permit records, it is my opinion that this system presently meets MPCA minimum compliance inspection requirements.

Midwest Sewer Services have been hired to perform a compliance inspection of this SSTS for compliance with local ordinances pursuant to Minn. Stat. § 115.55 (2013). This compliance inspection covers only the criteria required by Minn. Stat. § 115.55 Subd. 5a (2013) and Minn. R. 7080.1500 (2011). A compliance inspection is an indication of the current compliance status of the system and does not guarantee the performance or longevity of this system beyond the date of inspection, as it is impossible to determine the future performance of any system. Midwest Sewer Services disclaim any use of this compliance inspection beyond determining SSTS compliance pursuant to Minn. Stat. § 115.55 Subd. 5a (2013) and Minn. R. 7080.1500 (2011).

Please contact me should you have any questions.



Christopher Uebe

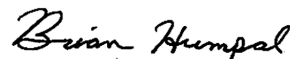

Brian Humpal

NOTE: This report is not complete without the inclusion/attachment of the additional pages which consist of up to three (3) MPCA drafted Compliance Inspection Documents, one (1) Homeowner/Occupant Information Sheet (when obtainable), one (1) site diagram, one (1) log of soil boring(s), one (1) Brian L Humpal, Inc. Disclaimer Sheet, and one (1) MPCA License.

Instructions: Inspection results based on Minnesota Pollution Control Agency (MPCA) requirements and attached supporting documentation – additional local requirements may also apply. Further information can be found here: <https://www.pca.state.mn.us/sites/default/files/wq-wwists4-31a.pdf>.

Inspector must submit completed form to Local Governmental Unit (LGU) and system owner within 15 days of final determination of compliance or noncompliance.

Property information

Local tracking number: _____

Parcel ID# or Sec/Twp/Range: _____ Local regulatory authority: Washington County

Property address: 16864 Jeffrey Ave N, Hugo, MN 55038

Owner/representative: Lance Smith Owner's phone: 651-587-9361

Brief system description: Two pre-cast septic tanks, a pre-cast lift tank, and a mound.

System status

System status on date (mm/dd/yyyy): 1/18/2021

Compliant – Certificate of compliance*

(Valid for 3 years from report date unless evidence of an imminent threat to public health or safety requiring removal and abatement under section 145A.04, subdivision 8 is discovered or a shorter time frame exists in Local Ordinance.)

***Note: Compliance indicates conformance with Minn. R. 7080.1500 as of system status date above and does not guarantee future performance.**

Noncompliant – Notice of noncompliance

An imminent threat to public health and safety (ITPHS) must be upgraded, replaced, or its use discontinued within ten months of receipt of this notice or within a shorter period if required by local ordinance or under section 145A.04 subdivision 8.

Systems failing to protect ground water must be upgraded, replaced, or use discontinued within the time required by local ordinance.

Reason(s) for noncompliance (check all applicable)

- Impact on public health (Compliance component #1) – *Imminent threat to public health and safety*
- Tank integrity (Compliance component #2) – *Failing to protect groundwater*
- Other Compliance Conditions (Compliance component #3) – *Imminent threat to public health and safety*
- Other Compliance Conditions (Compliance component #3) – *Failing to protect groundwater*
- System not abandoned according to Minn. R. 7080.2500 (Compliance component #3) – *Failing to protect groundwater*
- Soil separation (Compliance component #5) – *Failing to protect groundwater*
- Operating permit/monitoring plan requirements (Compliance component #4) – *Noncompliant - local ordinance applies*

Comments or recommendations

Certification

I hereby certify that all the necessary information has been gathered to determine the compliance status of this system. No determination of future system performance has been nor can be made due to unknown conditions during system construction, possible abuse of the system, inadequate maintenance, or future water usage.

By typing my name below, I certify the above statements to be true and correct, to the best of my knowledge, and that this information can be used for the purpose of processing this form.

Business name: Midwest Sewer Services

Certification number: C5342/C9852

Inspector signature: Brian Humpal

License number: L2896

(This document has been electronically signed)

Phone: 651-492-7550

Necessary or locally required supporting documentation (must be attached)

- Soil observation logs
- Locally required forms
- Tank Integrity Assessment
- Operating Permit
- Other information (list):

Report Summary, Property Information, Disclaimer, License

1. Impact on public health – Compliance component #1 of 5

Compliance criteria:

System discharges sewage to the ground surface	<input type="checkbox"/> Yes* <input checked="" type="checkbox"/> No
System discharges sewage to drain tile or surface waters.	<input type="checkbox"/> Yes* <input checked="" type="checkbox"/> No
System causes sewage backup into dwelling or establishment.	<input type="checkbox"/> Yes* <input checked="" type="checkbox"/> No

Any "yes" answer above indicates the system is an imminent threat to public health and safety.

Describe verification methods and results:

None of the above found.

Attached supporting documentation:

- Other: _____
- Not applicable

2. Tank integrity – Compliance component #2 of 5

Compliance criteria:

System consists of a seepage pit, cesspool, drywell, leaching pit, or other pit?	<input type="checkbox"/> Yes* <input checked="" type="checkbox"/> No
Sewage tank(s) leak below their designed operating depth?	<input type="checkbox"/> Yes* <input checked="" type="checkbox"/> No
If yes, which sewage tank(s) leaks:	

Any "yes" answer above indicates the system is failing to protect groundwater.

Describe verification methods and results:

Attached supporting documentation:

- Pumped at time of inspection
- Name of maintenance business: Meyer Sewer Service
- License number of maintenance business: L915
- Date of maintenance: 1/18/2021
- Existing tank integrity assessment (Attach)
- Date of maintenance (mm/dd/yyyy): _____ (must be within three years)
- (See form instructions to ensure assessment complies with Minn. R. 7082.0700 subp. 4 B (1))
- Tank is Noncompliant (pumping not necessary – explain below)
- Other: _____

3. Other compliance conditions – Compliance component #3 of 5

3a. Maintenance hole covers appear to be structurally unsound (damaged, cracked, etc.), or unsecured?

Yes* No Unknown

3b. Other issues (*electrical hazards, etc.*) to immediately and adversely impact public health or safety? Yes* No Unknown

***Yes to 3a or 3b - System is an imminent threat to public health and safety.**

3c. System is non-protective of ground water for other conditions as determined by inspector? Yes* No

3d. System not abandoned in accordance with Minn. R. 7080.2500? Yes* No

***Yes to 3c or 3d - System is failing to protect groundwater.**

Describe verification methods and results:

Attached supporting documentation: Not applicable _____

4. Operating permit and nitrogen BMP* – Compliance component #4 of 5 Not applicable

Is the system operated under an Operating Permit? Yes No **If “yes”, A below is required**

Is the system required to employ a Nitrogen BMP specified in the system design? Yes No **If “yes”, B below is required**

BMP = Best Management Practice(s) specified in the system design

If the answer to both questions is “no”, this section does not need to be completed.

Compliance criteria:

a. Have the operating permit requirements been met? Yes No

b. Is the required nitrogen BMP in place and properly functioning? Yes No

Any “no” answer indicates noncompliance.

Describe verification methods and results:

Attached supporting documentation: Operating permit (Attach) _____

5. Soil separation – Compliance component #5 of 5

Date of installation 2014 Unknown
(mm/dd/yyyy)

Shoreland/Wellhead protection/Food beverage lodging? Yes No

Compliance criteria (select one):

5a. For systems built prior to April 1, 1996, and not located in Shoreland or Wellhead Protection Area or not serving a food, beverage or lodging establishment: Yes No*

Drainfield has at least a two-foot vertical separation distance from periodically saturated soil or bedrock.

5b. Non-performance systems built April 1, 1996, or later or for non-performance systems located in Shoreland or Wellhead Protection Areas or serving a food, beverage, or lodging establishment: Yes No*

Drainfield has a three-foot vertical separation distance from periodically saturated soil or bedrock.*

5c. "Experimental", "Other", or "Performance" systems built under pre-2008 Rules; Type IV or V systems built under 2008 Rules 7080.2350 or 7080.2400 (Advanced Inspector License required) Yes No*

Drainfield meets the designed vertical separation distance from periodically saturated soil or bedrock.

Attached supporting documentation:

- Soil observation logs completed for the report (Attach)
- Two previous verifications of required vertical separation (Attach)
- Not applicable (No soil treatment area)
- Reviewed design and permit records.

Indicate depths or elevations

A. Bottom of distribution media	See Attached Boring Log(s)
B. Periodically saturated soil/bedrock	
C. System separation	
D. Required compliance separation*	

*May be reduced up to 15 percent if allowed by Local Ordinance.

***Any "no" answer above indicates the system is failing to protect groundwater.**

Describe verification methods and results:

Upgrade requirements: (Minn. Stat. § 115.55) An imminent threat to public health and safety (ITPHS) must be upgraded, replaced, or its use discontinued within ten months of receipt of this notice or within a shorter period if required by local ordinance. If the system is failing to protect ground water, the system must be upgraded, replaced, or its use discontinued within the time required by local ordinance. If an existing system is not failing as defined in law, and has at least two feet of design soil separation, then the system need not be upgraded, repaired, replaced, or its use discontinued, notwithstanding any local ordinance that is more strict. This provision does not apply to systems in shoreland areas, Wellhead Protection Areas, or those used in connection with food, beverage, and lodging establishments as defined in law.

Midwest Sewer Testing

Subsurface Sewage Treatment System Owner/Property Information

This information will be used for the purpose of conducting an MPCA Compliance Inspection.

Date of Inspection: January 18, 2021		Time: 9:45 AM	
Property Address: 16864 Jeffrey Ave N, Hugo, MN		Zip: 55038	
Property Owner: Lance Smith		Phone: 651-587-9361	
Tank(s) <input checked="" type="checkbox"/> Septic 2 <input type="checkbox"/> Aerobic <input checked="" type="checkbox"/> Lift <input type="checkbox"/> Holding <input type="checkbox"/> Other: _____	Tank(s)Material <input type="checkbox"/> Fiberglass <input type="checkbox"/> Plastic <input type="checkbox"/> Metal <input checked="" type="checkbox"/> Concrete <input type="checkbox"/> Block <input type="checkbox"/> Other _____	Soil Treatment System <input type="checkbox"/> Rock trench <input type="checkbox"/> Gravelless trench <input type="checkbox"/> Chamber trench <input type="checkbox"/> Seepage bed <input checked="" type="checkbox"/> Mound <input type="checkbox"/> At-grade _____	Other <input type="checkbox"/> Alternative system _____ <input type="checkbox"/> Experimental system _____ <input type="checkbox"/> Cesspool system _____ <input type="checkbox"/> Other system _____
Are the tank maintenance covers accessible? <input checked="" type="checkbox"/> Yes <input type="checkbox"/> No *If no, proper maintenance must be performed through the maintenance holes. Maintenance hole covers should be made accessible to the ground surface to facilitate access and proper maintenance of the system.			
Year house built: 2014	Year septic installed: 2014	Tank size (gals.): 1500, 1000	
How long has seller owned the property?		Number of residents in home?	
Number of bedrooms? 2	Are all floors drained by gravity? Y		
Garbage disposal?	Whirlpool bath?		
More than one system (laundry, etc.)?			
Does this property have any footing drain tiles connected to the septic system?			
Are any buildings on this property such as garages or out-buildings connected to this system?			
Are there any additional systems on this property serving other buildings?			
Location of septic system on lot? East Side			
Location of water well on lot? Southeast Side		Is the well a deep well? Y	
Have you ever experienced any problems with the system such as: tree roots, sewage back-ups, surfacing of sewage onto the ground, septic tank overflowing, etc.; or have any repairs been made to the system? If yes, explain:			
When was the system last pumped? 1/18/2021		Name of pumper: Meyer Sewer Service	
How often pumped in previous years?		Is system on a monitoring plan?	
Have you received notices from any government agency concerning this system?			
Is your property located in a shoreland management area? N			
Do you have any additional information that should be given to the new owner?			

I hereby certify that the above information is correct to the best of my knowledge. I also understand that if the system is considered "non-compliant/failing" per MPCA rules, that the inspector must by law submit a copy of this report to the local government unit within 15 days of the date of inspection completion. I also agree that unless otherwise noted in this report, that I/we are ultimately responsible for payment of all fees for all work performed relative to this inspection by Inspect Minnesota and Midwest Soil Testing

Owner/Occupant: _____

Date: _____

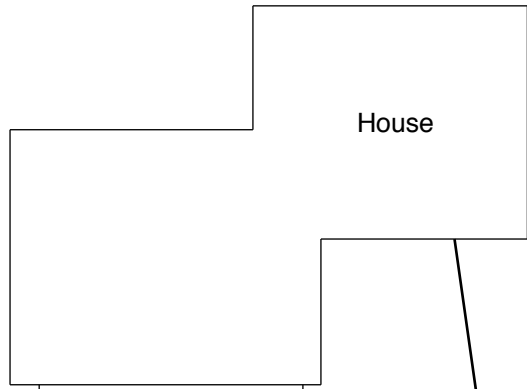

House

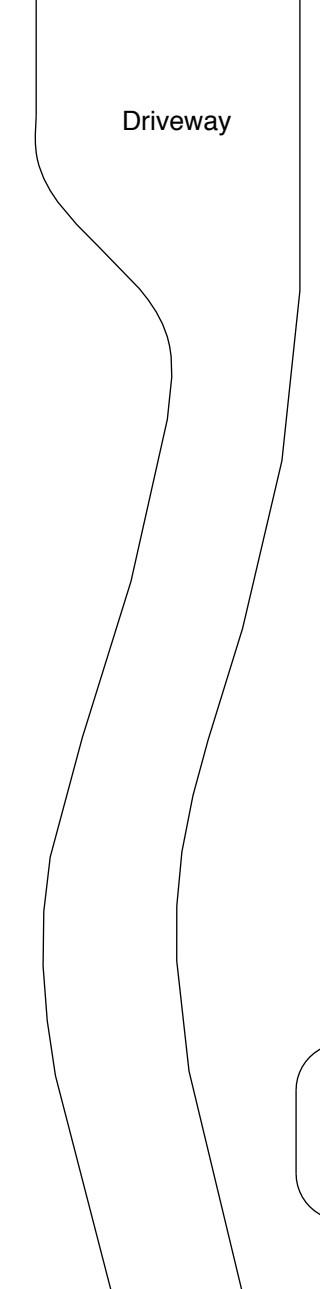

Driveway

Well ○



Septic Tanks



Lift Tank

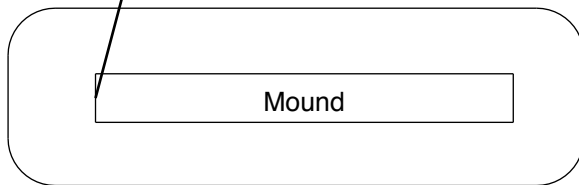

Mound

N →

NO SCALE

16864 Jeffrey Ave N, Hugo, MN 55038

UNIVERSITY OF MINNESOTA
 16864 Jeffrey Ave
 Onsite Sewage Treatment Program Soil Observation Log

Client/Address: 1678x Jeffrey Ave
 Date: 2/20/14
 Legal Description/GPS: _____
 Soil Parent Material(s): Till Outwash Lacustrine Alluvium Loess Organic Matter Bedrock
 (circle all that apply)
 Landscape Position: Summit Shoulder Back/Side Slope Foot Slope Toe Slope Slope Shape: Convex
 (circle one)
 Vegetation: _____ Soil Survey Map Unit(s): Kgs107 342 Slope (%): 10% to west
 Weather conditions/Time of Day: 15:30-4:00 Observation #/Location/Method: _____ Elevation: _____

Depth (in)	Texture	Rock Frag %	Matrix Color(s)	Mottle Color(s)	Redox Kind(s)	Saturated Soil indicator(s) (see back)	Structure Shape	Structure Grade	Consistency
0-5	Loamy sand	N	10 3/3	N	Concentrations Depletions Gleyed	Granular Platy Blocky Prismatic Single Grain Massive	Weak Moderate Strong Loose	Loose Firm Extremely Firm Rigid	
5-36 76" OBS	Fine sand	N	10 4/4	N	Concentrations Depletions Gleyed	Granular Platy Blocky Prismatic Single Grain Massive	Weak Moderate Strong Loose	Loose Firm Extremely Firm Rigid	
					Concentrations Depletions Gleyed	Granular Platy Blocky Prismatic Single Grain Massive	Weak Moderate Strong Loose	Loose Firm Extremely Firm Rigid	
					Concentrations Depletions Gleyed	Granular Platy Blocky Prismatic Single Grain Massive	Weak Moderate Strong Loose	Loose Firm Extremely Firm Rigid	
					Concentrations Depletions Gleyed	Granular Platy Blocky Prismatic Single Grain Massive	Weak Moderate Strong Loose	Loose Firm Extremely Firm Rigid	

Comments: D.B. 3' 3" show no frost 12" mound OK
 Certified Statement: I hereby certify that I have completed this work in accordance with all applicable ordinances, rules and laws.
 (Designer) _____ (Signature) _____ (License #) _____ (Date) 2/20/14

Tradewell Soil Testing
 18330 Dahlia Street NW
 Cedar, MN 55011

Name: Cameron Homes, Inc. Date: January 29th, 2014
 Address: XXXXX Jeffrey Avenue North, Hugo, MN

SOIL BORING TEST REPORT

Boring #1			
0'-4"	Topsoil		
4'-36"	Loamy Fine Sand		
	10YR 2/2		
	Loamy Fine Sand & Rock		
	10YR 3/4 4/4		
36"-44"	Sandy Loam & Gravel		
	10YR 3/6		
	Faint Mottles @ 36"		
	Dry Hole		

Soil borings and perc tests performed by Eklin Soil Testing are being used for the septic design at above address. Additional soil borings will be done to verify site as soon as weather permits before installation of system takes place. See attached site plan and design based on criteria from Eklin Soil Testing.

Mark Tradewell
 MPCA #307

JOB KRISTI HOFF
 7618X JEFFERY AVE N.
 HUGO

BORING LOC

DATE 6-20-2007

SEPTIC SYSTEM BORINGS BOREHOLE DIAMETER 4" 3 3/8" 2 1/2"

DEPTH FEET	BOLE # 1	BOLE # 2	BOLE # 3	BOLE # 4	BOLE # 5	BOLE # 6
	TOP SOIL SANDY	TOP SOIL FINE SAND	TOP SOIL LOAMY SAND	TOP SOIL SAND	TOP SOIL FINE SAND	TOP SOIL FINE SAND
1	BROWN MEDIUM SAND	BROWN FINE SAND	BROWN LOAMY SAND	BROWN FINE SAND	BROWN FINE SAND	BROWN FINE SAND
2	ROCKS			BROWN FINE SAND	BROWN FINE SAND	BROWN FINE SAND
3	BROWN MEDIUM SAND	BROWN LOAMY SAND	BROWN FINE TO MEDIUM SAND	MOTTLED SOIL	REDDISH BROWN SANDY CLAY	ROCKS
4	IRON STOP	BROWN MEDIUM SAND		MOTTLED SOIL	MOTTLED SOIL	CAVING STOP
5	IRON 34"	STOP		18"	STOP	OK 40" +
6	SOIL	MOTTLED SOIL 42"		LOW BORING	MOTTLED SOIL 28"	
7	CELSIUS PLACER TOP SOIL BROWN SAND & LOAM 7.5 YR 3/4		STOP MOTTLED SOIL 56"			
8	REDDISH BROWN SAND & LOAM 7.5 YR 5/4					
9	BROWN SAND 7.5 YR 4/4					

JOB KRISTI HOFF
 7618X JEFFERY AVE N.
 HUGO

BORING LOC

DATE 6-20-2007

HOUSE BORINGS BOREHOLE DIAMETER 4" 3 3/8" 2 1/2"

DEPTH FEET	BOLE # 1	BOLE # 2	BOLE # 3	BOLE # 4	BOLE # 5	BOLE # 6
	TOP SOIL SANDY	TOP SOIL FINE SAND				
1	BROWN MEDIUM SAND	BROWN FINE SAND				
2	REDDISH BROWN SANDY CLAY	REDDISH BROWN SANDY CLAY				
3	REDDISH BROWN SANDY CLAY	REDDISH BROWN SANDY CLAY				
4	IRON STOP	IRON STOP				
5	IRON 34"	IRON 34"				
6	STOP	STOP				
7	OK 6 FT	OK 6'				

DISCLAIMER

Brian L. Humpal, Inc. dba. Midwest Sewer Services, Inspect Minnesota, Midwest Soil Testing Relative to Subsurface Sewage Treatment System (SSTS) Compliance Inspections

1. This inspection/report is being performed for only the seller/owner of the property on which the SSTS is located. In such case that another party is paying for the inspection, the contract is between only said party and Brian L. Humpal, Inc.; there is no contract between Brian L. Humpal, Inc. and any other party unless otherwise noted.
3. Brian L. Humpal, Inc. has not been retained to warranty, guarantee, or certify the proper functioning of the SSTS for any period of time beyond the date of inspection or into the future. Because of the numerous factors (usage, maintenance, soil characteristics, previous failures, etc.) which may affect the proper operation of an SSTS, as well as the inability of Brian L. Humpal, Inc. to supervise or monitor the use or maintenance of the SSTS, the report shall not be construed as a warranty by Brian L. Humpal, Inc. that the SSTS will function properly for any particular party for any period of time.
4. Brian L. Humpal, Inc. is unable to verify the frequency and/or, quality of prior or future maintenance of the SSTS. Maintenance of the tank(s) must be performed through the tanks maintenance hole. The removal of solids from any location other than the maintenance hole is not a compliant method of maintenance. It is strongly recommended that maintenance covers be made accessible to the ground surface to facilitate proper maintenance.
5. Minimum Compliance Inspection requirements relative to this inspection and this report include only verification that the SSTS has tank(s) (septic tanks, lift tanks, dosing tanks, stilling tanks, etc.) which are watertight below the designed operating depth, the required separation between the bottom of the subsurface soil distribution medium and seasonally saturated soils, no back-ups of sewage into the dwelling, no discharge of sewage/effluent to the ground surface or surface waters, and no imminent safety hazards. Brian L. Humpal, Inc. does not inspect plumbing or pumps prior to the first SSTS component as these are plumbing components. The performance of exterior pumps and associated components are not inspected as they are considered to be maintenance items. Additionally, no indications relative to compliance with electrical code requirements have been made. It is recommended that any other applicable plumbing, electrical, housing, etc. inspections be performed by a qualified inspection business. Sewage back-up verification is limited to observing the floor drain area and/or the information supplied by the last occupants of the building prior to inspection. Brian L. Humpal, Inc. cannot guarantee that the information given to them by the last occupants of the building prior to inspection relative to back-ups is accurate.
4. Certification of this SSTS does not warranty future use beyond the date of the inspection. Any SSTS, old or new, can become hydraulically overloaded or discharge sewage/effluent to the ground surface as a result of more people moving into the house than were previously occupying the house, improper maintenance, heavy usage, leaking plumbing fixtures, groundwater infiltration, tree roots, freezing conditions, surface drainage problems, poor initial design, poor construction practices, or unsuitable materials used in constructing the system; the system can also simply stop working because of its age. An SSTS that has been properly designed and installed, properly maintained, and used in the manner for which the system was designed can be expected to provide service for twenty to twenty-five years on average. Some parts of the SSTS such as alarms, switches, pumps, filters, etc. will most likely have to be repaired or replaced over the lifetime of the system.
5. A Compliance Inspection is not meant to be a test or inspection for longevity of the system; a Compliance Inspection is strictly for the purpose of determining if the SSTS is protective of public health and safety, as well as the groundwater at the date and time the inspection was performed. This inspection is not intended to determine if the SSTS was originally designed or installed to past or present MPCA or other Local Government Unit code requirements. This inspection is not intended to determine if the SSTS was designed and/or installed to support the anticipated flow from the building as the use of the building may have changed since the design and construction of the SSTS due to the addition of bedrooms, occupants, etc. In addition, this inspection is not intended to determine the quality of the original SSTS design, the quality of the construction practices used while installing the SSTS, or the quality of the materials used in constructing the SSTS.
6. Brian L. Humpal, Inc. cannot guarantee the performance of SSTS products/components such as: gravelless pipe, chamber trenches, effluent filters, tanks, sewage pre-treatment components, piping, etc. Products such as gravelless pipe are no longer approved for installation in the State of Minnesota and may have a significantly reduced performance and/or life expectancy.
7. WINTER WORK: By accepting this report, it is understood that inspections conducted during winter months (approximately November 1st through April 1st) are more difficult to perform because of possible snow cover and/or ground frost. SSTS components such as tanks, maintenance covers, tank inspection pipes, subsurface distribution medium inspection pipes, and soil treatment areas are more difficult or impossible to locate due to snow cover and/or ground frost. In addition, soil borings are more difficult to perform due to snow cover and/or ground frost. Brian L. Humpal, Inc. will attempt to use the same level of standards when performing work during winter periods as when performing work during non-winter periods. However, the recipient of this report understands that because of the aforementioned considerations, the same level of standards may not be possible.
8. By accepting this report, the client understands that Brian L. Humpal, Inc. will not be responsible for any monetary damages exceeding the fee for the services provided.

Subsurface Sewage Treatment Systems

Non-transferable

Business License

Midwest Sewer Services

License # L2896

License Expires: 12/22/2020

Issued: 11/26/2019

Specialty Area(s):

Installer

Maintainer

Service Provider

Advanced Designer

Advanced Inspector

Designated Certified Individual(s):

Cert #	Name	Certification Expires:
C5342	Brian L Humpal Installer, Maintainer, Serv Prov, Adv Designer, Adv Inspector	10/15/2023
C9852	Christopher R Uebe Designer, Inspector	3/4/2021

 **MINNESOTA POLLUTION
CONTROL AGENCY**

520 Lafayette Road North
St. Paul, Minnesota 55155-4194

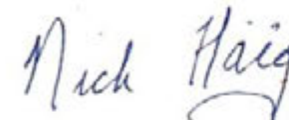

Nick Haig, Supervisor
Certification and Training Unit