



Minnesota Pollution Control Agency

520 Lafayette Road North
St. Paul, MN 55155-4194

Compliance Inspection Form
Existing Subsurface Sewage Treatment Systems (SSTS)

Doc Type: Compliance and Enforcement

Inspection results based on Minnesota Pollution Control Agency (MPCA) requirements and attached forms - additional local requirements may also apply.

For local tracking purposes:

Submit completed form to Local Unit of Government (LUG) and system owner within 15 days

System Status

System status on date (mm/dd/yyyy): 1/19/2021

[X] Compliant - Certificate of Compliance
(Valid for 3 years from report date, unless shorter time frame outlined in Local Ordinance.)

[] Noncompliant - Notice of Noncompliance
(See Upgrade Requirements on page 3.)

Reason(s) for noncompliance (check all applicable)

- [] Impact on Public Health (Compliance Component #1) - Imminent threat to public health and safety
[] Other Compliance Conditions (Compliance Component #3) - Imminent threat to public health and safety
[] Tank Integrity (Compliance Component #2) - Failing to protect groundwater
[] Other Compliance Conditions (Compliance Component #3) - Failing to protect groundwater
[] Soil Separation (Compliance Component #4) - Failing to protect groundwater
[] Operating permit/monitoring plan requirements (Compliance Component #5) - Noncompliant

Property Information

Parcel ID# or Sec/Twp/Range: 0303020320009

Property address: 15038 113th St Ct N. Sittlwater, Mn Reason for inspection: Property Transfer

Property owner: Km Ziton Realty Owner's phone: 651-428-1121

Owner's representative: Representative phone:

Local regulatory authority: Washington County Regulatory authority phone: 651-430-6655

Brief system description: 2 septic tanks and 1 pump tank to drainfield

Comments or recommendations:

Certification

I hereby certify that all the necessary information has been gathered to determine the compliance status of this system. No determination of future system performance has been nor can be made due to unknown conditions during system construction, possible abuse of the system, inadequate maintenance, or future water usage.

Inspector name: Dave Brown Certification number: 9370

Business name: David R Brown License number: 3649

Inspector signature: [Signature] Phone number: 651.788.3296

Necessary or Locally Required Attachments

- [X] Soil boring logs [X] System/As-built drawing [] Forms per local ordinance
[] Other information (list):

1. Impact on Public Health – Compliance component #1 of 5

Compliance criteria:

System discharges sewage to the ground surface.	<input type="checkbox"/> Yes <input checked="" type="checkbox"/> No
System discharges sewage to drain tile or surface waters.	<input type="checkbox"/> Yes <input checked="" type="checkbox"/> No
System causes sewage backup into dwelling or establishment.	<input type="checkbox"/> Yes <input checked="" type="checkbox"/> No

Any "yes" answer above indicates the system is an imminent threat to public health and safety.

Comments/Explanation:

Verification method(s):

- Searched for surface outlet
- Searched for seeping in yard/backup in home
- Excessive ponding in soil system/D-boxes
- Homeowner testimony (See Comments/Explanation)
- "Black soil" above soil dispersal system
- System requires "emergency" pumping
- Performed dye test
- Unable to verify (See Comments/Explanation)
- Other methods not listed (See Comments/Explanation)

2. Tank Integrity – Compliance component #2 of 5

Compliance criteria:

System consists of a seepage pit, cesspool, drywell, or leaching pit. <i>Seepage pits meeting 7080.2550 may be compliant if allowed in local ordinance.</i>	<input type="checkbox"/> Yes <input checked="" type="checkbox"/> No
Sewage tank(s) leak below their designed operating depth. If yes, which sewage tank(s) leaks:	<input type="checkbox"/> Yes <input checked="" type="checkbox"/> No

Any "yes" answer above indicates the system is failing to protect groundwater.

Comments/Explanation:

Verification method(s):

- Probed tank(s) bottom
- Examined construction records
- Examined Tank Integrity Form (Attach)
- Observed liquid level below operating depth
- Examined empty (pumped) tanks(s)
- Probed outside tank(s) for "black soil"
- Unable to verify (See Comments/Explanation)
- Other methods not listed (See Comments/Explanation)

3. Other Compliance Conditions – Compliance component #3 of 5

- a. Maintenance hole covers are damaged, cracked, unsecured, or appear to be structurally unsound. Yes* No Unknown
- b. Other issues (electrical hazards, etc.) to immediately and adversely impact public health or safety. Yes* No Unknown
***System is an imminent threat to public health and safety.**

Explain:

- c. System is non-protective of ground water for other conditions as determined by inspector. Yes* No
***System is failing to protect groundwater.**

Explain:

4. Soil Separation – Compliance component #4 of 5

Date of installation: _____ Unknown
(mm/dd/yyyy)

Shoreland/Wellhead protection/Food beverage lodging? Yes No

Compliance criteria:

For systems built prior to April 1, 1996, and not located in Shoreland or Wellhead Protection Area or not serving a food, beverage or lodging establishment: Drainfield has at least a two-foot vertical separation distance from periodically saturated soil or bedrock.	<input checked="" type="checkbox"/> Yes <input type="checkbox"/> No
Non-performance systems built April 1, 1996, or later or for non-performance systems located in Shoreland or Wellhead Protection Areas or serving a food, beverage, or lodging establishment: Drainfield has a three-foot vertical separation distance from periodically saturated soil or bedrock.*	<input checked="" type="checkbox"/> Yes <input type="checkbox"/> No
"Experimental", "Other", or "Performance" systems built under pre-2008 Rules; Type IV or V systems built under 2008 Rules (7080.2350 or 7080.2400 (Advanced Inspector License required) Drainfield meets the designed vertical separation distance from periodically saturated soil or bedrock.	<input type="checkbox"/> Yes <input type="checkbox"/> No

Verification method(s):

Soil observation does not expire. Previous soil observations by two independent parties are sufficient, unless site conditions have been altered or local requirements differ.

- Conducted soil observation(s) (Attach boring logs)
- Two previous verifications (Attach boring logs)
- Not applicable (Holding tank(s), no drainfield)
- Unable to verify (See Comments/Explanation)
- Other (See Comments/Explanation)

Comments/Explanation:

Indicate depths or elevations

A. Bottom of distribution media	36"
B. Periodically saturated soil/bedrock	72"
C. System separation	36"
D. Required compliance separation*	36"

*May be reduced up to 15 percent if allowed by Local Ordinance.

Any "no" answer above indicates the system is failing to protect groundwater.

5. Operating Permit and Nitrogen BMP* – Compliance component #5 of 5 Not applicable

Is the system operated under an Operating Permit? Yes No **If "yes", A below is required**

Is the system required to employ a Nitrogen BMP? Yes No **If "yes", B below is required**

BMP = Best Management Practice(s) specified in the system design

If the answer to both questions is "no", this section does not need to be completed.

Compliance criteria

a. Operating Permit number: _____ Have the Operating Permit requirements been met?	<input type="checkbox"/> Yes <input type="checkbox"/> No
b. Is the required nitrogen BMP in place and properly functioning?	<input type="checkbox"/> Yes <input type="checkbox"/> No

Any "no" answer indicates Noncompliance.

Upgrade Requirements (Minn. Stat. § 115.55) An imminent threat to public health and safety (ITPHS) must be upgraded, replaced, or its use discontinued within ten months of receipt of this notice or within a shorter period if required by local ordinance. If the system is failing to protect ground water, the system must be upgraded, replaced, or its use discontinued within the time required by local ordinance. If an existing system is not failing as defined in law, and has at least two feet of design soil separation, then the system need not be upgraded, repaired, replaced, or its use discontinued, notwithstanding any local ordinance that is more strict. This provision does not apply to systems in shoreland areas, Wellhead Protection Areas, or those used in connection with food, beverage, and lodging establishments as defined in law.

15038 113rd ST. CT. N. STILLWATER MN

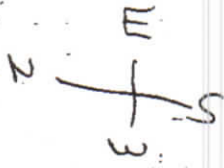

1500 gal. Septic tank
1000 gal. Septic tank
1500 gal. Pump tank

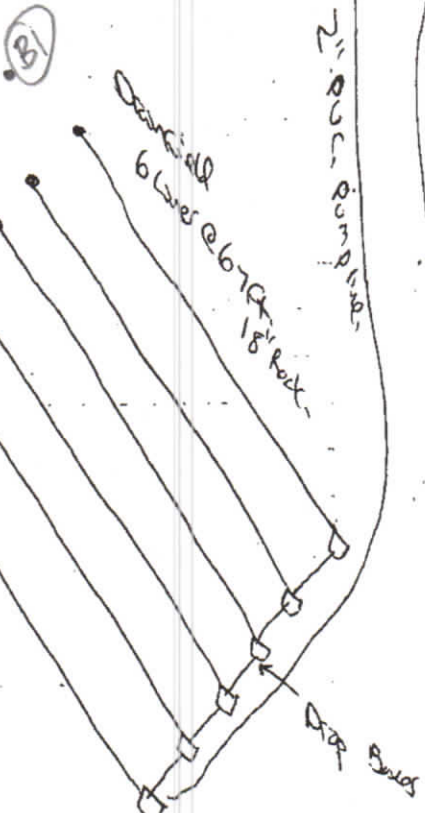
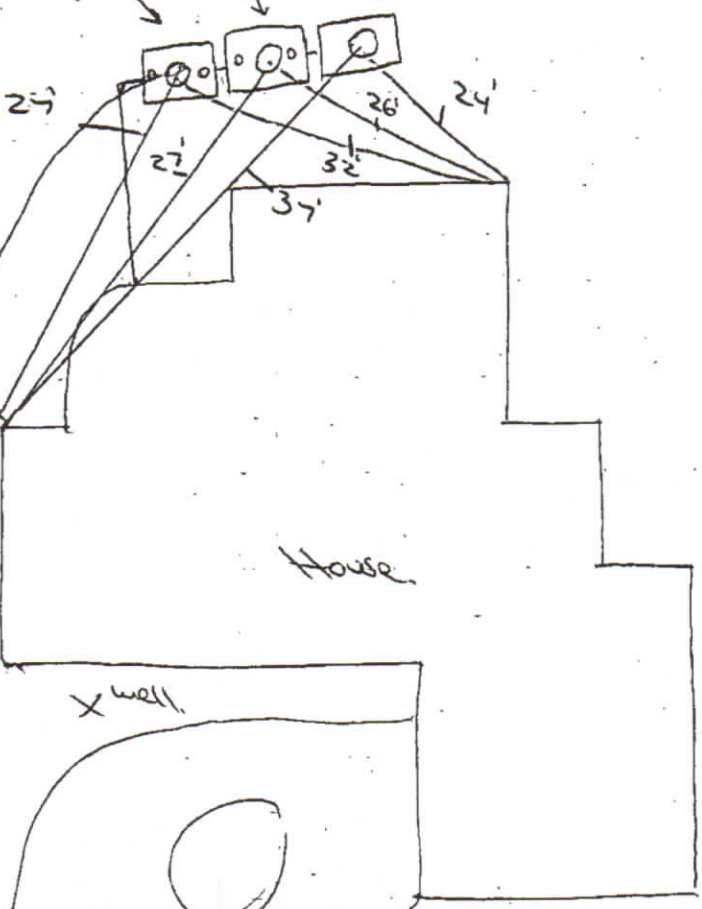

SOIL BORING LOG
(B1)
0" - 8" = 10YR 2.3/3 Fine Sand
8" - 24" = 10YR 5/4 SANDY LOAM
24" - 72" = 10YR 5/3 MEDIUM SAND



Tri-City / William Lloyd Analytical Laboratory

9300 Poplar Bridge Road • Bloomington, MN 55437 • (952) 563-4904

Dave Brown 4787 Radio Dr. Woodbury, MN 55129	Report Date: 01/21/2021 07:02
---	---

Received By: Bree Landherr	Sample Condition Upon Receipt:
Received Date / Time: 20-Jan-2021 8:39	<input type="checkbox"/> Acceptable Temperature <u>4.8</u> °C <input checked="" type="checkbox"/> On ice

Sample ID: 2101115-01
15038 113th St. Ct. N, Stillwater, MN
Sample Collector: Dave Brown
Collection Date/Time: 1/19/2021 9:03:00AM

Analyte	Result	Units	MCL*	PASS	Date Analyzed	Analyst Initials	Method
Nitrate as N	<0.0500	mg/L	10	PASS	01/20/2021	BL	EPA 353.2 Rev. 2.0
P/A total coliform	Absent	MPN/100 mL	Absent	PASS	01/20/2021	BL	SM 9223 B (Colilert-18® P/A)

*MCL (maximum contaminant level) set by the EPA

PASS - The analyte(s) reported, for the sample(s) listed above, meet standards set by the Minnesota Department of Health and U. S. Environmental Protection Agency for safe drinking water.

Approved By: *Deb Weltzin*

Deb Weltzin
Water Quality Supervisor

Laboratory Identification Number: 027-053-355

The results in this report apply to the above listed sample(s). All routine quality assurance procedures were followed, unless otherwise noted. This analytical report must be reported in its entirety. All methods are certified by the Minnesota Department of Health, unless otherwise noted. EPA 200.7 for the analysis of lead in drinking water is not certifiable by the MDH.