

Asbuilt for Chisago County



PLEASE PRINT INFORMATION

Location of Job 19855 Jeffery Circle N. New Work
 Owner J. Brown Homes Address _____ Replacement
 Licensed Installer Rick's Plumbing Designer Dele Eklun Addition
 Permit Validation CK M.O. CASH Check # _____ Receipt # _____

(Show location of house, tank, drainfield and property line.)

Location of well	Over 100'
Area of square footage of drainfield area	600
Depth of rock under pipe	9"
Depth of rock over pipe	2"
Depth of dirt over	18"
No. of bedrooms	
No. of tanks	3
Water table	
Outside lift <input checked="" type="checkbox"/>	
Injector <input type="checkbox"/>	
Gravity <input type="checkbox"/>	
Permit fee	
Surtax	
Tank fee	
Total	

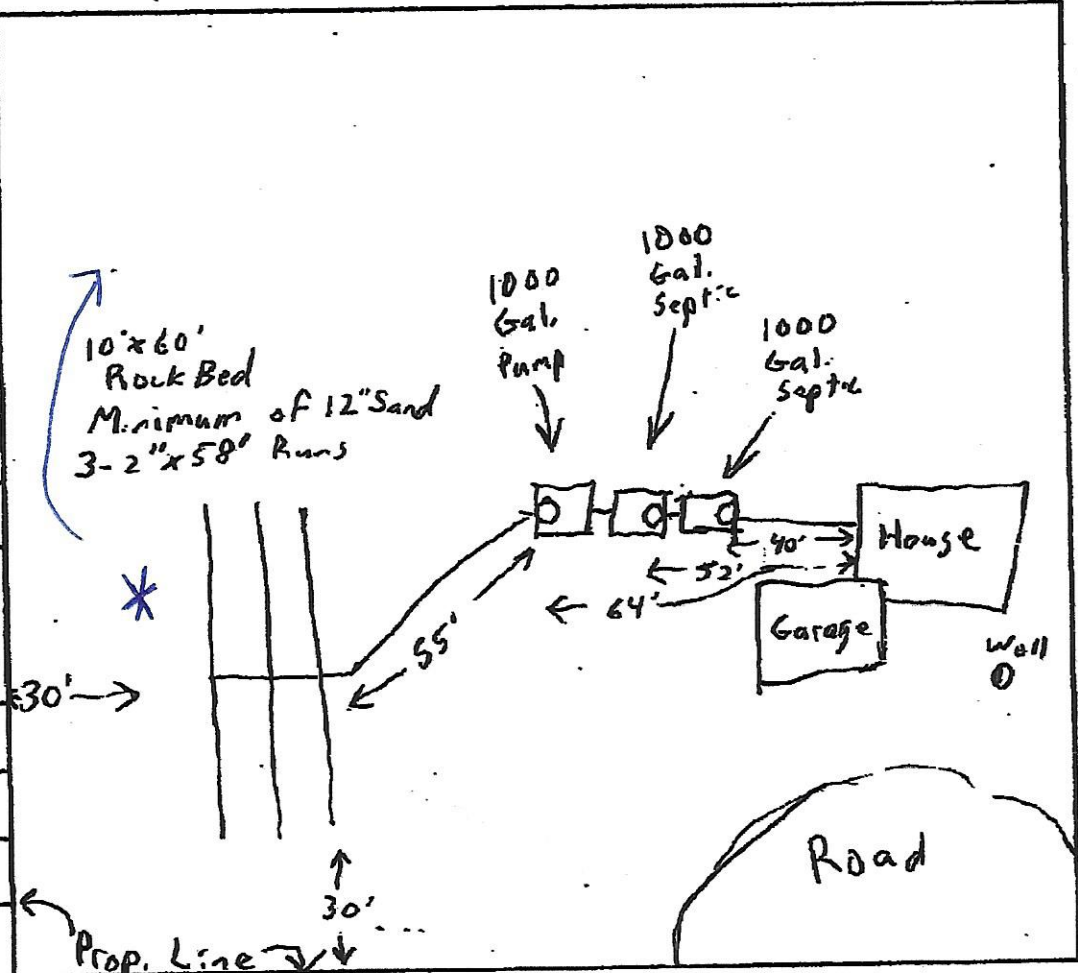

Signature [Signature] Licensed Installer Phone: 763-753-1935

Installer License #: L 2686

0600-05-12

Date 5-16-06

Issued By _____