

Instructions: Inspection results based on Minnesota Pollution Control Agency (MPCA) requirements and attached supporting documentation – additional local requirements may also apply. Further information can be found here: <https://www.pca.state.mn.us/sites/default/files/wq-wwists4-31a.pdf>.

Inspector must submit completed form to Local Governmental Unit (LGU) and system owner within 15 days of final determination of compliance or noncompliance.

Property information

Local tracking number: _____

Parcel ID# or Sec/Twp/Range: 3402821330002 Local regulatory authority: Washington County

Property address: 8930 Military Rd Woodbury, Mn. 55129

Owner/representative: Julie Wolterstorff Owner's phone: 651-230-5048

Brief system description: 2 septic tanks to gravity drainfield

System status

System status on date (mm/dd/yyyy): 6/1/2021

Compliant – Certificate of compliance*

(Valid for 3 years from report date unless evidence of an imminent threat to public health or safety requiring removal and abatement under section 145A.04, subdivision 8 is discovered or a shorter time frame exists in Local Ordinance.)

***Note: Compliance indicates conformance with Minn. R. 7080.1500 as of system status date above and does not guarantee future performance.**

Noncompliant – Notice of noncompliance

An imminent threat to public health and safety (ITPHS) must be upgraded, replaced, or its use discontinued within ten months of receipt of this notice or within a shorter period if required by local ordinance or under section 145A.04 subdivision 8.

Systems failing to protect ground water must be upgraded, replaced, or use discontinued within the time required by local ordinance.

Reason(s) for noncompliance (check all applicable)

- Impact on public health (Compliance component #1) – *Imminent threat to public health and safety*
- Tank integrity (Compliance component #2) – *Failing to protect groundwater*
- Other Compliance Conditions (Compliance component #3) – *Imminent threat to public health and safety*
- Other Compliance Conditions (Compliance component #3) – *Failing to protect groundwater*
- System not abandoned according to Minn. R. 7080.2500 (Compliance component #3) – *Failing to protect groundwater*
- Soil separation (Compliance component #5) – *Failing to protect groundwater*
- Operating permit/monitoring plan requirements (Compliance component #4) – *Noncompliant - local ordinance applies*

Comments or recommendations

System was installed with a permit from Washington County in 2008.

Certification

I hereby certify that all the necessary information has been gathered to determine the compliance status of this system. No determination of future system performance has been nor can be made due to unknown conditions during system construction, possible abuse of the system, inadequate maintenance, or future water usage.

By typing my name below, I certify the above statements to be true and correct, to the best of my knowledge, and that this information can be used for the purpose of processing this form.

Business name: David R Brown

Certification number: 9370

Inspector signature: DRB

License number: 3649

(This document has been electronically signed)

Phone: 651-788-3296

Necessary or locally required supporting documentation (must be attached)

- Soil observation logs
- Locally required forms
- Tank Integrity Assessment
- Operating Permit
- Other information (list): _____

1. Impact on public health – Compliance component #1 of 5

Compliance criteria:

System discharges sewage to the ground surface	<input type="checkbox"/> Yes* <input checked="" type="checkbox"/> No
System discharges sewage to drain tile or surface waters.	<input type="checkbox"/> Yes* <input checked="" type="checkbox"/> No
System causes sewage backup into dwelling or establishment.	<input type="checkbox"/> Yes* <input checked="" type="checkbox"/> No

Any "yes" answer above indicates the system is an imminent threat to public health and safety.

Describe verification methods and results:

Attached supporting documentation:

Other: _____

Not applicable

2. Tank integrity – Compliance component #2 of 5

Compliance criteria:

System consists of a seepage pit, cesspool, drywell, leaching pit, or other pit?	<input type="checkbox"/> Yes* <input checked="" type="checkbox"/> No
Sewage tank(s) leak below their designed operating depth?	<input type="checkbox"/> Yes* <input checked="" type="checkbox"/> No
If yes, which sewage tank(s) leaks:	

Any "yes" answer above indicates the system is failing to protect groundwater.

Describe verification methods and results:

Attached supporting documentation:

Pumped at time of inspection

Name of maintenance business: Pinkys

License number of maintenance business: 1673

Date of maintenance: 5/25/2021

Existing tank integrity assessment (Attach)

Date of maintenance (mm/dd/yyyy): _____ (must be within three years)

(See form instructions to ensure assessment complies with Minn. R. 7082.0700 subp. 4 B (1))

Tank is Noncompliant (pumping not necessary – explain below)

Other: _____

3. Other compliance conditions – Compliance component #3 of 5

3a. Maintenance hole covers appear to be structurally unsound (damaged, cracked, etc.), or unsecured?

Yes* No Unknown

3b. Other issues (*electrical hazards, etc.*) to immediately and adversely impact public health or safety? Yes* No Unknown

**Yes to 3a or 3b - System is an imminent threat to public health and safety.*

3c. System is non-protective of ground water for other conditions as determined by inspector? Yes* No

3d. System not abandoned in accordance with Minn. R. 7080.2500? Yes* No

**Yes to 3c or 3d - System is failing to protect groundwater.*

Describe verification methods and results:

Attached supporting documentation: Not applicable _____

4. Operating permit and nitrogen BMP* – Compliance component #4 of 5 Not applicable

Is the system operated under an Operating Permit? Yes No **If "yes", A below is required**

Is the system required to employ a Nitrogen BMP specified in the system design? Yes No **If "yes", B below is required**

BMP = Best Management Practice(s) specified in the system design

If the answer to both questions is "no", this section does not need to be completed.

Compliance criteria:

a. Have the operating permit requirements been met? Yes No

b. Is the required nitrogen BMP in place and properly functioning? Yes No

Any "no" answer indicates noncompliance.

Describe verification methods and results:

Attached supporting documentation: Operating permit (Attach) _____

5. Soil separation – Compliance component #5 of 5

Date of installation 8/8/2008 Unknown
(mm/dd/yyyy)

Shoreland/Wellhead protection/Food beverage lodging? Yes No

Compliance criteria (select one):

5a. For systems built prior to April 1, 1996, and not located in Shoreland or Wellhead Protection Area or not serving a food, beverage or lodging establishment: Yes No*

Drainfield has at least a two-foot vertical separation distance from periodically saturated soil or bedrock.

5b. Non-performance systems built April 1, 1996, or later or for non-performance systems located in Shoreland or Wellhead Protection Areas or serving a food, beverage, or lodging establishment: Yes No*

Drainfield has a three-foot vertical separation distance from periodically saturated soil or bedrock.*

5c. "Experimental", "Other", or "Performance" systems built under pre-2008 Rules; Type IV or V systems built under 2008 Rules 7080.2350 or 7080.2400 (Advanced Inspector License required) Yes No*

Drainfield meets the designed vertical separation distance from periodically saturated soil or bedrock.

***Any "no" answer above indicates the system is failing to protect groundwater.**

Describe verification methods and results:

Attached supporting documentation:

- Soil observation logs completed for the report (Attach)
- Two previous verifications of required vertical separation (Attach)
- Not applicable (No soil treatment area)
- _____

Indicate depths or elevations

A. Bottom of distribution media	36"
B. Periodically saturated soil/bedrock	72"
C. System separation	36"
D. Required compliance separation*	36"

*May be reduced up to 15 percent if allowed by Local Ordinance.

Upgrade requirements: (Minn. Stat. § 115.55) An imminent threat to public health and safety (ITPHS) must be upgraded, replaced, or its use discontinued within ten months of receipt of this notice or within a shorter period if required by local ordinance. If the system is failing to protect ground water, the system must be upgraded, replaced, or its use discontinued within the time required by local ordinance. If an existing system is not failing as defined in law, and has at least two feet of design soil separation, then the system need not be upgraded, repaired, replaced, or its use discontinued, notwithstanding any local ordinance that is more strict. This provision does not apply to systems in shoreland areas, Wellhead Protection Areas, or those used in connection with food, beverage, and lodging establishments as defined in law.



Department of Public Health and Environment
 14949 62nd Street North PO Box 6
 Stillwater MN 55082-0006
 Office: 651-430-6655 TTY: 651-430-6246 Fax: 651-430-6730

Review Fee:	\$260.00
Permit Fee:	\$270.00
Total Fee:	\$530.00
Previous Payment	\$530.00
Balance Due	\$0.00

Community: Woodbury
 Permit Number: 2500-08-1
 Owner: Dennis & Julieanne Wolterstorff
 8930 Military RD
 Woodbury MN 55129-9782
 Applicant: Ray Rumpca/ Rumpca Co., Inc.

*Scanned 7-31-08 Jm
 Mailed 8-1-08 Jm*

PERMISSION IS HEREBY GRANTED

To execute the work specified in this permit on the following identified property upon express condition that said persons and their agents, and employees shall conform in all respects to the provisions of Ordinance #128, Washington County Development Code, Chapter Four, Individual Sewage Treatment System Regulations. This permit may be revoked at any time upon violation of any of the provisions of said ordinance.

Project Address: 8930 Military RD
 Geo Code: 34-028-21-33-0002
 Designer: Brown's Soil Testing

2500-08-1

Type of System: Standard Drainfield		Pressure Distribution	
		N / A	
Design Criteria		Drainfield Sizing	
Percolation Rate:	3	Square Feet:	609
Depth To Restriction:	42	Lineal:	203 Feet
Land Slope:	2.00%	Depth Of Rock Below:	18 Inches
Flow Rate:	600	Maximum Trench Depth:	42 Inches
Number of Bedrooms:	4	Number Of Trenches:	6
Gravelless Chambered		Length Of Trenches:	51 Feet
		Spacing Of Trenches:	1 Feet
Tank Sizes			
Tank 1:	1000	Tank 2:	1000
Tank 3:	0	Lift Station:	0

Authorized Work/Special Conditions

1. Building sewer can be no closer than 20 feet from well and must be pressure tested Schedule 40 within 50 feet.
2. Domestic strength waste only. Industrial waste and hazardous wastes cannot enter the septic system.
3. Establish a vegetative cover over the soil treatment area within 30 days of the installation. Protect the soil treatment area from erosion until the vegetative cover is established.
4. Maximum trench depth 42 inches into natural soil.
5. Soil pit required before installation to verify soil conditions.
6. This system must be installed by a certified/licensed sewage treatment system installer holding a current license with the Minnesota Pollution Control Agency. (A list of installers is available at your request.)

Permit Issue Date: 7/31/2008
 Permit Expiration Date: 7/31/2009

Christopher W. LeClair, REHS
 Senior Environmental Specialist

Individual Sewage Treatment System Inspection Form

Project Address: 8930 Military RD		Application ID: 2500-08-1	
Community: Woodbury		Geo Code: 34-028-21-33-0002	
Owner: Dennis & Julieanne Wolterstorff		Type of System: Standard Drainfield	
Applicant: Ray Rumpca/ Rumpca Co., Inc.		Designer: Brown's Soil Testing	
Type of Installation: <input type="checkbox"/> New <input type="checkbox"/> Repair <input checked="" type="checkbox"/> Replacement <input type="checkbox"/> Other	Type of Inspection: <input type="checkbox"/> Site Review <input type="checkbox"/> Tank <input type="checkbox"/> Rough-Up <input type="checkbox"/> Treatment Area <input type="checkbox"/> Final	Inspector: <input type="checkbox"/> Pete Ganzel <input checked="" type="checkbox"/> Chris LeClair <input type="checkbox"/> Other	
Number of Bedrooms: _____	Inspection Dates: <u>8 AVE 2008</u>		

Installer: RAY RUMPCA

Site Review	Mounds / At-Grade
Date: _____	<input type="checkbox"/> Mound <input type="checkbox"/> At-Grade Absorption Area _____
<input type="checkbox"/> Soil Boring <input type="checkbox"/> Soil Pit	Percent Slope _____ Sand Below Bed _____
Depth of Pit/Boring _____	Upslope Width _____ Rock Below Pipe _____
Comments _____	Downslope Width _____ Perf Size/Spacing _____
	Sideslope Width _____ Pipe Size/Spacing _____
	Pressure Bed Dimensions: Length _____ Width _____

Sewage / Holding Tanks	Pump Information
Tank 1 <u>1000</u> <input checked="" type="checkbox"/> New <input type="checkbox"/> Existing	Lift Station Capacity _____ Feet of Head _____
Baffle Type <input type="checkbox"/> Plastic <input type="checkbox"/> Fiberglass <input type="checkbox"/> San-T <input type="checkbox"/> Concrete	Horsepower/GPM _____ Size of Discharge Line: _____
Tank 2 <u>1000</u> <input type="checkbox"/> New <input type="checkbox"/> Existing	Gallons Per Cycle _____ Type/Location or Alarm _____
	Gallons Per Minute _____

Trenches, Bed or Gravelless Drainfield	Setbacks
<input checked="" type="checkbox"/> Drop Box <input type="checkbox"/> Distribution Box <input checked="" type="checkbox"/> Gravity <input type="checkbox"/> Pump Trench <input type="checkbox"/> Pressure Bed	Building(s) to tanks <u>>10</u>
<input type="checkbox"/> Serial <input type="checkbox"/> Parallel <input type="checkbox"/> Chambers <input type="checkbox"/> Gravelless <input type="checkbox"/> 8" <input type="checkbox"/> 10"	Building(s) to drainfield <u>>20</u>
Trench Depth (in) T1 <u>36-42</u> Trench Length (ft) T1 <u>73</u>	Surface Water <u>J/A</u>
T2 _____ T2 <u>70</u>	Property Lines <u>10'</u>
T3 _____ T3 <u>70</u>	Wells <input checked="" type="checkbox"/> 50' <input type="checkbox"/> 100'
T4 _____ T4 _____	
T5 _____ T5 _____	
Trench Width <input type="checkbox"/> 24" <input checked="" type="checkbox"/> 36" <input type="checkbox"/> Other _____	
Trench Spacing _____	
Rock Below Pipe <input type="checkbox"/> 6" <input checked="" type="checkbox"/> 12" <input checked="" type="checkbox"/> 18" <input type="checkbox"/> 24"	
Pressure Bed Dimensions: Length _____ Width _____ Absorption Area _____	

Comments: No Rock in tank Holes - ok at design 2/15
Plan 8/17/08

TANKS INSULATED TO R-10

BUILDING SEWER INSULATED TO R-10

Inspector _____

ENTERED
8/29/08
DM

30 Jul 2008 13:30

BORING BETWEEN B1 : B2

44° 51' 45.404"N
92° 55' 06.878"W

0" - 8"	SILT LOAM	10 YR 3/2	SBK
8" - 15"	SILT LOAM	10 YR 4/3	SBK
15" - 26"	FINE SAND	10 YR 4/3	SE
26" - 38"	SAND	10 YR 4/4	SE
38"	- OBSTRUCTION		

SOIL PIT TO DETERMINE SOURCE OF
OBSTRUCTION

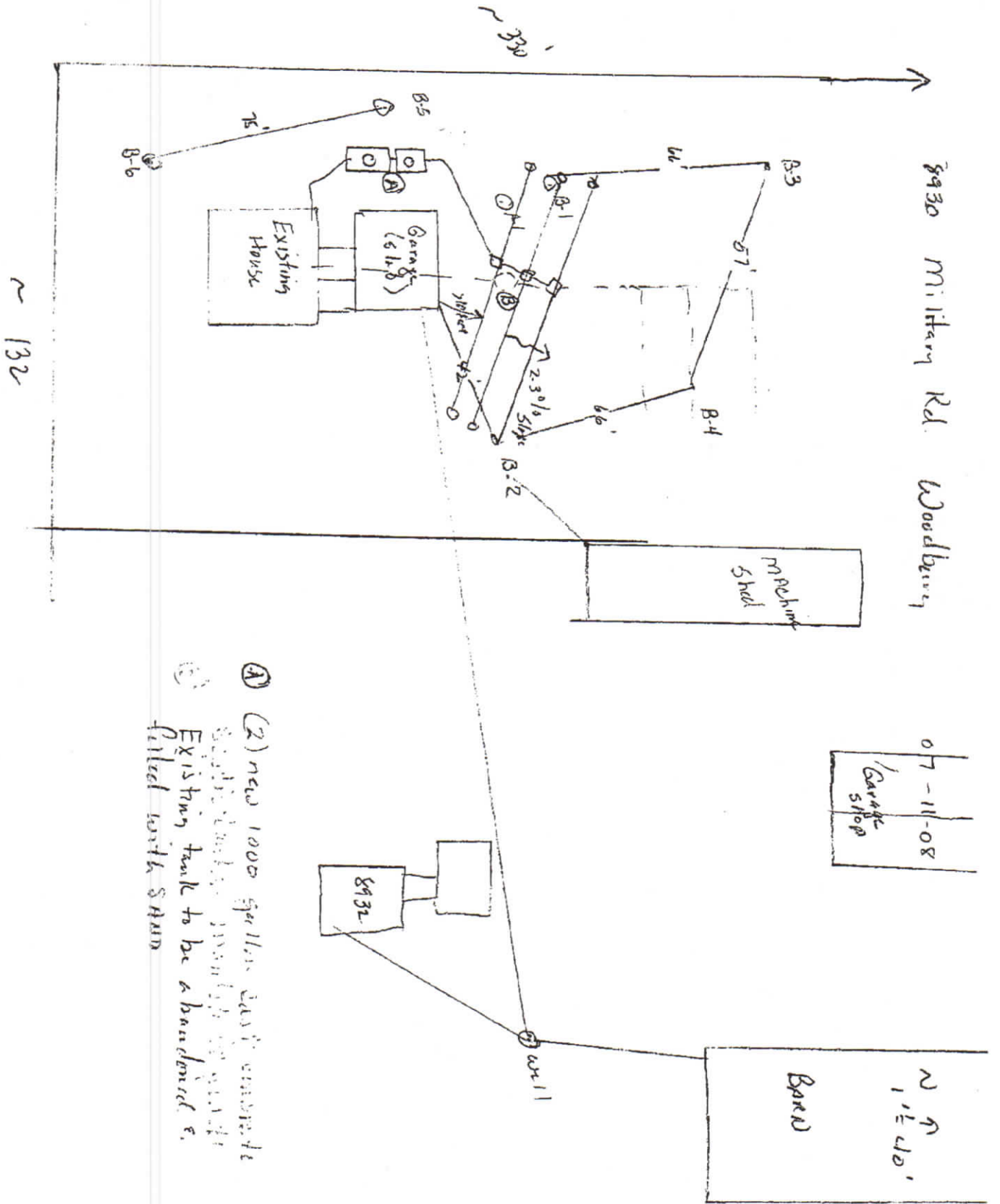

LOG OF SOIL BORINGS

Job: 8930 Military Road, Woodbury

Date: 07-09-08

Depth In Feet	B1	B2	B3	B4
1	dark brown silt loam topsoil 9 medium to yellow brown silt loam 10yr 5/6 20	black silt loam topsoil 14 yellow brown very fine silt 14	medium to dark brown silt loam topsoil 10 black loam 10yr 2/1 30	dark brown silt loam 10yr 3/3 14 dark brown loam 10yr 3/3 32
2	medium brown medium and coarse sand-gravel 10yr 4/3 54	medium brown sand and gravel 10yr 4/3 48	dark red brown silty clay loam 5yr 4/3 60	sandy clay loam 48
3	medium brown medium sand 10yr 4/3 64	medium brown sand and gravel 10yr 4/3 48	dark red brown silty clay loam 5yr 4/3 60	sandy clay loam 48
4	medium brown medium sand 10yr 4/3 78	medium brown sand and gravel 10yr 4/3 48	dark red brown silty clay loam 5yr 4/3 60	sandy clay loam 48
5	medium brown medium sand 10yr 4/3 78	medium brown sand and gravel 10yr 4/3 48	dark red brown silty clay loam 5yr 4/3 60	sandy clay loam 48
6	medium brown medium sand 10yr 4/3 78	medium brown sand and gravel 10yr 4/3 48	dark red brown silty clay loam 5yr 4/3 60	sandy clay loam 48
7	medium brown medium sand 10yr 4/3 78	medium brown sand and gravel 10yr 4/3 48	dark red brown silty clay loam 5yr 4/3 60	sandy clay loam 48

LOG OF SOIL BORINGS

Job: 8930 Military Road, Woodbury

Date: 07-09-08

Depth In Feet	B5 B4	B6 B2	B3	B1
1	black loam topsoil	dark brown silt loam -fill-	10yr ³ / ₃	B
2	red brown sandy silt loam 6yr ⁴ / ₃	black loam topsoil		
3				
4	medium brown medium sand		4R	
5	10yr ⁴ / ₃			
6	70			
7	red brown sandy Clay loam 6yr ⁴ / ₃			

91

Dennis Wolterstorff 651-459-4528
8930 Military Rd Woodbury

Installed by
Rumpca Co's

651-459-1556

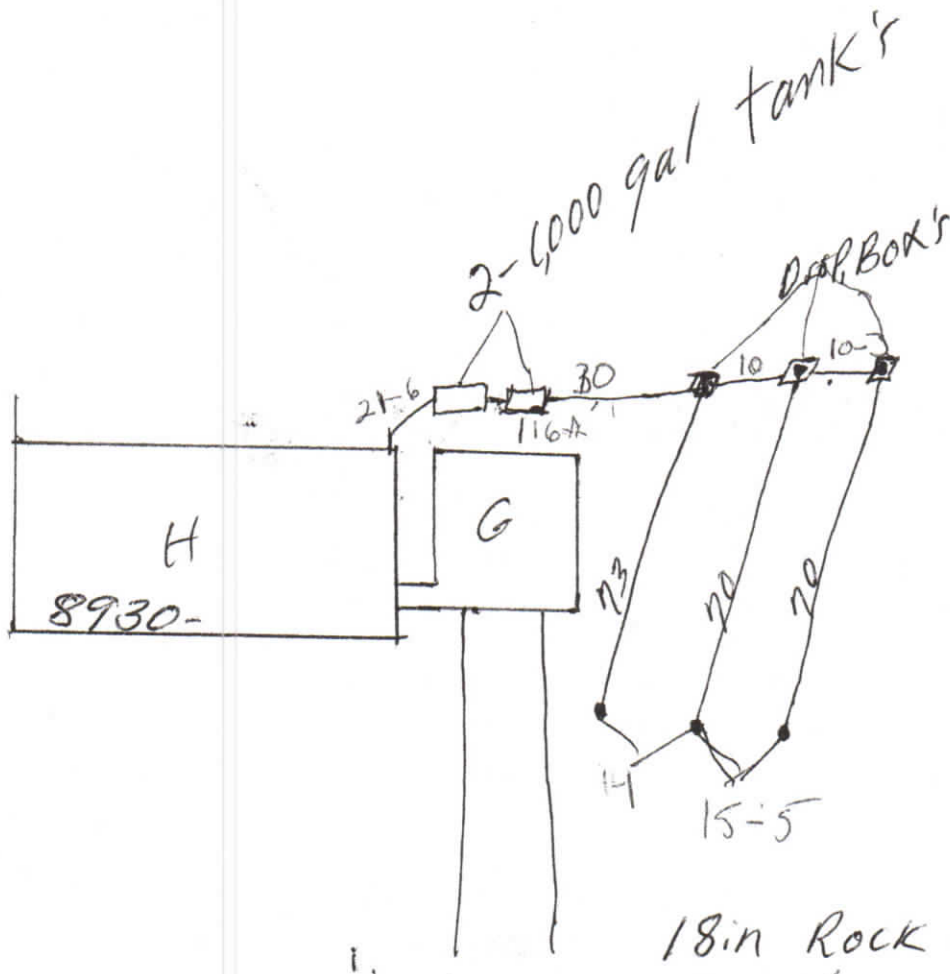



Department of Public Health and Environment

14949 62nd Street North PO Box 6
Stillwater MN 55082-0006
Office: 651-430-6655 – TTY: 651-430-6246 – Fax: 651-430-6730

Individual Sewage Treatment System Certificate of Compliance

Type of System:	Standard Drainfield
Permit Number:	2500-08-1
Property ID Number:	34-028-21-33-0002
Property Address:	8930 Military RD
Community:	Woodbury
Date of Installation:	August 8, 2008

This certifies that the individual sewage treatment system installed at the aforementioned address was inspected during installation and found to be in compliance with requirements of the Washington County Development Code, Chapter Four, Individual Sewage Treatment System Regulations (Washington County Ordinance No. 128). This Certificate of Compliance is valid for five (5) years from the date of issuance unless Washington County finds evidence of an imminent threat to public health and safety. Supporting documentation with detailed information on the system can be found on the attached as-built.

Christopher W. LeClair, REHS
Senior Environmental Specialist