

# Compliance inspection report form

## Existing Subsurface Sewage Treatment System (SSTS)

Doc Type: Compliance and Enforcement

**Instructions:** Inspection results based on Minnesota Pollution Control Agency (MPCA) requirements and attached supporting documentation – additional local requirements may also apply. Further information can be found here: <https://www.pca.state.mn.us/sites/default/files/wq-wwists4-31a.pdf>.

Inspector must submit completed form to Local Governmental Unit (LGU) and system owner within 15 days of final determination of compliance or noncompliance.

### Property information

Local tracking number: \_\_\_\_\_

Parcel ID# or Sec/Twp/Range: 3102821240002 Local regulatory authority: Washington County

Property address: 6191 Crackleberry Trail Woodbury, Mn. 55129

Owner/representative: Michial Mularoni Owner's phone: 651-308-2088

Brief system description: 2 Septic tanks to gravity drainfield (Septic System 2)

### System status

System status on date (mm/dd/yyyy): 8/13/2021

**Compliant – Certificate of compliance\***

*(Valid for 3 years from report date unless evidence of an imminent threat to public health or safety requiring removal and abatement under section 145A.04, subdivision 8 is discovered or a shorter time frame exists in Local Ordinance.)*

**\*Note: Compliance indicates conformance with Minn. R. 7080.1500 as of system status date above and does not guarantee future performance.**

**Noncompliant – Notice of noncompliance**

*An imminent threat to public health and safety (ITPHS) must be upgraded, replaced, or its use discontinued within ten months of receipt of this notice or within a shorter period if required by local ordinance or under section 145A.04 subdivision 8.*

*Systems failing to protect ground water must be upgraded, replaced, or use discontinued within the time required by local ordinance.*

#### Reason(s) for noncompliance (check all applicable)

- Impact on public health (Compliance component #1) – *Imminent threat to public health and safety*
- Tank integrity (Compliance component #2) – *Failing to protect groundwater*
- Other Compliance Conditions (Compliance component #3) – *Imminent threat to public health and safety*
- Other Compliance Conditions (Compliance component #3) – *Failing to protect groundwater*
- System not abandoned according to Minn. R. 7080.2500 (Compliance component #3) – *Failing to protect groundwater*
- Soil separation (Compliance component #5) – *Failing to protect groundwater*
- Operating permit/monitoring plan requirements (Compliance component #4) – *Noncompliant - local ordinance applies*

#### Comments or recommendations

### Certification

*I hereby certify that all the necessary information has been gathered to determine the compliance status of this system. No determination of future system performance has been nor can be made due to unknown conditions during system construction, possible abuse of the system, inadequate maintenance, or future water usage.*

**By typing my name below, I certify the above statements to be true and correct, to the best of my knowledge, and that this information can be used for the purpose of processing this form.**

Business name: David R Brown

Certification number: 9370

Inspector signature: DRB

License number: 3649

*(This document has been electronically signed)*

Phone: 651-788-3296

### Necessary or locally required supporting documentation (must be attached)

Soil observation logs       Locally required forms       Tank Integrity Assessment       Operating Permit

Other information (list): \_\_\_\_\_

## 1. Impact on public health – Compliance component #1 of 5

### Compliance criteria:

System discharges sewage to the ground surface	<input type="checkbox"/> Yes* <input checked="" type="checkbox"/> No
System discharges sewage to drain tile or surface waters.	<input type="checkbox"/> Yes* <input checked="" type="checkbox"/> No
System causes sewage backup into dwelling or establishment.	<input type="checkbox"/> Yes* <input checked="" type="checkbox"/> No

*Any "yes" answer above indicates the system is an imminent threat to public health and safety.*

Describe verification methods and results:

### Attached supporting documentation:

- Other: \_\_\_\_\_  
 Not applicable

## 2. Tank integrity – Compliance component #2 of 5

### Compliance criteria:

System consists of a seepage pit, cesspool, drywell, leaching pit, or other pit?	<input type="checkbox"/> Yes* <input checked="" type="checkbox"/> No
Sewage tank(s) leak below their designed operating depth?	<input type="checkbox"/> Yes* <input checked="" type="checkbox"/> No
If yes, which sewage tank(s) leaks:	

*Any "yes" answer above indicates the system is failing to protect groundwater.*

Describe verification methods and results:

### Attached supporting documentation:

- Pumped at time of inspection
- Name of maintenance business: Schlomka Services  
License number of maintenance business: 2989  
Date of maintenance: 8/13/2021
- Existing tank integrity assessment (Attach)  
Date of maintenance (mm/dd/yyyy): \_\_\_\_\_ (must be within three years)  
*(See form instructions to ensure assessment complies with Minn. R. 7082.0700 subp. 4 B (1))*
- Tank is Noncompliant (pumping not necessary – explain below)  
 Other: \_\_\_\_\_

### 3. Other compliance conditions – Compliance component #3 of 5

---

3a. Maintenance hole covers appear to be structurally unsound (damaged, cracked, etc.), or unsecured?

Yes\*  No  Unknown

3b. Other issues (*electrical hazards, etc.*) to immediately and adversely impact public health or safety?  Yes\*  No  Unknown

*\*Yes to 3a or 3b - System is an imminent threat to public health and safety.*

3c. System is non-protective of ground water for other conditions as determined by inspector?  Yes\*  No

3d. System not abandoned in accordance with Minn. R. 7080.2500?  Yes\*  No

*\*Yes to 3c or 3d - System is failing to protect groundwater.*

**Describe verification methods and results:**

Attached supporting documentation:  Not applicable  \_\_\_\_\_

### 4. Operating permit and nitrogen BMP\* – Compliance component #4 of 5 Not applicable

---

Is the system operated under an Operating Permit?  Yes  No **If "yes", A below is required**

Is the system required to employ a Nitrogen BMP specified in the system design?  Yes  No **If "yes", B below is required**

*BMP = Best Management Practice(s) specified in the system design*

***If the answer to both questions is "no", this section does not need to be completed.***

**Compliance criteria:**

a. Have the operating permit requirements been met?  Yes  No

b. Is the required nitrogen BMP in place and properly functioning?  Yes  No

***Any "no" answer indicates noncompliance.***

**Describe verification methods and results:**

Attached supporting documentation:  Operating permit (Attach)  \_\_\_\_\_

## 5. Soil separation – Compliance component #5 of 5

Date of installation 9/13/2000  Unknown  
(mm/dd/yyyy)

Shoreland/Wellhead protection/Food beverage lodging?  Yes  No

**Compliance criteria (select one):**

5a. For systems built prior to April 1, 1996, and not located in Shoreland or Wellhead Protection Area or not serving a food, beverage or lodging establishment:  Yes  No\*

Drainfield has at least a two-foot vertical separation distance from periodically saturated soil or bedrock.

5b. Non-performance systems built April 1, 1996, or later or for non-performance systems located in Shoreland or Wellhead Protection Areas or serving a food, beverage, or lodging establishment:  Yes  No\*

Drainfield has a three-foot vertical separation distance from periodically saturated soil or bedrock.\*

5c. "Experimental", "Other", or "Performance" systems built under pre-2008 Rules; Type IV or V systems built under 2008 Rules 7080.2350 or 7080.2400 (Advanced Inspector License required)  Yes  No\*

Drainfield meets the designed vertical separation distance from periodically saturated soil or bedrock.

**\*Any "no" answer above indicates the system is failing to protect groundwater.**

**Describe verification methods and results:**

**Attached supporting documentation:**

Soil observation logs completed for the report (Attach)

Two previous verifications of required vertical separation (Attach)

Not applicable (No soil treatment area)

\_\_\_\_\_

**Indicate depths or elevations**

A. Bottom of distribution media	30"
B. Periodically saturated soil/bedrock	70"
C. System separation	40"
D. Required compliance separation*	36"

\*May be reduced up to 15 percent if allowed by Local Ordinance.

**Upgrade requirements:** (Minn. Stat. § 115.55) An imminent threat to public health and safety (ITPHS) must be upgraded, replaced, or its use discontinued within ten months of receipt of this notice or within a shorter period if required by local ordinance. If the system is failing to protect ground water, the system must be upgraded, replaced, or its use discontinued within the time required by local ordinance. If an existing system is not failing as defined in law, and has at least two feet of design soil separation, then the system need not be upgraded, repaired, replaced, or its use discontinued, notwithstanding any local ordinance that is more strict. This provision does not apply to systems in shoreland areas, Wellhead Protection Areas, or those used in connection with food, beverage, and lodging establishments as defined in law.



WASHINGTON COUNTY, MINNESOTA

Department of Public Health  
and Environment 651/430-6708

WOODBURY CITY

PERMIT NUMBER 250020004 SEWAGE PERMIT

Owner : MICHAEL MULARONI  
6191 CRACKLEBERRY TR  
WOODBURY MN 55129  
Applicant : MICHAEL MULARONI 458-0648

DRAINFIELD REPLACEMENT PERMIT	70.00
SEPTIC APPLICATION/SOIL REVIEW	150.00
Total Fees :	220.00
Total Paid :	220.00
Total Due :	.00

25002-20004

PERMISSION IS HEREBY GRANTED

To execute the work specified in this permit on the following described property upon express condition that said persons and their agents, employees and workmen shall conform in all respects to the provisions of the Building Code, and/or Ordinances.

This permit may be revoked at any time upon the violation of any of the provisions of said code and ordinances.

Project Address : 6191 CRACKLEBERRY TR WOODBURY MN 55129  
Legal Description: PT SE 1/4- NW 1/4 312821 GOM AT A PT ON W LINE Geo : 31-028-21-24-0002

Flow Capacity 450 Gal/Day Tank Volume 2000  
Soil Conditions: Depth to Restriction 96 Inches Perc Rate 3 Hrs/Inch

Soil Treatment Type:  
Bottom Area 570 Rock Depth 12

Authorized Work / Special Conditions  
- Install individual sewage treatment system as per approved design in area tested and shown on site plan.

\*\* Permit Expiration Date : Sewage Treatment : 2001-05-03

A CERTIFICATE OF OCCUPANCY MUST BE REQUESTED AND ISSUED PRIOR TO USE OR OCCUPANCY OF WORK PERMITTED BY A BUILDING PERMIT.

\*\* This permit shall expire and be null and void if the work authorized by the Building Permit is not commenced within 60 days of the date of issuance or if work is abandoned or suspended for a period of 120 days. Term of the Building Permit is 12 months from date of issue. Term of sewage treatment permit is 12 months from date of issue.

Penalty for violation of any of the provisions of building code: Fine not to exceed five hundred dollars (\$500.00) or imprisonment for not more than ninety (90) days, or both.

Permit Issue Date 2000-05-03 Code Enforcement Officer *Plamuel*

# INSPECTION RECORD

BUILDING	DATE	INSP.	COMMENTS
Foundation.....			
Foundation Wall.....			
Plumbing (Groundwork).....			
Heating (Groundwork).....			
Rough Plumbing .....			
Rough Gas Piping .....			
Rough Heating and Ventilation .....			
Framing .....			
Insulation .....			
Fireplace .....			
Chimney .....			
Wallboard or Lath and Plaster .....			
Final Electrical .....			
Final Plumbing .....			
Final Gas Piping .....			
Final Heating and Ventilation .....			
Final Building .....			

SEWAGE TREATMENT SYSTEM	DATE	INSP.	COMMENTS
Installation .....	5-10-00	Rate	Tank Size: 2-1000 Treatment Area: 570 sq ft
As Built .....	9-13-00	P-let	Installer: OWNER - MR MULARSKI

DRIVEWAY	DATE	INSP.	COMMENTS
Access .....			
Installation .....			

**NOTES:**

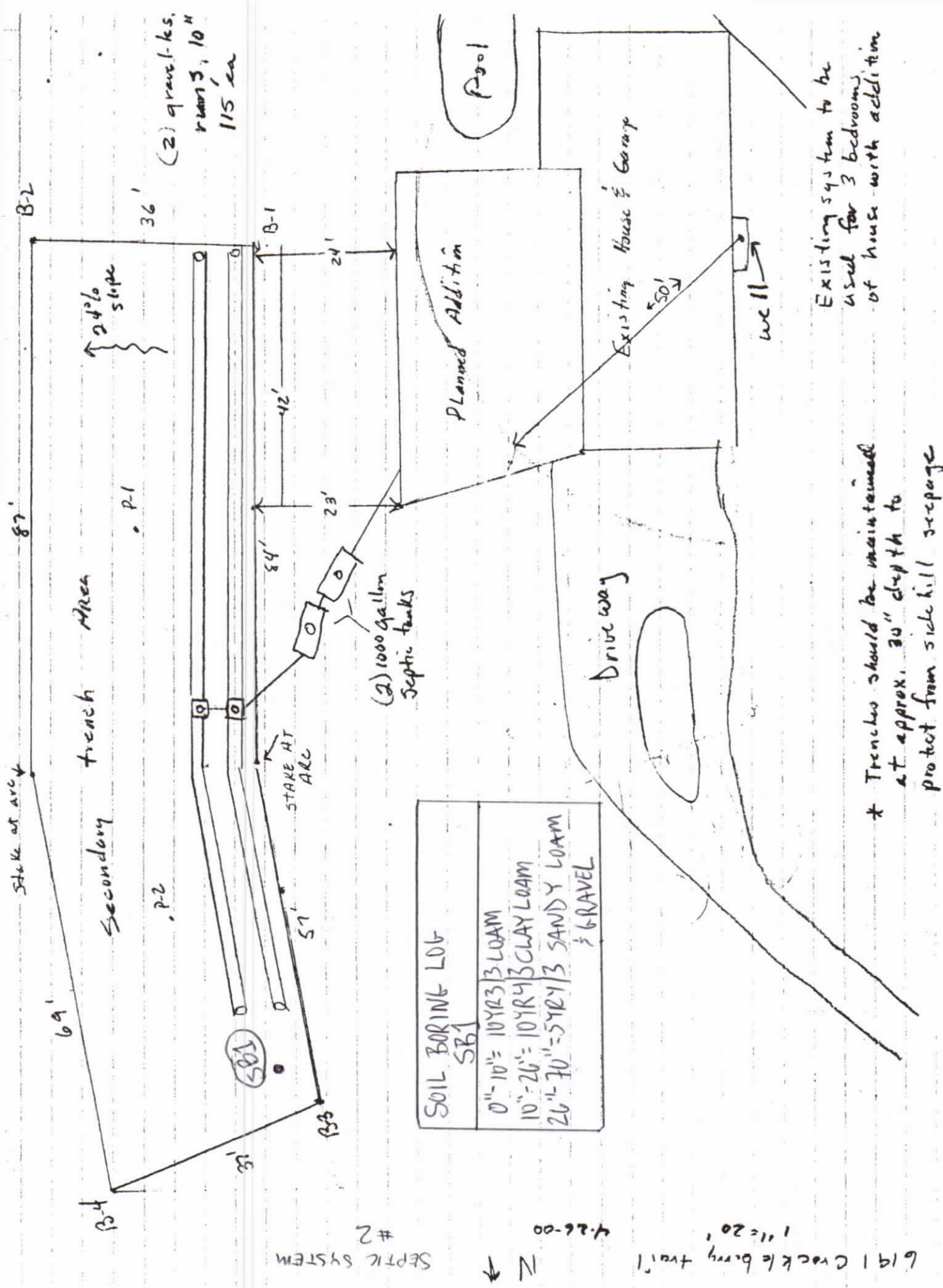

(2) gravel-l.s.  
 10' x 3', 10' x 4'  
 115' ea

SOIL BORING LOG	
SB1	
0" - 10"	10YR3   3 LOAM
10" - 26"	10YR4   3 CLAY LOAM
26" - 70"	5YR2   3 SANDY LOAM
	3 GRAVEL

Existing system to be used for 3 bedrooms of house with addition

\* Trenches should be maintained at approx. 30" depth to protect from side hill seepage

SEPTIC SYSTEM #2

N

4-26-00

6191 Crackleberry trail  
 1" = 20'