

Instructions: Inspector must submit completed form to Local Governmental Unit (LGU) and system owner within 15 days of final determination of compliance or noncompliance. Instructions for filling out this form are located on the Minnesota Pollution Control Agency (MPCA) website at <https://www.pca.state.mn.us/sites/default/files/wq-wwists4-31a.pdf>.

Property information

Local tracking number:

Parcel ID# or Sec/Twp/Range: 27.031.20.31.0004 Reason for inspection: property sale
Local regulatory authority info: Washington County
Property address: 13320 Northbrook Ave N Stillwater, MN 55082
Owner/representative: Terry & Linda Kniskern Owner's phone: 651-528-6989
Brief system description: Two precast septic tanks and a gravity, rock trench drainfield.

System status

System status on date (mm/dd/yyyy): 9/7/2021

Compliant – Certificate of compliance*

Noncompliant – Notice of noncompliance

(Valid for 3 years from report date unless evidence of an imminent threat to public health or safety requiring removal and abatement under section 145A.04, subdivision 8 is discovered or a shorter time frame exists in Local Ordinance.)

Systems failing to protect ground water must be upgraded, replaced, or use discontinued within the time required by local ordinance.

***Note: Compliance indicates conformance with Minn. R. 7080.1500 as of system status date above and does not guarantee future performance.**

An imminent threat to public health and safety (ITPHS) must be upgraded, replaced, or its use discontinued within ten months of receipt of this notice or within a shorter period if required by local ordinance or under section 145A.04 subdivision 8.

Reason(s) for noncompliance (check all applicable)

- Impact on public health (Compliance component #1) – *Imminent threat to public health and safety*
- Tank integrity (Compliance component #2) – *Failing to protect groundwater*
- Other Compliance Conditions (Compliance component #3) – *Imminent threat to public health and safety*
- Other Compliance Conditions (Compliance component #3) – *Failing to protect groundwater*
- System not abandoned according to Minn. R. 7080.2500 (Compliance component #3) – *Failing to protect groundwater*
- Soil separation (Compliance component #5) – *Failing to protect groundwater*
- Operating permit/monitoring plan requirements (Compliance component #4) – *Noncompliant - local ordinance applies*

Comments or recommendations

Reviewed septic system records on file at Washington County.

Certification

I hereby certify that all the necessary information has been gathered to determine the compliance status of this system. No determination of future system performance has been nor can be made due to unknown conditions during system construction, possible abuse of the system, inadequate maintenance, or future water usage.

By typing my name below, I certify the above statements to be true and correct, to the best of my knowledge, and that this information can be used for the purpose of processing this form.

Business name: All State Septic Services LLC Certification number: 323
Inspector signature: Tom Trooien License number: 1568
(This document has been electronically signed) Phone: 612-594-4496

Necessary or locally required supporting documentation (must be attached)

- Soil observation logs
- System/As-Built
- Locally required forms
- Tank Integrity Assessment
- Operating Permit
- Other information (list):

1. Impact on public health – Compliance component #1 of 5

Compliance criteria:

System discharges sewage to the ground surface Yes* No

System discharges sewage to drain tile or surface waters. Yes* No

System causes sewage backup into dwelling or establishment. Yes* No

Any "yes" answer above indicates the system is an imminent threat to public health and safety.

Describe verification methods and results:

Searched for seeping or surfacing to the ground surface - none observed during the inspection.

Attached supporting documentation:

Other: _____
 Not applicable

2. Tank integrity – Compliance component #2 of 5

Compliance criteria:

System consists of a seepage pit, cesspool, drywell, leaching pit, or other pit? Yes* No

Sewage tank(s) leak below their designed operating depth? Yes* No

If yes, which sewage tank(s) leaks:

Any "yes" answer above indicates the system is failing to protect groundwater.

Describe verification methods and results:

The tanks were pumped during the inspection. Lowered a camera into the empty tanks - bottoms, walls, covers, baffles, risers and maintenance hole covers appear ok

Attached supporting documentation:

Empty tank(s) viewed by inspector
 Name of maintenance business: Pinky's Sewer Service
 License number of maintenance business: C9755
 Date of maintenance: 9/7/2021
 Existing tank integrity assessment (Attach)
 Date of maintenance (mm/dd/yyyy): _____ (must be within three years)
(See form instructions to ensure assessment complies with Minn. R. 7082.0700 subp. 4 B (1))
 Tank is Noncompliant (pumping not necessary – explain below)
 Other: _____

3. Other compliance conditions – Compliance component #3 of 5

3a. Maintenance hole covers appear to be structurally unsound (damaged, cracked, etc.), or unsecured?

Yes* No Unknown

3b. Other issues (electrical hazards, etc.) to immediately and adversely impact public health or safety? Yes* No Unknown

*Yes to 3a or 3b - System is an imminent threat to public health and safety.

3c. System is non-protective of ground water for other conditions as determined by inspector? Yes* No

3d. System not abandoned in accordance with Minn. R. 7080.2500? Yes* No

*Yes to 3c or 3d - System is failing to protect groundwater.

Describe verification methods and results:

Attached supporting documentation: Not applicable

4. Operating permit and nitrogen BMP* – Compliance component #4 of 5 Not applicable

Is the system operated under an Operating Permit? Yes No If "yes", A below is required

Is the system required to employ a Nitrogen BMP specified in the system design? Yes No If "yes", B below is required

BMP = Best Management Practice(s) specified in the system design

If the answer to both questions is "no", this section does not need to be completed.

Compliance criteria:

a. Have the operating permit requirements been met? Yes No

b. Is the required nitrogen BMP in place and properly functioning? Yes No

Any "no" answer indicates noncompliance.

Describe verification methods and results:

Attached supporting documentation: Operating permit (Attach)

5. Soil separation – Compliance component #5 of 5

Date of installation 10/31/1997 Unknown
(mm/dd/yyyy)

Shoreland/Wellhead protection/Food beverage lodging? Yes No

Compliance criteria (select one):

5a. For systems built prior to April 1, 1996, and not located in Shoreland or Wellhead Protection Area or not serving a food, beverage or lodging establishment: Yes No*
 Drainfield has at least a two-foot vertical separation distance from periodically saturated soil or bedrock.

5b. Non-performance systems built April 1, 1996, or later or for non-performance systems located in Shoreland or Wellhead Protection Areas or serving a food, beverage, or lodging establishment: Yes No*
 Drainfield has a three-foot vertical separation distance from periodically saturated soil or bedrock.*

5c. "Experimental", "Other", or "Performance" systems built under pre-2008 Rules; Type IV or V systems built under 2008 Rules 7080.2350 or 7080.2400 (Intermediate Inspector License required ≤ 2,500 gallons per day; Advanced Inspector License required > 2,500 gallons per day) Yes No*
 Drainfield meets the designed vertical separation distance from periodically saturated soil or bedrock.

Attached supporting documentation:

- Soil observation logs completed for the report
- Two previous verifications of required vertical separation
- Not applicable (No soil treatment area)
- _____

Indicate depths or elevations

A. Bottom of distribution media	3
B. Periodically saturated soil/bedrock	6
C. System separation	3
D. Required compliance separation*	3

*May be reduced up to 15 percent if allowed by Local Ordinance.

**Any "no" answer above indicates the system is failing to protect groundwater.*

Describe verification methods and results:

Upgrade requirements: (Minn. Stat. § 115.55) An imminent threat to public health and safety (ITPHS) must be upgraded, replaced, or its use discontinued within ten months of receipt of this notice or within a shorter period if required by local ordinance. If the system is failing to protect ground water, the system must be upgraded, replaced, or its use discontinued within the time required by local ordinance. If an existing system is not failing as defined in law, and has at least two feet of design soil separation, then the system need not be upgraded, repaired, replaced, or its use discontinued, notwithstanding any local ordinance that is more strict. This provision does not apply to systems in shoreland areas, Wellhead Protection Areas, or those used in connection with food, beverage, and lodging establishments as defined in law.

Well not in
yet

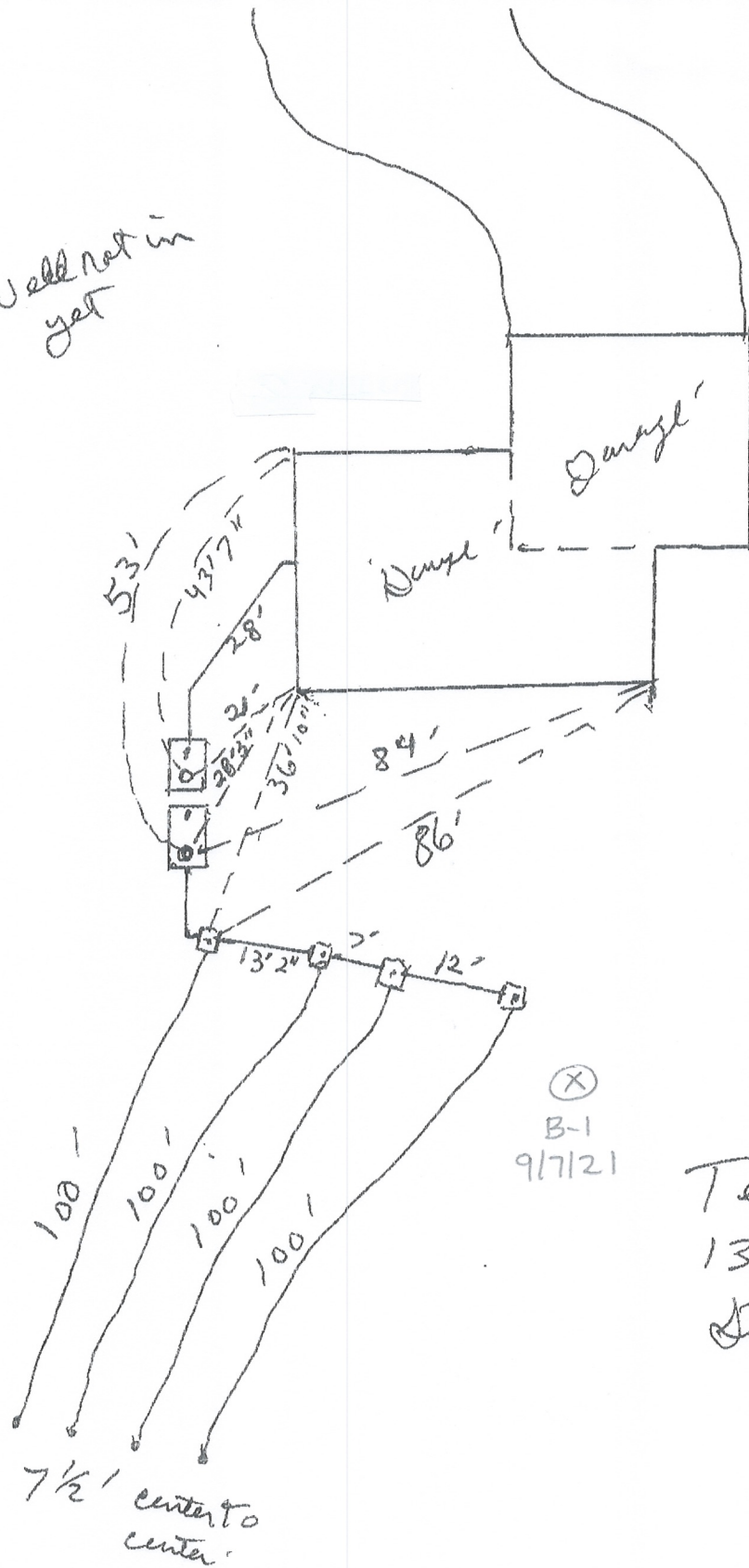

(X)
B-1
9/7/21

Terry Kinuskenn
13320 North Brook
ave N.
Stillwater Minn
55082



Soil Observation Log

Project ID: v 04.01.2021

Client: Terry & Linda Kniskern		Location / Address: 13320 Northbrook Ave N Stillwater, MN 55082							
Soil parent material(s): (Check all that apply)		<input type="checkbox"/> Outwash	<input type="checkbox"/> Lacustrine						
Landscape Position: (select one)		<input type="checkbox"/> Loess	<input type="checkbox"/> Till						
Vegetation: lawn		<input type="checkbox"/> Alluvium	<input type="checkbox"/> Bedrock						
Weather Conditions/Time of Day:		Slope shape							
Observation #/Location: B-1		Soil survey map units: clear am							
Date: 09/07/21		Observation Type: auger							
Depth (in)	Texture	Rock Frag. %	Matrix Color(s)	Mottle Color(s)	Redox Kind(s)	Indicator(s)	Structure		Consistence
							Shape	Grade	
0-10	topsoil		10YR 2/2						
10-30	loamy sand		10YR 3/4						
30-52	loamy sand		10YR 4/4						
52-72	fine sandy loam		7.5YR 5/4						
Comments									
I hereby certify that I have completed this work in accordance with all applicable ordinances, rules and laws.									
Tom Trooien		Tom Trooien		1568		9/7/21			
(Designer/Inspector)		(Signature)		(License #)		(Date)			

Elevation relative to benchmark: n/a

Limiting Layer Elevation: n/a