

Instructions: Inspector must submit completed form to Local Governmental Unit (LGU) and system owner within 15 days of final determination of compliance or noncompliance. Instructions for filling out this form are located on the Minnesota Pollution Control Agency (MPCA) website at <https://www.pca.state.mn.us/sites/default/files/wq-wwists4-31a.pdf>.

Property information

Local tracking number: _____

Parcel ID# or Sec/Twp/Range: 04.032.20.14.0001

Reason for Inspection property sale

Local regulatory authority info: Washington County

Property address: 23393 Nolan Ave N Scandia, MN 55073

Owner/representative: Jim Simpson

Owner's phone: 651-770-2222

Brief system description: Three septic tanks and one pump tank lifting to a mound drainfield.

System status

System status on date (mm/dd/yyyy): 9/7/2021

Compliant – Certificate of compliance*

Noncompliant – Notice of noncompliance

(Valid for 3 years from report date unless evidence of an imminent threat to public health or safety requiring removal and abatement under section 145A.04, subdivision 8 is discovered or a shorter time frame exists in Local Ordinance.)

Systems failing to protect ground water must be upgraded, replaced, or use discontinued within the time required by local ordinance.

***Note: Compliance indicates conformance with Minn. R. 7080.1500 as of system status date above and does not guarantee future performance.**

An imminent threat to public health and safety (ITPHS) must be upgraded, replaced, or its use discontinued within ten months of receipt of this notice or within a shorter period if required by local ordinance or under section 145A.04 subdivision 8.

Reason(s) for noncompliance (check all applicable)

- Impact on public health (Compliance component #1) – *Imminent threat to public health and safety*
- Tank integrity (Compliance component #2) – *Failing to protect groundwater*
- Other Compliance Conditions (Compliance component #3) – *Imminent threat to public health and safety*
- Other Compliance Conditions (Compliance component #3) – *Failing to protect groundwater*
- System not abandoned according to Minn. R. 7080.2500 (Compliance component #3) – *Failing to protect groundwater*
- Soil separation (Compliance component #5) – *Failing to protect groundwater*
- Operating permit/monitoring plan requirements (Compliance component #4) – *Noncompliant - local ordinance applies*

Comments or recommendations

Reviewed septic system records on file at Washington County.

Certification

I hereby certify that all the necessary information has been gathered to determine the compliance status of this system. No determination of future system performance has been nor can be made due to unknown conditions during system construction, possible abuse of the system, inadequate maintenance, or future water usage.

By typing my name below, I certify the above statements to be true and correct, to the best of my knowledge, and that this information can be used for the purpose of processing this form.

Business name: All State Septic Services LLC

Certification number: 323

Inspector signature: Tom Trooien

License number: 1568

(This document has been electronically signed)

Phone: 612-594-4496

Necessary or locally required supporting documentation (must be attached)

- Soil observation logs
- System/As-Built
- Locally required forms
- Tank Integrity Assessment
- Operating Permit
- Other information (list): _____

Property Address: 23393 Nolan Ave N Scandia, MN 55073

Business Name: All State Septic Services LLC

Date: 9/7/2021

1. Impact on public health – Compliance component #1 of 5

Compliance criteria:

System discharges sewage to the ground surface Yes* No

System discharges sewage to drain tile or surface waters. Yes* No

System causes sewage backup into dwelling or establishment. Yes* No

Any "yes" answer above indicates the system is an imminent threat to public health and safety.

Describe verification methods and results:

Searched for seeping or surfacing to the ground surface - none observed during the inspection.

Attached supporting documentation:

Other: _____

Not applicable

2. Tank integrity – Compliance component #2 of 5

Compliance criteria:

System consists of a seepage pit, cesspool, drywell, leaching pit, or other pit? Yes* No

Sewage tank(s) leak below their designed operating depth? Yes* No

If yes, which sewage tank(s) leaks:

Any "yes" answer above indicates the system is failing to protect groundwater.

Describe verification methods and results:

Attached supporting documentation:

Empty tank(s) viewed by inspector

Name of maintenance business: _____

License number of maintenance business: _____

Date of maintenance: _____

Existing tank integrity assessment (Attach)

Date of maintenance 9/7/2021

(mm/dd/yyyy):

(must be within three years)

(See form instructions to ensure assessment complies with Minn. R. 7082.0700 subp. 4 B (1))

Tank is Noncompliant (pumping not necessary – explain below)

Other: _____

Property Address: 23393 Nolan Ave N Scandia, MN 55073

Business Name: All State Septic Services LLC

Date: 9/7/2021

3. Other compliance conditions – Compliance component #3 of 5

3a. Maintenance hole covers appear to be structurally unsound (damaged, cracked, etc.), or unsecured?

Yes* No Unknown

3b. Other issues (*electrical hazards, etc.*) to immediately and adversely impact public health or safety? Yes* No Unknown

**Yes to 3a or 3b - System is an imminent threat to public health and safety.*

3c. System is non-protective of ground water for other conditions as determined by inspector? Yes* No

3d. System not abandoned in accordance with Minn. R. 7080.2500? Yes* No

**Yes to 3c or 3d - System is failing to protect groundwater.*

Describe verification methods and results:

Attached supporting documentation: Not applicable

4. Operating permit and nitrogen BMP* – Compliance component #4 of 5 Not applicable

Is the system operated under an Operating Permit? Yes No **If “yes”, A below is required**

Is the system required to employ a Nitrogen BMP specified in the system design? Yes No **If “yes”, B below is required**

BMP = Best Management Practice(s) specified in the system design

If the answer to both questions is “no”, this section does not need to be completed.

Compliance criteria:

a. Have the operating permit requirements been met? Yes No

b. Is the required nitrogen BMP in place and properly functioning? Yes No

Any “no” answer indicates noncompliance.

Describe verification methods and results:

Attached supporting documentation: Operating permit (Attach)

Property Address: 23393 Nolan Ave N Scandia, MN 55073

Business Name: All State Septic Services LLC

Date: 9/7/2021

5. Soil separation – Compliance component #5 of 5

Date of installation 5/18/1994 Unknown
(mm/dd/yyyy)

Shoreland/Wellhead protection/Food beverage lodging? Yes No

Attached supporting documentation:

- Soil observation logs completed for the report
- Two previous verifications of required vertical separation
- Not applicable (No soil treatment area)
- _____

Compliance criteria (select one):

5a. For systems built prior to April 1, 1996, and not located in Shoreland or Wellhead Protection Area or not serving a food, beverage or lodging establishment: Yes No*

Drainfield has at least a two-foot vertical separation distance from periodically saturated soil or bedrock.

5b. Non-performance systems built April 1, 1996, or later or for non-performance systems located in Shoreland or Wellhead Protection Areas or serving a food, beverage, or lodging establishment: Yes No*

Drainfield has a three-foot vertical separation distance from periodically saturated soil or bedrock.*

5c. "Experimental", "Other", or "Performance" systems built under pre-2008 Rules; Type IV or V systems built under 2008 Rules 7080, 2350 or 7080.2400 (Intermediate Inspector License required ≤ 2,500 gallons per day; Advanced Inspector License required > 2,500 gallons per day) Yes No*

Drainfield meets the designed vertical separation distance from periodically saturated soil or bedrock.

Indicate depths or elevations

A. Bottom of distribution media	94.4
B. Periodically saturated soil/bedrock	91.3
C. System separation	3.1
D. Required compliance separation*	3

*May be reduced up to 15 percent if allowed by Local Ordinance.

**Any "no" answer above indicates the system is failing to protect groundwater.*

Describe verification methods and results:

Upgrade requirements: (Minn. Stat. § 115.55) An imminent threat to public health and safety (ITPHS) must be upgraded, replaced, or its use discontinued within ten months of receipt of this notice or within a shorter period if required by local ordinance. If the system is failing to protect ground water, the system must be upgraded, replaced, or its use discontinued within the time required by local ordinance. If an existing system is not failing as defined in law, and has at least two feet of design soil separation, then the system need not be upgraded, repaired, replaced, or its use discontinued, notwithstanding any local ordinance that is more strict. This provision does not apply to systems in shoreland areas, Wellhead Protection Areas, or those used in connection with food, beverage, and lodging establishments as defined in law.

Property address: 23393 ndeaw Ave
City: Scandia MN

Parcel ID: _____
State: MN
Zip code: 55073

Optional section: Sewage Tank Compliance Certification (Tank integrity assessment)

This form does not represent a complete system inspection report and only certifies sewage tank compliance status. i.e., this form, completed, may serve as a tank integrity assessment.

Instructions: This section of the form may be completed and signed by a Designated Certified Individual (DCI) of a licensed SSTS Maintenance Business who personally conducts the necessary procedures to assess the compliance status of each sewage tank in the system.

When this section of the form is signed by a qualified certified professional, it becomes *necessary supporting documentation* to an Existing System Compliance Inspection Report: Compliance inspection form - Existing system (wq-wwists4-31b). This form can be found on the MPCA website at <https://www.pca.state.mn.us/water/service-and-maintenance>.

The information and certified statement on this form is **required** when existing septic tank compliance status is determined by an individual other than the SSTS Inspector that submits an inspection report. This form represents a third party assessment of SSTS component compliance and is allowable under Minn. R. 7082.0700, subp. 4 Item (B) subitem (1). This form is valid for a period of three years beyond the signature date on this form unless a new evaluation is requested by the owner or owner's agent or is required according to local regulations. Additional Administrative Rule references for this activity can be found at Minn. R. 7082.0700, subp. 4 Items B, C, and D; 7083.0730 Item C.

Certificate of sewage tank compliance
Affirm all three statements:
 The SSTS does not contain a seepage pit, cesspool, drywell, leaching pit, or other pit.
 It does not contain a sewage tank that was designed to be watertight, but subsequently leaks below the designed operating depth.
 It does not represent an imminent safety threat by reason of unsecured, damaged, or weak maintenance hole cover(s) or other unsafe condition.

Notice of sewage tank non-compliance
Select all that apply:
 The SSTS has a seepage pit, cesspool, drywell, leaching pit, or other pit – **"Failure to Protect Groundwater."**
 It has a sewage tank that was designed to be watertight, but subsequently leaks below the designed operating depth – **"Failure to Protect Groundwater."**
 It presents a threat to public safety by reason of unsecured, damaged, or weak maintenance hole cover(s) or other unsafe condition – **"Imminent Threat to Public Health or Safety."**

Company information

Company name: Olson's Sewer Service, Inc.
Business license number: 216

Designated Certified Individual (DCI) information

Print name: Brian Dukart
Certification number: ~~92476~~ C9646

I personally conducted the work described above as a Designated Certified Individual of a Minnesota-licensed SSTS Maintenance Business. I personally conducted the necessary procedures to assess the compliance status of each sewage tank in this SSTS.

By typing/signing my name below, I certify the above statements to be true and correct, to the best of my knowledge, and that this information can be used for the purpose of processing this form.

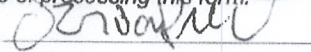
Designated Certified Individual's signature:  Date (mm/dd/yyyy): 9-7-21

NEW 111T PUMP added 5/01 for 1/2 Bath in Barn

Sewer can be no closer than 20 feet to well and must be pressure tested within 50 feet of well.

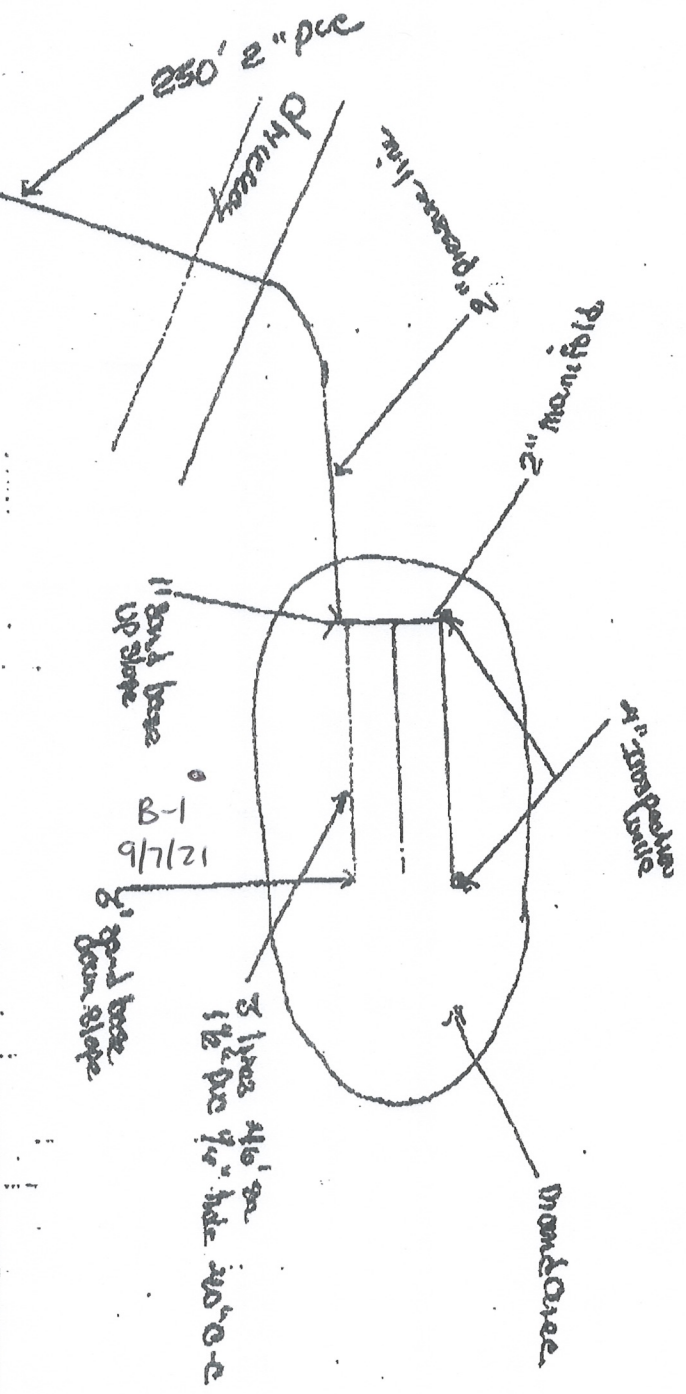
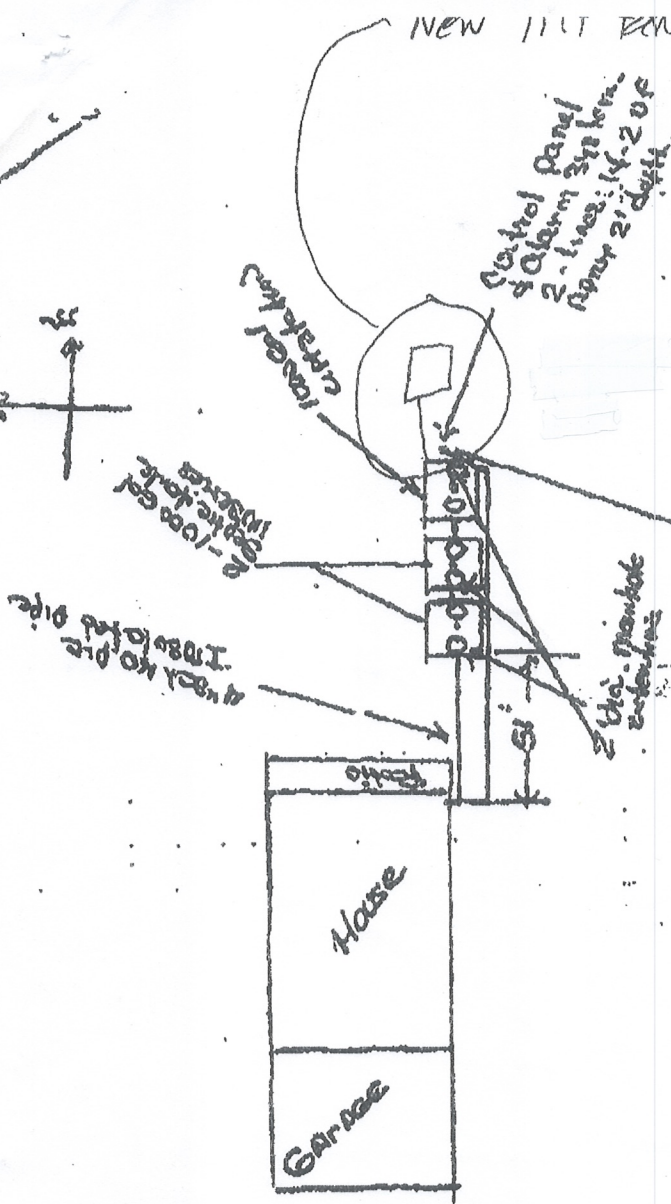

Installed 5-18-99
 C&B Excavating & Sewer Inc
 3-1000 Gal Tanks Royal Corralle
 500 gal Pressure manhd
 2\"/>

Driveway Under Construction

Goolds Pump

NO Stale

