Midwest Sewer Services

P.O. Box 10853 White Bear Lake, MN 55110
651-492-7550/Brian@Midwestsoiltesting.com

Brian Humpal
MPCA Licensed Advanced Inspector

SUBSURFACE SEWAGE TREATMENT SYSTEM (SSTS) COMPLIANCE REPORT

Date: October 21, 2021

Time: 10:30 AM

Owner: Mike Schuberg

Inspection Address: 11549 W Point Douglas Rd, Cottage Grove, MN 55033

REPORT SUMMARY

I have performed an “MPCA Compliance Inspection” on this system and have reviewed the original design/permit records on file at Washington County. This system consists of two pre-cast septic tanks, a pre-cast lift tank, and a mound. Ron’s Sewer Service pumped the tanks on July 22, 2020. Although not a compliance criteria, it should be noted that the lift pump electrical is poorly configured and should be re-configured to reduce the potential for problems.

Predicated on my inspection of the system and my review of the original design/permit records, it is my opinion that this system presently meets MPCA minimum compliance inspection requirements.

Midwest Sewer Services have been hired to perform a compliance inspection of this SSTS for compliance with local ordinances pursuant to Minn. Stat. § 115.55 (2013). This compliance inspection covers only the criteria required by Minn. Stat. § 115.55 Subd. 5a (2013) and Minn. R. 7080.1500 (2011). A compliance inspection is an indication of the current compliance status of the system and does not guarantee the performance or longevity of this system beyond the date of inspection, as it is impossible to determine the future performance of any system. Midwest Sewer Services disclaim any use of this compliance inspection beyond determining SSTS compliance pursuant to Minn. Stat. § 115.55 Subd. 5a (2013) and Minn. R. 7080.1500 (2011).

Please contact me should you have any questions.



Christopher Uebe

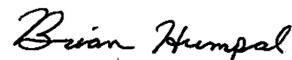

Brian Humpal

Compliance inspection report form

Existing Subsurface Sewage Treatment System (SSTS)

Doc Type: Compliance and Enforcement

Instructions: Inspector must submit completed form to Local Governmental Unit (LGU) and system owner within 15 days of final determination of compliance or noncompliance. Instructions for filling out this form are located on the Minnesota Pollution Control Agency (MPCA) website at <https://www.pca.state.mn.us/sites/default/files/wq-wwists4-31a.pdf>.

Property information

Local tracking number: _____

Parcel ID# or Sec/Twp/Range: _____ Reason for Inspection _____ Property Transfer _____

Local regulatory authority info: Washington CountyProperty address: 11549 W Point Douglas Rd, Cottage Grove, MN 55033Owner/representative: Mike Schuberg Owner's phone: 612-859-8920Brief system description: Two pre-cast septic tanks, a pre-cast lift tank, and a mound.

System status

System status on date (mm/dd/yyyy): 10/21/2021 **Compliant – Certificate of compliance***

(Valid for 3 years from report date unless evidence of an imminent threat to public health or safety requiring removal and abatement under section 145A.04, subdivision 8 is discovered or a shorter time frame exists in Local Ordinance.)

***Note: Compliance indicates conformance with Minn. R. 7080.1500 as of system status date above and does not guarantee future performance.**

 Noncompliant – Notice of noncompliance

Systems failing to protect ground water must be upgraded, replaced, or use discontinued within the time required by local ordinance.

An imminent threat to public health and safety (ITPHS) must be upgraded, replaced, or its use discontinued within ten months of receipt of this notice or within a shorter period if required by local ordinance or under section 145A.04 subdivision 8.

Reason(s) for noncompliance (check all applicable)

- Impact on public health (Compliance component #1) – *Imminent threat to public health and safety*
- Tank integrity (Compliance component #2) – *Failing to protect groundwater*
- Other Compliance Conditions (Compliance component #3) – *Imminent threat to public health and safety*
- Other Compliance Conditions (Compliance component #3) – *Failing to protect groundwater*
- System not abandoned according to Minn. R. 7080.2500 (Compliance component #3) – *Failing to protect groundwater*
- Soil separation (Compliance component #5) – *Failing to protect groundwater*
- Operating permit/monitoring plan requirements (Compliance component #4) – *Noncompliant - local ordinance applies*

Comments or recommendations

Although not a compliance criteria, it should be noted that the lift pump electrical is poorly configured and should be re-configured to reduce the potential for problems.

Certification

I hereby certify that all the necessary information has been gathered to determine the compliance status of this system. No determination of future system performance has been nor can be made due to unknown conditions during system construction, possible abuse of the system, inadequate maintenance, or future water usage.

By typing my name below, I certify the above statements to be true and correct, to the best of my knowledge, and that this information can be used for the purpose of processing this form.

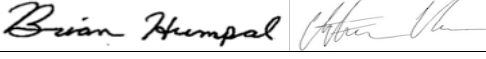
Business name: Midwest Sewer Services Certification number: 5342/9852Inspector signature:  License number: L2896
(This document has been electronically signed) Phone: 651-492-7550

Necessary or locally required supporting documentation (must be attached)

- Soil observation logs System/As-Built Locally required forms Tank Integrity Assessment Operating Permit
- Other information (list): Report Summary, Property Information, Disclaimer, License

Property Address: 11549 W Point Douglas Rd, Cottage Grove, MN 55033

Business Name: Midwest Sewer Services

Date: 10/21/2021

1. Impact on public health – Compliance component #1 of 5**Compliance criteria:**

| | |
|---|--|
| System discharges sewage to the ground surface | <input type="checkbox"/> Yes* <input checked="" type="checkbox"/> No |
| System discharges sewage to drain tile or surface waters. | <input type="checkbox"/> Yes* <input checked="" type="checkbox"/> No |
| System causes sewage backup into dwelling or establishment. | <input type="checkbox"/> Yes* <input checked="" type="checkbox"/> No |

Any "yes" answer above indicates the system is an imminent threat to public health and safety.

Describe verification methods and results:

None of the above found.

Attached supporting documentation: Other: _____ Not applicable**2. Tank integrity – Compliance component #2 of 5****Compliance criteria:**

| | |
|--|--|
| System consists of a seepage pit, cesspool, drywell, leaching pit, or other pit? | <input type="checkbox"/> Yes* <input checked="" type="checkbox"/> No |
| Sewage tank(s) leak below their designed operating depth? | <input type="checkbox"/> Yes* <input checked="" type="checkbox"/> No |
| If yes, which sewage tank(s) leaks: | |

Any "yes" answer above indicates the system is failing to protect groundwater.

Describe verification methods and results:

Although not a compliance criteria, it should be noted that the lift pump electrical is poorly configured and should be re-configured to reduce the potential for problems.

Attached supporting documentation: Empty tank(s) viewed by inspector

Name of maintenance business: _____

License number of maintenance business: _____

Date of maintenance: _____

 Existing tank integrity assessment (Attach)Date of maintenance 7/22/2020

(mm/dd/yyyy):

(must be within three years)

(See form instructions to ensure assessment complies with Minn. R. 7082.0700 subp. 4 B (1))

 Tank is Noncompliant (pumping not necessary – explain below) Other: _____

Property Address: 11549 W Point Douglas Rd, Cottage Grove, MN 55033

Business Name: Midwest Sewer Services

Date: 10/21/2021

3. Other compliance conditions – Compliance component #3 of 5

3a. Maintenance hole covers appear to be structurally unsound (damaged, cracked, etc.), or unsecured?

Yes* No Unknown

3b. Other issues (*electrical hazards, etc.*) to immediately and adversely impact public health or safety? Yes* No Unknown

***Yes to 3a or 3b - System is an imminent threat to public health and safety.**

3c. System is non-protective of ground water for other conditions as determined by inspector? Yes* No

3d. System not abandoned in accordance with Minn. R. 7080.2500? Yes* No

***Yes to 3c or 3d - System is failing to protect groundwater.**

Describe verification methods and results:

Attached supporting documentation: Not applicable

4. Operating permit and nitrogen BMP* – Compliance component #4 of 5 Not applicable

Is the system operated under an Operating Permit? Yes No **If “yes”, A below is required**

Is the system required to employ a Nitrogen BMP specified in the system design? Yes No **If “yes”, B below is required**

BMP = Best Management Practice(s) specified in the system design

If the answer to both questions is “no”, this section does not need to be completed.

Compliance criteria:

a. Have the operating permit requirements been met? Yes No

b. Is the required nitrogen BMP in place and properly functioning? Yes No

Any “no” answer indicates noncompliance.

Describe verification methods and results:

Attached supporting documentation: Operating permit (Attach)

Property Address: 11549 W Point Douglas Rd, Cottage Grove, MN 55033

Business Name: Midwest Sewer Services

Date: 10/21/2021

5. Soil separation – Compliance component #5 of 5

Date of installation 2012 Unknown
(mm/dd/yyyy)

Shoreland/Wellhead protection/Food beverage lodging? Yes No

Compliance criteria (select one):

5a. For systems built prior to April 1, 1996, and not located in Shoreland or Wellhead Protection Area or not serving a food, beverage or lodging establishment: Yes No*
Drainfield has at least a two-foot vertical separation distance from periodically saturated soil or bedrock.

5b. Non-performance systems built April 1, 1996, or later or for non-performance systems located in Shoreland or Wellhead Protection Areas or serving a food, beverage, or lodging establishment: Yes No*
Drainfield has a three-foot vertical separation distance from periodically saturated soil or bedrock.*

5c. "Experimental", "Other", or "Performance" systems built under pre-2008 Rules; Type IV or V systems built under 2008 Rules 7080. 2350 or 7080.2400 (Intermediate Inspector License required ≤ 2,500 gallons per day; Advanced Inspector License required > 2,500 gallons per day) Yes No*
Drainfield meets the designed vertical separation distance from periodically saturated soil or bedrock.

Attached supporting documentation:

- Soil observation logs completed for the report
- Two previous verifications of required vertical separation
- Not applicable (No soil treatment area)
- Reviewed design and permit records.

Indicate depths or elevations

| | |
|--|----------------------------|
| A. Bottom of distribution media | See Attached Boring Log(s) |
| B. Periodically saturated soil/bedrock | |
| C. System separation | |
| D. Required compliance separation* | |

*May be reduced up to 15 percent if allowed by Local Ordinance.

***Any "no" answer above indicates the system is failing to protect groundwater.**

Describe verification methods and results:

Upgrade requirements: (Minn. Stat. § 115.55) An imminent threat to public health and safety (ITPHS) must be upgraded, replaced, or its use discontinued within ten months of receipt of this notice or within a shorter period if required by local ordinance. If the system is failing to protect ground water, the system must be upgraded, replaced, or its use discontinued within the time required by local ordinance. If an existing system is not failing as defined in law, and has at least two feet of design soil separation, then the system need not be upgraded, repaired, replaced, or its use discontinued, notwithstanding any local ordinance that is more strict. This provision does not apply to systems in shoreland areas, Wellhead Protection Areas, or those used in connection with food, beverage, and lodging establishments as defined in law.

Property address: 11549 Point Douglas Dr S
 City: Hastings State: MN

Parcel ID: _____
 Zip code: 55033

Optional section: Sewage Tank Compliance Certification (Tank integrity assessment)

This form does not represent a complete system inspection report and only certifies sewage tank compliance status. i.e., this form, completed, may serve as a tank integrity assessment.

Instructions: This section of the form may be completed and signed by a Designated Certified Individual (DCI) of a licensed SSTS Maintenance Business who personally conducts the necessary procedures to assess the compliance status of each sewage tank in the system.

When this section of the form is signed by a qualified certified professional, it becomes *necessary supporting documentation* to an Existing System Compliance Inspection Report: [Compliance inspection form - Existing system \(wq-wwists4-31b\)](https://www.pca.state.mn.us/water/service-and-maintenance). This form can be found on the MPCA website at <https://www.pca.state.mn.us/water/service-and-maintenance>.

The information and certified statement on this form is **required** when existing septic tank compliance status is determined by an individual other than the SSTS Inspector that submits an inspection report. This form represents a third party assessment of SSTS component compliance and is allowable under Minn. R. 7082.0700, subp. 4 Item (B) subitem (1). This form is valid for a period of three years beyond the signature date on this form unless a new evaluation is requested by the owner or owner's agent or is required according to local regulations. Additional Administrative Rule references for this activity can be found at Minn. R. 7082.0700, subp. 4 Items B, C, and D; 7083.0730 Item C.

| | |
|---|--|
| <p><input checked="" type="checkbox"/> Certificate of sewage tank compliance</p> <p>Affirm all three statements:</p> <p><input checked="" type="checkbox"/> The SSTS does not contain a seepage pit, cesspool, drywell, leaching pit, or other pit.</p> <p><input checked="" type="checkbox"/> It does not contain a sewage tank that was designed to be watertight, but subsequently leaks below the designed operating depth.</p> <p><input checked="" type="checkbox"/> It does not represent an imminent safety threat by reason of unsecured, damaged, or weak maintenance hole cover(s) or other unsafe condition.</p> | <p><input type="checkbox"/> Notice of sewage tank non-compliance</p> <p>Select all that apply:</p> <p><input type="checkbox"/> The SSTS has a seepage pit, cesspool, drywell, leaching pit, or other pit – "Failure to Protect Groundwater."</p> <p><input type="checkbox"/> It has a sewage tank that was designed to be watertight, but subsequently leaks below the designed operating depth – "Failure to Protect Groundwater."</p> <p><input type="checkbox"/> It presents a threat to public safety by reason of unsecured, damaged, or weak maintenance hole cover(s) or other unsafe condition – "Imminent Threat to Public Health or Safety."</p> |
|---|--|

Company information

Company name: Ron's Sewer Service
 Business license number: L4007

Designated Certified Individual (DCI) information

Print name: Marc Meyer
 Certification number: C4984

I personally conducted the work described above as a Designated Certified Individual of a Minnesota-licensed SSTS Maintenance Business. I personally conducted the necessary procedures to assess the compliance status of each sewage tank in this SSTS.

By typing/signing my name below, I certify the above statements to be true and correct, to the best of my knowledge, and that this information can be used for the purpose of processing this form.

Designated Certified Individual's signature: Marc Meyer Date (mm/dd/yyyy): 10/19/21

7 of 12
Midwest Sewer Testing

Subsurface Sewage Treatment System Owner/Property Information

This information will be used for the purpose of conducting an MPCA Compliance Inspection.

| | | | |
|--|---|---|--|
| Date of Inspection: October 21, 2021 | | Time: 10:30 AM | |
| Property Address: 11549 W Point Douglas Rd, Cottage Grove, MN | | Zip: 55033 | |
| Property Owner: Mike Schuberg | | Phone: 612-859-8920 | |
| Tank(s) <input checked="" type="checkbox"/> Septic 2 <input type="checkbox"/> Aerobic <input checked="" type="checkbox"/> Lift <input type="checkbox"/> Holding <input type="checkbox"/> Other: | Tank(s)Material <input type="checkbox"/> Fiberglass <input type="checkbox"/> Plastic <input type="checkbox"/> Metal <input checked="" type="checkbox"/> Concrete <input type="checkbox"/> Block <input type="checkbox"/> Other _____ | Soil Treatment System <input type="checkbox"/> Rock trench <input type="checkbox"/> Gravelless trench <input type="checkbox"/> Chamber trench <input type="checkbox"/> Seepage bed <input checked="" type="checkbox"/> Mound <input type="checkbox"/> At-grade _____ | Other <input type="checkbox"/> Alternative system _____ <input type="checkbox"/> Experimental system _____ <input type="checkbox"/> Cesspool system _____ <input type="checkbox"/> Other system _____ |
| Are the tank maintenance covers accessible? <input checked="" type="checkbox"/> Yes <input type="checkbox"/> No *If no, proper maintenance must be performed through the maintenance holes. Maintenance hole covers should be made accessible to the ground surface to facilitate access and proper maintenance of the system. | | | |
| Year house built: 1986 | Year septic installed: 2012 | Tank size (gals.): 1500, 1000 | |
| How long has seller owned the property? | | Number of residents in home? | |
| Number of bedrooms? 4 | Are all floors drained by gravity? | | |
| Garbage disposal? | Whirlpool bath? | | |
| More than one system (laundry, etc.)? | | | |
| Does this property have any footing drain tiles connected to the septic system? | | | |
| Are any buildings on this property such as garages or out-buildings connected to this system? | | | |
| Are there any additional systems on this property serving other buildings? | | | |
| Location of septic system on lot? Tanks - West Side, Mound - South Side | | | |
| Location of water well on lot? North Side | | Is the well a deep well? Y | |
| Have you ever experienced any problems with the system such as: tree roots, sewage back-ups, surfacing of sewage onto the ground, septic tank overflowing, etc.; or have any repairs been made to the system? If yes, explain: | | | |
| When was the system last pumped? 7/22/2021 | | Name of pumper: Ron's Sewer Service | |
| How often pumped in previous years? | | Is system on a monitoring plan? | |
| Have you received notices from any government agency concerning this system? | | | |
| Is your property located in a shoreland management area? N | | | |
| Do you have any additional information that should be given to the new owner? | | | |

I hereby certify that the above information is correct to the best of my knowledge. I also understand that if the system is considered "non-compliant/failing" per MPCA rules, that the inspector must by law submit a copy of this report to the local government unit within 15 days of the date of inspection completion. I also agree that unless otherwise noted in this report, that I/we are ultimately responsible for payment of all fees for all work performed relative to this inspection by Inspect Minnesota and Midwest Soil Testing

Owner/Occupant: _____

Date: _____

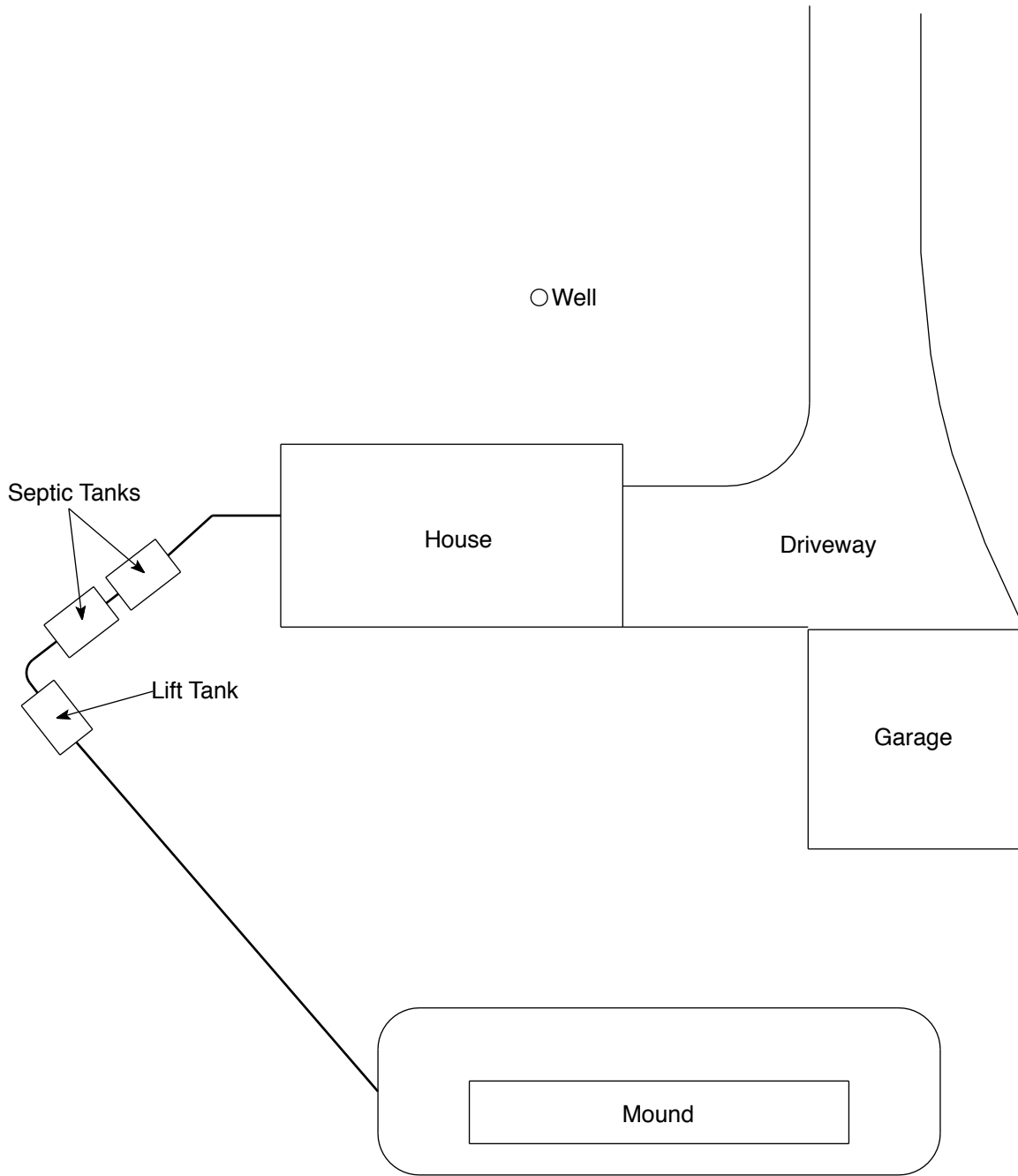

NO SCALE

11549 W Point Douglas Rd, Cottage Grove, MN 55033

U of MN Onsite Sewage Treatment Program Soil Boring Log

Client/ Address: 11549 Point Douglas Drive S. Legal Description/GPS: 36-027-21-42-0014 Date: 20SEP2012
 44° 46' 53.5665" 92° 52' 22.0741"
 Soil Parent Material(s): Till Outwash Lacustrine Alluvium Loess Organic Matter Bedrock SUPERIOR LOESS OUTWASH
 Landscape Position: Summit Shoulder Back/Side Slope Foot Slope Toe Slope
 Vegetation: Soil Survey Map Unit(s): 7C Slope (%):
 HUBBARD LOAMY SAND Slope Shape:

| Depth (in) | Texture | Matrix Color(s) | Mottle Color(s) | Redox Kind(s) | Saturated Soil Indicator(s) (see back) | Structure | | |
|------------|-------------------------|-----------------|-----------------|--|--|--|-------------------------------------|---|
| | | | | | | Shape | Grade | Consistence |
| 0-10" | SILT LOAM | 10 YR 3/2 | | Concentrations Depletions Gleyed | | Granular Blocky Prismatic Single Grain Massive | Weak Moderate Strong Loose | Loose Friable Firm Extremely Firm Rigid |
| 10-24" | LOAMY COARSE SAND | 10 YR 4/1 | | Concentrations Depletions Gleyed | | Granular Blocky Prismatic Single Grain Massive | Weak Moderate Strong Loose | Loose Friable Firm Extremely Firm Rigid |
| | | | | Concentrations Depletions Gleyed | | Granular Play Blocky Prismatic Single Grain Massive | Weak Moderate Strong Loose | Loose Friable Firm Extremely Firm Rigid |
| | | | | Concentrations Depletions Gleyed | | Granular Play Blocky Prismatic Single Grain Massive | Weak Moderate Strong Loose | Loose Friable Firm Extremely Firm Rigid |
| | | | | Concentrations Depletions Gleyed | | Granular Play Blocky Prismatic Single Grain Massive | Weak Moderate Strong Loose | Loose Friable Firm Extremely Firm Rigid |
| | | | | Concentrations Depletions Gleyed | | Granular Play Blocky Prismatic Single Grain Massive | Weak Moderate Strong Loose | Loose Friable Firm Extremely Firm Rigid |

Comments:

Job: 11549 Point Douglas Drive Cottage Grove
 Date: 8-8-12

LOG OF SOIL BORINGS

| Depth in Feet | B1 | B2 | B3 | B4 |
|---------------|--|---|---|---|
| 1 | TOPSOIL 10YR2/1 | TOPSOIL 10YR2/1 | TOPSOIL 10YR2/1 | TOPSOIL 10YR2/1 |
| 1 | DARK BROWN SANDY LOAM 10YR3/3 | | DARK BROWN SANDY LOAM 10YR3/3 | |
| 2 | | MEDIUM TO DARK BROWN SANDY LOAM 10YR4/4 | YELLOW BROWN MEDIUM SAND 10YR5/6 | MEDIUM TO DARK BROWN SANDY LOAM 10YR4/4 |
| 8 | YELLOW BROWN MEDIUM SAND 10YR5/6 | | DARK YELLOW BROWN MEDIUM SAND w/ REDOX @ 40" 10YR3/4 | DARK YELLOW BROWN MEDIUM SAND 10YR3/4 |
| 4 | w/ REDOX @ 40" | | REDOX @ 42" | w/ REDOX @ 44" |
| 5 | YELLOW BROWN MEDIUM SAND 10YR5/6 | DARK YELLOW BROWN MEDIUM SAND 10YR3/6 | | LIMESTONE |
| 6 | LIMESTONE | | | |
| 7 | | | | |

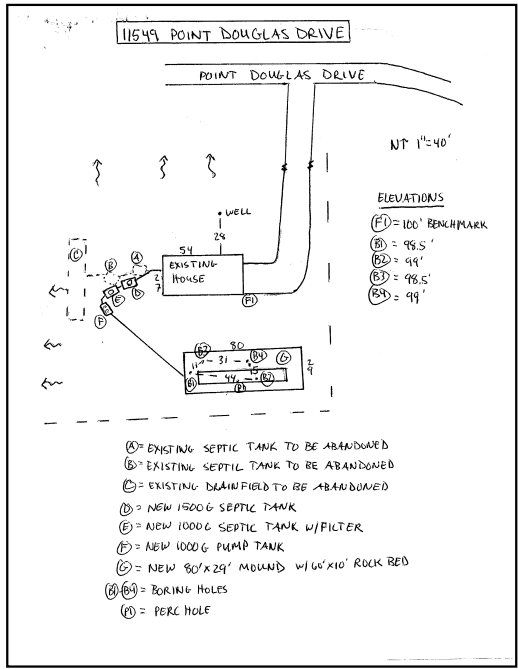

Owner: _____ 10 of 12 Parcel Number: _____
 Street/City/Zip Code: 11549 Point Douglas Drive south Cottage Grove
 Lot: _____ Section: _____ Township: _____ N Range: _____ W
 Installation Date: 10-4-12 Installer: Capa's License Number: 1810
 Is the system in Shoreland, serving a MDH facility or in a Wellhead Protection area? YES NO
 Number of Bedrooms/ Flow Rate: 600 #/gpd Septic Tanks, No & Size: 2300 #/gal
 Pump Tank Size: 1000 gal Tank Manufacturer: Precast Model # 59000
 Date of Manufacture: 8-8-12 Maximum Burial Depth: 6'
 Pump Size: .5 hp 34 gpm 16 ft of TDH Floats properly set? YES NO

Soil Treatment Area:
 TYPE I TYPE II TYPE III TYPE IV TYPE V
 TRENCH BED MOUND AT-GRADE WARRANTIED OTHER: _____

Limiting Layer/Depth: _____ " Rockbed Size: 10' x 60' Describe: _____
 Depth from Surface: _____ " Adsorption width: 15'
 Rock or Slat depth: _____ " Sand depth: 1 foot
 Diameter of Gravelless: _____ " (under mound)
 Trench Width: _____ ft
 Bottom Square Feet Area: _____ ft²

Design Variances: _____

Site Drawing:

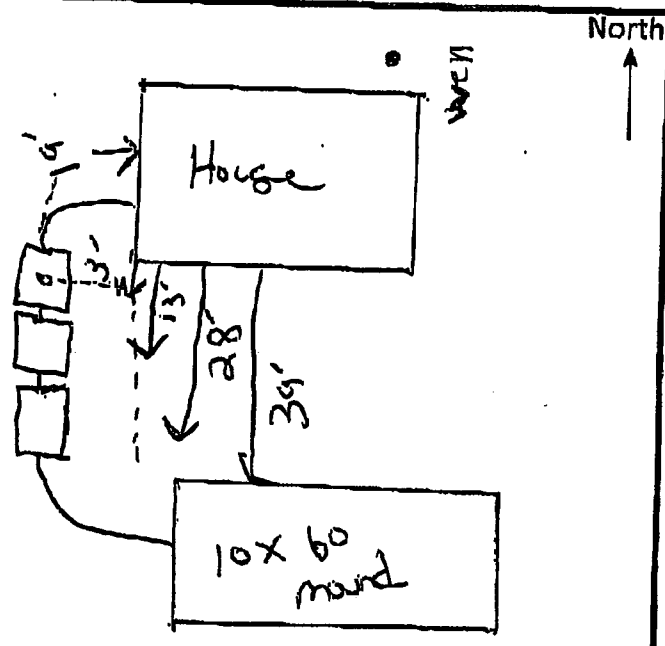

- Items to be identified:
1. Septic, holding and pump tanks, piping, and soil system configuration. Label bed or trench width and length or rockbed size, adsorption width and final dimensions. Indicate alarm location.
 2. Show all setbacks from tank and soil system
 - a. Property boundaries
 - b. Buildings
 - c. Wells
 - d. Water bodies
 - e. Road right-of-way
 3. Improvements - present and future.
 4. Benchmark location and distance of tank and soil system from benchmark
 5. Replacement site
 6. Abandoned system

Reverse Side
 →

DISCLAIMER

Brian L. Humpal, Inc. dba. Midwest Sewer Services, Inspect Minnesota, Midwest Soil Testing Relative to Subsurface Sewage Treatment System (SSTS) Compliance Inspections

1. This inspection/report is being performed for only the seller/owner of the property on which the SSTS is located. In such case that another party is paying for the inspection, the contract is between only said party and Brian L. Humpal, Inc.; there is no contract between Brian L. Humpal, Inc. and any other party unless otherwise noted.
3. Brian L. Humpal, Inc. has not been retained to warranty, guarantee, or certify the proper functioning of the SSTS for any period of time beyond the date of inspection or into the future. Because of the numerous factors (usage, maintenance, soil characteristics, previous failures, etc.) which may affect the proper operation of an SSTS, as well as the inability of Brian L. Humpal, Inc. to supervise or monitor the use or maintenance of the SSTS, the report shall not be construed as a warranty by Brian L. Humpal, Inc. that the SSTS will function properly for any particular party for any period of time.
4. Brian L. Humpal, Inc. is unable to verify the frequency and/or, quality of prior or future maintenance of the SSTS. Maintenance of the tank(s) must be performed through the tanks maintenance hole. The removal of solids from any location other than the maintenance hole is not a compliant method of maintenance. It is strongly recommended that maintenance covers be made accessible to the ground surface to facilitate proper maintenance.
5. Minimum Compliance Inspection requirements relative to this inspection and this report include only verification that the SSTS has tank(s) (septic tanks, lift tanks, dosing tanks, stilling tanks, etc.) which are watertight below the designed operating depth, the required separation between the bottom of the subsurface soil distribution medium and seasonally saturated soils, no back-ups of sewage into the dwelling, no discharge of sewage/effluent to the ground surface or surface waters, and no imminent safety hazards. Brian L. Humpal, Inc. does not inspect plumbing or pumps prior to the first SSTS component as these are plumbing components. The performance of exterior pumps and associated components are not inspected as they are considered to be maintenance items. Additionally, no indications relative to compliance with electrical code requirements have been made. It is recommended that any other applicable plumbing, electrical, housing, etc. inspections be performed by a qualified inspection business. Sewage back-up verification is limited to observing the floor drain area and/or the information supplied by the last occupants of the building prior to inspection. Brian L. Humpal, Inc. cannot guarantee that the information given to them by the last occupants of the building prior to inspection relative to back-ups is accurate.
4. Certification of this SSTS does not warranty future use beyond the date of the inspection. Any SSTS, old or new, can become hydraulically overloaded or discharge sewage/effluent to the ground surface as a result of more people moving into the house than were previously occupying the house, improper maintenance, heavy usage, leaking plumbing fixtures, groundwater infiltration, tree roots, freezing conditions, surface drainage problems, poor initial design, poor construction practices, or unsuitable materials used in constructing the system; the system can also simply stop working because of its age. An SSTS that has been properly designed and installed, properly maintained, and used in the manner for which the system was designed can be expected to provide service for twenty to twenty-five years on average. Some parts of the SSTS such as alarms, switches, pumps, filters, etc. will most likely have to be repaired or replaced over the lifetime of the system.
5. A Compliance Inspection is not meant to be a test or inspection for longevity of the system; a Compliance Inspection is strictly for the purpose of determining if the SSTS is protective of public health and safety, as well as the groundwater at the date and time the inspection was performed. This inspection is not intended to determine if the SSTS was originally designed or installed to past or present MPCA or other Local Government Unit code requirements. This inspection is not intended to determine if the SSTS was designed and/or installed to support the anticipated flow from the building as the use of the building may have changed since the design and construction of the SSTS due to the addition of bedrooms, occupants, etc. In addition, this inspection is not intended to determine the quality of the original SSTS design, the quality of the construction practices used while installing the SSTS, or the quality of the materials used in constructing the SSTS.
6. Brian L. Humpal, Inc. cannot guarantee the performance of SSTS products/components such as: gravelless pipe, chamber trenches, effluent filters, tanks, sewage pre-treatment components, piping, etc. Products such as gravelless pipe are no longer approved for installation in the State of Minnesota and may have a significantly reduced performance and/or life expectancy.
7. WINTER WORK: By accepting this report, it is understood that inspections conducted during winter months (approximately November 1st through April 1st) are more difficult to perform because of possible snow cover and/or ground frost. SSTS components such as tanks, maintenance covers, tank inspection pipes, subsurface distribution medium inspection pipes, and soil treatment areas are more difficult or impossible to locate due to snow cover and/or ground frost. In addition, soil borings are more difficult to perform due to snow cover and/or ground frost. Brian L. Humpal, Inc. will attempt to use the same level of standards when performing work during winter periods as when performing work during non-winter periods. However, the recipient of this report understands that because of the aforementioned considerations, the same level of standards may not be possible.
8. By accepting this report, the client understands that Brian L. Humpal, Inc. will not be responsible for any monetary damages exceeding the fee for the services provided.

Subsurface Sewage Treatment Systems

Non-transferable

Business License

Midwest Sewer Services

License # L2896

License Expires: 12/22/2021

Issued: 11/06/2020

Specialty Area(s):

Installer

Maintainer

Service Provider

Advanced Designer

Advanced Inspector

Designated Certified Individual(s):

| Cert # | Name | Certification Expires: |
|--------|---|------------------------|
| C5342 | Brian L Humpal Installer, Maintainer, Serv Prov, Adv Designer, Adv Inspector | 10/15/2023 |
| C9852 | Christopher R Uebe Designer, Inspector | 3/4/2024 |



520 Lafayette Road North
St. Paul, Minnesota 55155-4194

Nick Haig

Nick Haig, Supervisor
Certification and Training Unit