

---

---

# Midwest Sewer Services

---

---

P.O. Box 10853 White Bear Lake, MN 55110  
651-492-7550/Brian@Midwestsoiltesting.com

Brian Humpal  
MPCA Licensed Advanced Inspector

---

## **SUBSURFACE SEWAGE TREATMENT SYSTEM (SSTS) COMPLIANCE REPORT**

---

**Date:** 12/9/2021 & 12/17/2021      **Time:** 12:00 PM      **Owner:** Jaime Junker (Buyer)

**Inspection Address:** 11550 Stillwater Blvd N, Lake Elmo, MN 55042

---

### **REPORT SUMMARY**

I have performed an “MPCA Compliance Inspection” on this system and have reviewed the limited original design/permit records on file at the City of Lake Elmo. This older system (installed in 1999) consists of two pre-cast septic tanks, a pre-cast lift tank, and a seepage bed. Pinky’s Sewer Service pumped the septic tanks on December 9, 2021.

At the time of our inspection on December 9, 2021, the lift pump was not operating. The lift pump was repaired/replaced on December 17, 2021.

My inspection indicates that this system is presently “non-compliant” in accordance with MPCA rules 7080.1500 Subp.4(B)(D) because of the lack of the required three foot separation between the bottom of the drainfield and seasonally saturated soils.

In accordance with MPCA rules, I am sending a copy of this complete report to Washington County. I cannot officially speak on behalf of the County relative to the upgrade requirements of these non-compliant systems. Please contact the Washington County Department of Public Health & Environment (651-430-6655) to verify the County’s position.

Please advise buyer, agents, lender, etc. to contact me should they have any questions regarding this system.



---

Christopher Uebe

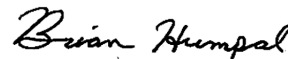

---

Brian Humpal

# Compliance inspection report form

## Existing Subsurface Sewage Treatment System (SSTS)

Doc Type: Compliance and Enforcement

**Instructions: Inspector must submit completed form to Local Governmental Unit (LGU) and system owner within 15 days of final determination of compliance or noncompliance.** Instructions for filling out this form are located on the Minnesota Pollution Control Agency (MPCA) website at <https://www.pca.state.mn.us/sites/default/files/wq-wwists4-31a.pdf>.

### Property information

Local tracking number: \_\_\_\_\_

Parcel ID# or Sec/Twp/Range: \_\_\_\_\_ Reason for Inspection \_\_\_\_\_ Property Transfer \_\_\_\_\_

Local regulatory authority info: Washington CountyProperty address: 11550 Stillwater Blvd N, Lake Elmo, MN 55042Owner/representative: Jaime Junker (Buyer) Owner's phone: 651-246-1058Brief system description: Two pre-cast septic tanks, a pre-cast lift tank, and a seepage bed.

### System status

System status on date (mm/dd/yyyy): 12/17/2021 **Compliant – Certificate of compliance\***

*(Valid for 3 years from report date unless evidence of an imminent threat to public health or safety requiring removal and abatement under section 145A.04, subdivision 8 is discovered or a shorter time frame exists in Local Ordinance.)*

**\*Note: Compliance indicates conformance with Minn. R. 7080.1500 as of system status date above and does not guarantee future performance.**

 **Noncompliant – Notice of noncompliance**

*Systems failing to protect ground water must be upgraded, replaced, or use discontinued within the time required by local ordinance.*

*An imminent threat to public health and safety (ITPHS) must be upgraded, replaced, or its use discontinued within ten months of receipt of this notice or within a shorter period if required by local ordinance or under section 145A.04 subdivision 8.*

#### Reason(s) for noncompliance (check all applicable)

- Impact on public health (Compliance component #1) – *Imminent threat to public health and safety*
- Tank integrity (Compliance component #2) – *Failing to protect groundwater*
- Other Compliance Conditions (Compliance component #3) – *Imminent threat to public health and safety*
- Other Compliance Conditions (Compliance component #3) – *Failing to protect groundwater*
- System not abandoned according to Minn. R. 7080.2500 (Compliance component #3) – *Failing to protect groundwater*
- Soil separation (Compliance component #5) – *Failing to protect groundwater*
- Operating permit/monitoring plan requirements (Compliance component #4) – *Noncompliant - local ordinance applies*

#### Comments or recommendations

### Certification

*I hereby certify that all the necessary information has been gathered to determine the compliance status of this system. No determination of future system performance has been nor can be made due to unknown conditions during system construction, possible abuse of the system, inadequate maintenance, or future water usage.*

**By typing my name below, I certify the above statements to be true and correct, to the best of my knowledge, and that this information can be used for the purpose of processing this form.**

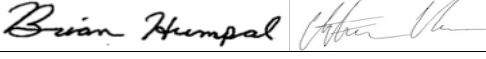
Business name: Midwest Sewer Services Certification number: 5342/9852Inspector signature:  License number: L2896  
(This document has been electronically signed) Phone: 651-492-7550

### Necessary or locally required supporting documentation (must be attached)

- Soil observation logs     System/As-Built     Locally required forms     Tank Integrity Assessment     Operating Permit
- Other information (list): Report Summary, Property Information, Disclaimer, License

Property Address: 11550 Stillwater Blvd N, Lake Elmo, MN 55042

Business Name: Midwest Sewer Services

Date: 12/17/2021

**1. Impact on public health – Compliance component #1 of 5**

**Compliance criteria:**

System discharges sewage to the ground surface	<input type="checkbox"/> Yes* <input checked="" type="checkbox"/> No
System discharges sewage to drain tile or surface waters.	<input type="checkbox"/> Yes* <input checked="" type="checkbox"/> No
System causes sewage backup into dwelling or establishment.	<input type="checkbox"/> Yes* <input checked="" type="checkbox"/> No

**Attached supporting documentation:**

- Other: \_\_\_\_\_
- Not applicable

**Any "yes" answer above indicates the system is an imminent threat to public health and safety.**

**Describe verification methods and results:**

None of the above found.

**2. Tank integrity – Compliance component #2 of 5**

**Compliance criteria:**

System consists of a seepage pit, cesspool, drywell, leaching pit, or other pit?	<input type="checkbox"/> Yes* <input checked="" type="checkbox"/> No
Sewage tank(s) leak below their designed operating depth?	<input type="checkbox"/> Yes* <input checked="" type="checkbox"/> No
If yes, which sewage tank(s) leaks:	

**Attached supporting documentation:**

- Empty tank(s) viewed by inspector
  - Name of maintenance business: Pinky's Sewer Service
  - License number of maintenance business: L1673
  - Date of maintenance: 12/9/2021
- Existing tank integrity assessment (Attach)
  - Date of maintenance (mm/dd/yyyy): \_\_\_\_\_ (must be within three years)
  - (See form instructions to ensure assessment complies with Minn. R. 7082.0700 subp. 4 B (1))
- Tank is Noncompliant (pumping not necessary – explain below)
- Other: \_\_\_\_\_

**Any "yes" answer above indicates the system is failing to protect groundwater.**

**Describe verification methods and results:**

This is not a certification of the tanks for reuse; tanks will need to be certified by a designer, installer, or pumper for reuse.

Property Address: 11550 Stillwater Blvd N, Lake Elmo, MN 55042

Business Name: Midwest Sewer Services

Date: 12/17/2021

### 3. Other compliance conditions – Compliance component #3 of 5

3a. Maintenance hole covers appear to be structurally unsound (damaged, cracked, etc.), or unsecured?

Yes\*  No  Unknown

3b. Other issues (*electrical hazards, etc.*) to immediately and adversely impact public health or safety?  Yes\*  No  Unknown

**\*Yes to 3a or 3b - System is an imminent threat to public health and safety.**

3c. System is non-protective of ground water for other conditions as determined by inspector?  Yes\*  No

3d. System not abandoned in accordance with Minn. R. 7080.2500?  Yes\*  No

**\*Yes to 3c or 3d - System is failing to protect groundwater.**

**Describe verification methods and results:**

Attached supporting documentation:  Not applicable

### 4. Operating permit and nitrogen BMP\* – Compliance component #4 of 5 Not applicable

Is the system operated under an Operating Permit?  Yes  No **If “yes”, A below is required**

Is the system required to employ a Nitrogen BMP specified in the system design?  Yes  No **If “yes”, B below is required**

*BMP = Best Management Practice(s) specified in the system design*

**If the answer to both questions is “no”, this section does not need to be completed.**

**Compliance criteria:**

a. Have the operating permit requirements been met?  Yes  No

b. Is the required nitrogen BMP in place and properly functioning?  Yes  No

**Any “no” answer indicates noncompliance.**

**Describe verification methods and results:**

Attached supporting documentation:  Operating permit (Attach)

Property Address: 11550 Stillwater Blvd N, Lake Elmo, MN 55042

Business Name: Midwest Sewer Services

Date: 12/17/2021

**5. Soil separation – Compliance component #5 of 5**

Date of installation 1999  Unknown  
(mm/dd/yyyy)

Shoreland/Wellhead protection/Food beverage lodging?  Yes  No

**Compliance criteria (select one):**

5a. For systems built prior to April 1, 1996, and not located in Shoreland or Wellhead Protection Area or not serving a food, beverage or lodging establishment:  Yes  No\*  
Drainfield has at least a two-foot vertical separation distance from periodically saturated soil or bedrock.

5b. Non-performance systems built April 1, 1996, or later or for non-performance systems located in Shoreland or Wellhead Protection Areas or serving a food, beverage, or lodging establishment:  Yes  No\*  
Drainfield has a three-foot vertical separation distance from periodically saturated soil or bedrock.\*

5c. "Experimental", "Other", or "Performance" systems built under pre-2008 Rules; Type IV or V systems built under 2008 Rules 7080. 2350 or 7080.2400 (Intermediate Inspector License required ≤ 2,500 gallons per day; Advanced Inspector License required > 2,500 gallons per day)  Yes  No\*  
Drainfield meets the designed vertical separation distance from periodically saturated soil or bedrock.

**Attached supporting documentation:**

- Soil observation logs completed for the report
- Two previous verifications of required vertical separation
- Not applicable (No soil treatment area)
- \_\_\_\_\_

**Indicate depths or elevations**

A. Bottom of distribution media	See Attached Boring Log(s)
B. Periodically saturated soil/bedrock	
C. System separation	
D. Required compliance separation*	

\*May be reduced up to 15 percent if allowed by Local Ordinance.

**\*Any "no" answer above indicates the system is failing to protect groundwater.**

**Describe verification methods and results:**

**Upgrade requirements:** (Minn. Stat. § 115.55) An imminent threat to public health and safety (ITPHS) must be upgraded, replaced, or its use discontinued within ten months of receipt of this notice or within a shorter period if required by local ordinance. If the system is failing to protect ground water, the system must be upgraded, replaced, or its use discontinued within the time required by local ordinance. If an existing system is not failing as defined in law, and has at least two feet of design soil separation, then the system need not be upgraded, repaired, replaced, or its use discontinued, notwithstanding any local ordinance that is more strict. This provision does not apply to systems in shoreland areas, Wellhead Protection Areas, or those used in connection with food, beverage, and lodging establishments as defined in law.

8 of 10  
**Midwest Sewer Testing**

**Subsurface Sewage Treatment System Owner/Property Information**

This information will be used for the purpose of conducting an MPCA Compliance Inspection.

Date of Inspection: 12/9/21 & 12/17/21		Time: 12:00 PM																													
Property Address: 11550 Stillwater Blvd N, Lake Elmo, MN		Zip: 55042																													
Property Owner:		Phone:																													
<table style="width: 100%; border: none;"> <tr> <td style="width: 25%;"><u>Tank(s)</u></td> <td style="width: 25%;"><u>Tank(s)Material</u></td> <td style="width: 25%;"><u>Soil Treatment System</u></td> <td style="width: 25%;"><u>Other</u></td> </tr> <tr> <td><input checked="" type="checkbox"/> Septic 2</td> <td><input type="checkbox"/> Fiberglass</td> <td><input type="checkbox"/> Rock trench</td> <td><input type="checkbox"/> Alternative system _____</td> </tr> <tr> <td><input type="checkbox"/> Aerobic</td> <td><input type="checkbox"/> Plastic</td> <td><input type="checkbox"/> Gravelless trench</td> <td><input type="checkbox"/> Experimental system _____</td> </tr> <tr> <td><input checked="" type="checkbox"/> Lift</td> <td><input type="checkbox"/> Metal</td> <td><input type="checkbox"/> Chamber trench</td> <td><input type="checkbox"/> Cesspool system _____</td> </tr> <tr> <td><input type="checkbox"/> Holding</td> <td><input checked="" type="checkbox"/> Concrete</td> <td><input checked="" type="checkbox"/> Seepage bed</td> <td><input type="checkbox"/> Other system _____</td> </tr> <tr> <td><input type="checkbox"/> Other:</td> <td><input type="checkbox"/> Block</td> <td><input type="checkbox"/> Mound</td> <td>_____</td> </tr> <tr> <td></td> <td><input type="checkbox"/> Other _____</td> <td><input type="checkbox"/> At-grade</td> <td>_____</td> </tr> </table>	<u>Tank(s)</u>	<u>Tank(s)Material</u>	<u>Soil Treatment System</u>	<u>Other</u>	<input checked="" type="checkbox"/> Septic 2	<input type="checkbox"/> Fiberglass	<input type="checkbox"/> Rock trench	<input type="checkbox"/> Alternative system _____	<input type="checkbox"/> Aerobic	<input type="checkbox"/> Plastic	<input type="checkbox"/> Gravelless trench	<input type="checkbox"/> Experimental system _____	<input checked="" type="checkbox"/> Lift	<input type="checkbox"/> Metal	<input type="checkbox"/> Chamber trench	<input type="checkbox"/> Cesspool system _____	<input type="checkbox"/> Holding	<input checked="" type="checkbox"/> Concrete	<input checked="" type="checkbox"/> Seepage bed	<input type="checkbox"/> Other system _____	<input type="checkbox"/> Other:	<input type="checkbox"/> Block	<input type="checkbox"/> Mound	_____		<input type="checkbox"/> Other _____	<input type="checkbox"/> At-grade	_____	<p>Are the tank maintenance covers accessible? <input checked="" type="checkbox"/> Yes <input type="checkbox"/> No *If no, proper maintenance must be performed through the maintenance holes. Maintenance hole covers should be made accessible to the ground surface to facilitate access and proper maintenance of the system.</p>		
<u>Tank(s)</u>	<u>Tank(s)Material</u>	<u>Soil Treatment System</u>	<u>Other</u>																												
<input checked="" type="checkbox"/> Septic 2	<input type="checkbox"/> Fiberglass	<input type="checkbox"/> Rock trench	<input type="checkbox"/> Alternative system _____																												
<input type="checkbox"/> Aerobic	<input type="checkbox"/> Plastic	<input type="checkbox"/> Gravelless trench	<input type="checkbox"/> Experimental system _____																												
<input checked="" type="checkbox"/> Lift	<input type="checkbox"/> Metal	<input type="checkbox"/> Chamber trench	<input type="checkbox"/> Cesspool system _____																												
<input type="checkbox"/> Holding	<input checked="" type="checkbox"/> Concrete	<input checked="" type="checkbox"/> Seepage bed	<input type="checkbox"/> Other system _____																												
<input type="checkbox"/> Other:	<input type="checkbox"/> Block	<input type="checkbox"/> Mound	_____																												
	<input type="checkbox"/> Other _____	<input type="checkbox"/> At-grade	_____																												
Year house built: 1999	Year septic installed: 1999	Tank size (gals.): 2-1500																													
How long has seller owned the property?		Number of residents in home?																													
Number of bedrooms? N/A	Are all floors drained by gravity?																														
Garbage disposal?	Whirlpool bath?																														
More than one system (laundry, etc.)?																															
Does this property have any footing drain tiles connected to the septic system?																															
Are any buildings on this property such as garages or out-buildings connected to this system?																															
Are there any additional systems on this property serving other buildings?																															
Location of septic system on lot? East Side																															
Location of water well on lot? North Side		Is the well a deep well? Y																													
Have you ever experienced any problems with the system such as: tree roots, sewage back-ups, surfacing of sewage onto the ground, septic tank overflowing, etc.; or have any repairs been made to the system? If yes, explain:																															
When was the system last pumped? 12/9/2021		Name of pumper: Pinky's Sewer Service																													
How often pumped in previous years?		Is system on a monitoring plan?																													
Have you received notices from any government agency concerning this system?																															
Is your property located in a shoreland management area? N																															
Do you have any additional information that should be given to the new owner?																															

I hereby certify that the above information is correct to the best of my knowledge. I also understand that if the system is considered "non-compliant/failing" per MPCA rules, that the inspector must by law submit a copy of this report to the local government unit within 15 days of the date of inspection completion. I also agree that unless otherwise noted in this report, that I/we are ultimately responsible for payment of all fees for all work performed relative to this inspection by Inspect Minnesota and Midwest Soil Testing

Owner/Occupant: \_\_\_\_\_

Date: \_\_\_\_\_

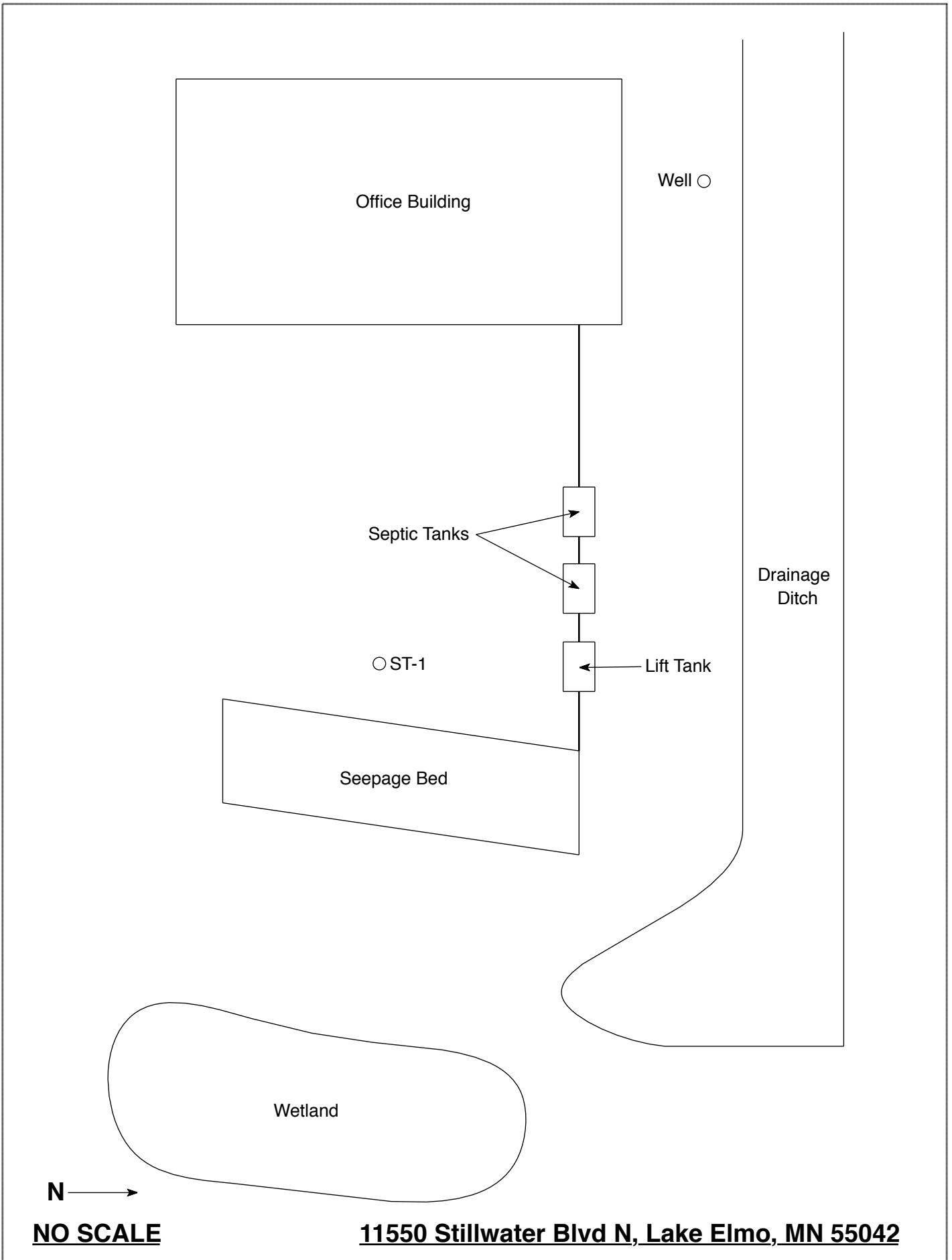

Office Building

Well ○

Septic Tanks

○ST-1

Lift Tank

Seepage Bed

Drainage Ditch

Wetland

N →

**NO SCALE**

**11550 Stillwater Blvd N, Lake Elmo, MN 55042**

## Soil Observations Log

Location of Project:		11550 Stillwater Blvd N, Lake Elmo, MN 55042			
Observations Made By:		Midwest Sewer Services		Date:	12/9/2021
Classification System:		USDA			
Soil Observation:		ST-1			
Surface Elevation of Observation		Same ground surface as seepage bed		Surface Elevation of Observation	
Depth In Inches	Rock %	<u>Soils Encountered</u>		Depth In Inches	Rock %
0-24		10YR 3/3 Silt Loam With Till Mottles 10YR 3/4 Clay Loam 10YR 4/4 Silt Loam 10YR 3/4 Silt Loam 10YR 3/4 Silt Loam With 7.5YR 5/8 & 10YR 6/2 Redox			
24-34					
34-40					
40-56					
56-65					
56"	Depth To End Of Soil Observation Or Redox			Depth To End Of Soil Observation Or Redox	
Same	Elevation Of Observation Relative To System			Elevation Of Observation Relative To System	
-33"	Depth To Bottom Of Distribution Media			Depth To Bottom Of Distribution Media	
=23"	Of Separation			Of Separation	
End Of Soil Observation At:		65"	End Of Soil Observation At:		
Limiting Soil Conditions At:		56"	Limiting Soil Conditions At:		
Standing Water Present At:		None	Standing Water Present At:		

Bottom Of Distribution Medium At: 33 Inches

---



---

Signature: \_\_\_\_\_





## **DISCLAIMER**

### Brian L. Humpal, Inc. dba. Midwest Sewer Services, Inspect Minnesota, Midwest Soil Testing Relative to Subsurface Sewage Treatment System (SSTS) Compliance Inspections

1. This inspection/report is being performed for only the seller/owner of the property on which the SSTS is located. In such case that another party is paying for the inspection, the contract is between only said party and Brian L. Humpal, Inc.; there is no contract between Brian L. Humpal, Inc. and any other party unless otherwise noted.
3. Brian L. Humpal, Inc. has not been retained to warranty, guarantee, or certify the proper functioning of the SSTS for any period of time beyond the date of inspection or into the future. Because of the numerous factors (usage, maintenance, soil characteristics, previous failures, etc.) which may affect the proper operation of an SSTS, as well as the inability of Brian L. Humpal, Inc. to supervise or monitor the use or maintenance of the SSTS, the report shall not be construed as a warranty by Brian L. Humpal, Inc. that the SSTS will function properly for any particular party for any period of time.
4. Brian L. Humpal, Inc. is unable to verify the frequency and/or, quality of prior or future maintenance of the SSTS. Maintenance of the tank(s) must be performed through the tanks maintenance hole. The removal of solids from any location other than the maintenance hole is not a compliant method of maintenance. It is strongly recommended that maintenance covers be made accessible to the ground surface to facilitate proper maintenance.
5. Minimum Compliance Inspection requirements relative to this inspection and this report include only verification that the SSTS has tank(s) (septic tanks, lift tanks, dosing tanks, stilling tanks, etc.) which are watertight below the designed operating depth, the required separation between the bottom of the subsurface soil distribution medium and seasonally saturated soils, no back-ups of sewage into the dwelling, no discharge of sewage/effluent to the ground surface or surface waters, and no imminent safety hazards. Brian L. Humpal, Inc. does not inspect plumbing or pumps prior to the first SSTS component as these are plumbing components. The performance of exterior pumps and associated components are not inspected as they are considered to be maintenance items. Additionally, no indications relative to compliance with electrical code requirements have been made. It is recommended that any other applicable plumbing, electrical, housing, etc. inspections be performed by a qualified inspection business. Sewage back-up verification is limited to observing the floor drain area and/or the information supplied by the last occupants of the building prior to inspection. Brian L. Humpal, Inc. cannot guarantee that the information given to them by the last occupants of the building prior to inspection relative to back-ups is accurate.
4. Certification of this SSTS does not warranty future use beyond the date of the inspection. Any SSTS, old or new, can become hydraulically overloaded or discharge sewage/effluent to the ground surface as a result of more people moving into the house than were previously occupying the house, improper maintenance, heavy usage, leaking plumbing fixtures, groundwater infiltration, tree roots, freezing conditions, surface drainage problems, poor initial design, poor construction practices, or unsuitable materials used in constructing the system; the system can also simply stop working because of its age. An SSTS that has been properly designed and installed, properly maintained, and used in the manner for which the system was designed can be expected to provide service for twenty to twenty-five years on average. Some parts of the SSTS such as alarms, switches, pumps, filters, etc. will most likely have to be repaired or replaced over the lifetime of the system.
5. A Compliance Inspection is not meant to be a test or inspection for longevity of the system; a Compliance Inspection is strictly for the purpose of determining if the SSTS is protective of public health and safety, as well as the groundwater at the date and time the inspection was performed. This inspection is not intended to determine if the SSTS was originally designed or installed to past or present MPCA or other Local Government Unit code requirements. This inspection is not intended to determine if the SSTS was designed and/or installed to support the anticipated flow from the building as the use of the building may have changed since the design and construction of the SSTS due to the addition of bedrooms, occupants, etc. In addition, this inspection is not intended to determine the quality of the original SSTS design, the quality of the construction practices used while installing the SSTS, or the quality of the materials used in constructing the SSTS.
6. Brian L. Humpal, Inc. cannot guarantee the performance of SSTS products/components such as: gravelless pipe, chamber trenches, effluent filters, tanks, sewage pre-treatment components, piping, etc. Products such as gravelless pipe are no longer approved for installation in the State of Minnesota and may have a significantly reduced performance and/or life expectancy.
7. WINTER WORK: By accepting this report, it is understood that inspections conducted during winter months (approximately November 1<sup>st</sup> through April 1<sup>st</sup>) are more difficult to perform because of possible snow cover and/or ground frost. SSTS components such as tanks, maintenance covers, tank inspection pipes, subsurface distribution medium inspection pipes, and soil treatment areas are more difficult or impossible to locate due to snow cover and/or ground frost. In addition, soil borings are more difficult to perform due to snow cover and/or ground frost. Brian L. Humpal, Inc. will attempt to use the same level of standards when performing work during winter periods as when performing work during non-winter periods. However, the recipient of this report understands that because of the aforementioned considerations, the same level of standards may not be possible.
8. By accepting this report, the client understands that Brian L. Humpal, Inc. will not be responsible for any monetary damages exceeding the fee for the services provided.

# Subsurface Sewage Treatment Systems

Non-transferable

# Business License

Midwest Sewer Services

License # L2896

License Expires: 12/22/2021

Issued: 11/06/2020

## Specialty Area(s):

Installer

Maintainer

Service Provider

Advanced Designer

Advanced Inspector

## Designated Certified Individual(s):

Cert #	Name	Certification Expires:
C5342	Brian L Humpal Installer, Maintainer, Serv Prov, Adv Designer, Adv Inspector	10/15/2023
C9852	Christopher R Uebe Designer, Inspector	3/4/2024



520 Lafayette Road North  
St. Paul, Minnesota 55155-4194

*Nick Haig*

Nick Haig, Supervisor  
Certification and Training Unit