

# ZIERKE SOIL TESTING

Michael LeGare  
23243 St Croix Trl N  
Scandia, MN 55073

4/18/2022

Dear Michael LeGare,

At your request, I have conducted a septic inspection to determine the compliance status of your septic system pursuant to Minnesota Rules Chapter 7080.1500.

The compliance test set out in 7080.1500 has three main inquiries: 1). Is the system functioning hydraulically (disposing of effluent in a manner that prevents it from coming in contact with people)? 2). Are the septic tanks water tight? 3). Does the system have sufficient vertical separation between the bottom of the septic system and restrictive layers (bedrock, standing water, seasonally wet layers, etc) to provide full treatment of effluent?

Based off of these criteria, your septic system is compliant. A certification of compliance is in effect for three years from the date it is issued. To be clear, this should not be construed as a guarantee of future system function – there are too many factors that influence the lifespan of a septic system for an inspector to predict or even guess how long a septic system will last. A copy of this report will be filed with your local unit of government for their records.

Sincerely,



Benjamin Zierke  
MPCA Lic 119, Cert 9594

ADDRESS:  
28587 Jeffrey Ave  
Chisago City, MN 55013

PHONE 651-249-1346  
EMAIL benzierke@gmail.com

# Compliance inspection report form

## Existing Subsurface Sewage Treatment System (SSTS)

Doc Type: Compliance and Enforcement

**Instructions: Inspector must submit completed form to Local Governmental Unit (LGU) and system owner within 15 days of final determination of compliance or noncompliance.** Instructions for filling out this form are located on the Minnesota Pollution Control Agency (MPCA) website at <https://www.pca.state.mn.us/sites/default/files/wq-wwists4-31a.pdf>.

### Property information

Local tracking number: \_\_\_\_\_

Parcel ID# or Sec/Twp/Range: 0603219340004 Reason for Inspection Sale

Local regulatory authority info: Washington County

Property address: 23243 St Croix Trl N Scandia, MN 55073

Owner/representative: Michael LeGare Owner's phone: 651-231-2466

Brief system description: Round 1200 gallon septic tank, 1000 gallon septic tank, 1000 gallon lift tank, drop box rock trench drainfield

### System status

System status on date (mm/dd/yyyy): 4/18/2022

**Compliant – Certificate of compliance\***

*(Valid for 3 years from report date unless evidence of an imminent threat to public health or safety requiring removal and abatement under section 145A.04, subdivision 8 is discovered or a shorter time frame exists in Local Ordinance.)*

**\*Note: Compliance indicates conformance with Minn. R. 7080.1500 as of system status date above and does not guarantee future performance.**

**Noncompliant – Notice of noncompliance**

*Systems failing to protect ground water must be upgraded, replaced, or use discontinued within the time required by local ordinance.*

*An imminent threat to public health and safety (ITPHS) must be upgraded, replaced, or its use discontinued within ten months of receipt of this notice or within a shorter period if required by local ordinance or under section 145A.04 subdivision 8.*

#### Reason(s) for noncompliance (check all applicable)

- Impact on public health (Compliance component #1) – *Imminent threat to public health and safety*
- Tank integrity (Compliance component #2) – *Failing to protect groundwater*
- Other Compliance Conditions (Compliance component #3) – *Imminent threat to public health and safety*
- Other Compliance Conditions (Compliance component #3) – *Failing to protect groundwater*
- System not abandoned according to Minn. R. 7080.2500 (Compliance component #3) – *Failing to protect groundwater*
- Soil separation (Compliance component #5) – *Failing to protect groundwater*
- Operating permit/monitoring plan requirements (Compliance component #4) – *Noncompliant - local ordinance applies*

#### Comments or recommendations

Round septic tank is original (1970's era). Rest of system upgraded in 1993.

### Certification

*I hereby certify that all the necessary information has been gathered to determine the compliance status of this system. No determination of future system performance has been nor can be made due to unknown conditions during system construction, possible abuse of the system, inadequate maintenance, or future water usage.*

**By typing my name below, I certify the above statements to be true and correct, to the best of my knowledge, and that this information can be used for the purpose of processing this form.**

Business name: Zierke Soil Testing Certification number: 9594

Inspector signature:  License number: 119

(This document has been electronically signed) Phone: 651-249-1346

### Necessary or locally required supporting documentation (must be attached)

- Soil observation logs
- System/As-Built
- Locally required forms
- Tank Integrity Assessment
- Operating Permit
- Other information (list): \_\_\_\_\_

## 1. Impact on public health – Compliance component #1 of 5

### Compliance criteria:

System discharges sewage to the ground surface	<input type="checkbox"/> Yes* <input checked="" type="checkbox"/> No
System discharges sewage to drain tile or surface waters.	<input type="checkbox"/> Yes* <input checked="" type="checkbox"/> No
System causes sewage backup into dwelling or establishment.	<input type="checkbox"/> Yes* <input checked="" type="checkbox"/> No

**Any "yes" answer above indicates the system is an imminent threat to public health and safety.**

### Describe verification methods and results:

None of the above observed during site visit 4/18/2022. Michael did not report any past issues with the system.

### Attached supporting documentation:

- Other: \_\_\_\_\_
- Not applicable

## 2. Tank integrity – Compliance component #2 of 5

### Compliance criteria:

System consists of a seepage pit, cesspool, drywell, leaching pit, or other pit?	<input type="checkbox"/> Yes* <input checked="" type="checkbox"/> No
Sewage tank(s) leak below their designed operating depth?	<input type="checkbox"/> Yes* <input checked="" type="checkbox"/> No
If yes, which sewage tank(s) leaks:	

**Any "yes" answer above indicates the system is failing to protect groundwater.**

### Describe verification methods and results:

Present for pumping by Smilies Sewer 4/18/2022. Tanks watertight and baffles in place. Homeowner reported replacing the pump in the lift station recently.

### Attached supporting documentation:

- Empty tank(s) viewed by inspector
- Name of maintenance business: Smilies
- License number of maintenance business: 2428
- Date of maintenance: 4/18/2022
- Existing tank integrity assessment (Attach)
- Date of maintenance (mm/dd/yyyy): \_\_\_\_\_ (must be within three years)
- (See form instructions to ensure assessment complies with Minn. R. 7082.0700 subp. 4 B (1))
- Tank is Noncompliant (pumping not necessary – explain below)
- Other: \_\_\_\_\_

### 3. Other compliance conditions – Compliance component #3 of 5

3a. Maintenance hole covers appear to be structurally unsound (damaged, cracked, etc.), or unsecured?

Yes\*  No  Unknown

3b. Other issues (*electrical hazards, etc.*) to immediately and adversely impact public health or safety?  Yes\*  No  Unknown

**\*Yes to 3a or 3b - System is an imminent threat to public health and safety.**

3c. System is non-protective of ground water for other conditions as determined by inspector?

Yes\*  No

3d. System not abandoned in accordance with Minn. R. 7080.2500?

Yes\*  No

**\*Yes to 3c or 3d - System is failing to protect groundwater.**

**Describe verification methods and results:**

Attached supporting documentation:  Not applicable

### 4. Operating permit and nitrogen BMP\* – Compliance component #4 of 5 Not applicable

Is the system operated under an Operating Permit?

Yes  No **If “yes”, A below is required**

Is the system required to employ a Nitrogen BMP specified in the system design?  Yes  No

**If “yes”, B below is required**

*BMP = Best Management Practice(s) specified in the system design*

**If the answer to both questions is “no”, this section does not need to be completed.**

**Compliance criteria:**

a. Have the operating permit requirements been met?

Yes  No

b. Is the required nitrogen BMP in place and properly functioning?

Yes  No

**Any “no” answer indicates noncompliance.**

**Describe verification methods and results:**

Attached supporting documentation:  Operating permit (Attach)

## 5. Soil separation – Compliance component #5 of 5

Date of installation 10/22/1993  Unknown  
(mm/dd/yyyy)

Shoreland/Wellhead protection/Food beverage lodging?  Yes  No

**Compliance criteria (select one):**

5a. For systems built prior to April 1, 1996, and not located in Shoreland or Wellhead Protection Area or not serving a food, beverage or lodging establishment:  Yes  No\*

Drainfield has at least a two-foot vertical separation distance from periodically saturated soil or bedrock.

5b. Non-performance systems built April 1, 1996, or later or for non-performance systems located in Shoreland or Wellhead Protection Areas or serving a food, beverage, or lodging establishment:  Yes  No\*

Drainfield has a three-foot vertical separation distance from periodically saturated soil or bedrock.\*

5c. "Experimental", "Other", or "Performance" systems built under pre-2008 Rules; Type IV or V systems built under 2008 Rules 7080.2350 or 7080.2400 (Intermediate Inspector License required ≤ 2,500 gallons per day; Advanced Inspector License required > 2,500 gallons per day)  Yes  No\*

Drainfield meets the designed vertical separation distance from periodically saturated soil or bedrock.

**Attached supporting documentation:**

- Soil observation logs completed for the report
- Two previous verifications of required vertical separation
- Not applicable (No soil treatment area)
- \_\_\_\_\_

**Indicate depths or elevations**

A. Bottom of distribution media	97.7'
B. Periodically saturated soil/bedrock	94.5'+
C. System separation	3.2'+
D. Required compliance separation*	3.0'

\*May be reduced up to 15 percent if allowed by Local Ordinance.

**\*Any "no" answer above indicates the system is failing to protect groundwater.**

**Describe verification methods and results:**

**Upgrade requirements:** (Minn. Stat. § 115.55) An imminent threat to public health and safety (ITPHS) must be upgraded, replaced, or its use discontinued within ten months of receipt of this notice or within a shorter period if required by local ordinance. If the system is failing to protect ground water, the system must be upgraded, replaced, or its use discontinued within the time required by local ordinance. If an existing system is not failing as defined in law, and has at least two feet of design soil separation, then the system need not be upgraded, repaired, replaced, or its use discontinued, notwithstanding any local ordinance that is more strict. This provision does not apply to systems in shoreland areas, Wellhead Protection Areas, or those used in connection with food, beverage, and lodging establishments as defined in law.

St. Croix River

**Site Notes 4/18/2022  
by Ben Zierke boxed in RED**

**Relative Elevations  
in Decimal Feet:**  
B1: 100.0  
B1 Redox: 94.5+  
Bottom of rock: 97.7  
B1 Separation: 3.2+  
Benchmark: 100.1  
(cover on lift station)

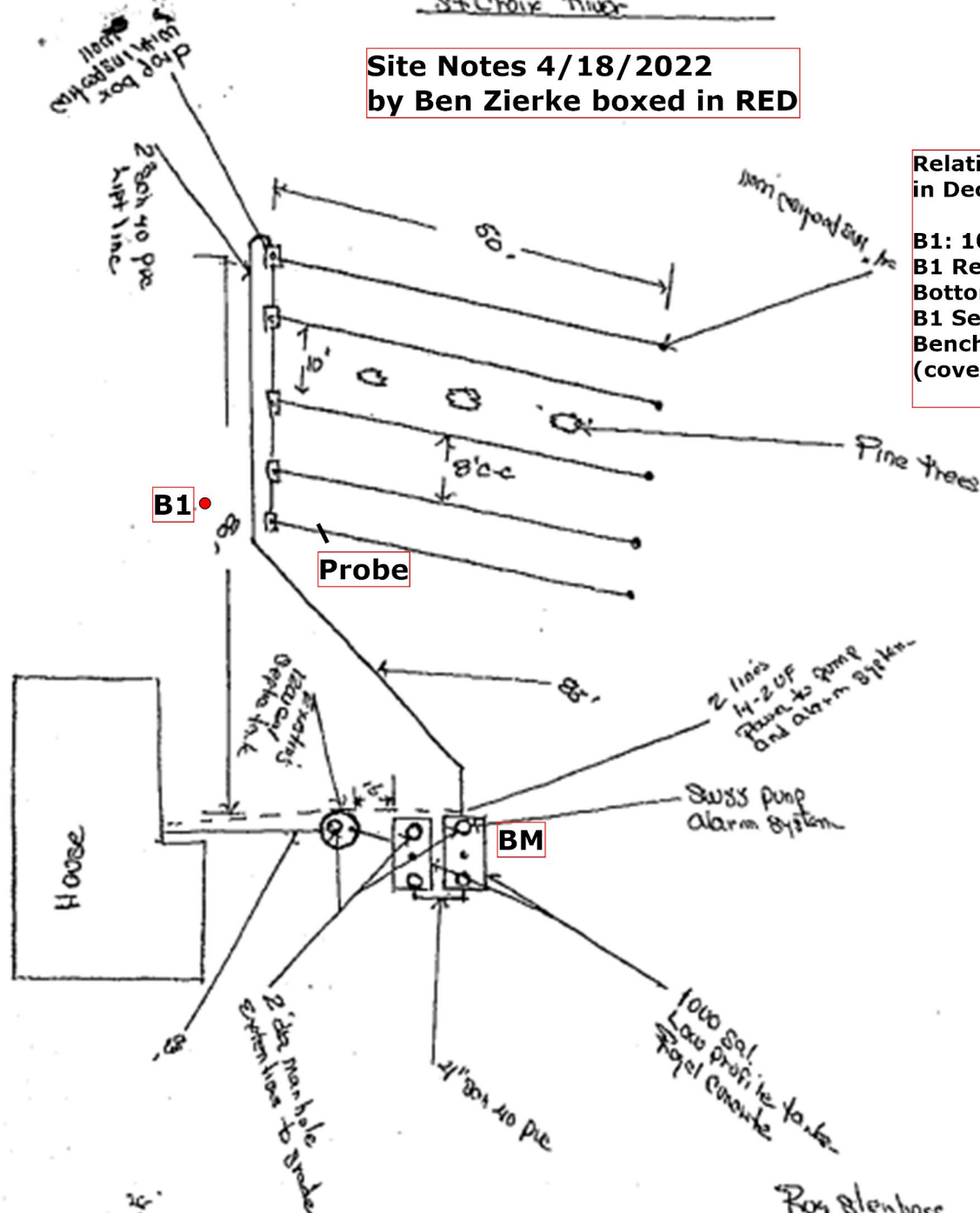

Roy Stenborg  
26243 St. Croix St. N.  
Installed 10-22-98  
C&B Excavating & Sewer Inc.  
2 - 1000 gal Lad Profile  
Royal Concrete  
750 sq. ft. - 5 lines @ 60' ea.  
12" Rock Geo Text Fabric.  
Drop boxes -  
2" lift line SWSS.

## Logs of Soil Borings

Location of Project: 23243 St Croix Trl N Scandia, MN 55073

Borings Made by Ben Zierke

Date: 4/18/2022

Hand bucket auger used for borings; USDA - SCS Soil Classification used.

Depth, in Inches	Boring Number 1	Depth, in Inches	Boring Number 2
0-----	-----	0-----	-----
0-13"	10YR 3/2 loamy fine sand		
13-30"	10YR 4/4 loamy fine sand		
30-35"	7.5YR 4/4 sandy loam		
35-52"	10YR 5/4 loamy sand, layers of medium sand		
52-66"	10YR 6/3 coarse sand, <15% coarse fragments		

End of boring at 5.5 feet

**Standing water table:**

Present at \_\_\_\_\_ feet of depth \_\_\_\_\_ Hours after boring  
 Standing water not present in hole

**Mottled Soil:**

Observed at \_\_\_\_\_ feet of depth \_\_\_\_\_  
 Mottled soil not present in bore hole

Comments:

End of boring at \_\_\_\_\_ feet

**Standing water table:**

Present at \_\_\_\_\_ feet of depth \_\_\_\_\_ Hours after boring  
 Standing water not present in hole

**Mottled Soil:**

Observed at \_\_\_\_\_ feet of depth \_\_\_\_\_  
 Mottled soil not present in bore hole

Comments:

Depth, in Inches	Boring Number 3	Depth, in Inches	Boring Number 4
0-----	-----	0-----	-----

End of boring at \_\_\_\_\_ feet

**Standing water table:**

Present at \_\_\_\_\_ feet of depth \_\_\_\_\_ Hours after boring  
 Standing water not present in hole

**Mottled Soil:**

Observed at \_\_\_\_\_ feet of depth \_\_\_\_\_  
 Mottled soil not present in bore hole

Comments:

End of boring at \_\_\_\_\_ feet

**Standing water table:**

Present at \_\_\_\_\_ feet of depth \_\_\_\_\_ Hours after boring  
 Standing water not present in hole

**Mottled Soil:**

Observed at \_\_\_\_\_ feet of depth \_\_\_\_\_  
 Mottled soil not present in bore hole

Comments: