

**Instructions:** Inspector must submit completed form to Local Governmental Unit (LGU) and system owner within 15 days of final determination of compliance or noncompliance. Instructions for filling out this form are located on the Minnesota Pollution Control Agency (MPCA) website at <https://www.pca.state.mn.us/sites/default/files/wq-wwists4-31a.pdf>.

### Property information

Local tracking number: \_\_\_\_\_

Parcel ID# or Sec/Twp/Range: 2802920120007 Reason for Inspection Property Transfer

Local regulatory authority info: Washington County

Property address: 14554 19<sup>th</sup> St N Stillwater, Mn. 55082

Owner/representative: Marc and Kristin Campbell Owner's phone: 612-803-2977

Brief system description: 2 septic tanks to gravity drainfield. System was installed with a permit from Washington County.

### System status

System status on date (mm/dd/yyyy): 5/27/2022

**Compliant – Certificate of compliance\***

**Noncompliant – Notice of noncompliance**

*(Valid for 3 years from report date unless evidence of an imminent threat to public health or safety requiring removal and abatement under section 145A.04, subdivision 8 is discovered or a shorter time frame exists in Local Ordinance.)*

*Systems failing to protect ground water must be upgraded, replaced, or use discontinued within the time required by local ordinance.*

*An imminent threat to public health and safety (ITPHS) must be upgraded, replaced, or its use discontinued within ten months of receipt of this notice or within a shorter period if required by local ordinance or under section 145A.04 subdivision 8.*

**\*Note: Compliance indicates conformance with Minn. R. 7080.1500 as of system status date above and does not guarantee future performance.**

#### Reason(s) for noncompliance (check all applicable)

- Impact on public health (Compliance component #1) – *Imminent threat to public health and safety*
- Tank integrity (Compliance component #2) – *Failing to protect groundwater*
- Other Compliance Conditions (Compliance component #3) – *Imminent threat to public health and safety*
- Other Compliance Conditions (Compliance component #3) – *Failing to protect groundwater*
- System not abandoned according to Minn. R. 7080.2500 (Compliance component #3) – *Failing to protect groundwater*
- Soil separation (Compliance component #5) – *Failing to protect groundwater*
- Operating permit/monitoring plan requirements (Compliance component #4) – *Noncompliant - local ordinance applies*

#### Comments or recommendations

### Certification

*I hereby certify that all the necessary information has been gathered to determine the compliance status of this system. No determination of future system performance has been nor can be made due to unknown conditions during system construction, possible abuse of the system, inadequate maintenance, or future water usage.*

**By typing my name below, I certify the above statements to be true and correct, to the best of my knowledge, and that this information can be used for the purpose of processing this form.**

Business name: David R Brown Certification number: 9370

Inspector signature: DRB License number: 3649

*(This document has been electronically signed)*

Phone: 651-788-3296

### Necessary or locally required supporting documentation (must be attached)

- Soil observation logs
- System/As-Built
- Locally required forms
- Tank Integrity Assessment
- Operating Permit
- Other information (list): \_\_\_\_\_

Property Address: 14554 19<sup>th</sup> St N Stillwater, Mn. 55082

Business Name: David R Brown

Date: 5/27/2022

## 1. Impact on public health – Compliance component #1 of 5

### Compliance criteria:

System discharges sewage to the ground surface  Yes\*  No

System discharges sewage to drain tile or surface waters.  Yes\*  No

System causes sewage backup into dwelling or establishment.  Yes\*  No

**Any "yes" answer above indicates the system is an imminent threat to public health and safety.**

Describe verification methods and results:

### Attached supporting documentation:

Other: \_\_\_\_\_

Not applicable

## 2. Tank integrity – Compliance component #2 of 5

### Compliance criteria:

System consists of a seepage pit, cesspool, drywell, leaching pit, or other pit?  Yes\*  No

Sewage tank(s) leak below their designed operating depth?  Yes\*  No

If yes, which sewage tank(s) leaks:

**Any "yes" answer above indicates the system is failing to protect groundwater.**

Describe verification methods and results:

### Attached supporting documentation:

Empty tank(s) viewed by inspector

Name of maintenance business: Pinky's

License number of maintenance business: 1673

Date of maintenance: 5/27/2022

Existing tank integrity assessment (Attach)

Date of maintenance (mm/dd/yyyy): \_\_\_\_\_ (must be within three years)

(See form instructions to ensure assessment complies with Minn. R. 7082.0700 subp. 4 B (1))

Tank is Noncompliant (pumping not necessary – explain below)

Other: \_\_\_\_\_

### 3. Other compliance conditions – Compliance component #3 of 5

3a. Maintenance hole covers appear to be structurally unsound (damaged, cracked, etc.), or unsecured?

Yes\*  No  Unknown

3b. Other issues (electrical hazards, etc.) to immediately and adversely impact public health or safety?  Yes\*  No  Unknown

**\*Yes to 3a or 3b - System is an imminent threat to public health and safety.**

3c. System is non-protective of ground water for other conditions as determined by inspector?  Yes\*  No

3d. System not abandoned in accordance with Minn. R. 7080.2500?  Yes\*  No

**\*Yes to 3c or 3d - System is failing to protect groundwater.**

**Describe verification methods and results:**

Attached supporting documentation:  Not applicable

### 4. Operating permit and nitrogen BMP\* – Compliance component #4 of 5 Not applicable

Is the system operated under an Operating Permit?  Yes  No **If "yes", A below is required**

Is the system required to employ a Nitrogen BMP specified in the system design?  Yes  No **If "yes", B below is required**

*BMP = Best Management Practice(s) specified in the system design*

**If the answer to both questions is "no", this section does not need to be completed.**

**Compliance criteria:**

a. Have the operating permit requirements been met?  Yes  No

b. Is the required nitrogen BMP in place and properly functioning?  Yes  No

**Any "no" answer indicates noncompliance.**

**Describe verification methods and results:**

Attached supporting documentation:  Operating permit (Attach)

## 5. Soil separation – Compliance component #5 of 5

Date of installation 6/15/1999  Unknown  
(mm/dd/yyyy)

Shoreland/Wellhead protection/Food beverage lodging?  Yes  No

**Compliance criteria (select one):**

5a. For systems built prior to April 1, 1996, and not located in Shoreland or Wellhead Protection Area or not serving a food, beverage or lodging establishment:  Yes  No\*

Drainfield has at least a two-foot vertical separation distance from periodically saturated soil or bedrock.

5b. Non-performance systems built April 1, 1996, or later or for non-performance systems located in Shoreland or Wellhead Protection Areas or serving a food, beverage, or lodging establishment:  Yes  No\*

Drainfield has a three-foot vertical separation distance from periodically saturated soil or bedrock.\*

5c. "Experimental", "Other", or "Performance" systems built under pre-2008 Rules; Type IV or V systems built under 2008 Rules 7080.2350 or 7080.2400 (Intermediate Inspector License required ≤ 2,500 gallons per day; Advanced Inspector License required > 2,500 gallons per day)  Yes  No\*

Drainfield meets the designed vertical separation distance from periodically saturated soil or bedrock.

**Attached supporting documentation:**

- Soil observation logs completed for the report
- Two previous verifications of required vertical separation
- Not applicable (No soil treatment area)
- \_\_\_\_\_

**Indicate depths or elevations**

A. Bottom of distribution media	12"
B. Periodically saturated soil/bedrock	50"
C. System separation	38"
D. Required compliance separation*	36"

\*May be reduced up to 15 percent if allowed by Local Ordinance.

**\*Any "no" answer above indicates the system is failing to protect groundwater.**

**Describe verification methods and results:**

**Upgrade requirements:** (Minn. Stat. § 115.55) An imminent threat to public health and safety (ITPHS) must be upgraded, replaced, or its use discontinued within ten months of receipt of this notice or within a shorter period if required by local ordinance. If the system is failing to protect ground water, the system must be upgraded, replaced, or its use discontinued within the time required by local ordinance. If an existing system is not failing as defined in law, and has at least two feet of design soil separation, then the system need not be upgraded, repaired, replaced, or its use discontinued, notwithstanding any local ordinance that is more strict. This provision does not apply to systems in shoreland areas, Wellhead Protection Areas, or those used in connection with food, beverage, and lodging establishments as defined in law.

14554 19<sup>th</sup> ST. N. STILLWATER, MN. 55082

NT  
NO SCALE

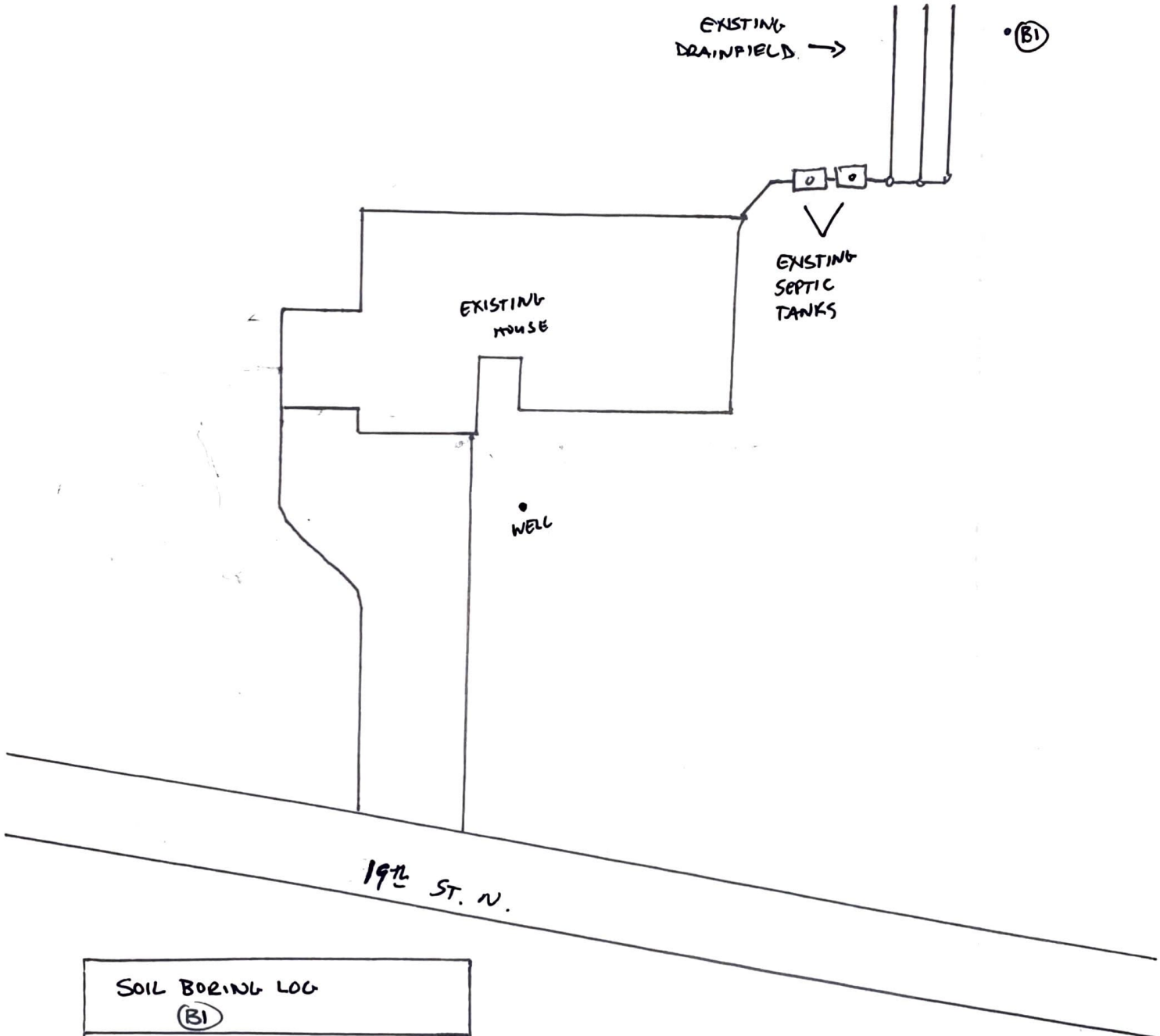

SOIL BORING LOG	
(B1)	
0" - 30"	10YR 2/2 LOAM
30" - 43"	10YR 3/4 SILTY CLAY
43" - 50"	10YR 3/6 SILT
50" - 64"	10YR 3/6 SANDY CLAY LOAM
	5YR 5/8
	10YR 7/1



**WASHINGTON COUNTY, MINNESOTA**  
 Department of Public Health  
 and Environment 651/430-6708

PERMIT NUMBER **WEST LAKELAND TOWNSHIP**  
**001799026 SEWAGE PERMIT**

Owner : **CONLIM CONSTRUCTION CO**  
**2077 GENEVA AVE N**  
**DAKOTA MN 55124**  
 Applicant : **AAA POLLUTION CONTROL 78A-9341**

**NEW DRAINFIELD PERMIT 150.00**  
**SEPTIC APPLICATION/ROLL REVIEW 150.00**  
**Total Fees : 300.00**  
**Total Paid : .00**  
**Total Due : 300.00**

001799026 99026

**PERMISSION IS HEREBY GRANTED**

To execute the work specified in this permit on the following described property upon express condition that said persons and their agents, employees and workmen shall conform in all respects to the provisions of the Building Code, and/or Ordinances.  
 This permit may be revoked at any time upon the violation of any of the provisions of said code and ordinances.

Project Address : **15TH ST N STILLWATER MN 55042**  
 Legal Description: **OUTLOT A WEST LAKELAND TOWNSHIP Geo : 28-029-20-21-0004**  
 Flow Capacity **600 Gal/Day Tank Volume 2000**  
 Soil Conditions: **Depth to Restriction 48 inches Perc Rate 14 Min/Inch**

Soil Treatment Type:  
 Bottom Area **900** Rock Depth **12**

Authorized Work / Special Conditions  
 - install individual sewage treatment system as per approved design in area tested and shown on site plan.

Permit Expiration Date : **Sewage Treatment : 2000-05-05**

**A CERTIFICATE OF OCCUPANCY MUST BE REQUESTED AND ISSUED PRIOR TO USE OR OCCUPANCY OF WORK PERMITTED BY A BUILDING PERMIT.**

As this permit shall expire and be null and void if the work authorized by the Building Permit is not commenced within 60 days of the date of issuance or if work is abandoned or suspended for a period of 120 days. Term of the Building Permit is 12 months from date of issue. Term of sewage treatment permit is 12 months from date of issue.

Penalty for violation of any of the provisions of building code: Fine not to exceed five hundred dollars (\$500.00) or imprisonment for not more than ninety (90) days, or both.

Permit Issue Date **1999-05-05** Code Enforcement Officer P. Laurzel

## INSPECTION RECORD

BUILDING	DATE	INSP.	COMMENTS
Foundation .....			
Foundation Wall .....			
Plumbing (Groundwork) .....			
Heating (Groundwork) .....			
Rough Plumbing .....			
Rough Gas Piping .....			
Rough Heating and Ventilation .....			
Framing .....			
Insulation .....			
Fireplace .....			
Chimney .....			
Wallboard or Lath and Plaster .....			
Final Electrical .....			
Final Plumbing .....			
Final Gas Piping .....			
Final Heating and Ventilation .....			
Final Building .....			

SEWAGE TREATMENT SYSTEM	DATE	INSP.	COMMENTS
Installation .....	2-15-99	P. Cooney	Tank Size: 2-1000      Treatment Area: 3-1000 900#
As Built .....			Installer: AAA

DRIVEWAY	DATE	INSP.	COMMENTS
Access .....			
Installation .....			

**NOTES:**

FMA NO. 8467/321

P. 05/08

CERTIFICATION # 00627 Logs of Soil Borings

Location or Project Lct 2, Block 2, West Lakeland Property, Washington Co.

Borings made by G-P Testing, Inc. Steve Schirmers Date 6-25-95

Classification System: AASHTO     ; USDA-SCS X; Unified     ; Other     

Auger used (check two): Hand X, or Power     , Flight     , or Bucket X

Depth, in feet	Boring number <u>1</u>	Depth, in feet	Boring number <u>2</u>
	Surface elevation <u>898.6</u>		Surface elevation <u>900.8</u>
0 -	Topsoil dark brown loam	0 -	Topsoil dark brown loam
1 -	0 - 1'	1 -	0 - 1-1/2'
2 -	Brown loam	2 -	
	1' - 2-1/2'	3 -	Brown loam
3 -	Brown sandy loam	4 -	
4 -	2-1/2' - 4'8"	5 -	1-1/2' - 4'4"-MOTTLED 4'
5 -	<sup>Reddish brown</sup> sandy 4'8" - 5'-MOTTLED 5'	6 -	Rusty olive brown loam
	<sup>Reddish brown</sup> Rusty reddish brown sandy 5' - 5-1/2' loam		4'4" - 5-1/2'
6 -	Rusty brown sandy loam	7 -	Rusty 5-1/2' - 5'10" <sup>olive brown sandy loam</sup>
	5-1/2' - 6-1/2'	8 -	Rusty brown loamy medium sand
7 -			5'10" - 6-1/2'
8 -			

End of boring at 6-1/2' feet.  
 Standing water table:  
 present at      feet of depth,  
     hours after boring.  
 Not present in hole X

End of boring at 6-1/2' feet.  
 Standing water table:  
 present at 5'10" feet of depth,  
25 hours after boring.  
 Not present in hole     

Mottled soil:  
 Observed at 5' feet of depth.  
 Not present in hole       
 Comments:

Mottled soil:  
 Observed at 4'4" feet of depth.  
 Not present in hole       
 Comments:





# AS-BUILT REPORT INDIVIDUAL SEWAGE TREATMENT SYSTEM

Washington County Health, Environment & Land Management  
14900 61st. ST. N., P.O. BOX 3803, STILLWATER, MN., 55082-3803  
612/430-6708 or 612/430-6656 FAX 612/430-6730

RECEIVED  
MAY 20 1999  
H.E.L.M.

POSTED

Legal Description or Complete Street Address <i>19<sup>th</sup> ST. NO</i>		City or Township <i>W. LAKELAND</i>		
Owner Name <i>CONLIN CONSTRUCTION</i>	Mail Address	City	State	Zip
Installer AAA Pollution Control, Inc.	Mail Address 2077 Geneva Ave. No.	City Oakdale	State MN.	Zip 55119
Septic Tank Information Tank Manufacturer: MINNESOTA PRECAST INDUSTRIES		Liquid Capacity: <i>2 @ 1000</i>		

<del>PUMP CHAMBER (if installed)</del>				
Tank Manufacturer: <i>SAME</i>	Liquid Capacity:	Horsepower of Pump:	Type of Warning Device: <i>PER OWNER</i>	
Pump Discharge in Gallons Per Minute:	at	Feet of Head.	Number of Gallons Pumped Per Cycle:	
DRAINFIELD TRENCH			BED OR MOUND	
Width: <i>36"</i>	Length of Each Trench: <i>100'</i>	Rock Bed Length:	Width:	Area:
Depth of Trench Bottom From Finish Grade: <i>12" ORIG - 17" FINISH</i>		Bed Depth from Grade:		
Method of Distribution: <input type="checkbox"/> Gravelless <input type="checkbox"/> Pressure <input type="checkbox"/> Distribution Box <input checked="" type="checkbox"/> Drop Box		MOUND: Upslope Sand Depth:      Downslope Sand Depth:		
Depth of Rock Under Distribution Pipe: <i>12"</i>		Depth of Rock Under Pipe:		
Square Footage of Test Area Used:		PRESSURE DISTRIBUTION SYSTEM:		
Trench Bottom Area Sq. FT. Required: <i>900</i>	Area As Built: <i>900</i>	Lateral Inside Diameter:	Length:	Perforation Size:
PERMIT NUMBER: # <i>17-99026</i>		Spacing:	Number:	Perforation Spacing: