

**Instructions:** Inspector must submit completed form to Local Governmental Unit (LGU) and system owner within 15 days of final determination of compliance or noncompliance. Instructions for filling out this form are located on the Minnesota Pollution Control Agency (MPCA) website at <https://www.pca.state.mn.us/sites/default/files/wq-wwists4-31a.pdf>.

### Property information

Local tracking number: \_\_\_\_\_

Parcel ID# or Sec/Twp/Range: 1202721320011 Reason for Inspection Property Transfer

Local regulatory authority info: Washington County

Property address: 7575 Lamar Ave S Cottage Grove, Mn. 55016

Owner/representative: Mike and Janna Miller (Realtor Mick Ramey) Owner's phone: 651-459-1111

Brief system description: 1 Septic tank to gravity drainfield.

### System status

System status on date (mm/dd/yyyy): 7/13/2022

**Compliant – Certificate of compliance\***

*(Valid for 3 years from report date unless evidence of an imminent threat to public health or safety requiring removal and abatement under section 145A.04, subdivision 8 is discovered or a shorter time frame exists in Local Ordinance.)*

**\*Note: Compliance indicates conformance with Minn. R. 7080.1500 as of system status date above and does not guarantee future performance.**

**Noncompliant – Notice of noncompliance**

*Systems failing to protect ground water must be upgraded, replaced, or use discontinued within the time required by local ordinance.*

*An imminent threat to public health and safety (ITPHS) must be upgraded, replaced, or its use discontinued within ten months of receipt of this notice or within a shorter period if required by local ordinance or under section 145A.04 subdivision 8.*

#### Reason(s) for noncompliance (check all applicable)

- Impact on public health (Compliance component #1) – *Imminent threat to public health and safety*
- Tank integrity (Compliance component #2) – *Failing to protect groundwater*
- Other Compliance Conditions (Compliance component #3) – *Imminent threat to public health and safety*
- Other Compliance Conditions (Compliance component #3) – *Failing to protect groundwater*
- System not abandoned according to Minn. R. 7080.2500 (Compliance component #3) – *Failing to protect groundwater*
- Soil separation (Compliance component #5) – *Failing to protect groundwater*
- Operating permit/monitoring plan requirements (Compliance component #4) – *Noncompliant - local ordinance applies*

#### Comments or recommendations

### Certification

*I hereby certify that all the necessary information has been gathered to determine the compliance status of this system. No determination of future system performance has been nor can be made due to unknown conditions during system construction, possible abuse of the system, inadequate maintenance, or future water usage.*

**By typing my name below, I certify the above statements to be true and correct, to the best of my knowledge, and that this information can be used for the purpose of processing this form.**

Business name: David R Brown Certification number: 9370

Inspector signature: DRB License number: 3649

*(This document has been electronically signed)* Phone: 651-788-3296

### Necessary or locally required supporting documentation (must be attached)

- Soil observation logs
- System/As-Built
- Locally required forms
- Tank Integrity Assessment
- Operating Permit
- Other information (list): \_\_\_\_\_

### 1. Impact on public health – Compliance component #1 of 5

**Compliance criteria:**

System discharges sewage to the ground surface  Yes\*  No

System discharges sewage to drain tile or surface waters.  Yes\*  No

System causes sewage backup into dwelling or establishment.  Yes\*  No

*Any "yes" answer above indicates the system is an imminent threat to public health and safety.*

**Describe verification methods and results:**

**Attached supporting documentation:**

Other: \_\_\_\_\_

Not applicable

### 2. Tank integrity – Compliance component #2 of 5

**Compliance criteria:**

System consists of a seepage pit, cesspool, drywell, leaching pit, or other pit?  Yes\*  No

Sewage tank(s) leak below their designed operating depth?  Yes\*  No

If yes, which sewage tank(s) leaks:

*Any "yes" answer above indicates the system is failing to protect groundwater.*

**Describe verification methods and results:**

**Attached supporting documentation:**

Empty tank(s) viewed by inspector

Name of maintenance business: Meyer's

License number of maintenance business: 915

Date of maintenance: 6/22/2022

Existing tank integrity assessment (Attach)

Date of maintenance (mm/dd/yyyy): \_\_\_\_\_ (must be within three years)

*(See form instructions to ensure assessment complies with Minn. R. 7082.0700 subp. 4 B (1))*

Tank is Noncompliant (pumping not necessary – explain below)

Other: \_\_\_\_\_



3. Other compliance conditions – Compliance component #3 of 5

3a. Maintenance hole covers appear to be structurally unsound (damaged, cracked, etc.), or unsecured?

Yes\*  No  Unknown

3b. Other issues (electrical hazards, etc.) to immediately and adversely impact public health or safety?  Yes\*  No  Unknown

\*Yes to 3a or 3b - System is an imminent threat to public health and safety.

3c. System is non-protective of ground water for other conditions as determined by inspector?

Yes\*  No

3d. System not abandoned in accordance with Minn. R. 7080.2500?

Yes\*  No

\*Yes to 3c or 3d - System is failing to protect groundwater.

Describe verification methods and results:

Attached supporting documentation:  Not applicable

4. Operating permit and nitrogen BMP\* – Compliance component #4 of 5  Not applicable

Is the system operated under an Operating Permit?

Yes  No If "yes", A below is required

Is the system required to employ a Nitrogen BMP specified in the system design?

Yes  No If "yes", B below is required

BMP = Best Management Practice(s) specified in the system design

If the answer to both questions is "no", this section does not need to be completed.

Compliance criteria:

a. Have the operating permit requirements been met?

Yes  No

b. Is the required nitrogen BMP in place and properly functioning?

Yes  No

Any "no" answer indicates noncompliance.

Describe verification methods and results:

Attached supporting documentation:  Operating permit (Attach)

## 5. Soil separation – Compliance component #5 of 5

Date of installation \_\_\_\_\_  Unknown  
(mm/dd/yyyy)

Shoreland/Wellhead protection/Food beverage lodging?  Yes  No

**Attached supporting documentation:**

- Soil observation logs completed for the report
- Two previous verifications of required vertical separation
- Not applicable (No soil treatment area)
- \_\_\_\_\_

**Compliance criteria (select one):**

5a. For systems built prior to April 1, 1996, and not located in Shoreland or Wellhead Protection Area or not serving a food, beverage or lodging establishment:  Yes  No\*

Drainfield has at least a two-foot vertical separation distance from periodically saturated soil or bedrock.

5b. Non-performance systems built April 1, 1996, or later or for non-performance systems located in Shoreland or Wellhead Protection Areas or serving a food, beverage, or lodging establishment:  Yes  No\*

Drainfield has a three-foot vertical separation distance from periodically saturated soil or bedrock.\*

5c. "Experimental", "Other", or "Performance" systems built under pre-2008 Rules; Type IV or V systems built under 2008 Rules 7080.2350 or 7080.2400 (Intermediate Inspector License required ≤ 2,500 gallons per day; Advanced Inspector License required > 2,500 gallons per day)  Yes  No\*

Drainfield meets the designed vertical separation distance from periodically saturated soil or bedrock.

**Indicate depths or elevations**

A. Bottom of distribution media	28"
B. Periodically saturated soil/bedrock	72"
C. System separation	44"
D. Required compliance separation*	36"

\*May be reduced up to 15 percent if allowed by Local Ordinance.

**\*Any "no" answer above indicates the system is failing to protect groundwater.**

**Describe verification methods and results:**

**Upgrade requirements:** (Minn. Stat. § 115.55) An imminent threat to public health and safety (ITPHS) must be upgraded, replaced, or its use discontinued within ten months of receipt of this notice or within a shorter period if required by local ordinance. If the system is failing to protect ground water, the system must be upgraded, replaced, or its use discontinued within the time required by local ordinance. If an existing system is not failing as defined in law, and has at least two feet of design soil separation, then the system need not be upgraded, repaired, replaced, or its use discontinued, notwithstanding any local ordinance that is more strict. This provision does not apply to systems in shoreland areas, Wellhead Protection Areas, or those used in connection with food, beverage, and lodging establishments as defined in law.

NA  
No Scale

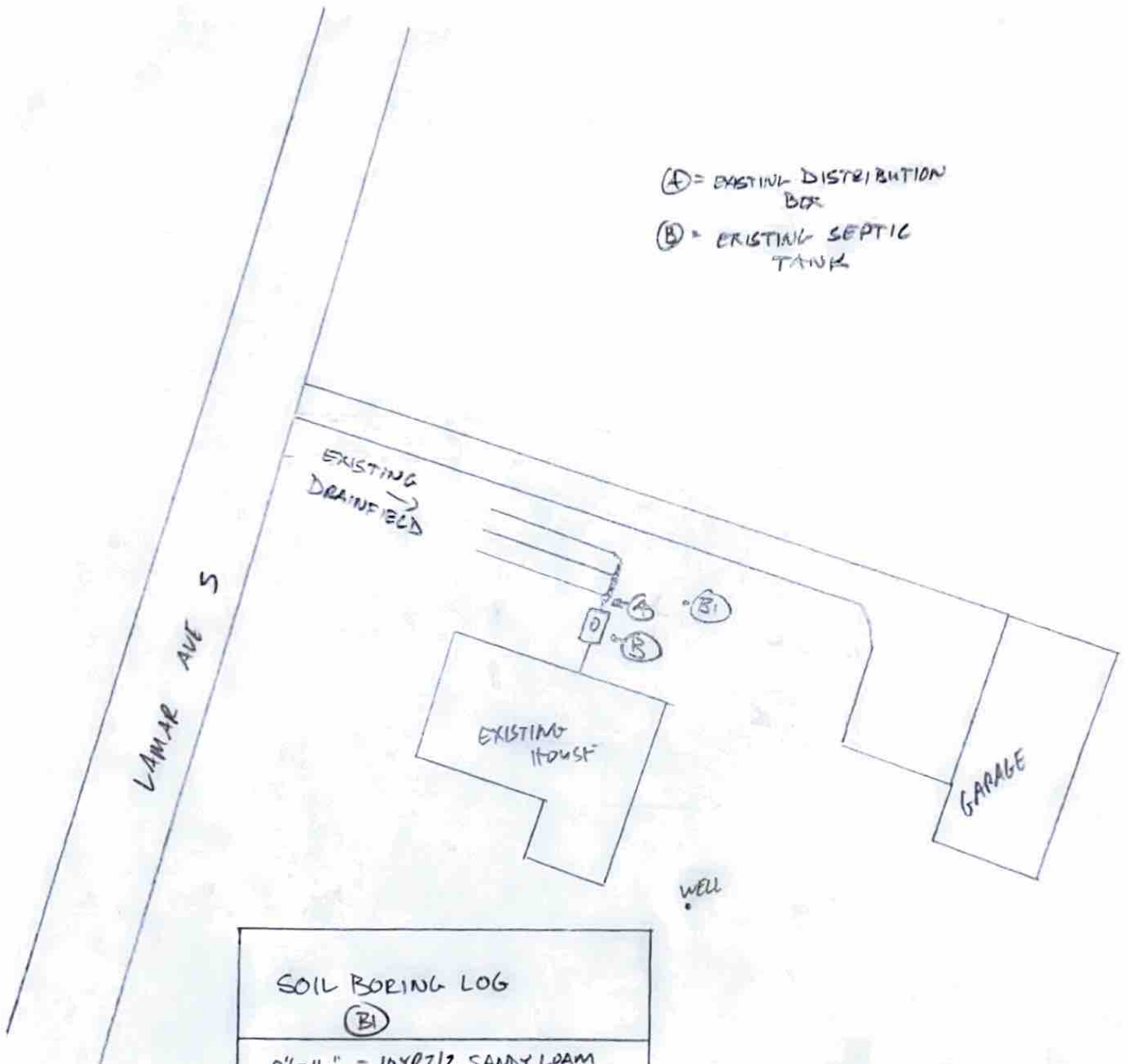





# Tri-City / William Lloyd Analytical Laboratory

9300 Poplar Bridge Road • Bloomington, MN 55437 • (952) 563-4904

## Sample Results Report

Dave Brown  
4787 Radio Dr.  
Woodbury, MN 55129

**Report Date:**  
06/30/2022 07:01

**Received By:** Deb Weltzin

### Sample Condition Upon Receipt:

**Received Date / Time:** 29-Jun-2022 12:06

Acceptable      Temperature 11.1 °C  
 On ice

**Sample ID:** 2206258-01

**7575 Lamar Ave S Cottage Grove, MN 55016**

**Sample Collector:** Dave Brown

**Collection Date/Time:** 6/29/2022 10:58:00AM

Analyte	Result	Units	MCL*		Date Analyzed	Analyst Initials	Method
Nitrate as N	18.4	mg/L	10	FAIL	06/29/2022 14:36	BL	EPA 353.2 Rev. 2.0
P/A total coliform	Absent	MPN/100 mL	Absent	PASS	06/29/2022 06:54	DJW	SM 9223 B (Colliert-18® P/A)

\*MCL (maximum contaminant level) set by the EPA

**FAIL - The analyte(s) reported, for the sample(s) listed above, DO NOT meet standards set by the Minnesota Department of Health and U. S. Environmental Protection Agency for safe drinking water.**

Approved By: *Deb Weltzin*

Deb Weltzin  
Water Quality Supervisor

Laboratory Identification Number: 027-053-355

The results in this report apply to the above listed sample(s). All routine quality assurance procedures were followed, unless otherwise noted. This analytical report must be reported in its entirety. All methods are certified by the Minnesota Department of Health, unless otherwise noted. The test report shall not be reproduced except in full, without written approval of the laboratory.

\* - The lab does not hold a Minnesota Department of Health accreditation for this parameter.