

Property address: 13987 OZARK AVE PO  
 City: ST. LOUIS, MO  
 State: MO  
 Parcel ID: 55080  
 Zip code: 63108

**Optional section: Sewage Tank Compliance Certification**

This form does not represent a complete system inspection report and only certifies sewage tank compliance status. Instructions: This section of the form may be completed and signed by a Designated Certified Individual (DCI) of a licensed SSTS Maintenance Business who personally conducts the necessary procedures to assess the compliance status of each sewage tank in the system.

When this section of the form is signed by a qualified certified professional, it becomes necessary supporting documentation to an Existing System Compliance Inspection Report: <http://www.mpcasystem.com> (MP-WSIS-4-3.1b). This form can be found on the MPCAs website at <http://www.mpcasystem.com>.  
 The information and certified statement on this form is required when existing septic tank compliance status is determined by an individual other than the SSTS inspector that submits the inspection report. It represents a third party assessment of SSTS component compliance and is allowable under Minn. R. 7082.0700, subp. 4 item (B) subitem (1). This form is valid for a period of three years beyond the signature date on this form unless a new evaluation is requested by the owner or owner's agent or is required according to local regulations. Additional Administrative Rule references for this activity can be found at Minn. R. 7082.0700, subp. 4 items B, C, and D; 7083.0730 item C.

Certificate of sewage tank compliance  
 Notice of sewage tank non-compliance

Affirm all three statements:  
 The SSTS does not contain a seepage pit, cesspool, drywell, leaching pit, or other pit.  
 It does not contain a sewage tank that was designed to be watertight, but subsequently leaks below the designed operating depth.  
 It does not represent an imminent safety threat by reason of unsecured, damaged, or weak maintenance hole cover(s) or other unsafe condition.  
 It presents a threat to public safety by reason of operating depth - "Failure to Protect Groundwater."  
 It has a sewage tank that was designed to be watertight, but subsequently leaks below the designed operating depth - "Failure to Protect Groundwater."  
 The SSTS has a seepage pit, cesspool, drywell, leaching pit, or other pit - "Failure to Protect Groundwater."  
 It has a sewage tank that was designed to be unsecured, damaged, or weak maintenance hole cover(s) or other unsafe condition - "Imminent Threat to Public Health or Safety."

**Company Information**  
 Company name: Pinky's Sewer Service  
 Business license number: 1673  
 Designated Certified Individual (DCI) information  
 Print name: Nick S. Clark  
 Certification number: 59755

Designated Certified Individual (DCI) personally conducted the work described above as a Designated Certified Individual of a Minnesota-licensed SSTS Maintenance Business. I personally conducted the necessary procedures to assess the compliance status of each sewage tank in this SSTS.  
 Designated Certified Individual's signature: *Nick S. Clark*  
 Date (m/d/yyyy): 10/28/22



# Soil Observation Log

Project ID:

v 04.01.2020

Client: Renee Carlson

Location / Address: 13987 Ozark Ave N.

Soil parent material(s): (Check all that apply)  Outwash  Lacustrine  Loess  Till  Alluvium  Bedrock  Organic Matter

Landscape Position: (select one) Shoulder Slope %: \_\_\_\_\_ Slope shape: Convex, Convex Elevation-relative to benchmark: \_\_\_\_\_

Vegetation: Lawn Soil survey map units: 49C Limiting Layer Elevation: \_\_\_\_\_

Weather Conditions/Time of Day: Sunny 39 degrees 1:00 pm Date: 02/26/23

Observation #/Location: See Map Observation Type: Auger

Depth (in)	Texture	Rock Frag. %	Matrix Color(s)	Mottle Color(s)	Redox Kind(s)	Indicator(s)	Structure		
							Shape	Grade	Consistence
0-6"	Loamy Sand	<35%	10R 3/3				Granular	Moderate	Loose
7" - 34"	Loamy Coarse Sand	<35%	10YR 4/4				Granular	Moderate	Loose
35" - 72"	Coarse Sand	<35%	10YR 4/3				Granular	Moderate	Loose

I hereby certify that I have completed this work in accordance with all applicable ordinances, rules and laws.

Shelley Schlomka  
(Designer/Inspector)

  
(Signature)

4137  
(License #)

2/24/2023  
(Date)

Optional Verification: I hereby certify that this soil observation was verified according to Minn. R. 7082.0500 subp. 3 A. The signature below represents an infield verification of the periodically saturated soil or bedrock at the proposed soil treatment and dispersal site.

\_\_\_\_\_  
(LGU Inspector)

\_\_\_\_\_  
(Signature)

\_\_\_\_\_  
(Cert. #)

\_\_\_\_\_  
(Date)

02 RAIL AVE N

ROAD

Soil BORINGS

SCALE 1" = 20'

13987 02ARK HVE  
Installed 9/18/03  
By Peterson E&C Inc  
SCHAUDIN, MN.

\* Well

Well  
THIS  
AREA

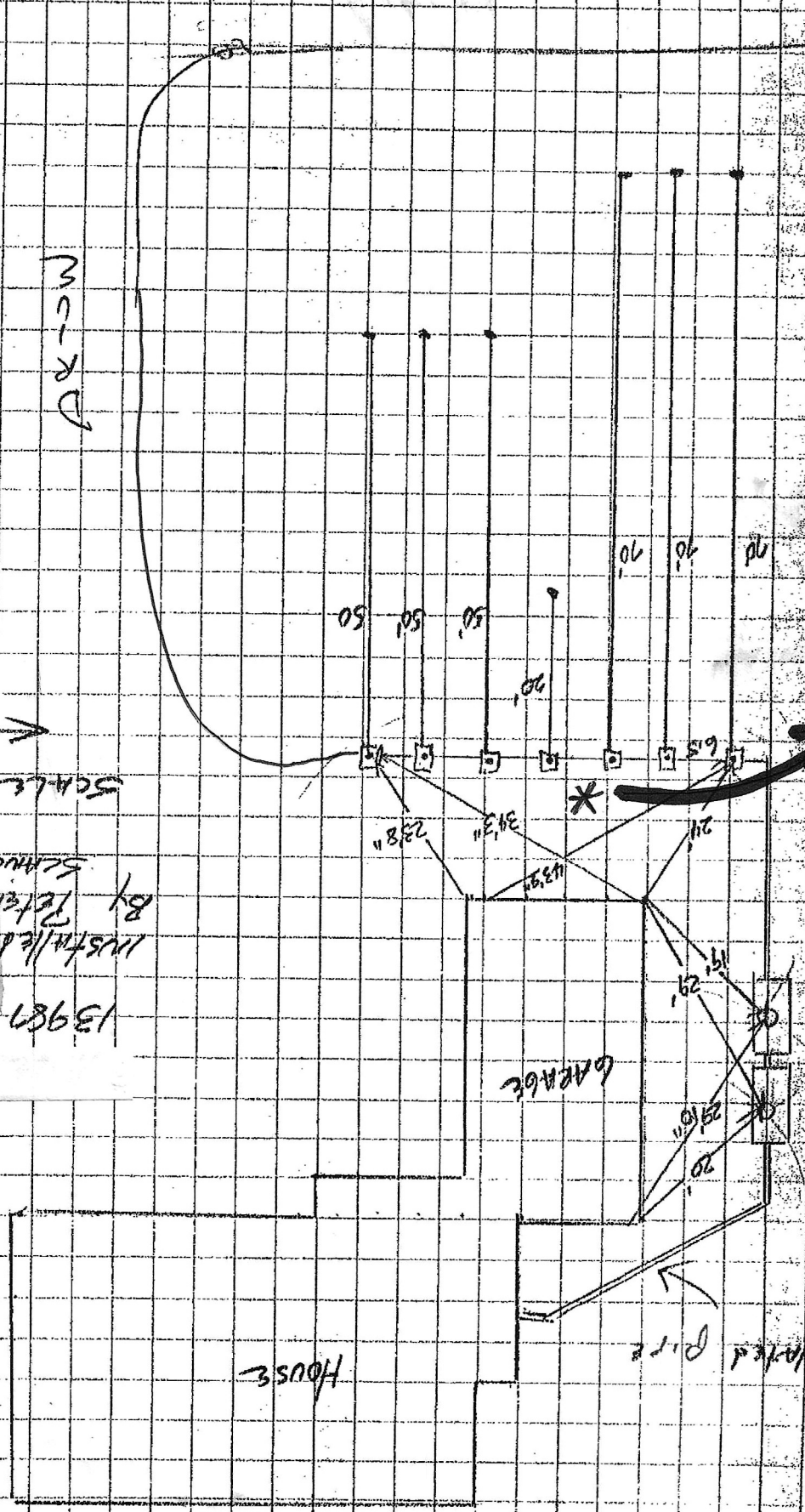

GARAGE

HOUSE

insulated pipe

2-1000's  
SEPTIC  
TANK  
INSTALL  
TOP

Permit Issue Date 2003-05-19 (Solo Enforcement Officer)

*1-Grant*

A CERTIFICATE OF OCCUPANCY MUST BE REQUESTED AND ISSUED PRIOR TO USE OR OCCUPANCY OF WORK PERMITTED BY A BUILDING PERMIT.

\* This permit shall expire and be null and void if the work authorized by the building permit is not commenced within 60 days of the date of issuance or if work is abandoned or suspended for a period of 120 days. Term of the building permit is 12 months from date of issue. Term of sewage treatment permit is 12 months from date of issue. Penalties for violation of any of the provisions of building codes: fine not to exceed five hundred dollars (\$500.00) or imprisonment for not more than ninety (90) days, or both.

\*\* Permit Expiration Date : Sewage Treatment : 2004-05-19

Authorized work / special conditions - install individual sewage treatment system as per approved design in area located and shown on site plan.

Project Address : 13987 OZARK AVE N  
 Legal Description: MAY TOWNSHIP  
 Flow Capacity 600 gal/day Tank Volume 2000  
 Soil Conditions: Depth to Water Table 96 inches  
 Perce Rate 5 min/inch  
 Bottom Area 1000 Rock Depth 12  
 Soil Treatment Type:

PERMISSION IS HEREBY GRANTED TO execute the work specified in this permit on the following described property upon express condition that said persons and their agents, employees and workmen shall conform in all respects to the provisions of the building code, and/or ordinances, and this permit may be revoked at any time upon the violation of any of the provisions of said code and ordinances.

*51020-5000*

NEW DRAINAGE PERMIT 208.00  
 SEPTIC APPLICATION/SOIL REVIEW 195.00  
 Total Fee : 400.00  
 Total Paid : 400.00  
 Total Due : .00

PERMIT NUMBER MAY TOWNSHIP 000903018 SEWAGE PERMIT  
 Owner : MICHAEL HORLIER 15091 65TH ST N  
 RPTLAWER MN 55052  
 Applicant : MICHAEL HORLIER 430-0606

WASHINGTON COUNTY, MINNESOTA  
 Department of Public Health  
 and Environment 651/430-6688



*Approved 8/11/08 BM*

JOB DAN LANG  
LOTS 3, 4, 5, 6, 7, 8, 9, 10, 11, 12, 13, 14, 15, 16, 17, 18, 19, 20, 21, 22, 23, 24, 25, 26, 27, 28, 29, 30, 31, 32, 33, 34, 35, 36, 37, 38, 39, 40, 41, 42, 43, 44, 45, 46, 47, 48, 49, 50, 51, 52, 53, 54, 55, 56, 57, 58, 59, 60, 61, 62, 63, 64, 65, 66, 67, 68, 69, 70, 71, 72, 73, 74, 75, 76, 77, 78, 79, 80, 81, 82, 83, 84, 85, 86, 87, 88, 89, 90, 91, 92, 93, 94, 95, 96, 97, 98, 99, 100  
 SOUTH  
 DATE 5-14-02

BORING LOG

BOREHOLE DIAMETER

DEPTH FEET	HOLE #1	HOLE #2	HOLE #3	HOLE #4	HOLE #5
1	TOP SOIL - LOAM AND BLACK DIRT - FILL	TOP SOIL - LOAM	TOP SOIL - LOAM AND BLACK DIRT -	TOP SOIL - LOAM AND BLACK DIRT -	TOP SOIL - LOAM AND BLACK DIRT -
2	LIGHT BROWN, COARSE SAND MEDIUM TO COARSE SAND	LIGHT BROWN, COARSE SAND	FILL	FILL	FILL
3		LIGHT BROWN, MEDIUM SAND	LIGHT BROWN, MEDIUM TO COARSE SAND	LIGHT BROWN, MEDIUM SAND	YELLOWISH BROWN SANDY LOAM
4					LIGHT BROWN MEDIUM SAND
5					
6		LIGHT BROWN FINE TO MEDIUM SAND			
7	STOP	STOP	STOP	STOP	STOP
8	OKAY 7' SAND 18"	OKAY 7' SAND 12"	OKAY 7' SAND 28"	OKAY 7' SAND 30"	OKAY 7' SAND 42"
9					
10					

BOREHOLE # 1  
 BOREHOLE DEPTH 1  
 BOREHOLE DIAMETER 1

DEPTH	READING
0-24"	LOAM
26"-42"	LIGHT TO

TIME	READING	MEASUREMENT	D
9:35	36"		
9:45	38 1/2"		2
9:45	36"		
9:55	38 3/4"		2
9:55	36"		
10:05	38 1/8"		2
10:05	36"		
10:15	38 1/8"		2
10:15	36"		

JOB MIKE HOEFLER  
LOT 3 BLOCK 2  
MAYWOOD SOUTH  
MAY TWP  
 DATE 9-12-2003

BORING LOG

BOREHOLE DIAGRAM

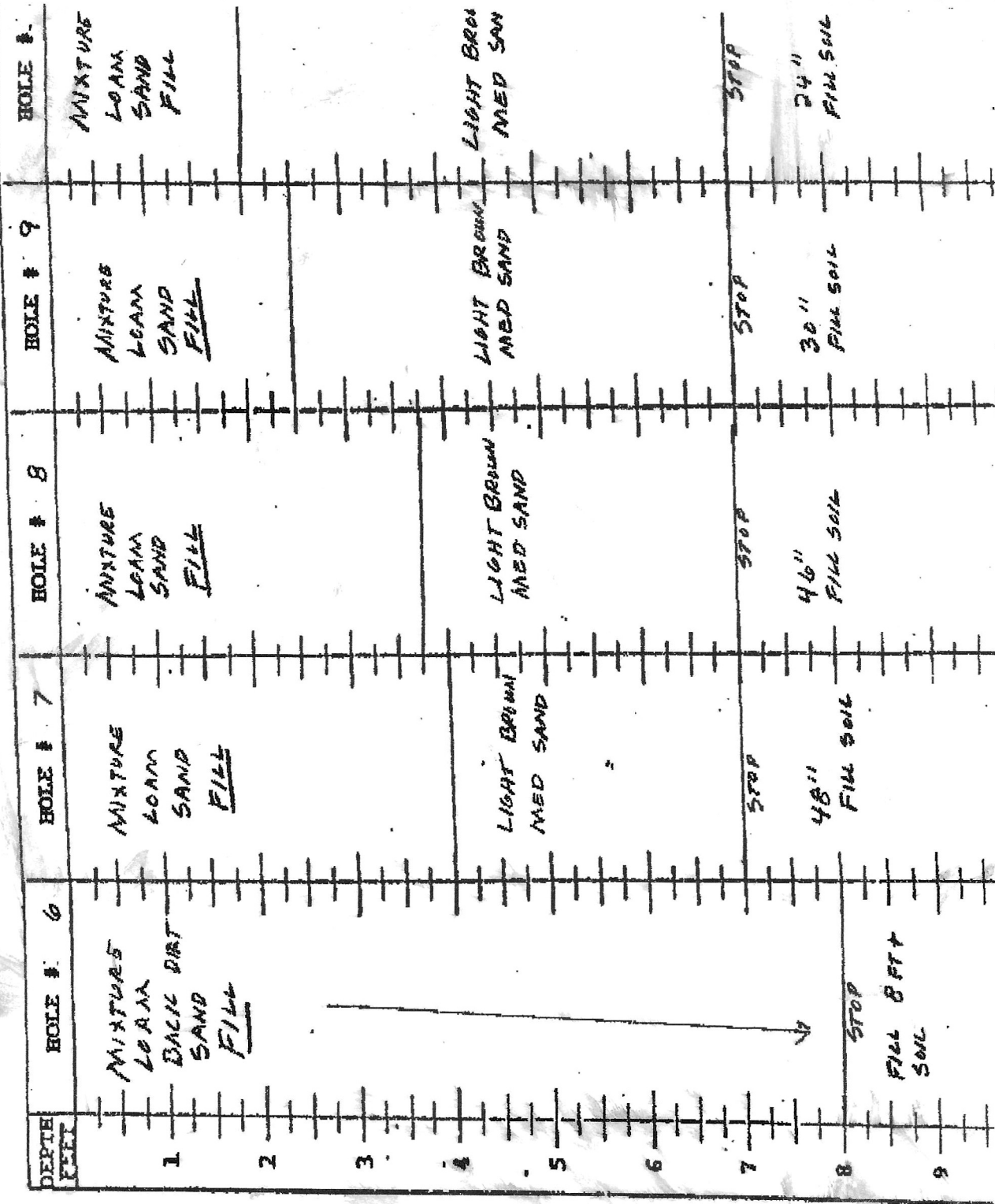

1 TRENCH 4 WAS 8 FT + DEEP - THERE WERE NO BORINGS AT THIS LOCATION SO THE FILL WAS MISSED - SEE BORING LOGS 9-12-2003 TRENCH LENGTH CAN VARY TO KEEP IN THE SAND

This system has been designed by a Pollution Control Agency (PCA) Certified Professional.  
 Designer Name DAVE FKLIN STATE - 410  
1986 RIDGEWOOD AVE PCA Certification # 695

SS Septic Solutions, LLC additional terms and information.

1. SS Septic Solutions has not been retained to warrant, guarantee, or certify the proper functioning of the system for any period beyond the inspection date. Due to the numerous factors (usage, maintenance, tank pumping, soil characteristics, previous failures, etc.) which may affect the proper operation of a septic system. The report shall not be construed as a warranty that the system will properly function for any particular period of time.
2. Minimum compliance inspection requirements relative to this inspection and this report include only verification that the septic system has a watertight septic tank(s) and lift tank, the required separation from the bottom of the drain field/mound distribution medium and saturated soils, no backup of sewage into the dwelling and no discharge of sewage onto the ground surface or surface water. SS Septic Solutions, LLC does not inspect basement sewage ejector pumps or exterior lift pumps as they are a maintenance item. Sewage backup verification is limited to the information supplied by the last occupants/owner if available. I can not guarantee that the information given to me is accurate. Some people may attempt to hide or conceal signs of previous backups.
3. Certification of this system does not warranty any future use beyond the date of inspection. Any system new or old can be hydraulically overloaded because of more people moving into the house than were previously occupying it, improper maintenance, heavy usage, tree roots, freezing conditions or surface drainage problems. The system could simply stop working due to age.
4. A compliance inspection is not meant to be a test of the longevity of the septic system. The inspection is strictly for the purpose of determining if the septic is polluting the environment at the date and time the inspection is performed. The inspection is not intended to determine if the system was originally designed or installed to past or present MPCAs or local unit of government code requirements.
5. Winter Work – Client understand that inspections conducted in winter weather conditions are more difficult to perform due to snow cover and frost. Septic system components like tanks, tank covers, drop boxes and soil treatment areas are more difficult to locate in these conditions. Soil borings and drain field locations are also more difficult to perform due to ground frost. The client needs to understand that due to the weather conditions, the same level of standards may not be possible compared to an inspection during the spring/summer/fall months.
6. If hired to perform the compliance inspection, the client hereby agrees that SS Septic Solutions, LLC will not be responsible for any monetary damages, claims or causes of action including attorney fees arising from the performance of this inspection.

