

# Compliance inspection report form

## Existing Subsurface Sewage Treatment System (SSTS)

Doc Type: Compliance and Enforcement

**Instructions:** Inspector must submit completed form to Local Governmental Unit (LGU) and system owner within 15 days of final determination of compliance or noncompliance. Instructions for filling out this form are located on the Minnesota Pollution Control Agency (MPCA) website at <https://www.pca.state.mn.us/sites/default/files/wq-wwists4-31a.pdf>.

### Property information

Local tracking number:

Parcel ID# or Sec/Twp/Range: 0902920110011 Reason for Inspection Sale of home

Local regulatory authority info: Washington County

Property address: 14829 50<sup>th</sup> Street North - Town of Baytown

Owner/representative: Katie Swanson Owner's phone: 651-271-3374

Brief system description: Original system from 1974 - 1200 precast tank with gravity fed drain field

### System status

System status on date (mm/dd/yyyy): 10/20/2022

**Compliant – Certificate of compliance\***

**Noncompliant – Notice of noncompliance**

*(Valid for 3 years from report date unless evidence of an imminent threat to public health or safety requiring removal and abatement under section 145A.04, subdivision 8 is discovered or a shorter time frame exists in Local Ordinance.)*

*Systems failing to protect ground water must be upgraded, replaced, or use discontinued within the time required by local ordinance.*

**\*Note: Compliance indicates conformance with Minn. R. 7080.1500 as of system status date above and does not guarantee future performance.**

*An imminent threat to public health and safety (ITPHS) must be upgraded, replaced, or its use discontinued within ten months of receipt of this notice or within a shorter period if required by local ordinance or under section 145A.04 subdivision 8.*

#### Reason(s) for noncompliance (check all applicable)

- Impact on public health (Compliance component #1) – *Imminent threat to public health and safety*
- Tank integrity (Compliance component #2) – *Failing to protect groundwater*
- Other Compliance Conditions (Compliance component #3) – *Imminent threat to public health and safety*
- Other Compliance Conditions (Compliance component #3) – *Failing to protect groundwater*
- System not abandoned according to Minn. R. 7080.2500 (Compliance component #3) – *Failing to protect groundwater*
- Soil separation (Compliance component #5) – *Failing to protect groundwater*
- Operating permit/monitoring plan requirements (Compliance component #4) – *Noncompliant - local ordinance applies*

#### Comments or recommendations

### Certification

*I hereby certify that all the necessary information has been gathered to determine the compliance status of this system. No determination of future system performance has been nor can be made due to unknown conditions during system construction, possible abuse of the system, inadequate maintenance, or future water usage.*

**By typing my name below, I certify the above statements to be true and correct, to the best of my knowledge, and that this information can be used for the purpose of processing this form.**

Business name: SS Septic Solutions, LLC

Certification number: 9917

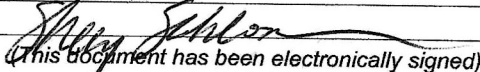
Inspector signature: 

License number: 4137

*(This document has been electronically signed)*

Phone: 651-343-9117

### Necessary or locally required supporting documentation (must be attached)

- Soil observation logs
- System/As-Built
- Locally required forms
- Tank Integrity Assessment
- Operating Permit
- Other information (list):

## 1. Impact on public health – Compliance component #1 of 5

**Compliance criteria:**

System discharges sewage to the ground surface	<input type="checkbox"/> Yes* <input checked="" type="checkbox"/> No
System discharges sewage to drain tile or surface waters.	<input type="checkbox"/> Yes* <input checked="" type="checkbox"/> No
System causes sewage backup into dwelling or establishment.	<input type="checkbox"/> Yes* <input checked="" type="checkbox"/> No

*Any "yes" answer above indicates the system is an imminent threat to public health and safety.*

**Describe verification methods and results:**

**Attached supporting documentation:**

- Other: \_\_\_\_\_
- Not applicable

## 2. Tank integrity – Compliance component #2 of 5

**Compliance criteria:**

System consists of a seepage pit, cesspool, drywell, leaching pit, or other pit?	<input type="checkbox"/> Yes* <input checked="" type="checkbox"/> No
Sewage tank(s) leak below their designed operating depth?	<input type="checkbox"/> Yes* <input checked="" type="checkbox"/> No
If yes, which sewage tank(s) leaks:	

*Any "yes" answer above indicates the system is failing to protect groundwater.*

**Describe verification methods and results:**

At time of inspection, the tank and manhole were covered. I called the maintainer to make sure this was a precast tank after receiving the tank integrity form. He confirmed at the time of the maintenance, the manhole was dug open and tank in compliance.

**Attached supporting documentation:**

- Empty tank(s) viewed by inspector
- Name of maintenance business: \_\_\_\_\_
- License number of maintenance business: \_\_\_\_\_
- Date of maintenance: \_\_\_\_\_
- Existing tank integrity assessment (Attach)
- Date of maintenance (mm/dd/yyyy): 10/5/2021  
(must be within three years)
- (See form instructions to ensure assessment complies with Minn. R. 7082.0700 subp. 4 B (1))*
- Tank is Noncompliant (pumping not necessary – explain below)
- Other: \_\_\_\_\_

**3. Other compliance conditions – Compliance component #3 of 5**

3a. Maintenance hole covers appear to be structurally unsound (damaged, cracked, etc.), or unsecured?

Yes\*  No  Unknown

3b. Other issues (electrical hazards, etc.) to immediately and adversely impact public health or safety?  Yes\*  No  Unknown

*\*Yes to 3a or 3b - System is an imminent threat to public health and safety.*

3c. System is non-protective of ground water for other conditions as determined by inspector?  Yes\*  No

3d. System not abandoned in accordance with Minn. R. 7080.2500?  Yes\*  No

*\*Yes to 3c or 3d - System is failing to protect groundwater.*

**Describe verification methods and results:**

Attached supporting documentation:  Not applicable

**4. Operating permit and nitrogen BMP\* – Compliance component #4 of 5  Not applicable**

Is the system operated under an Operating Permit?  Yes  No **If "yes", A below is required**

Is the system required to employ a Nitrogen BMP specified in the system design?  Yes  No **If "yes", B below is required**

*BMP = Best Management Practice(s) specified in the system design*

***If the answer to both questions is "no", this section does not need to be completed.***

**Compliance criteria:**

a. Have the operating permit requirements been met?  Yes  No

b. Is the required nitrogen BMP in place and properly functioning?  Yes  No

***Any "no" answer indicates noncompliance.***

**Describe verification methods and results:**

Attached supporting documentation:  Operating permit (Attach)

### 5. Soil separation – Compliance component #5 of 5

Date of installation 8/16/1974  Unknown  
(mm/dd/yyyy)

Shoreland/Wellhead protection/Food beverage lodging?  Yes  No

**Compliance criteria (select one):**

5a. For systems built prior to April 1, 1996, and not located in Shoreland or Wellhead Protection Area or not serving a food, beverage or lodging establishment:  Yes  No\*  
 Drainfield has at least a two-foot vertical separation distance from periodically saturated soil or bedrock.

5b. Non-performance systems built April 1, 1996, or later or for non-performance systems located in Shoreland or Wellhead Protection Areas or serving a food, beverage, or lodging establishment:  Yes  No\*  
 Drainfield has a three-foot vertical separation distance from periodically saturated soil or bedrock.\*

5c. "Experimental", "Other", or "Performance" systems built under pre-2008 Rules; Type IV or V systems built under 2008 Rules 7080. 2350 or 7080.2400 (Intermediate Inspector License required ≤ 2,500 gallons per day; Advanced Inspector License required > 2,500 gallons per day)  Yes  No\*  
 Drainfield meets the designed vertical separation distance from periodically saturated soil or bedrock.

**Attached supporting documentation:**

- Soil observation logs completed for the report
- Two previous verifications of required vertical separation
- Not applicable (No soil treatment area)
- \_\_\_\_\_

**Indicate depths or elevations**

A. Bottom of distribution media	24"
B. Periodically saturated soil/bedrock	60"
C. System separation	36"
D. Required compliance separation*	24"

\*May be reduced up to 15 percent if allowed by Local Ordinance.

**\*Any "no" answer above indicates the system is failing to protect groundwater.**

**Describe verification methods and results:**

See map of soil boring location. This is a very old system so I recommend regular maintenance for the remainder of its life. System should be pumped through the maintenance hole to make sure it gets cleaned thoroughly.

**Upgrade requirements:** (Minn. Stat. § 115.55) An imminent threat to public health and safety (ITPHS) must be upgraded, replaced, or its use discontinued within ten months of receipt of this notice or within a shorter period if required by local ordinance. If the system is failing to protect ground water, the system must be upgraded, replaced, or its use discontinued within the time required by local ordinance. If an existing system is not failing as defined in law, and has at least two feet of design soil separation, then the system need not be upgraded, repaired, replaced, or its use discontinued, notwithstanding any local ordinance that is more strict. This provision does not apply to systems in shoreland areas, Wellhead Protection Areas, or those used in connection with food, beverage, and lodging establishments as defined in law.

Property address: 14829 50<sup>th</sup> St. NW Parcel ID: \_\_\_\_\_  
City: Stillwater State: MN Zip code: 55082

**Optional section: Sewage Tank Compliance Certification**

This form does not represent a complete system inspection report and only certifies sewage tank compliance status.

**Instructions:** This section of the form may be completed and signed by a Designated Certified Individual (DCI) of a licensed SSTS Maintenance Business who personally conducts the necessary procedures to assess the compliance status of each sewage tank in the system.

When this section of the form is signed by a qualified certified professional, it becomes *necessary supporting documentation* to an Existing System Compliance Inspection Report: Compliance Inspection Form - Existing System (wq-wwists4-31b). This form can be found on the MPCA website at <http://www.pca.state.mn.us/wq/wwists4-31b-acts-technical-and-compliance-criteria>.

The information and certified statement on this form is required when existing septic tank compliance status is determined by an individual other than the SSTS Inspector that submits the inspection report. It represents a third party assessment of SSTS component compliance and is allowable under Minn. R. 7082.0700, subp. 4 Item (B) subitem (1). This form is valid for a period of three years beyond the signature date on this form unless a new evaluation is requested by the owner or owner's agent or is required according to local regulations. Additional Administrative Rule references for this activity can be found at Minn. R. 7082.0700, subp. 4 Items B, C, and D; 7083.0730 Item C.

**Certificate of sewage tank compliance**

Affirm all three statements:

- The SSTS does not contain a seepage pit, cesspool, drywell, leaching pit, or other pit.
- It does not contain a sewage tank that was designed to be watertight, but subsequently leaks below the designed operating depth.
- It does not represent an imminent safety threat by reason of unsecured, damaged, or weak maintenance hole cover(s) or other unsafe condition.

**Notice of sewage tank non-compliance**

Select all that apply:

- The SSTS has a seepage pit, cesspool, drywell, leaching pit, or other pit – "Failure to Protect Groundwater."
- It has a sewage tank that was designed to be watertight, but subsequently leaks below the designed operating depth – "Failure to Protect Groundwater."
- It presents a threat to public safety by reason of unsecured, damaged, or weak maintenance hole cover(s) or other unsafe condition – "Imminent Threat to Public Health or Safety."

**Company information**

Company name: Pinkys Sewer Service  
Business license number: 1673

**Designated Certified Individual (DCI) information**

Print name: Neil Clymer  
Certification number: C2814

I personally conducted the work described above as a Designated Certified Individual of a Minnesota-licensed SSTS Maintenance Business. I personally conducted the necessary procedures to assess the compliance status of each sewage tank in this SSTS:

Designated Certified Individual's signature: 

Date (mm/dd/yyyy): 10/5/21



14829 50<sup>th</sup> St. N.

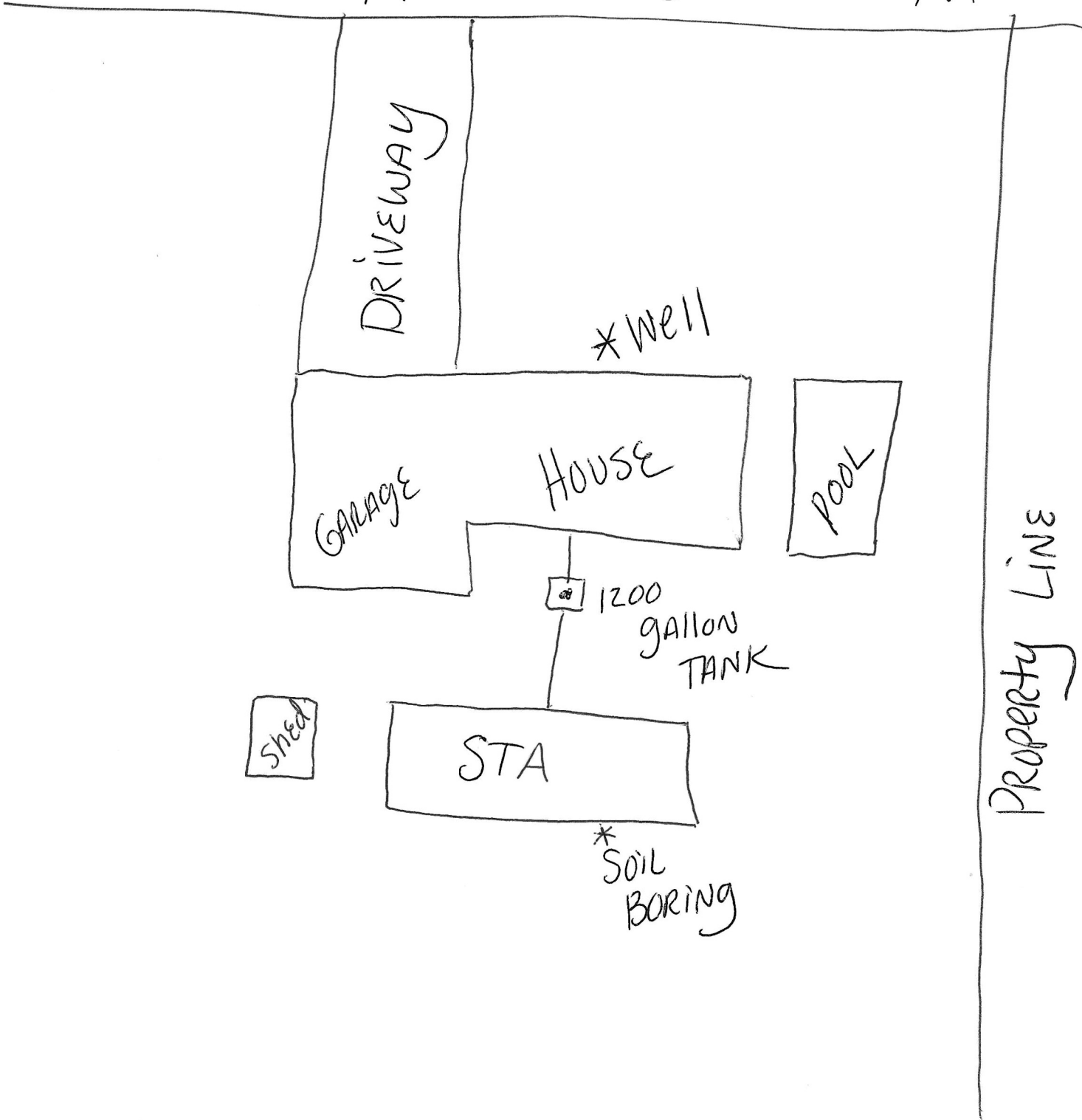

SS Septic Solutions, LLC additional terms and information.

1. SS Septic Solutions has not been retained to warrant, guarantee, or certify the proper functioning of the system for any period beyond the inspection date. Due to the numerous factors (usage, maintenance, tank pumping, soil characteristics, previous failures, etc.) which may affect the proper operation of a septic system. The report shall not be construed as a warranty that the system will properly function for any particular period of time.
2. Minimum compliance inspection requirements relative to this inspection and this report include only verification that the septic system has a watertight septic tank(s) and lift tank, the required separation from the bottom of the drain field/mound distribution medium and saturated soils, no backup of sewage into the dwelling and no discharge of sewage onto the ground surface or surface water. SS Septic Solutions, LLC does not inspect basement sewage ejector pumps or exterior lift pumps as they are a maintenance item. Sewage backup verification is limited to the information supplied by the last occupants/owner if available. I can not guarantee that the information given to me is accurate. Some people may attempt to hide or conceal signs of previous backups.
3. Certification of this system does not warranty any future use beyond the date of inspection. Any system new or old can be hydraulically overloaded because of more people moving into the house than were previously occupying it, improper maintenance, heavy usage, tree roots, freezing conditions or surface drainage problems. The system could simply stop working due to age.
4. A compliance inspection is not meant to be a test of the longevity of the septic system. The inspection is strictly for the purpose of determining if the septic is polluting the environment at the date and time the inspection is performed. The inspection is not intended to determine if the system was originally designed or installed to past or present MPCA or local unit of government code requirements.
5. Winter Work – Client understand that inspections conducted in winter weather conditions are more difficult to perform due to snow cover and frost. Septic system components like tanks, tank covers, drop boxes and soil treatment areas are more difficult to locate in these conditions. Soil borings and drain field locations are also more difficult to perform due to ground frost. The client needs to understand that due to the weather conditions, the same level of standards may not be possible compared to an inspection during the spring/summer/fall months.
6. If hired to perform the compliance inspection, the client hereby agrees that SS Septic Solutions, LLC will not be responsible for any monetary damages, claims or causes of action including attorney fees arising from the performance of this inspection.