

Instructions: Inspector must submit completed form to Local Governmental Unit (LGU) and system owner within 15 days of final determination of compliance or noncompliance. Instructions for filling out this form are located on the Minnesota Pollution Control Agency (MPCA) website at <https://www.pca.state.mn.us/sites/default/files/wq-wwists4-31a.pdf>.

Property information

Local tracking number: _____

Parcel ID# or Sec/Twp/Range: 3602721340009 Reason for Inspection Sale of property
Local regulatory authority info: Washington County
Property address: 11801 LOCKRIDGE AVE S, CITY OF COTTAGE GROVE
Owner/representative: DELANO NELSON Owner's phone: 612-590-2082
Brief system description: Single tank tp gravity fed drain field (3 lines 60', 70' 70')

System status

System status on date (mm/dd/yyyy): 5/5/2023

Compliant – Certificate of compliance*

Noncompliant – Notice of noncompliance

(Valid for 3 years from report date unless evidence of an imminent threat to public health or safety requiring removal and abatement under section 145A.04, subdivision 8 is discovered or a shorter time frame exists in Local Ordinance.)

Systems failing to protect ground water must be upgraded, replaced, or use discontinued within the time required by local ordinance.

***Note: Compliance indicates conformance with Minn. R. 7080.1500 as of system status date above and does not guarantee future performance.**

An imminent threat to public health and safety (ITPHS) must be upgraded, replaced, or its use discontinued within ten months of receipt of this notice or within a shorter period if required by local ordinance or under section 145A.04 subdivision 8.

Reason(s) for noncompliance (check all applicable)

- Impact on public health (Compliance component #1) – *Imminent threat to public health and safety*
- Tank integrity (Compliance component #2) – *Failing to protect groundwater*
- Other Compliance Conditions (Compliance component #3) – *Imminent threat to public health and safety*
- Other Compliance Conditions (Compliance component #3) – *Failing to protect groundwater*
- System not abandoned according to Minn. R. 7080.2500 (Compliance component #3) – *Failing to protect groundwater*
- Soil separation (Compliance component #5) – *Failing to protect groundwater*
- Operating permit/monitoring plan requirements (Compliance component #4) – *Noncompliant - local ordinance applies*

Comments or recommendations

Certification

I hereby certify that all the necessary information has been gathered to determine the compliance status of this system. No determination of future system performance has been nor can be made due to unknown conditions during system construction, possible abuse of the system, inadequate maintenance, or future water usage.

By typing my name below, I certify the above statements to be true and correct, to the best of my knowledge, and that this information can be used for the purpose of processing this form.

Business name: SS Septic Solutions, LLC

Certification number: 9917

Inspector signature: _____

License number: 4137

(This document has been electronically signed)

Phone: 651-343-9117

Necessary or locally required supporting documentation (must be attached)

- Soil observation logs
- System/As-Built
- Locally required forms
- Tank Integrity Assessment
- Operating Permit
- Other information (list): _____

1. Impact on public health – Compliance component #1 of 5

Compliance criteria:

System discharges sewage to the ground surface Yes* No

System discharges sewage to drain tile or surface waters. Yes* No

System causes sewage backup into dwelling or establishment. Yes* No

Any "yes" answer above indicates the system is an imminent threat to public health and safety.

Describe verification methods and results:

Attached supporting documentation:

- Other: _____
 Not applicable

2. Tank integrity – Compliance component #2 of 5

Compliance criteria:

System consists of a seepage pit, cesspool, drywell, leaching pit, or other pit? Yes* No

Sewage tank(s) leak below their designed operating depth? Yes* No

If yes, which sewage tank(s) leaks:

Any "yes" answer above indicates the system is failing to protect groundwater.

Describe verification methods and results:

Tank was dug up by the maintainer. They added 3-4' riser so tank can be properly cleaned in the future. Previous owner had two layers of pink styrofoam insulation on the ground over the pipe from the house to tank during the winter. House was vacant at time of inspection. If a family moves in, I would recommend maintaining the tank every year or two at the most. Tank had over a foot of sludge on the bottom and it took several times of backflushing the system to get the tank clean.

Attached supporting documentation:

- Empty tank(s) viewed by inspector

Name of maintenance business: Meyers

License number of maintenance business: _____

Date of maintenance: 5/5/2023

- Existing tank integrity assessment (Attach)

Date of maintenance (mm/dd/yyyy): _____ (must be within three years)

(See form instructions to ensure assessment complies with Minn. R. 7082.0700 subp. 4 B (1))

- Tank is Noncompliant (pumping not necessary – explain below)
 Other: _____

3. Other compliance conditions – Compliance component #3 of 5

3a. Maintenance hole covers appear to be structurally unsound (damaged, cracked, etc.), or unsecured?

Yes* No Unknown

3b. Other issues (electrical hazards, etc.) to immediately and adversely impact public health or safety? Yes* No Unknown

*Yes to 3a or 3b - System is an imminent threat to public health and safety.

3c. System is non-protective of ground water for other conditions as determined by inspector?

Yes* No

3d. System not abandoned in accordance with Minn. R. 7080.2500?

Yes* No

*Yes to 3c or 3d - System is failing to protect groundwater.

Describe verification methods and results:

Attached supporting documentation: Not applicable

4. Operating permit and nitrogen BMP* – Compliance component #4 of 5 Not applicable

Is the system operated under an Operating Permit?

Yes No If "yes", A below is required

Is the system required to employ a Nitrogen BMP specified in the system design? Yes No

If "yes", B below is required

BMP = Best Management Practice(s) specified in the system design

If the answer to both questions is "no", this section does not need to be completed.

Compliance criteria:

a. Have the operating permit requirements been met?

Yes No

b. Is the required nitrogen BMP in place and properly functioning?

Yes No

Any "no" answer indicates noncompliance.

Describe verification methods and results:

Attached supporting documentation: Operating permit (Attach)

5. Soil separation – Compliance component #5 of 5

Date of installation 6/1/1986 Unknown
(mm/dd/yyyy)

Shoreland/Wellhead protection/Food beverage lodging? Yes No

Compliance criteria (select one):

5a. For systems built prior to April 1, 1996, and not located in Shoreland or Wellhead Protection Area or not serving a food, beverage or lodging establishment: Yes No*
 Drainfield has at least a two-foot vertical separation distance from periodically saturated soil or bedrock.

5b. Non-performance systems built April 1, 1996, or later or for non-performance systems located in Shoreland or Wellhead Protection Areas or serving a food, beverage, or lodging establishment: Yes No*
 Drainfield has a three-foot vertical separation distance from periodically saturated soil or bedrock.*

5c. "Experimental", "Other", or "Performance" systems built under pre-2008 Rules; Type IV or V systems built under 2008 Rules 7080.2350 or 7080.2400 (Intermediate Inspector License required ≤ 2,500 gallons per day; Advanced Inspector License required > 2,500 gallons per day) Yes No*
 Drainfield meets the designed vertical separation distance from periodically saturated soil or bedrock.

Attached supporting documentation:

- Soil observation logs completed for the report
- Two previous verifications of required vertical separation
- Not applicable (No soil treatment area)
- _____

Indicate depths or elevations

A. Bottom of distribution media	30"
B. Periodically saturated soil/bedrock	66"
C. System separation	36"
D. Required compliance separation*	24"

*May be reduced up to 15 percent if allowed by Local Ordinance.

***Any "no" answer above indicates the system is failing to protect groundwater.**

Describe verification methods and results:

Planting boxes and gardens are built over the drainfield.

Upgrade requirements: (Minn. Stat. § 115.55) An imminent threat to public health and safety (ITPHS) must be upgraded, replaced, or its use discontinued within ten months of receipt of this notice or within a shorter period if required by local ordinance. If the system is failing to protect ground water, the system must be upgraded, replaced, or its use discontinued within the time required by local ordinance. If an existing system is not failing as defined in law, and has at least two feet of design soil separation, then the system need not be upgraded, repaired, replaced, or its use discontinued, notwithstanding any local ordinance that is more strict. This provision does not apply to systems in shoreland areas, Wellhead Protection Areas, or those used in connection with food, beverage, and lodging establishments as defined in law.



Soil Observation Log

Project ID:

v 03.15.2023

Client: Delano Nelson **Location / Address:** 11801 Lockridge Ave S

Soil parent material(s): (Check all that apply) Outwash Lacustrine Loess Till Alluvium Bedrock Organic Matter Disturbed/Fill

Landscape Position: Shoulder **Slope %:** **Slope shape:** Linear, Convex **Flooding/Run-On potential:**

Vegetation: Grass **Soil survey map units:** 367B & 1820F **Surface Elevation-Relative to benchmark:**

Date/Time of Day/Weather Conditions: 5/5/2023 grey - warm **Limiting Layer Elevation:**

Observation #/Location: See Map **Observation Type:** Auger

Depth (in)	Texture	Rock Frag. %	Matrix Color(s)	Mottle Color(s)	Redox Kind(s)	Indicator(s)	Structure-----I		Consistence
							Shape	Grade	
0-34"	Loamy Fine Sand	100%	10YR 3/3				Blocky	Moderate	Friable
35"-42"	Loamy Very Fine Sand	100%	10YR 4/6				Blocky	Moderate	Friable
43"-66"	Fine Sand	100%	10YR 4/6				Granular	Moderate	Loose

Comments:

I hereby certify that I have completed this work in accordance with all applicable ordinances, rules and laws.

Shelley Schlomka 4137 5/5/2023
 (Designer/Inspector) (License #) (Date)

Optional Verification: I hereby certify that this soil observation was verified according to Minn. R. 7082.0500 subp. 3 A. The signature below represents an infield verification of the periodically saturated soil or bedrock at the proposed soil treatment and dispersal site.

 (LGU/Designer/Inspector) (Cert #) (Date)

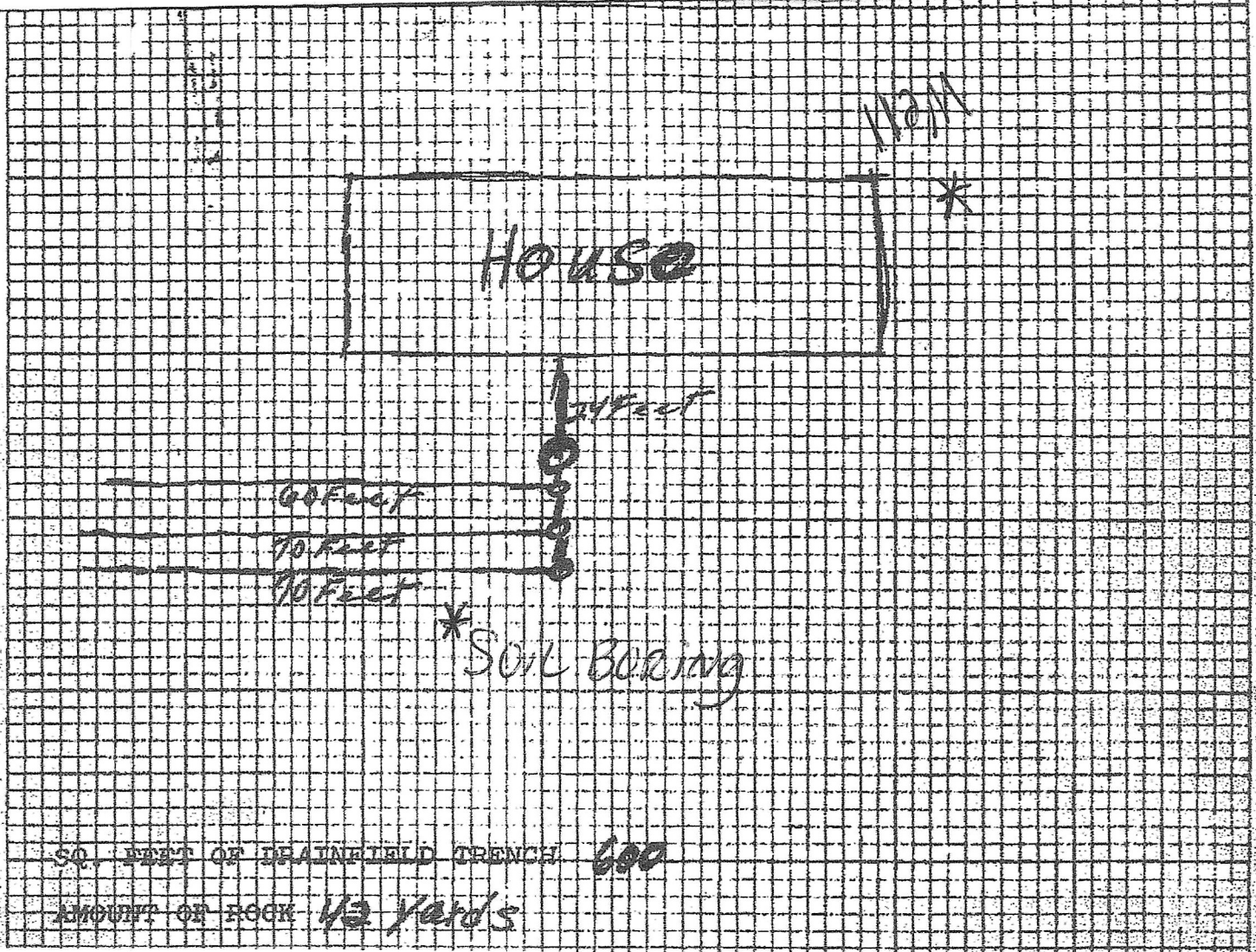

11801 LOCKRIDGE AVE. SOUTH
 COTTAGE GROVE

SS Septic Solutions, LLC additional terms and information.

1. SS Septic Solutions has not been retained to warrant, guarantee, or certify the proper functioning of the system for any period beyond the inspection date. Due to the numerous factors (usage, maintenance, tank pumping, soil characteristics, previous failures, etc.) which may affect the proper operation of a septic system. The report shall not be construed as a warranty that the system will properly function for any particular period of time.
2. Minimum compliance inspection requirements relative to this inspection and this report include only verification that the septic system has a watertight septic tank(s) and lift tank, the required separation from the bottom of the drain field/mound distribution medium and saturated soils, no backup of sewage into the dwelling and no discharge of sewage onto the ground surface or surface water. SS Septic Solutions, LLC does not inspect basement sewage ejector pumps or exterior lift pumps as they are a maintenance item. Sewage backup verification is limited to the information supplied by the last occupants/owner if available. I can not guarantee that the information given to me is accurate. Some people may attempt to hide or conceal signs of previous backups.
3. Certification of this system does not warranty any future use beyond the date of inspection. Any system new or old can be hydraulically overloaded because of more people moving into the house than were previously occupying it, improper maintenance, heavy usage, tree roots, freezing conditions or surface drainage problems. The system could simply stop working due to age.
4. A compliance inspection is not meant to be a test of the longevity of the septic system. The inspection is strictly for the purpose of determining if the septic is polluting the environment at the date and time the inspection is performed. The inspection is not intended to determine if the system was originally designed or installed to past or present MPCA or local unit of government code requirements.
5. Winter Work – Client understand that inspections conducted in winter weather conditions are more difficult to perform due to snow cover and frost. Septic system components like tanks, tank covers, drop boxes and soil treatment areas are more difficult to locate in these conditions. Soil borings and drain field locations are also more difficult to perform due to ground frost. The client needs to understand that due to the weather conditions, the same level of standards may not be possible compared to an inspection during the spring/summer/fall months.
6. If hired to perform the compliance inspection, the client hereby agrees that SS Septic Solutions, LLC will not be responsible for any monetary damages, claims or causes of action including attorney fees arising from the performance of this inspection.