



# Compliance inspection report form

## Existing Subsurface Sewage Treatment System (SSTS)

Doc Type: Compliance and Enforcement

### Instructions:

Control Agency (MPCA) website at

Instructions for filling out this form are located on the Minnesota Pollution

### Property information

Local tracking number:

Parcel ID# or Sec/Twp/Range: 0502921420017 Reason for Inspection Sale of property

Local regulatory authority info: Washington County

Property address: 5440 HILLTOP AVE N, CITY OF LAKE ELMO

Owner/representative: CONNOLLY JOSEPH T Owner's phone: 651-338-2080

Brief system description: Single septic tank gravity fed to drain field

### System status

System status on date (mm/dd/yyyy): 9/27/2023

**Compliant – Certificate of compliance\***

**Noncompliant – Notice of noncompliance**

*(Valid for 3 years from report date unless evidence of an imminent threat to public health or safety requiring removal and abatement under section 145A.04, subdivision 8 is discovered or a shorter time frame exists in Local Ordinance.)*

*Systems failing to protect ground water must be upgraded, replaced, or use discontinued within the time required by local ordinance.*

**\*Note: Compliance indicates conformance with Minn. R. 7080.1500 as of system status date above and does not guarantee future performance.**

*An imminent threat to public health and safety (ITPHS) must be upgraded, replaced, or its use discontinued within ten months of receipt of this notice or within a shorter period if required by local ordinance or under section 145A.04 subdivision 8.*

#### Reason(s) for noncompliance (check all applicable)

- Impact on public health (Compliance component #1) – *Imminent threat to public health and safety*
- Tank integrity (Compliance component #2) – *Failing to protect groundwater*
- Other Compliance Conditions (Compliance component #3) – *Imminent threat to public health and safety*
- Other Compliance Conditions (Compliance component #3) – *Failing to protect groundwater*
- System not abandoned according to Minn. R. 7080.2500 (Compliance component #3) – *Failing to protect groundwater*
- Soil separation (Compliance component #5) – *Failing to protect groundwater*
- Operating permit/monitoring plan requirements (Compliance component #4) – *Noncompliant - local ordinance applies*

#### Comments or recommendations

### Certification

*I hereby certify that all the necessary information has been gathered to determine the compliance status of this system. No determination of future system performance has been nor can be made due to unknown conditions during system construction, possible abuse of the system, inadequate maintenance, or future water usage.*

**By typing my name below, I certify the above statements to be true and correct, to the best of my knowledge, and that this information can be used for the purpose of processing this form.**

Business name: SS Septic Solutions, LLC.

Certification number: 9917

Inspector signature: *Melley Schomburg*

License number: 4137

*(This document has been electronically signed)*

Phone: 651-343-9117

### Necessary or locally required supporting documentation

- Soil observation logs
- System/As-Built
- Locally required forms
- Tank Integrity Assessment
- Operating Permit
- Other information (list):



**1. Impact on public health – Compliance component #1 of 5**

**Compliance criteria:**

System discharges sewage to the ground surface	<input type="checkbox"/> Yes <input checked="" type="checkbox"/> No
System discharges sewage to drain tile or surface waters.	<input type="checkbox"/> Yes <input checked="" type="checkbox"/> No
System causes sewage backup into dwelling or establishment.	<input type="checkbox"/> Yes <input checked="" type="checkbox"/> No

**Attached supporting documentation:**

- Other: \_\_\_\_\_
- Not applicable

**Describe verification methods and results:**

**2. Tank integrity – Compliance component #2 of 5**

**Compliance criteria:**

System consists of a seepage pit, cesspool, drywell, leaching pit, or other pit?	<input type="checkbox"/> Yes <input checked="" type="checkbox"/> No
Sewage tank(s) leak below their designed operating depth?	<input type="checkbox"/> Yes <input checked="" type="checkbox"/> No
If yes, which sewage tank(s) leaks:	

**Attached supporting documentation:**

- Empty tank(s) viewed by inspector
  - Name of maintenance business: Meyers
  - License number of maintenance business: \_\_\_\_\_
  - Date of maintenance: 9/27/2023
- Existing tank integrity assessment (Attach)
  - Date of maintenance (mm/dd/yyyy): \_\_\_\_\_ (must be within three years)
  - (See form instructions to ensure assessment complies with Minn. R. 7082.0700 subp. 4 B (1))*
- Tank is Noncompliant (pumping not necessary – explain below)
- Other: \_\_\_\_\_

**Describe verification methods and results:**

Tank in good shape for it's age. Since this system is original, the new owners should get the tank serviced every two years.



**3. Other compliance conditions – Compliance component #3 of 5**

3a. Maintenance hole covers appear to be structurally unsound (damaged, cracked, etc.), or unsecured?

Yes  No  Unknown

3b. Other issues (electrical hazards, etc.) to immediately and adversely impact public health or safety?  Yes  No  Unknown

3c. System is non-protective of ground water for other conditions as determined by inspector?  Yes  No

3d. System not abandoned in accordance with Minn. R. 7080.2500?  Yes  No

**Describe verification methods and results:**

Attached supporting documentation:  Not applicable

**4. Operating permit and nitrogen BMP\* – Compliance component #4 of 5  Not applicable**

Is the system operated under an Operating Permit?  Yes  No If "yes", A below is required

Is the system required to employ a Nitrogen BMP specified in the system design?  Yes  No If "yes", B below is required

*BMP = Best Management Practice(s) specified in the system design*

**If the answer to both questions is "no", this section does not need to be completed.**

**Compliance criteria:**

a. Have the operating permit requirements been met?  Yes  No

b. Is the required nitrogen BMP in place and properly functioning?  Yes  No

**Describe verification methods and results:**

Attached supporting documentation:  Operating permit (Attach)



### 5. Soil separation – Compliance component #5 of 5

Date of installation 7/1/1979  Unknown  
(mm/dd/yyyy)

Shoreland/Wellhead protection/Food beverage lodging?  Yes  No

**Compliance criteria (select one):**

5a. For systems built prior to April 1, 1996, and not located in Shoreland or Wellhead Protection Area or not serving a food, beverage or lodging establishment:  Yes  No  
 Drainfield has at least a two-foot vertical separation distance from periodically saturated soil or bedrock.

5b. Non-performance systems built April 1, 1996, or later or for non-performance systems located in Shoreland or Wellhead Protection Areas or serving a food, beverage, or lodging establishment:  Yes  No  
 Drainfield has a three-foot vertical separation distance from periodically saturated soil or bedrock.\*

5c. "Experimental", "Other", or "Performance" systems built under pre-2008 Rules; Type IV or V systems built under 2008 Rules 7080.2350 or 7080.2400 (Intermediate Inspector License required ≤ 2,500 gallons per day; Advanced Inspector License required > 2,500 gallons per day)  Yes  No  
 Drainfield meets the designed vertical separation distance from periodically saturated soil or bedrock.

**Attached supporting documentation:**

- Soil observation logs completed for the report
- Two previous verifications of required vertical separation
- Not applicable (No soil treatment area)
- \_\_\_\_\_

**Indicate depths or elevations**

A. Bottom of distribution media	42"
B. Periodically saturated soil/bedrock	72"
C. System separation	30"
D. Required compliance separation*	24"

\*May be reduced up to 15 percent if allowed by Local Ordinance.

**Describe verification methods and results:**

**Upgrade requirements:** (Minn. Stat. § 115.55) An imminent threat to public health and safety (ITPHS) must be upgraded, replaced, or its use discontinued within ten months of receipt of this notice or within a shorter period if required by local ordinance. If the system is failing to protect ground water, the system must be upgraded, replaced, or its use discontinued within the time required by local ordinance. If an existing system is not failing as defined in law, and has at least two feet of design soil separation, then the system need not be upgraded, repaired, replaced, or its use discontinued, notwithstanding any local ordinance that is more strict. This provision does not apply to systems in shoreland areas, Wellhead Protection Areas, or those used in connection with food, beverage, and lodging establishments as defined in law.





# Soil Observation Log

Project ID: \_\_\_\_\_ v 03.15.2023

<b>Client:</b> Joe Connolly		<b>Location / Address:</b> 5440 Hilltop Ave. N. - Lake Elmo							
<b>Soil parent material(s):</b> (Check all that apply) <input checked="" type="checkbox"/> Outwash <input type="checkbox"/> Lacustrine <input type="checkbox"/> Loess <input type="checkbox"/> Till <input type="checkbox"/> Alluvium <input type="checkbox"/> Bedrock <input type="checkbox"/> Organic Matter <input type="checkbox"/> Disturbed/Fill									
<b>Landscape Position:</b> Shoulder		<b>Slope %:</b> _____							
<b>Vegetation:</b> Lawn		<b>Slope shape:</b> Convex, Convex							
<b>Date/Time of Day/Weather Conditions:</b> 9/27/2023 2:00 warm		<b>Soil survey map units:</b> 454C							
<b>Observation #/Location:</b> See Map		<b>Observation Type:</b> Auger							
<b>Depth (in)</b>	<b>Texture</b>	<b>Rock Frag. %</b>	<b>Matrix Color(s)</b>	<b>Mottle Color(s)</b>	<b>Redox Kind(s)</b>	<b>Indicator(s)</b>	<b>Structure</b>		
							<b>Shape</b>	<b>Grade</b>	<b>Consistence</b>
0-12"	Loamy Coarse Sand	0	7.5YR 3/3				Granular	Moderate	Loose
13" - 48"	Coarse Sand	0	7.5YR 4/3				Granular	Moderate	Loose
49" - 72"	Coarse Sand	0	7.5YR 3/3				Granular	Moderate	Loose
<b>Comments:</b>									
I hereby certify that I have completed this work in accordance with all applicable ordinances, rules and laws.									
Shelley Schlomka		4137		9/27/2023					
(Designer/Inspector)		(License #)		(Date)					
<b>Optional Verification:</b> I hereby certify that this soil observation was verified according to Minn. R. 7082.0500 subp. 3 A. The signature below represents an infield verification of the periodically saturated soil or bedrock at the proposed soil treatment and dispersal site.									
_____		_____		_____		_____			
(LGU/Designer/Inspector)		(Signature)		(Cert #)		(Date)			



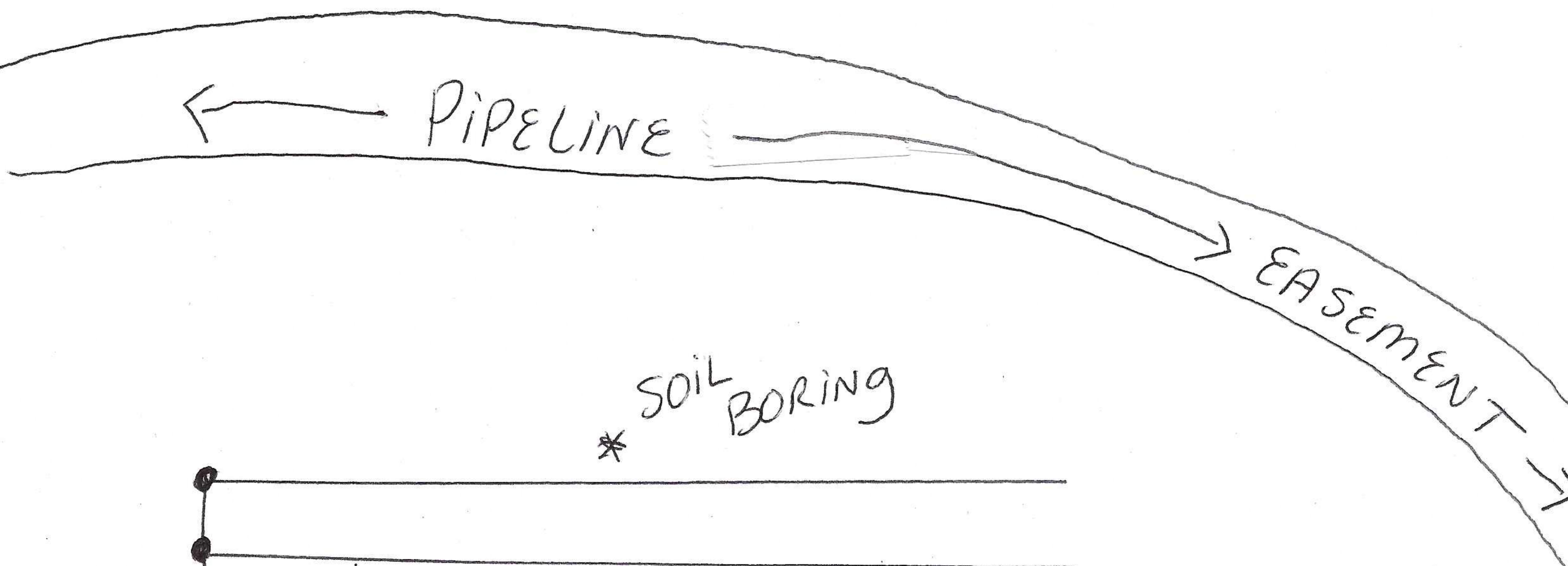

\* SOIL BORING

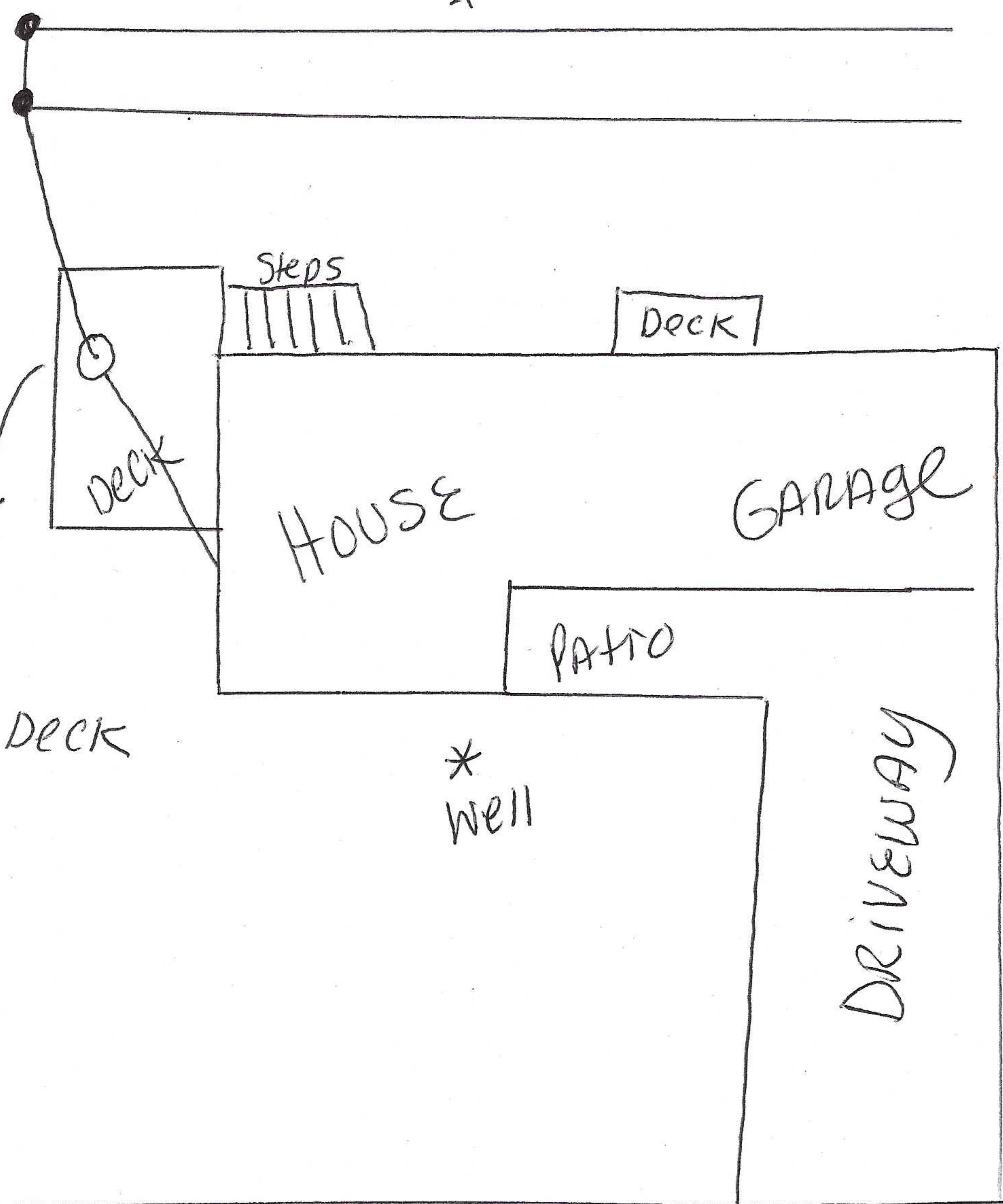

SEPTIC TANK UNDER DECK

5440 Hilltop AVE N.



### **SS Septic Solutions, LLC additional terms and information.**

1. SS Septic Solutions, LLC has not been retained to warrant, guarantee, or certify the proper functioning of the system for any period beyond the inspection date. Due to numerous factors (usage, maintenance, tank pumping, soil characteristics, previous failures, etc.) which may affect the proper operation of a septic system. The report shall not be construed as a warranty that the system will properly function for any period.
2. Minimum compliance inspection requirements relative to this inspection and this report include only verification that the septic system has a watertight septic tank(s) and lift tank, the required separation from the bottom of the drain field/mound distribution medium and saturated soils, no backup of sewage into the dwelling and no discharge of sewage onto the ground surface or surface water. SS Septic Solutions, LLC does not inspect basement sewage ejector pumps or exterior lift pumps as they are a maintenance item. Sewage backup verification is limited to the information supplied by the last occupants/owner if available. I cannot guarantee that the information given to me is accurate. Some people may attempt to hide or conceal signs of previous backups.
3. Certification of this system does not warranty any future use beyond the date of inspection. Any system, new or old, can be hydraulically overloaded because of more people moving into the house than were previously occupying it, improper maintenance, heavy usage, tree roots, freezing conditions, or surface drainage problems. The system could simply stop working due to age.
4. A compliance inspection is not meant to be a test of the longevity of the septic system. The inspection is strictly for the purpose of determining if the septic is polluting the environment at the date and time the inspection is performed. The inspection is not intended to determine if the system was originally designed or installed to past or present MPCA or local unit of government code requirements.
5. Winter Work – Client understands that inspections conducted in winter weather conditions are more difficult to perform due to snow cover and frost. Septic system components like tanks, tank covers, drop boxes and soil treatment areas are more difficult to locate in these conditions. Soil borings and drain field locations are also more difficult to perform due to ground frost. The client needs to understand that due to the weather conditions, the same level of standards may not be possible compared to an inspection during the spring/summer/fall months.
6. If hired to perform the compliance inspection, the client hereby agrees that SS Septic Solutions, LLC will not be responsible for any monetary damages, claims or causes of action including attorney fees arising from the performance of this inspection.
7. Nothing other than gray water (laundry, showers, etc.) human waste and toilet tissue should be disposed of into the septic tanks. Garbage disposals are not recommended. Smaller amounts of laundry, soaps, dish soap, cleaning agents, etc. are better for the system. Antibacterial soaps and chlorine agents may kill the bacteria needed to treat effluent properly. Additives are not recommended and may be harmful to your system. Recommend to pump and clean your tanks by a certified pumper every other year if you have 1 tank and every 2-3 years if you have a 2-tank system to ensure proper maintenance.



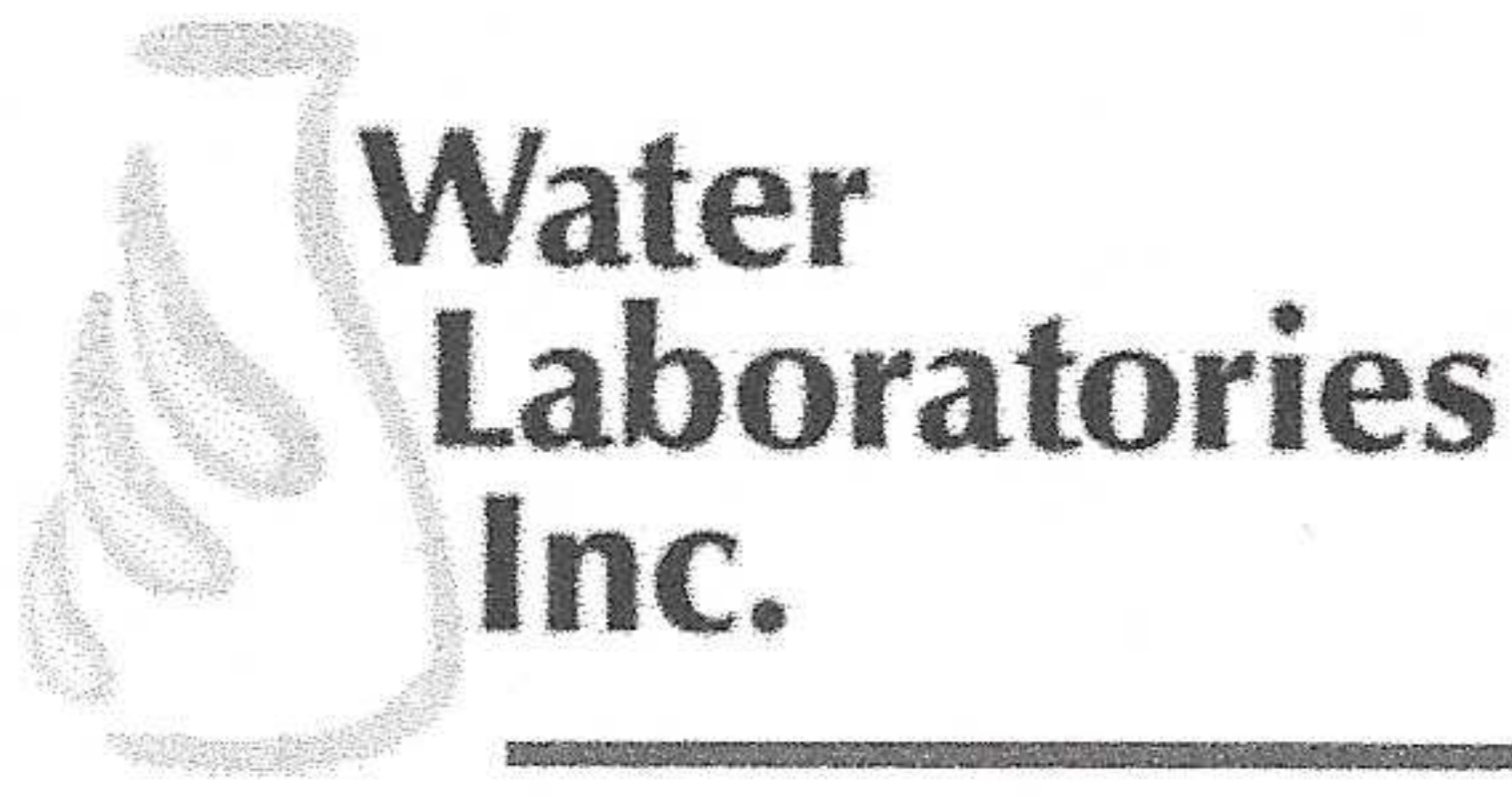

333 Main Street NW  
P.O. Box 388  
Elk River, MN 55330  
Phone: 763-441-7509  
Fax: 763-441-9176

**DRINKING WATER LABORATORY TEST REPORT**

**Last Name:** CONNOLLY **File #:** 83451  
**First Name:** JOE **Date/Time in Lab:** 9/28/2023 9:54 AM  
**Address:** 5440 HILLTOP AVE N  
**City:** LAKE ELMO **Unique Well #:**  
**State:** MN **Zip Code:** **Drillers #:**  
**County:**  
**Legal:**

**Ordered By:** SS SEPTIC SOLUTIONS **Sampled From:** Outside Tap  
**Sampled By:** SS SEPTIC SOLUTIONS **Date/Time Sampled:** 09/27/2023 1445  
**Reason For Test:** Coliform + Nitrate **Sample Temp:** 22.4 ° C  
**Received on Ice:** No

<u>ANALYTE &amp; METHOD</u>	<u>DATE &amp; TIME OF ANALYSIS</u>	<u>MAXIMUM CONTAMINATION LEVEL (EPA)</u>	<u>TEST RESULTS</u>
Coliform Bacteria (SM 9223 B)	09/28/2023 1005	Negative	Negative
Nitrate (EPA 353.2 Rev 2.0)	09/28/2023 1334	10.0 ppm	< 0.5 ppm

This sample **DOES** meet EPA guidelines for safe drinking water for the Analytes tested.

**Notes:**

The test results are only indicative of the sample tested from the sample point on the date collected.  
This report must not be reproduced, except in full, without the written approval from Water Laboratories, Inc.  
Minnesota Certification# 027-141-110, Wisconsin Certification #399044470 (for compliance with NR812)

**Water Laboratories, Inc.**

**By:** 

**Date:** 09/29/2023

Received By TJ Entered By TJ Edited By TJ

**Amount Billed:**

**Date Paid:** 09/28/2023

**Amount Paid:**