

Compliance inspection report form

Existing Subsurface Sewage Treatment System (SSTS)

Doc Type: Compliance and Enforcement

Instructions: Inspector must submit completed form to Local Governmental Unit (LGU) and system owner within 15 days of final determination of compliance or noncompliance. Instructions for filling out this form are located on the Minnesota Pollution Control Agency (MPCA) website at <https://www.pca.state.mn.us/sites/default/files/wq-wwists4-31a.pdf>.

Property information

Local tracking number: _____

Parcel ID# or Sec/Twp/Range: 35-031.20.0013 Reason for Inspection: Property Transfer
Local regulatory authority info: Washington County
Property address: 12190 - Panama Ave. N. Stillwater, MN. (May Twp) 55082
Owner representative: Peter Rose Owner's phone: 507-358-8882
Brief system description: Septic + Pump TANKS w/ Drainfield & Trenches

System status

System status on date (mm/dd/yyyy): 3-4-2024

Compliant – Certificate of compliance*

Noncompliant – Notice of noncompliance

(Valid for 3 years from report date unless evidence of an imminent threat to public health or safety requiring removal and abatement under section 145A.04, subdivision 8 is discovered or a shorter time frame exists in Local Ordinance.)

Systems failing to protect ground water must be upgraded, replaced, or use discontinued within the time required by local ordinance.

***Note: Compliance indicates conformance with Minn. R. 7080.1500 as of system status date above and does not guarantee future performance.**

An imminent threat to public health and safety (ITPHS) must be upgraded, replaced, or its use discontinued within ten months of receipt of this notice or within a shorter period if required by local ordinance or under section 145A.04 subdivision 8.

Reason(s) for noncompliance (check all applicable)

- Impact on public health (Compliance component #1) – *Imminent threat to public health and safety*
- Tank integrity (Compliance component #2) – *Failing to protect groundwater*
- Other Compliance Conditions (Compliance component #3) – *Imminent threat to public health and safety*
- Other Compliance Conditions (Compliance component #3) – *Failing to protect groundwater*
- System not abandoned according to Minn. R. 7080.2500 (Compliance component #3) – *Failing to protect groundwater*
- Soil separation (Compliance component #5) – *Failing to protect groundwater*
- Operating permit/monitoring plan requirements (Compliance component #4) – *Noncompliant - local ordinance applies*

Comments or recommendations

RECEIVED

MAR 21 2024

PUBLIC HEALTH

Certification

I hereby certify that all the necessary information has been gathered to determine the compliance status of this system. No determination of future system performance has been nor can be made due to unknown conditions during system construction, possible abuse of the system, inadequate maintenance, or future water usage.

By typing my name below, I certify the above statements to be true and correct, to the best of my knowledge, and that this information can be used for the purpose of processing this form.

Business name: Sanber P&H Co. Certification number: 925
Inspector signature: [Signature] License number: 317
(This document has been electronically signed) Phone: 651-463-7434

Necessary or locally required supporting documentation (must be attached)

- Soil observation logs
- System/As-Built
- Locally required forms
- Tank Integrity Assessment
- Operating Permit
- Other information (list): _____

Property Address: 12190 - Panama Ave. N. Stillwater MN.
 Business Name: Jauber P & H Co. Date: 3-4-2024

1. Impact on public health – Compliance component #1 of 5

Compliance criteria:

System discharges sewage to the ground surface	<input type="checkbox"/> Yes* <input checked="" type="checkbox"/> No
System discharges sewage to drain tile or surface waters.	<input type="checkbox"/> Yes* <input checked="" type="checkbox"/> No
System causes sewage backup into dwelling or establishment.	<input type="checkbox"/> Yes* <input checked="" type="checkbox"/> No

Any "yes" answer above indicates the system is an imminent threat to public health and safety.

Describe verification methods and results:

Attached supporting documentation:

- Other: _____
 Not applicable

2. Tank integrity – Compliance component #2 of 5

Compliance criteria:

System consists of a seepage pit, cesspool, drywell, leaching pit, or other pit?	<input type="checkbox"/> Yes* <input checked="" type="checkbox"/> No
Sewage tank(s) leak below their designed operating depth?	<input type="checkbox"/> Yes* <input checked="" type="checkbox"/> No
If yes, which sewage tank(s) leaks:	

Any "yes" answer above indicates the system is failing to protect groundwater.

Describe verification methods and results:

3-4-2024 Normal operating level - Viewed empty tanks - Probed bottom - checked bottles before pumping
3-5-2024

Attached supporting documentation:

- Empty tank(s) viewed by inspector
 Name of maintenance business: Pinky's Sewer Service Inc.
 License number of maintenance business: 4251
 Date of maintenance: 3-7-2024
 Existing tank integrity assessment (Attach)
 Date of maintenance (mm/dd/yyyy): 3-7-2024 (must be within three years)
 (See form instructions to ensure assessment complies with Minn. R. 7082.0700 subp. 4 B (1))
 Tank is Noncompliant (pumping not necessary – explain below)
 Other: _____

Property Address: 12190- Pagama Ave. N. Stillwater, MN.
Business Name: Jauber P.H.C. Date: 3-4-2024

3. Other compliance conditions – Compliance component #3 of 5

- 3a. Maintenance hole covers appear to be structurally unsound (damaged, cracked, etc.), or unsecured?
 Yes* No Unknown
- 3b. Other issues (electrical hazards, etc.) to immediately and adversely impact public health or safety? Yes* No Unknown
**Yes to 3a or 3b - System is an imminent threat to public health and safety.*
- 3c. System is non-protective of ground water for other conditions as determined by inspector? Yes* No
- 3d. System not abandoned in accordance with Minn. R. 7080.2500? Yes* No
**Yes to 3c or 3d - System is failing to protect groundwater.*

Describe verification methods and results:

Attached supporting documentation: Not applicable _____

4. Operating permit and nitrogen BMP* – Compliance component #4 of 5 Not applicable

- Is the system operated under an Operating Permit? Yes No **If "yes", A below is required**
Is the system required to employ a Nitrogen BMP specified in the system design? Yes No **If "yes", B below is required**
BMP = Best Management Practice(s) specified in the system design

If the answer to both questions is "no", this section does not need to be completed.

Compliance criteria:

- a. Have the operating permit requirements been met? Yes No
b. Is the required nitrogen BMP in place and properly functioning? Yes No

Any "no" answer indicates noncompliance.

Describe verification methods and results:

Attached supporting documentation: Operating permit (Attach)

Property Address: 12190 Panama Ave. N. Stillwater MN
 Business Name: Jambor P&H Co. Date: 3-4-2024

5. Soil separation – Compliance component #5 of 5

Date of installation 1979 Unknown
 (mm/dd/yyyy)

Shoreland/Wellhead protection/Food beverage lodging? Yes No

Attached supporting documentation:
 Soil observation logs completed for the report
 Two previous verifications of required vertical separation
 Not applicable (No soil treatment area)

Compliance criteria (select one):

5a. For systems built prior to April 1, 1996, and not located in Shoreland or Wellhead Protection Area or not serving a food, beverage or lodging establishment: Yes No*
 Drainfield has at least a two-foot vertical separation distance from periodically saturated soil or bedrock.

5b. Non-performance systems built April 1, 1996, or later or for non-performance systems located in Shoreland or Wellhead Protection Areas or serving a food, beverage, or lodging establishment: Yes No*
 Drainfield has a three-foot vertical separation distance from periodically saturated soil or bedrock.*

Indicate depths or elevations

A. Bottom of distribution media	25'-26" 5
B. Periodically saturated soil/bedrock	26" 5
C. System separation	3'
D. Required compliance separation*	3'

*May be reduced up to 15 percent if allowed by Local Ordinance.

5c. "Experimental", "Other", or "Performance" systems built under pre-2008 Rules; Type IV or V systems built under 2008 Rules 7080. 2350 or 7080.2400 (Intermediate Inspector License required ≤ 2,500 gallons per day; Advanced Inspector License required > 2,500 gallons per day) Yes No*
 Drainfield meets the designed vertical separation distance from periodically saturated soil or bedrock.

***Any "no" answer above indicates the system is failing to protect groundwater.**

Describe verification methods and results:

Upgrade requirements: (Minn. Stat. § 115.55) An imminent threat to public health and safety (ITPHS) must be upgraded, replaced, or its use discontinued within ten months of receipt of this notice or within a shorter period if required by local ordinance. If the system is failing to protect ground water, the system must be upgraded, replaced, or its use discontinued within the time required by local ordinance. If an existing system is not failing as defined in law, and has at least two feet of design soil separation, then the system need not be upgraded, repaired, replaced, or its use discontinued, notwithstanding any local ordinance that is more strict. This provision does not apply to systems in shoreland areas, Wellhead Protection Areas, or those used in connection with food, beverage, and lodging establishments as defined in law.



Soil Observation Log

Project ID:

v 03.15.2023

Client: Peter Rose

Location / Address: 12190 - Parana Ave. N Stillwater, MN

Soil parent material(s): (Check all that apply) Outwash Lacustrine Loess Till Alluvium Bedrock Organic Matter Disturbed/fill

Landscape Position: Shrub Area Slope %: 4-5% Slope shape: L, L. Flooding/Run-On potential:

Vegetation: Aspen Soil survey map units: 3-4-2034 Surface Elevation-Relative to benchmark: 2.1 Limiting Layer Elevation:

Date/Time of Day/Weather Conditions: 3-4-2024 Day Observation Type: Soil Auger

Observation #/Location:	Texture	Rock Frag. %	Matrix Color(s)	Mottle Color(s)	Redox Kind(s)	Indicator(s)	Structure		
							Shape	Grade	Consistence
0-8	Spiky loam	10	10YR 3/2	—	—	—	Angular	bedrock	Frill
8-14	"	10	10YR 5/4	—	—	—	fine grain	black	loose
14-22	Dark red	10	10YR 5/4	—	—	—	fine grain	black	loose
No Lobs.									

Comments:

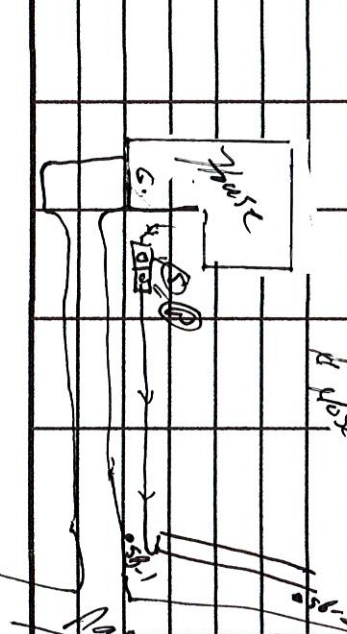

I hereby certify that I have completed this work in accordance with all applicable ordinances, rules and laws.

Designer/Inspector: Verity Seiber

(Signature)

(License #) 925

(Date) 3-4-2024

Optional Verification: I hereby certify that this soil observation was verified according to Minn. R. 7082.0500 subp. 3 A. The signature below represents an infield verification of the periodically saturated soil or bedrock at the proposed soil treatment and dispersal site.

(LGU/Designer/Inspector)

(Signature)

(Cert #)

(Date)

