

# Compliance inspection report form

## Existing Subsurface Sewage Treatment System (SSTS)

Doc Type: Compliance and Enforcement

### Instructions:

Control Agency (MPCA) website at

Instructions for filling out this form are located on the Minnesota Pollution

### Property information

Local tracking number: \_\_\_\_\_

Parcel ID# or Sec/Twp/Range: 3102821210012 Reason for Inspection Transfer of deed

Local regulatory authority info: Washington County

Property address: 6372 CRACKLEBERRY TRL, CITY OF WOODBURY

Owner/representative: REYNOLDS SAMUEL N & KELLIE J Owner's phone: n/a

Brief system description: 1500 gallon septic tank to gravity fed drainfield with 4-64' trenches

### System status

System status on date (mm/dd/yyyy): 7/22/2024

**Compliant – Certificate of compliance\***

*(Valid for 3 years from report date unless evidence of an imminent threat to public health or safety requiring removal and abatement under section 145A.04, subdivision 8 is discovered or a shorter time frame exists in Local Ordinance.)*

**\*Note: Compliance indicates conformance with Minn. R. 7080.1500 as of system status date above and does not guarantee future performance.**

**Noncompliant – Notice of noncompliance**

*Systems failing to protect ground water must be upgraded, replaced, or use discontinued within the time required by local ordinance.*

*An imminent threat to public health and safety (ITPHS) must be upgraded, replaced, or its use discontinued within ten months of receipt of this notice or within a shorter period if required by local ordinance or under section 145A.04 subdivision 8.*

#### Reason(s) for noncompliance (check all applicable)

- Impact on public health (Compliance component #1) – *Imminent threat to public health and safety*
- Tank integrity (Compliance component #2) – *Failing to protect groundwater*
- Other Compliance Conditions (Compliance component #3) – *Imminent threat to public health and safety*
- Other Compliance Conditions (Compliance component #3) – *Failing to protect groundwater*
- System not abandoned according to Minn. R. 7080.2500 (Compliance component #3) – *Failing to protect groundwater*
- Soil separation (Compliance component #5) – *Failing to protect groundwater*
- Operating permit/monitoring plan requirements (Compliance component #4) – *Noncompliant - local ordinance applies*

#### Comments or recommendations

### Certification

*I hereby certify that all the necessary information has been gathered to determine the compliance status of this system. No determination of future system performance has been nor can be made due to unknown conditions during system construction, possible abuse of the system, inadequate maintenance, or future water usage.*

**By typing my name below, I certify the above statements to be true and correct, to the best of my knowledge, and that this information can be used for the purpose of processing this form.**

Business name: SS Septic Solutions, LLC.

Certification number: 9917

Inspector signature: Shelley Schlomka

License number: 4137

*(This document has been electronically signed)*

Phone: 651-343-9117

### Necessary or locally required supporting documentation

- Soil observation logs
- System/As-Built
- Locally required forms
- Tank Integrity Assessment
- Operating Permit
- Other information (list): \_\_\_\_\_



Property Address: 6372 CRACKLEBERRY TRL, CITY OF WOODBURY

Business Name: SS Septic Solutions, LLC.

Date: 7/22/2024

### 1. Impact on public health – Compliance component #1 of 5

**Compliance criteria:**

System discharges sewage to the ground surface	<input type="checkbox"/> Yes <input checked="" type="checkbox"/> No
System discharges sewage to drain tile or surface waters.	<input type="checkbox"/> Yes <input checked="" type="checkbox"/> No
System causes sewage backup into dwelling or establishment.	<input type="checkbox"/> Yes <input checked="" type="checkbox"/> No

**Attached supporting documentation:**

- Other: \_\_\_\_\_
- Not applicable

**Describe verification methods and results:**

### 2. Tank integrity – Compliance component #2 of 5

**Compliance criteria:**

System consists of a seepage pit, cesspool, drywell, leaching pit, or other pit?	<input type="checkbox"/> Yes <input checked="" type="checkbox"/> No
Sewage tank(s) leak below their designed operating depth?	<input type="checkbox"/> Yes <input checked="" type="checkbox"/> No
If yes, which sewage tank(s) leaks:	

**Attached supporting documentation:**

- Empty tank(s) viewed by inspector
  - Name of maintenance business: Meyers
  - License number of maintenance business: \_\_\_\_\_
  - Date of maintenance: 7/22/2024
- Existing tank integrity assessment (Attach)
  - Date of maintenance (mm/dd/yyyy): \_\_\_\_\_ (must be within three years)
  - (See form instructions to ensure assessment complies with Minn. R. 7082.0700 subp. 4 B (1))*
- Tank is Noncompliant (pumping not necessary – explain below)
- Other: \_\_\_\_\_

**Describe verification methods and results:**

Tank water tight at time of inspection. Tank should be pumped every 1-2 years since there is only one tank.



Property Address: 6372 CRACKLEBERRY TRL, CITY OF WOODBURY

Business Name: SS Septic Solutions, LLC.

Date: 7/22/2024

### 3. Other compliance conditions – Compliance component #3 of 5

3a. Maintenance hole covers appear to be structurally unsound (damaged, cracked, etc.), or unsecured?

Yes  No  Unknown

3b. Other issues (*electrical hazards, etc.*) to immediately and adversely impact public health or safety?  Yes  No  Unknown

3c. System is non-protective of ground water for other conditions as determined by inspector?  Yes  No

3d. System not abandoned in accordance with Minn. R. 7080.2500?  Yes  No

Describe verification methods and results:

Attached supporting documentation:  Not applicable

### 4. Operating permit and nitrogen BMP\* – Compliance component #4 of 5 Not applicable

Is the system operated under an Operating Permit?  Yes  No If "yes", A below is required

Is the system required to employ a Nitrogen BMP specified in the system design?  Yes  No If "yes", B below is required

*BMP = Best Management Practice(s) specified in the system design*

***If the answer to both questions is "no", this section does not need to be completed.***

**Compliance criteria:**

a. Have the operating permit requirements been met?  Yes  No

b. Is the required nitrogen BMP in place and properly functioning?  Yes  No

Describe verification methods and results:

Attached supporting documentation:  Operating permit (Attach)



### 5. Soil separation – Compliance component #5 of 5

Date of installation 1988  Unknown  
(mm/dd/yyyy)

Shoreland/Wellhead protection/Food beverage lodging?  Yes  No

**Attached supporting documentation:**

- Soil observation logs completed for the report
- Two previous verifications of required vertical separation
- Not applicable (No soil treatment area)
- \_\_\_\_\_

**Compliance criteria (select one):**

<p>5a. For systems built prior to April 1, 1996, and not located in Shoreland or Wellhead Protection Area or not serving a food, beverage or lodging establishment:</p> <p>Drainfield has at least a two-foot vertical separation distance from periodically saturated soil or bedrock.</p>	<input type="checkbox"/> Yes <input type="checkbox"/> No
<p>5b. Non-performance systems built April 1, 1996, or later or for non-performance systems located in Shoreland or Wellhead Protection Areas or serving a food, beverage, or lodging establishment:</p> <p>Drainfield has a three-foot vertical separation distance from periodically saturated soil or bedrock.*</p>	<input checked="" type="checkbox"/> Yes <input type="checkbox"/> No
<p>5c. "Experimental", "Other", or "Performance" systems built under pre-2008 Rules; Type IV or V systems built under 2008 Rules 7080.2350 or 7080.2400 (Intermediate Inspector License required ≤ 2,500 gallons per day; Advanced Inspector License required &gt; 2,500 gallons per day)</p> <p>Drainfield meets the designed vertical separation distance from periodically saturated soil or bedrock.</p>	<input type="checkbox"/> Yes <input type="checkbox"/> No

**Indicate depths or elevations**

A. Bottom of distribution media	48"
B. Periodically saturated soil/bedrock	84"
C. System separation	36"
D. Required compliance separation*	36"

\*May be reduced up to 15 percent if allowed by Local Ordinance.

**Describe verification methods and results:**

Drain field intalled deep to take advantage of the best soil.

**Upgrade requirements:** (Minn. Stat. § 115.55) An imminent threat to public health and safety (ITPHS) must be upgraded, replaced, or its use discontinued within ten months of receipt of this notice or within a shorter period if required by local ordinance. If the system is failing to protect ground water, the system must be upgraded, replaced, or its use discontinued within the time required by local ordinance. If an existing system is not failing as defined in law, and has at least two feet of design soil separation, then the system need not be upgraded, repaired, replaced, or its use discontinued, notwithstanding any local ordinance that is more strict. This provision does not apply to systems in shoreland areas, Wellhead Protection Areas, or those used in connection with food, beverage, and lodging establishments as defined in law.



# Soil Observation Log

Project ID:

v 03.15.2023

Client: **Nathan Reynolds** Location / Address: **6372 Crackleberry Trail - Woodbury**

Soil parent material(s): (Check all that apply)  Outwash  Lacustrine  Loess  Till  Alluvium  Bedrock  Organic Matter  Disturbed/Fill

Landscape Position: **Back/Side Slope** Slope shape: **Convex, Linear** Flooding/Run-On potential:

Vegetation: **Lawn** Soil survey map units: **155C** Surface Elevation-Relative to benchmark:

Date/Time of Day/Weather Conditions: **7/22/2024** Limiting Layer Elevation:

Observation #/Location: See map Observation Type: **Auger**

Depth (in)	Texture	Rock Frag. %	Matrix Color(s)	Mottle Color(s)	Redox Kind(s)	Indicator(s)	Structure		Consistence
							Shape	Grade	
0 - 16"	Medium Loamy Sand	0	10YR 3/3				Granular		Loose
16" - 42"	Sandy Clay Loam	10	10YR 3/3				Blocky		Friable
42" - 65"	Medium Loamy Sand	15	10YR 3/4				Granular		Loose
65" - 84"	Coarse Sand	20	10YR 4/4				Granular		Loose

Comments:

I hereby certify that I have completed this work in accordance with all applicable ordinances, rules and laws.

Shelley Schlomka (Designer/Inspector) License # 4137 Signature Date 7/22/2024

Optional Verification: I hereby certify that this soil observation was verified according to Minn. R. 7082.0500 subp. 3 A. The signature below represents an infield verification of the periodically saturated soil or bedrock at the proposed soil treatment and dispersal site.

(LGU/Designer/Inspector) (Signature) (Cert #) (Date)



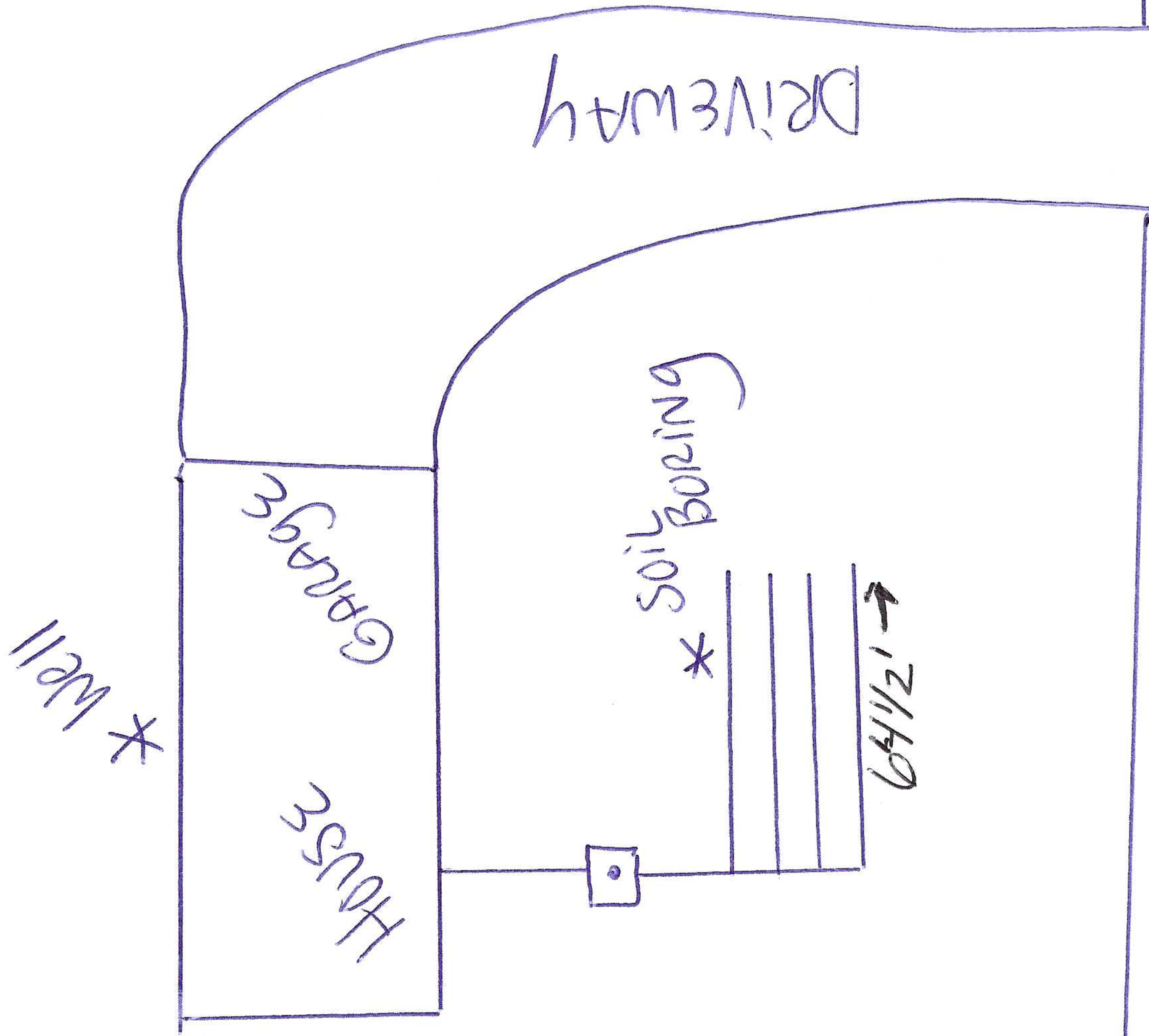

6372 CRACKIEBERRY



## 2SS Septic Solutions, LLC additional terms and information.

1. SS Septic Solutions, LLC has not been retained to warrant, guarantee, or certify the proper functioning of the system for any period beyond the inspection date. Due to numerous factors (usage, maintenance, tank pumping, soil characteristics, previous failures, etc.) which may affect the proper operation of a septic system. The report shall not be construed as a warranty that the system will properly function for any period.
2. Minimum compliance inspection requirements relative to this inspection and this report include only verification that the septic system has a watertight septic tank(s) and lift tank, the required separation from the bottom of the drain field/mound distribution medium and saturated soils, no backup of sewage into the dwelling and no discharge of sewage onto the ground surface or surface water. SS Septic Solutions, LLC does not inspect basement sewage ejector pumps or exterior lift pumps as they are a maintenance item. Sewage backup verification is limited to the information supplied by the last occupants/owner if available. I cannot guarantee that the information given to me is accurate. Some people may attempt to hide or conceal signs of previous backups.
3. Certification of this system does not warranty any future use beyond the date of inspection. Any system, new or old, can be hydraulically overloaded because of more people moving into the house than were previously occupying it, improper maintenance, heavy usage, tree roots, freezing conditions, or surface drainage problems. The system could simply stop working due to age.
4. A compliance inspection is not meant to be a test of the longevity of the septic system. The inspection is strictly for the purpose of determining if the septic is polluting the environment at the date and time the inspection is performed. The inspection is not intended to determine if the system was originally designed or installed to past or present MPCA or local unit of government code requirements.
5. Winter Work – Client understands that inspections conducted in winter weather conditions are more difficult to perform due to snow cover and frost. Septic system components like tanks, tank covers, drop boxes and soil treatment areas are more difficult to locate in these conditions. Soil borings and drain field locations are also more difficult to perform due to ground frost. The client needs to understand that due to the weather conditions, the same level of standards may not be possible compared to an inspection during the spring/summer/fall months.
6. If hired to perform the compliance inspection, the client hereby agrees that SS Septic Solutions, LLC will not be responsible for any monetary damages, claims or causes of action including attorney fees arising from the performance of this inspection.
7. Nothing other than gray water (laundry, showers, etc.) human waste and toilet tissue should be disposed of into the septic tanks. Garbage disposals are not recommended. Smaller amounts of laundry, soaps, dish soap, cleaning agents, etc. are better for the system. Antibacterial soaps and chlorine agents may kill the bacteria needed to treat effluent properly. Additives are not recommended and may be harmful to your system. Recommend to pump and clean your tanks by a certified pumper every other year if you have 1 tank and every 2-3 years if you have a 2-tank system to ensure proper maintenance.