

**WASHINGTON COUNTY, MINNESOTA**Department of Public Health
and Environment 651/430-6688

PERMIT NUMBER 000901037 SEWAGE PERMIT

OWNER : JEFF HILGER
10675 110TH ST N
STILLWATER MN 55062
Applicant : JEFF HILGER 651-449-7622

INDIVIDUAL SOIL REVIEW FEE	25.00
NEW DEACTIVATED PERMIT	150.00
SEPTIC APPLICATION/SOIL REVIEW	40.00
Total Fees :	215.00
Total Paid :	215.00
Total Due :	0.00

PERMISSION IS HEREBY GRANTED

To execute the work specified in this permit on the following described property upon express condition that said persons and their agents, employees and workmen shall conform in all respects to the provisions of the Building Code, and/or Ordinances.

This permit may be revoked at any time upon the violation of any of the provisions of said code and ordinances.

Project Address :	12361 ROBERTS AVE CT D	STILLWATER	MN	55062	
Legal Description:	S21/4	3451.0	PIECE 5 OF BL. 1 & 2		Geo : 34-01-20-3-001
Flow Capacity	1.0 Gal/Day	Tank Volume	2000		
Soil Conditions:	Depth to Restriction	96 inches	Per. Rate	16 Min/Inch	

Soil Treatment Type:

Bottom Area 1000 Eock Depth 12

Authorized Work / Special Conditions

- Install individual sewage treatment system as per approved design in area tested and shown on site plan.
- Permit revised to include small system for stable.

Permit Expiration Date : Sewage Treatment : 2002-07-16

A CERTIFICATE OF OCCUPANCY MUST BE REQUESTED AND ISSUED PRIOR TO USE OR OCCUPANCY OF WORK PERMITTED BY A BUILDING PERMIT.

This permit shall expire and be null and void if the work authorized by the Building Permit is not commenced within 60 days of the date of issuance or if work is abandoned or suspended for a period of 120 days. Term of the Building Permit is 12 months from date of issue. Term of sewage treatment permit is 12 months from date of issue.

Penalty for violation of any of the provisions of building code: Fine not to exceed five hundred dollars (\$500.00) or imprisonment for not more than ninety (90) days, or both.

Permit Issue Date 2001-07-16 Code Enforcement Officer

T. Gauszel

000901037

INSPECTION RECORD

BUILDING	DATE	INSP.	COMMENTS
Foundation.....			
Foundation Wall.....			
Plumbing (Groundwork).....			
Heating (Groundwork).....			
Rough Plumbing.....			
Rough Gas Piping.....			
Rough Heating and Ventilation.....			
Framing.....			
Insulation.....			
Fireplace.....			
Chimney.....			
Wallboard or Lath and Plaster.....			
Final Electrical.....			
Final Plumbing.....			
Final Gas Piping.....			
Final Heating and Ventilation.....			
Final Building.....			

SEWAGE TREATMENT SYSTEM	DATE	INSP.	COMMENTS
Installation.....	10-23-01 12-17-01	P. Gault P. Gault	Tank Size: 2-1000 Treatment Area: 1000 ft ²
As Built.....			Installer: Rick Fuhn

DRIVEWAY	DATE	INSP.	COMMENTS
Access.....			
Installation.....			

NOTES:

12-17-01 stable system installed
 single 60' trench
 w/1000 gallon septic tank
 P. Gault

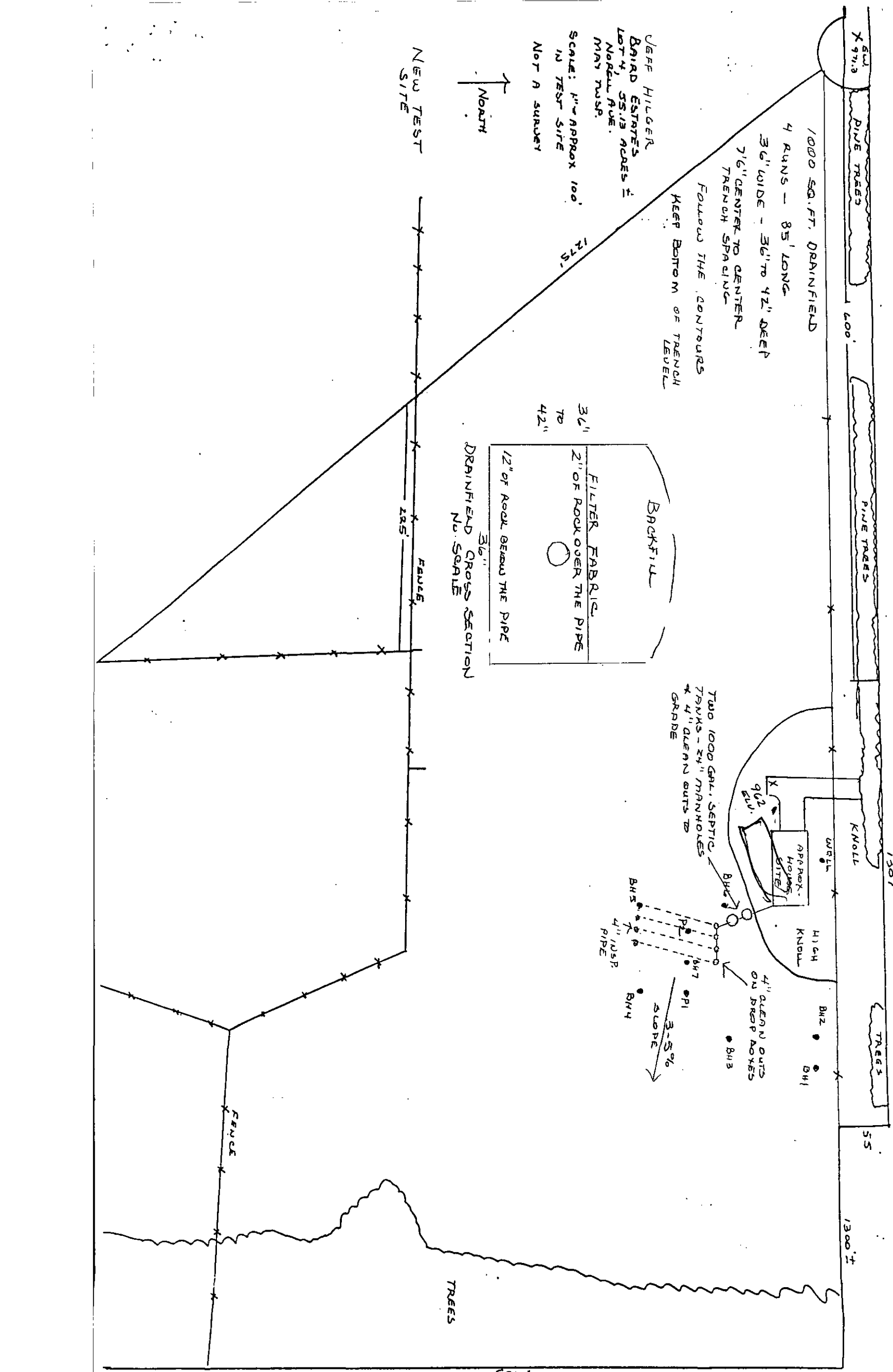

JEFF HILGER
 BRAD ESTATES
 LOT 4, 55.13 ACRES ±
 NORBELL AVE.
 MAY TWP.
 SCALE: 1" = APPROX 100'
 IN TEST SITE
 NOT A SURVEY

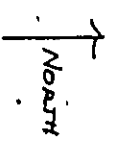

NEW TEST
 SITE

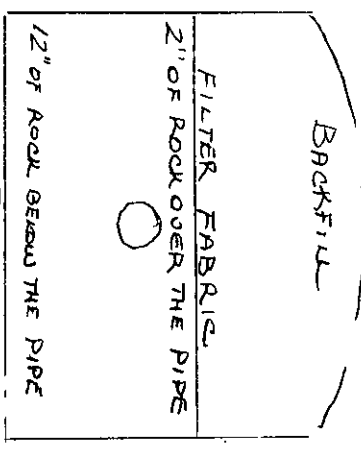

DRAINFIELD CROSS SECTION
 NO SCALE

TWO 1000 GAL. SEPTIC
 TANKS - 24" MANHOLES
 * 4" GLENN OUTS TO
 GRADE

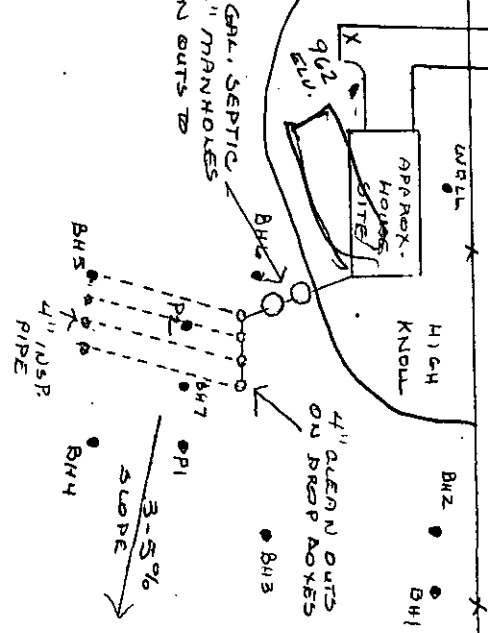

3-5%
 SLOPE

EKLIN SOIL TESTING AND INSPECTIONS, INC.

1986 Ridgewood Avenue
White Bear Lake, MN 55110
1-6 429-1090

Owner's Name	JEFF HILGER		
Job Site Address	LOT 4 BAIRD ESTATES	NORRILL AVE	
City or Township	MAY TOWNSHIP		
Use of Building	HOME - 3 BEDROOMS		

Design Flow Rate	150 GALLONS PER MIN +	Perc Rate	16.24 MPI	Land Slope	3-5	Percent	
Two Required Tank Sizes	1000 Gallons	1000 Gallons	Lift Station Tank Size	Gallons			
Type of System (standard, at grade or bed)	STANDARD						
System Size:	1000	-Square Feet	334	-Lineal Feet	36"	-Trench Width	
Depth of rock below pipe	12"		Depth of Rock Above Pipe	2"			
MINimum Depth of Trench From Existing Grade	36		Inches	MAXimum Depth of Trench From Existing Grade	42		Inches
Recommended Number of Trenches	4		Recommended Length of Trenches	80-85			
Trench Spacing Measured Center to Center				7		Feet	
Any Other Special Conditions	SEPTIC TANK LOCATION CAN VARY						

This system has been designed by a Pollution Control Agency (PCA) Certified Professional.			
Designer Name	DALE EKLIN	PCA Certification #	695
Address	1986 RIDGEWOOD AVE	Phone #	429-1090
Signature		Date	6-28-2001



RECEIVED
JUL 05 2001

Washington County Public Health & Environment

4949 62nd Street N, PO Box 3803
 Stillwater, MN 55082-3803
 651/430-6688 FAX 651/430-6730

Paid \$ Ad \$355⁰⁰

Make checks payable to **WASHINGTON COUNTY HELM** 34-031-20-32-0001

Receipt # 40501

- \$180 - New Home Drainsfield
- \$ 80 - Replace Existing System with a Drainsfield System
- \$300 - New Home Mound
- \$200 - Replace Existing System with a Mound System
- \$300 - Alternative/Experimental System
- \$175 - Individual Lot
- \$125 - Subdivision Soil/Site Review - Base fee Plus \$50/lot
- \$ 25 - Additional Review Fee (1 hour minimum)
- \$ 25 - Renewal of Previous Permit Fee

0009-010.35

Legal Description and Parcel Identification Number (especially if this is for a NEW SUBDIVISION OR MINOR SUBDIVISION) Soc TW
LOT A 5 BARDS ESTATES NORELL AVE MAY TUSA RA

Applicant JEFF HILGER Address 10675 110TH ST. N. City STILLWATER State MINN Zip 55082 Phone _____

Owner (if different from applicant) _____ Address _____ City _____ State _____ Zip _____ Phone 651-439-7622

New Home Existing Home New Business Existing Business Number Of Bedrooms: 3 Gallons Per Day: 450

Check the following fixture(s) which are or will be installed: Garbage Disposal _____ Recreational Bathing Facility: (jacuzzi, hot tub, etc.) _____

New Home ⇒ Drainsfield System Mound System Alternate/Experimental System Existing Permit Renewal Tank Replacement Only

Existing Home Replacement System ⇒ Drainsfield System Mound System

Site Approval Only If this site has been previously approved, attach copy of approval letter _____ Additional Soil Test Data for Previously Approved Site

The following exhibits are required as part of this application and shall be attached hereto: Percolation Test Reports; Soil Boring Logs; Site Plan drawn to scale showing location of buildings, lot lines, percolation test holes, soil boring holes, proposed location of system and well; one (1) copy of the System Design; and one (1) copy of the Final Building Plan. The house and the drainsfield areas must be staked. Inaccurate or incomplete information will result in delays in processing.

AGREEMENT: The undersigned hereby makes Application for Permit to Install or Extend Sewage Treatment System herein specified, agreeing that all such work shall be done in strict accordance with ordinances and regulations of the County of Washington, Minnesota. Applicant agrees that the Site Plan, Sketches and Design submitted herewith, and which are reviewed by Washington County, together with any requirement and/or restriction made necessary by conditions peculiar to a particular location, shall become a part of the permit. Applicant further agrees to provide access, at reasonable times, to Washington County for the purpose of performing inspections required and that no part of the system shall be covered until it has been inspected and accepted. **APPLICATION IS FOR AN INSTALLATION AT A SPECIFIC LOCATION; ANY DEVIATION FROM THE APPROVED LOCATION WILL VOID THE PERMIT.** It shall be the responsibility of the applicant for the permit to notify the Office of the Washington County Dept. of Public Health & Environment that the installation is ready for inspection.

I hereby certify the above to be true and correct. In connection with your request for a soil review/septic permit, I hereby give Washington County Department of Public Health and Environment permission to enter upon my property during normal business hours for the purpose of determining the suitability of the location, design, and construction, which may include minor excavation or soil borings by the Department.

Signature of Applicant (Owner or Contractor) _____ Date 7.5.01

THE AREA BELOW IS FOR COUNTY USE ONLY

SITE EVALUATION: BY INSPECTOR P. Cozart DATE 7-9-01

SETBACKS:

	REQUIRED (CIRCLE APPROPRIATE ITEM(S))					ACTUAL
Well (including adjacent property)	50'	75'	100'	150'		
Wetland, Pond, Lake, Stream, River, or Bluffline	20'	40'	75'	100'	150'	

CONCLUSIONS: Site Suitable: Site Unsuitable: Additional Tests Required: Verify Use: _____ Bedrooms _____

NOTES: Lot Size _____ Year Built _____

New plat no addresses yet

JOB JEFF HILGER
LOT 4, BAIRD ESTATES
MAY TWP

BORING LOG

Page 1 of 2

DATE 6-25-01

BOREHOLE DIAMETER 4" 3/8" 2 1/8" HAND BUCKER

DEPTH FEET	HOLE #1	HOLE #2	HOLE #3	HOLE #4	HOLE #5	HOLE #6
1	TOP SOIL	TOP SOIL	TOP SOIL	TOP SOIL	TOP SOIL	TOP SOIL
	YELLOWISH BROWN LOAM	YELLOWISH BROWN LOAM	YELLOWISH BROWN LOAM	YELLOWISH BROWN LOAM	YELLOWISH BROWN LOAM	YELLOWISH BROWN LOAM
2				LIGHT BROWN MEDIUM SAND		LIGHT BROWN, MEDIUM SAND
3	YELLOWISH BROWN LOAM	YELLOWISH BROWN LOAM	BROWN, SANDY LOAM		LIGHT BROWN MEDIUM SAND	
4	MOTTLED SOIL	MOTTLED SOIL	LIGHT BROWN MEDIUM SAND			
5	STOP	STOP				
6						
7	MOTTLE 36"	MOTTLE 36"	STOP	STOP	STOP	STOP
8			OKAY 6'6" SANDY 34"	OKAY 6'6" SAND 18"	OKAY 6'6" SAND 30"	OKAY 6'6" SAND 24"
9						
10						

JOB JEFF HIGGER
LOT 4, BAIRD ESTATES
ORAY TWP

BORING LOG

DATE 6-25-01

BOREHOLE DIAMETER 4" 3/8" 2 1/8" HAND AUGER

DEPTH FEET	HOLE # 7	HOLE # 2	SOIL CLASSIFICATION	HOLE #	HOLE #	HOLE #
1	TOP SOIL		Yellowish Brown LOAM			
2	YELLOWISH BROWN LOAM		Brown LOAM 7.5YR 4/4			
3	LIGHT BROWN, MEDIUM SAND		Light Brown SAND 7.5YR 6/3			
4						
5						
6	BROWN, SANDY LOAM					
7	STOP					
8	OKAY 6'6"					
9						
10						

PERCOLATION DATA

BOREHOLE # 1 JOB JEFF HILGER
 BOREHOLE DEPTH 42" LOT 4, BIRD ESTATES
 BOREHOLE DIAMETER 6" DATE 6-25-01 SIGNED MAY TUSP.
 BOREHOLE # 2 BOREHOLE DEPTH 36"
 BOREHOLE DIAMETER 6"

DEPTH	SOIL DESCRIPTION
0-12"	TOP SOIL
12"-36"	YELLOWISH BROWN LOAM
36"-42"	BROWN, SANDY LOAM

DEPTH	SOIL DESCRIPTION
0-12"	TOP SOIL
12"-36"	YELLOWISH BROWN LOAM

TIME	READING MEASUREMENT	DROP	COMMENTS
9:20	36"		FILL
9:50	38 1/8"	2 1/8"	14.1 MPI
9:50	36"		FILL
10:20	38"	2"	15 MPI
10:20	36"		FILL
10:50	37 7/8"	1 7/8"	16 MPI
10:50	36"		FILL
11:20	37 7/8"	1 7/8"	16 MPI

TIME	READING MEASUREMENT	DROP	COMMENTS
9:30	30"		FILL
10:00	31 3/8"	1 3/8"	21.8 MPI
10:00	30"		FILL
10:30	31 1/8"	1 1/8"	26.7 MPI
10:30	30"		FILL
11:00	31 1/4"	1 1/4"	24 MPI
11:00	30"		FILL
11:30	31 1/8"	1 1/8"	26.7 MPI

Best Copy Available

SEPF HILGER
12361 NARREN AVE
COURT NORTH
MAY TOWN SHIP

SCALE 1" = APPROX 40'
IN STABLE & DRAIN FIELD
TRENCH

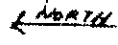

WELL 150' ± FROM
THE STABLE SEPTIC
SYSTEM

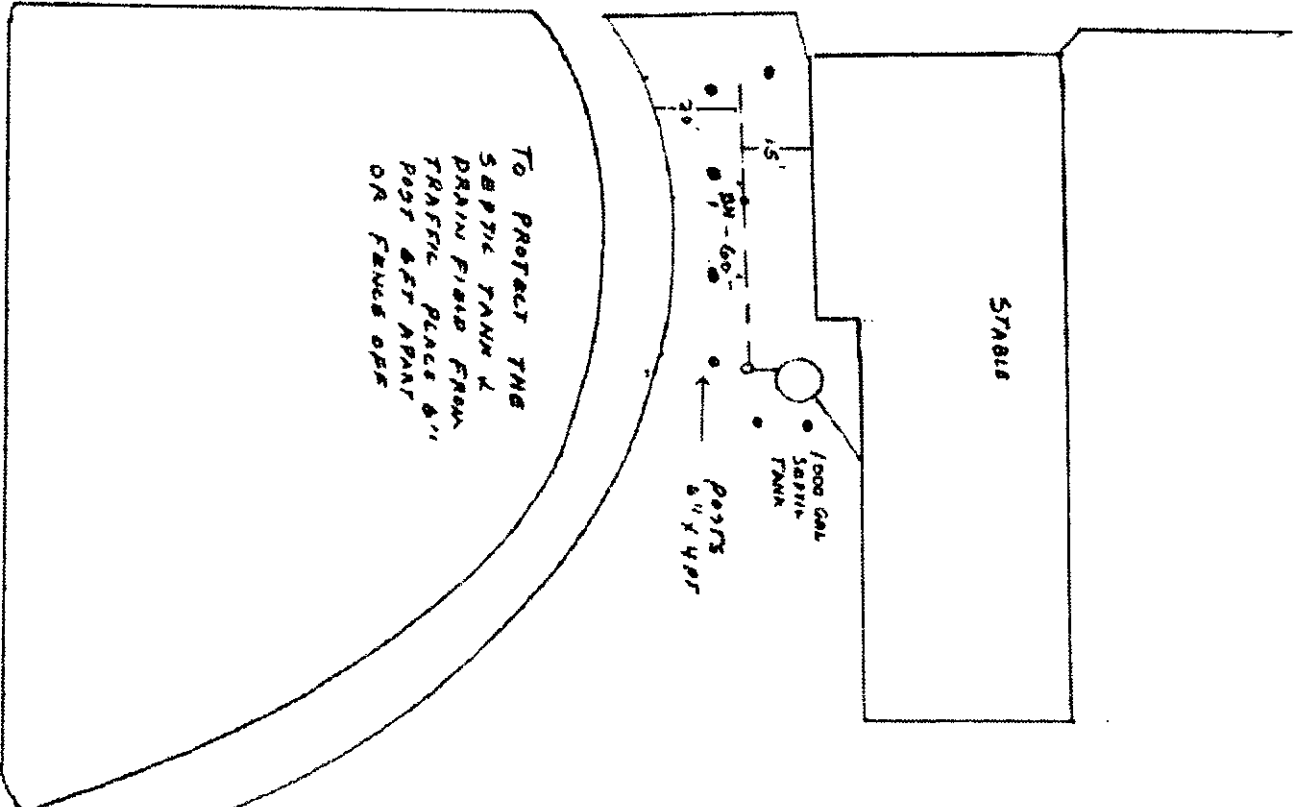
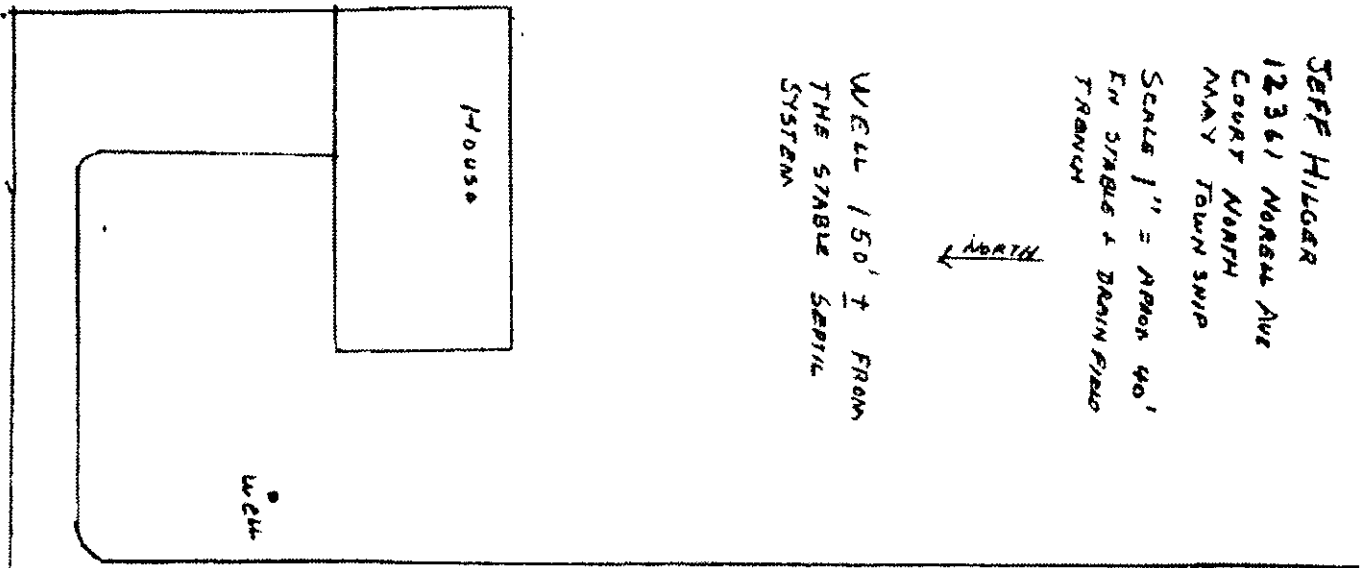

TO PROTECT THE
SEPTIC TANK &
DRAIN FIELD FROM
TRAFFIC PLACE 8"
POST 8" x 4" OR
FENCE OFF

DRIVEWAY

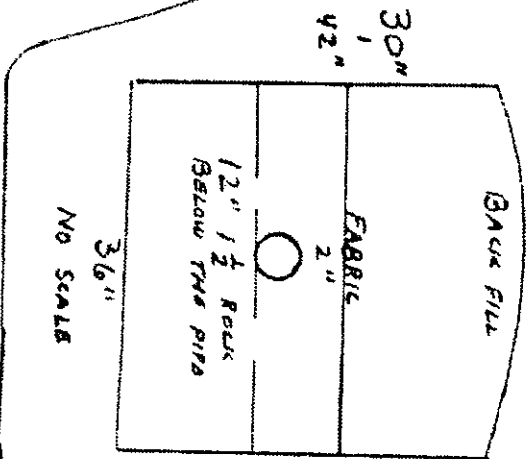

- 1- 1000 GAL SEPTIC TANK WITH 24" MAN HOLE & 4" CLEAN OUTS TO GRADE
- 2- 1- 60 FT TRENCH
- 3- 36" WIDE 36" 42" DEEP
- 4- 180 59 FT

30" 42" 36"

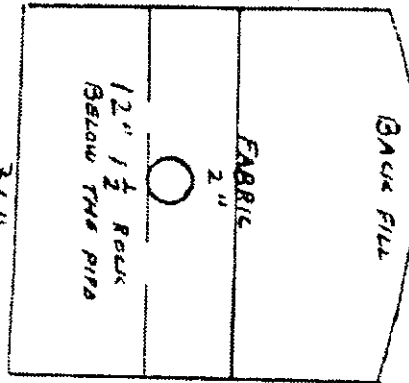

NO SCALE

EKLIN SOIL TESTING AND INSPECTIONS, INC.

1986 Ridgewood Avenue
White Bear Lake, MN 55110
1-651-429-1090

Owner's Name	JEFF HILGER
Job Site Address	12361 NORRALL AVE CT. N.
City or Township	MAY TOWNSHIP
Use of Building	STABLE - SINK - TOILET

Design Flow Rate	150 GAL +-	Pipe Rate	4-5 MPI	Land Slope	LEVEL	Percent
Two Required Tank Sizes	1000 Gallons	Gallons		Lift Station Tank Size		Gallons
Type of System (standard, at grade or bed)	STANDARD					
System Size:	180	-Square Feet	60	-Linear Feet	36"	-Trench Width
Depth of rock below pipe	12"		Depth of Rock Above Pipe	2"		
Minimum Depth of Trench From Existing Grade	30		Inches	MAXimum Depth of Trench From Existing Grade	42	
Recommended Number of Trenches	1		Recommended Length of Trenches	60 FT		
Trench Spacing Measured Center to Center						Feet
Any Other Special Conditions	PLACE 6" DIA POSTS 4 FT HIGH 6 FT APART AROUND THE SEPTIC TANK & DRAIN FIELD OF FENCE - THIS WILL KEEP THE TRAFFIC OFF OF THE SEPTIC SYSTEM					

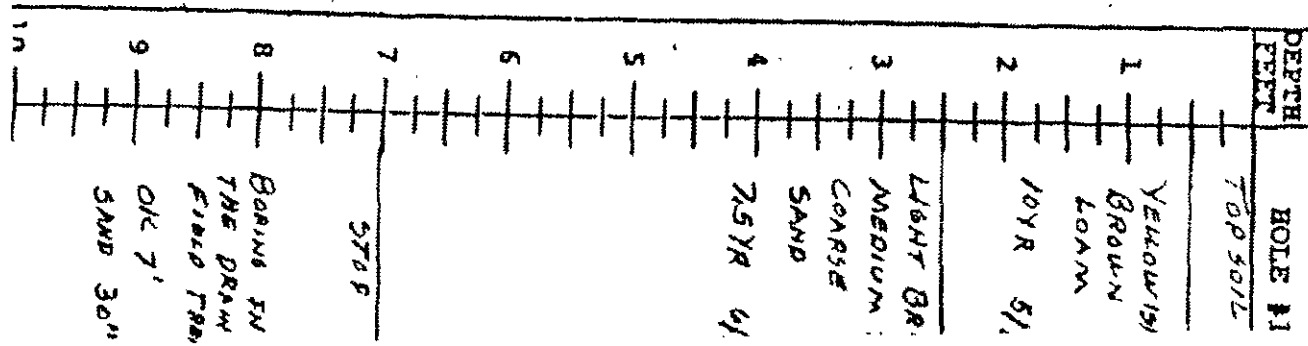

JOB JEFF HILGER

12361 NORRALL AVE
MAY TOWN
DATE 12-14-01



AS-BUILT REPORT INDIVIDUAL SEWAGE TREATMENT SYSTEM

Washington County Health, Environment & Land Management
14900 61ST ST N, PO BOX 3803, STILLWATER, MN 55082-3803
612/430-6708 or 612/430-6656 FAX 612/430-6730

RECEIVED

FEB 22 2002

HELM

Legal Description or Complete Street Address		City or Township	
Owner Name	Mail Address	City	State Zip
Jeff Hilger 12361 Norell Ave. Ct. N. Stillwater, MN 55082			
Installer	Mail Address	City	State Zip
Fuhr Trenching 12539 Manning Ave. N. Hugo, MN 55038			
Septic Tank Information		Liquid Capacity:	
Tank Manufacturer: MN Precast Ind. Inc.		2-1000 gal.	

PUMP CHAMBER (if installed) Not used			
Tank Manufacturer:	Liquid Capacity:	Horsepower of Pump:	Type of Warning Device:
Pump Discharge in Gallons Per Minute: Head	at	Feet of	Number of Gallons Pumped Per Cycle:

DRAINFIELD TRENCH		BED OR MOUND		
Width:	Length of Each Trench:	Rock Bed Length:	Width:	Area:
36"	5 lines @ 67ft.			
Depth of Trench Bottom from Finished Grade:		Bed Depth from Grade:		
36"				
Method of Distribution:		MOUND:		
<input type="checkbox"/> Pressure <input type="checkbox"/> Distribution Box <input checked="" type="checkbox"/> Drop Box		Upslope Sand Base Depth: Downslope Sand Base Depth:		
Depth of Rock Under Distribution Pipe:		Depth of Rock Under Pipe:		
12"				
Square Footage of Tested Area Used:		PRESSURE DISTRIBUTION SYSTEM:		
2500sq.ft.		Lateral Inside Diameter:	Length:	Perforation Size:
Trench Bottom Square Footage Required:	Area As Built:	Spacing:	Number:	Perforation Spacing:
1000sq.ft.	1000sq.ft.			

Complete site plan on attached sheet. On the site plan, include location of the following items.

Structures, septic tank, pump chamber, line from house to tank treatment system, distribution lines, distribution or drop boxes, well, and driveway. Show all distances applicable to the sewage treatment system (distance from structure to tank, tank to treatment system, distance between distribution lines, length of distribution lines, and distance between well and sewage treatment system). Indicate NORTH on the site plan and the scale of the plan.

I hereby certify that the system at the above referenced address was installed according to the Washington County Individual Sewage Treatment System Ordinance requirements.

Signed: MPCA License #: 775 Dated: 2-20-02

ASBUILT.FRM:DC

WASHINGTON COUNTY SEPTIC PERMIT NUMBER 00090135

