



Minnesota Pollution Control Agency

520 Lafayette Road North
St. Paul, MN 55155-4194

Compliance Inspection Form
Existing Subsurface Sewage Treatment Systems (SSTS)

Doc Type: Compliance and Enforcement

Instructions: Inspection results based on Minnesota Pollution Control Agency (MPCA) requirements and attached forms - additional local requirements may also apply.

Submit completed form to Local Unit of Government (LUG) and system owner within 15 days

For local tracking purposes:

System Status

System status on date (mm/dd/yyyy): 5-26-17

[X] Compliant - Certificate of Compliance
(Valid for 3 years from report date, unless shorter time frame outlined in Local Ordinance.)

[] Noncompliant - Notice of Noncompliance
(See Upgrade Requirements on page 3)

Reason(s) for noncompliance (check all applicable)

- [] Impact on Public Health (Compliance Component #1) - Imminent threat to public health and safety
[] Other Compliance Conditions (Compliance Component #3) - Imminent threat to public health and safety
[] Tank Integrity (Compliance Component #2) - Failing to protect groundwater
[] Other Compliance Condition (Compliance Component #3) - Failing to protect groundwater
[] Soil Separation (Compliance Component #4) - Failing to protect groundwater
[] Operating permit/monitoring plan requirements (Compliance Component #5) - Noncompliant

Property Information

Parcel ID# or Sec/Twp/Range:

Property address: 2867 Lisbon Ave

Reason for inspection: Property Transfer

Property owner: Scott Strand

Owner's phone: 651-271-7732

Owner's representative:

Representative phone:

Local regulatory authority: Washington Co

Regulatory authority phone:

Brief system description: 2 septic tanks, 4 trenches @ 100' ea.

Comments or recommendations:

Certification

I hereby certify that all the necessary information has been gathered to determine the compliance status of this system. No determination of future system performance has been nor can be made due to unknown conditions during system construction, possible abuse of the system, inadequate maintenance, or future water usage.

Inspector name: Larry Christiansen

Certification number: C-674

Business name: Scandia Compliance Insp LLC

License number: L-3911

Inspector signature: Larry Christiansen

Phone number: 651-333-0281

Necessary or Locally Required Attachments

- [X] Soil boring logs
[X] System/As-built drawing
[] Forms per local ordinance
[] Other information (list):

1. Impact on Public Health – Compliance component #1 of 5

Compliance criteria:

System discharge sewage to the ground surface.	<input type="checkbox"/> Yes <input checked="" type="checkbox"/> No
System discharge sewage to drain tile or surface waters.	<input type="checkbox"/> Yes <input checked="" type="checkbox"/> No
System cause sewage backup into dwelling or establishment.	<input type="checkbox"/> Yes <input checked="" type="checkbox"/> No

Any "yes" answer above indicates the system is an Imminent Threat to Public Health and Safety.

- Verification method(s):**
- Searched for surface outlet
 - Searched for seeping in yard/backup in home
 - Excessive ponding in soil system/D-boxes
 - Homeowner testimony (See Comments/Explanation)
 - "Black soil" above soil dispersal system
 - System requires "emergency" pumping
 - Performed dye test
 - Unable to verify (See Comments/Explanation)
 - Other methods not listed (See Comments/Explanation)

Comments/Explanation:

2. Tank Integrity – Compliance component #2 of 5

Compliance criteria:

System consists of a seepage pit, cesspool, drywell, or leaching pit. <i>Seepage pits meeting 7080.2550 may be compliant if allowed in local ordinance.</i>	<input type="checkbox"/> Yes <input checked="" type="checkbox"/> No
Sewage tank(s) leak below their designed operating depth. If yes, which sewage tank(s) leaks:	<input type="checkbox"/> Yes <input checked="" type="checkbox"/> No

Any "yes" answer above indicates the system is Failing to Protect Groundwater.

- Verification method(s):**
- Probed tank(s) bottom
 - Examined construction records
 - Examined Tank Integrity Form (Attach)
 - Observed liquid level below operating depth ^{AT}
 - Examined empty (pumped) tanks(s)
 - Probed outside tank(s) for "black soil"
 - Unable to verify (See Comments/Explanation)
 - Other methods not listed (See Comments/Explanation)

Comments/Explanation:

3. Other Compliance Conditions – Compliance component #3 of 5

- a. Maintenance hole covers are damaged, cracked, unsecured, or appear to structurally unsound. Yes* No Unknown
- b. Other issues (electrical hazards, etc.) to immediately and adversely impact public health or safety. Yes* No Unknown
***System is an imminent threat to public health and safety**

Explain:

- c. System is non-protective of ground water for other conditions as determined by inspector Yes* No
***System is failing to protect groundwater**

Explain:

4. Soil Separation – Compliance component #4 of 5

Date of installation: 1999 Unknown
 Shoreland/Wellhead protection/Food Beverage Lodging? Yes No

Verification method(s):
 Soil observation does not expire. Previous soil observations by two independent parties are sufficient, unless site conditions have been altered or local requirements differ.

<p>Compliance criteria:</p> <p>For systems built prior to April 1, 1996, and not located in Shoreland or Wellhead Protection Area or not serving a food, beverage or lodging establishment:</p> <p>Drainfield has at least a two-foot vertical separation distance from periodically saturated soil or bedrock.</p>	<input type="checkbox"/> Yes <input type="checkbox"/> No
<p>Non-performance systems built April 1, 1996, or later or for non-performance systems located in Shoreland or Wellhead Protection Areas or serving a food, beverage, or lodging establishment:</p> <p>Drainfield has a three-foot vertical separation distance from periodically saturated soil or bedrock.*</p>	<input checked="" type="checkbox"/> Yes <input type="checkbox"/> No
<p>"Experimental", "Other", or "Performance" systems built under pre-2008 Rules; Type IV or V systems built under 2008 Rules (7080, 2350 or 7080.2400 (Advanced Inspector License required)</p> <p>Drainfield meets the designed vertical separation distance from periodically saturated soil or bedrock.</p>	<input type="checkbox"/> Yes <input type="checkbox"/> No

- Conducted soil observation(s) (Attach boring logs)
- Two previous verifications (Attach boring logs)
- Not applicable (Holding tank(s), no drainfield)
- Unable to verify (See Comments/Explanation)
- Other (See Comments/Explanation)

Comments/Explanation:

Indicate depths of elevations

A. Bottom of distribution media	<u>36"</u>
B. Periodically saturated soil/bedrock	<u>—</u>
C. System separation	<u>3'</u>
D. Required compliance separation*	<u>3'</u>

*May be reduced up to 15 percent if allowed by Local Ordinance.

Any "no" answer above indicates the system is Failing to Protect Groundwater.

5. Operating Permit and Nitrogen BMP* – Compliance component #5 of 5 Not applicable

Is the system operated under an Operating Permit? Yes No If "yes", A below is required
 Is the system required to employ a Nitrogen BMP? Yes No If "yes", B below is required

BMP=Best Management Practice(s) specified in the system design

If the answer to both questions is "no", this section does not need to be completed.

Compliance criteria

a. Operating Permit number: _____ Have the Operating Permit requirements been met?	<input type="checkbox"/> Yes <input type="checkbox"/> No
b. Is the required nitrogen BMP in place and properly functioning?	<input type="checkbox"/> Yes <input type="checkbox"/> No

Any "no" answer indicates Noncompliance.

Upgrade Requirements (Minn. Stat. § 115.55) An imminent threat to public health and safety (ITPHS) must be upgraded, replaced, or its use discontinued within ten months of receipt of this notice or within a shorter period if required by local ordinance. If the system is failing to protect ground water, the system must be upgraded, replaced, or its use discontinued within the time required by local ordinance. If an existing system is not failing as defined in law, and has at least two feet of design soil separation, then the system need not be upgraded, repaired, replaced, or its use discontinued, notwithstanding any local ordinance that is more strict. This provision does not apply to systems in shoreland areas, Wellhead Protection Areas, or those used in connection with food, beverage, and lodging establishments as defined in law.

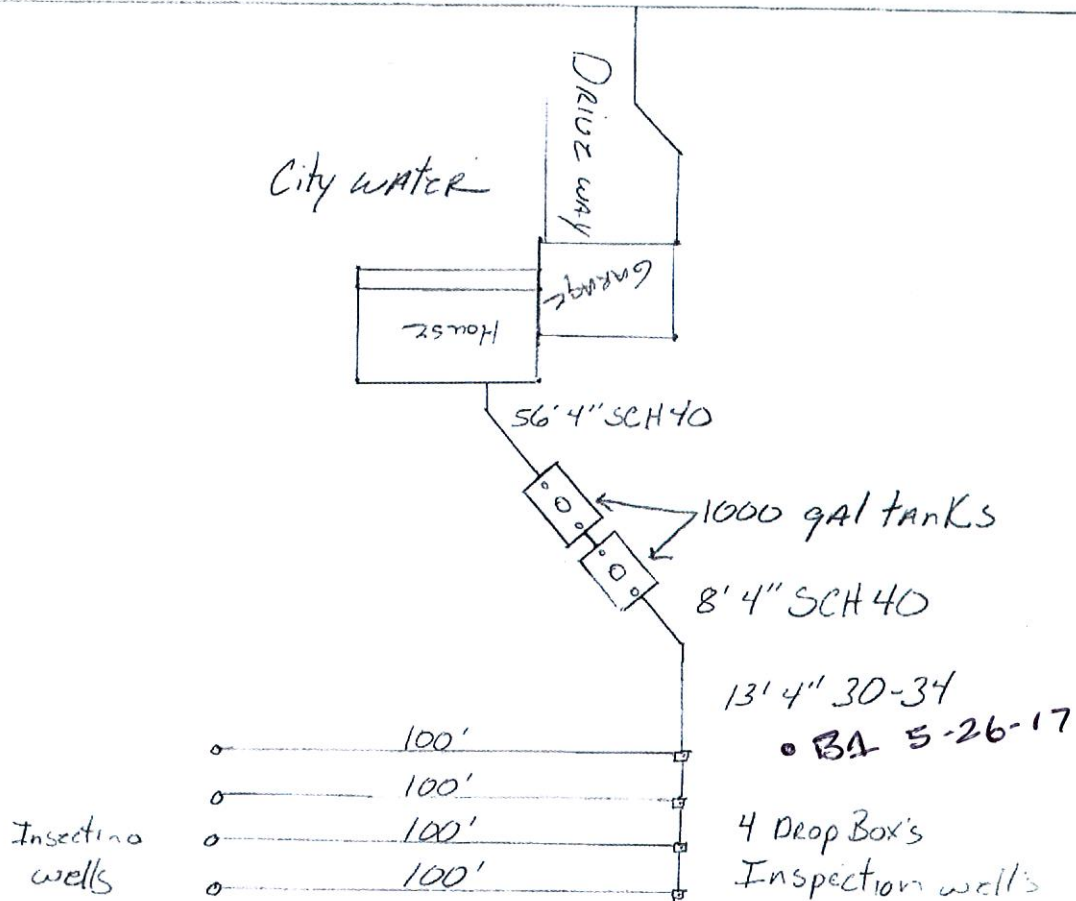

2-1000 gal tanks
1200 sq ft DRAIN field

2867 LISBOW AV. C.T.
Lot 6 Block 2
HERITAGE FARM
WASHINGTON COUNTY

5-26-17
Bl. SOIL boring
0-12 Clay Loam 10yr 3/3
12-23 Clay Loam 10yr 3/4
33-42" Fine sand 10yr 4/4
42-60 Fine to med sand 10yr 4/4
60-66" med to coarse sand 11/4
66-72" Fine sand 11

rec'd 7-7-99

City of Lake Elmo

3800 Lake Elmo Avenue N
 Lake Elmo MN 55042
 Telephone (651)777-5510 Facsimile (651)777-9615

Building Permit Fee	\$0.00
Surcharge	\$0.00
Plan Review	\$0.00
Investigation	\$0.00
Other	\$0.00
SAC Fee	\$0.00
Sewer Fee	\$0.00
WAC Fee	\$0.00
Plumbing Fee	\$75.00
Surcharge	\$0.50
HVAC Fee	\$0.00
Surcharge	\$0.00
Fire Suppression Fee	\$0.00
Surcharge	\$0.00
Water Meter	\$0.00
SalesTax	\$0.00
Total Fee	\$75.50
Previous Payment	\$75.50
Balance Due	\$0.00

Plumbing Permit

Permit Number 275

PERMISSION IS HEREBY GRANTED

To carry out the work specified in this permit on the following described property. Upon the express condition that said persons and their agents, employees and workmen, in such work done, shall conform in all respects to the provisions of the Minnesota State Building Code and local ordinances. This permit may be revoked at any time upon the violation of any of the provisions of said code.

Owner	Jack Krongard (651) 430-2314	Address	same MN
Contractor	Vanderhoff Excavating (651) 777-2422	Address	2389 Geneva Ave Oakdale MN 55128

Project Address	2867 Lisbon Ave Ct
Legal Description	
Property Identification Number	
Geographic Code	
Zoning District	OP
Valuation of Work	3,500

Authorized Work/Special Conditions: Install Septic per approved plans and local codes.

This Permit Is Issued: July 1, 1999

This Permit Expires: June 30, 2000

This permit shall expire and be null and void if the work authorized by this permit is not commenced within 60 days of the date of issuance or if work is abandoned or suspended for a period of 120 days. A violation of a provision of this Code is a misdemeanor (Minnesota Statutes, Section 16B.69.)

White - Applicant
 Canary - Municipality
 Pink - Assessor

copy

 BUILDING OFFICIAL / AUTHORIZED AGENT

Permit Application

City of Lake Elmo
3800 Laverne Ave.
Lake Elmo, MN 55042
651-777-5510 Fax 651-777-9615

Office Use Only
Permit # Issued 275

Parcel Information

Address 2867 Lisbon Ave Parcel ID # _____
Legal Description Lot _____ Blk _____

Owner Information

Owner JACK Krongaard Construction Phone 651-430-2314
First name Last name

Project Information

Construction () HVAC () Plumbing () Septic (X) Other ()

Project Description Single Family Home (e.g. new home alter plumbing, install new heating, remodel kitchen)

Contractor Vanderhoff KRONGAARD Address 2389 Geneva Ave
14791 60th St N 55128
Stillwater Mn 55082
City State Zip
OAKDALE

State Lic. # _____ Phone - - - - - Fax _____ Cellular _____

Valuation \$ 35000

DESCRIPTION OF WORK TO BE DONE

Install septic (new)

Dimensions: _____ x _____ = _____
length width sq. ft.

The applicant hereby agrees to do all work in accordance with the Ordinances of the City of Lake Elmo and the State Building Code. In connection with your application for a permit, your signature constitutes permission for a representative of the City of Lake Elmo to enter upon said property for the purposes of project evaluation and code compliance.

Richard Vanderhoff
Signature of Applicant

7-1-99
Date

Fee used from depl permit 99-159