



Minnesota Pollution Control Agency

520 Lafayette Road North
St. Paul, MN 55155-4194

Compliance Inspection Form
Existing Subsurface Sewage Treatment Systems (SSTS)

Doc Type: Compliance and Enforcement

Inspection results based on Minnesota Pollution Control Agency (MPCA) requirements and attached forms - additional local requirements may also apply.

Submit completed form to Local Unit of Government (LUG) and system owner within 15 days

For local tracking purposes:

System Status

System status on date (mm/dd/yyyy): 6/22/2017

[X] Compliant - Certificate of Compliance
(Valid for 3 years from report date, unless shorter time frame outlined in Local Ordinance.)

[] Noncompliant - Notice of Noncompliance
(See Upgrade Requirements on page 3.)

Reason(s) for noncompliance (check all applicable)

- [] Impact on Public Health (Compliance Component #1) - Imminent threat to public health and safety
[] Other Compliance Conditions (Compliance Component #3) - Imminent threat to public health and safety
[] Tank Integrity (Compliance Component #2) - Failing to protect groundwater
[] Other Compliance Conditions (Compliance Component #3) - Failing to protect groundwater
[] Soil Separation (Compliance Component #4) - Failing to protect groundwater
[] Operating permit/monitoring plan requirements (Compliance Component #5) - Noncompliant

Property Information

Parcel ID# or Sec/Twp/Range: 3602721110001

Property address: 11055 Panama Av. S., Hastings, Mn. 55033

Reason for inspection: Property Transfer

Property owner: Richard and Marijo McCarthy

Owner's phone: 651-428-3868

Owner's representative:

Representative phone:

Local regulatory authority: Washington County

Regulatory authority phone: 651-430-6655

Brief system description: 2-1000 gal. precast septic tanks and 480 lin. ft. trench with 10" SB2 pipe.

Comments or recommendations:

Certification

I hereby certify that all the necessary information has been gathered to determine the compliance status of this system. No determination of future system performance has been nor can be made due to unknown conditions during system construction, possible abuse of the system, inadequate maintenance, or future water usage.

Inspector name: Roger Benson

Certification number: 1505

Business name: Benson Septic Service

License number: 190

Inspector signature: [Handwritten Signature]

Phone number: 651-325-6555

Necessary or Locally Required Attachments

- [X] Soil boring logs [X] System/As-built drawing [] Forms per local ordinance
[X] Other information (list): Approved inspection. All records on file at Washington Co.

1. Impact on Public Health – Compliance component #1 of 5

Compliance criteria:

System discharges sewage to the ground surface.	<input type="checkbox"/> Yes <input checked="" type="checkbox"/> No
System discharges sewage to drain tile or surface waters.	<input type="checkbox"/> Yes <input checked="" type="checkbox"/> No
System causes sewage backup into dwelling or establishment.	<input type="checkbox"/> Yes <input checked="" type="checkbox"/> No

Any "yes" answer above indicates the system is an imminent threat to public health and safety.

Comments/Explanation:

No excessive ponding. Trench 1 and 2 at normal operating level. Trench 3 being used. Trench 4 and 5 were dry.

Verification method(s):

- Searched for surface outlet
- Searched for seeping in yard/backup in home
- Excessive ponding in soil system/D-boxes
- Homeowner testimony (See Comments/Explanation)
- "Black soil" above soil dispersal system
- System requires "emergency" pumping
- Performed dye test
- Unable to verify (See Comments/Explanation)
- Other methods not listed (See Comments/Explanation)

2. Tank Integrity – Compliance component #2 of 5

Compliance criteria:

System consists of a seepage pit, cesspool, drywell, or leaching pit. <i>Seepage pits meeting 7080.2550 may be compliant if allowed in local ordinance.</i>	<input type="checkbox"/> Yes <input checked="" type="checkbox"/> No
Sewage tank(s) leak below their designed operating depth. If yes, which sewage tank(s) leaks:	<input type="checkbox"/> Yes <input checked="" type="checkbox"/> No

Any "yes" answer above indicates the system is failing to protect groundwater.

Comments/Explanation:

Effluent level in tanks normal. Manholes to grade.

Verification method(s):

- Probed tank(s) bottom
- Examined construction records
- Examined Tank Integrity Form (Attach)
- Observed liquid level below operating depth
- Examined empty (pumped) tanks(s)
- Probed outside tank(s) for "black soil"
- Unable to verify (See Comments/Explanation)
- Other methods not listed (See Comments/Explanation)

3. Other Compliance Conditions – Compliance component #3 of 5

- a. Maintenance hole covers are damaged, cracked, unsecured, or appear to be structurally unsound. Yes* No Unknown
- b. Other issues (electrical hazards, etc.) to immediately and adversely impact public health or safety. Yes* No Unknown
***System is an imminent threat to public health and safety.**

Explain:

- c. System is non-protective of ground water for other conditions as determined by inspector. Yes* No
***System is failing to protect groundwater.**

Explain:

4. Soil Separation – Compliance component #4 of 5

Date of installation: 8/31/1995 Unknown
(mm/dd/yyyy)

Shoreland/Wellhead protection/Food beverage lodging? Yes No

Compliance criteria:

For systems built prior to April 1, 1996, and not located in Shoreland or Wellhead Protection Area or not serving a food, beverage or lodging establishment: Yes No

Drainfield has at least a two-foot vertical separation distance from periodically saturated soil or bedrock.

Non-performance systems built April 1, 1996, or later or for non-performance systems located in Shoreland or Wellhead Protection Areas or serving a food, beverage, or lodging establishment: Yes No

Drainfield has a three-foot vertical separation distance from periodically saturated soil or bedrock.*

"Experimental", "Other", or "Performance" systems built under pre-2008 Rules; Type IV or V systems built under 2008 Rules (7080.2350 or 7080.2400 (Advanced Inspector License required) Yes No

Drainfield meets the designed vertical separation distance from periodically saturated soil or bedrock.

Any "no" answer above indicates the system is failing to protect groundwater.

Verification method(s):

Soil observation does not expire. Previous soil observations by two independent parties are sufficient, unless site conditions have been altered or local requirements differ.

- Conducted soil observation(s) (Attach boring logs)
- Two previous verifications (Attach boring logs)
- Not applicable (Holding tank(s), no drainfield)
- Unable to verify (See Comments/Explanation)
- Other (See Comments/Explanation)

Comments/Explanation:

Original borings by AAA Pollution Control indicate no water table, saturated soil or bedrock to 5.25'. Soils reviewed by Pete Ganzel (Wash. Co.) 11/16/94.

Indicate depths or elevations

A. Bottom of distribution media	36"
B. Periodically saturated soil/bedrock	>60"
C. System separation	>24"
D. Required compliance separation*	24"

*May be reduced up to 15 percent if allowed by Local Ordinance.

5. Operating Permit and Nitrogen BMP* – Compliance component #5 of 5

Not applicable

Is the system operated under an Operating Permit? Yes No If "yes", A below is required

Is the system required to employ a Nitrogen BMP? Yes No If "yes", B below is required

BMP = Best Management Practice(s) specified in the system design

If the answer to both questions is "no", this section does not need to be completed.

Compliance criteria

- a. Operating Permit number: _____
Have the Operating Permit requirements been met? Yes No
- b. Is the required nitrogen BMP in place and properly functioning? Yes No

Any "no" answer indicates Noncompliance.

Upgrade Requirements (Minn. Stat. § 115.55) An imminent threat to public health and safety (ITPHS) must be upgraded, replaced, or its use discontinued within ten months of receipt of this notice or within a shorter period if required by local ordinance. If the system is failing to protect ground water, the system must be upgraded, replaced, or its use discontinued within the time required by local ordinance. If an existing system is not failing as defined in law, and has at least two feet of design soil separation, then the system need not be upgraded, repaired, replaced, or its use discontinued, notwithstanding any local ordinance that is more strict. This provision does not apply to systems in shoreland areas, Wellhead Protection Areas, or those used in connection with food, beverage, and lodging establishments as defined in law.

OCT-17-1995 14:44

VALLEY ENTERPRISES

16124389910 P.01

AS-BUILT REPORT INDIVIDUAL SEWAGE TREATMENT SYSTEM

Washington County Health, Environment & Land Management
14900 61ST ST N, PO BOX 3803, STILLWATER, MN 55082-3803
612/430-6708 or 612/430-6656

Legal Description or Complete Street Address 11055 Panama Av. S		City or Township Denmark Twp	
Owner Name Dick McCarthy	Mail Address 11055 Panama Av	City Hastings	State Mn
Installer Valley Enterprises	Mail Address 18070 218th St E	City Welch	State Mn
Basic Tank Information Tank Manufacturer: A-1 Concrete		Liquid Capacity: 1000-1000	

PUMP CHAMBER (if installed)			
Tank Manufacturer:	Liquid Capacity:	Horsepower of Pump:	Type of Warning Device:
Pump Discharge in Gallons Per Minute: Head	at	Feet of	Number of Gallons Pumped Per Cycle:

DRAINFIELD TRENCH		BED OR MOUND	
Width: 10" SBZ	Length of Each Trench: 100, 100, 100, 80	Rock Bed Length:	Width: Area:
Depth of Trench Bottom from Finished Grade: 36"		Bed Depth from Grade:	
Method of Distribution: <input type="checkbox"/> Pressure <input type="checkbox"/> Distribution Box <input checked="" type="checkbox"/> Drop Box		MOUND: Upslope Sand Base Depth:	Downslope Sand Base Depth:
Depth of Rock Under Distribution Pipe: NA 10" SBZ		Depth of Rock Under Pipe:	
Square Footage of Treated Area Used: 3500		PRESSURE DISTRIBUTION SYSTEM:	
Trench Bottom Square Footage Required: 1440	Area As Built: 1440	Lateral Inside Diameter:	Length: Perforation Size:
		Spacing:	Number: Perforation Spacing:

Complete site plan on attached sheet. On the site plan, include location of structure, septic tank, pump chamber, line from house to tank treatment system, distribution lines, distribution or drop boxes, well, and driveway. Show all distances applicable to the sewage treatment system (distance from structure to tank, tank to treatment system, distance between distribution lines, length of distribution lines, and distance between well and sewage treatment system). Indicate NORTH on the site plan and the scale of the plan.

ASBULT.FRM.DOC 1/95

WASHINGTON COUNTY SEPTIC PERMIT NUMBER 8295038

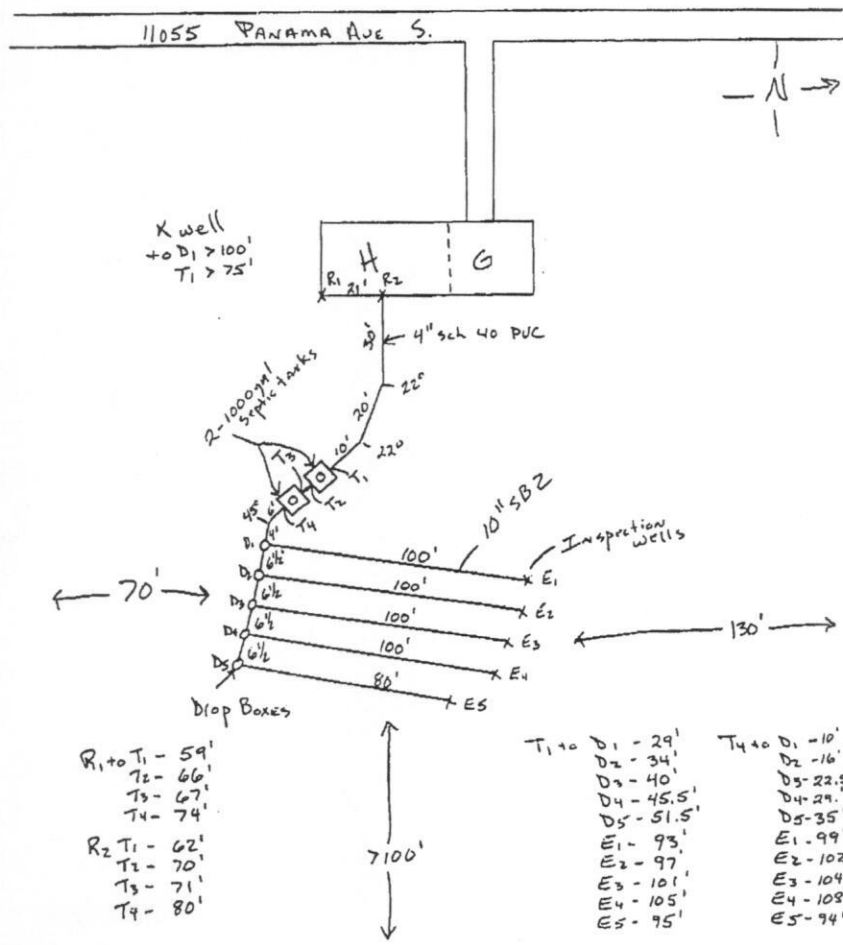



WASHINGTON COUNTY, MINNESOTA
 Department of Health, Environment & Land Management

INSPECTION REQUEST DETAIL

DATE 11/10/94

Requested Date 11/14/94 Requested Time 99:99 Priority 92

Application Number 82 94080

Owner Name RICHARD MCCARTHY

Project Address 0 790340003 - MINOR SUBD SPLIT
 Municipality DENMARK TOWNSHIP

Inspection Type SOIL REVIEW For AAA POLLUTION DID SOILS

Special Instructions MINOR SUBDIVISION

Inspector P. Jones Date 11-16 Time 11:06

Corrections _____

1st lot split
 along Panama approval
 by Denmark Township
 Planning on Oct 17, 1994
 2nd lot from 110th St



SOIL REVIEW/SEPTIC PERMIT APPLICATION

Washington County Health, Environment & Land Management
14900 61st. Street N., P.O. Box 3803
Stillwater, MN. 55082-3803
612/430-6708 or 612/430-6656 FAX 612/430-6730

FEE _____

Make checks payable to WASHINGTON COUNTY TREASURER

FOR COUNTY USE ONLY

\$100 - Application Fee (site review) \$25 - Additional Review Fee (1 hour minimum)
\$100 - Drainsfield System Permit Fee \$100 base fee, plus \$50 per lot - Subdivision Fee
\$150 - Mound System Permit Fee

82-94080

Large Diagram or Plat Filed, Home Design Number: 79034-0003 0.267-91' of N 56.8-82' W 487.18' of NW 1/4 Sec 34 T27N R20W

Applicant: RICHARD McCARTHY, 3076 WOODBRIDGE, ROSEVILLE, 55115 Plat Gov 2015

Owner (if different from applicant): SAME

Use of Building: SFD Number of Bedrooms: 4 Gallons per Day: 600

Check the following fixture(s) which are or will be installed: Garbage Disposal POS Recreational Bath Facility

New System Approval Only Prev. Appr. Denied Exist. Syst. Repair Exist. System Alt. Fill Site

If site has been previously approved, please attach a copy of the approval letter

The following exhibits are required as part of this application and shall be attached hereto: Percolation Test Report; Soil Boring Logs; Site Plan drawn to scale showing location of buildings, lot lines, percolation test holes, soil boring holes, proposed location of system and well; two(2) copies of the System Design; and one (1) copy of the Final Building Plan. The house and the drainfield areas must be staked. Inaccurate or incomplete information will result in delays in processing.

AGREEMENT: The undersigned hereby makes Application for permit to install or extend Sewage Treatment System herein specified, agreeing that all such work shall be done in strict accordance with ordinances and regulations of the County of Washington, Minnesota. Applicant agrees that the Site Plan, Sketches and Design submitted herewith, and which are reviewed by the Washington County Building Official or his agent, together with any requirement and/or restriction made necessary by conditions peculiar to a particular location, shall become a part of the permit. Applicant further agrees to provide access, at reasonable times, to the Building Official or his agent for the purpose of performing inspections required and that no part of the system shall be covered until it has been inspected and accepted. APPLICATION IS FOR AN INSTALLATION AT A SPECIFIC LOCATION; ANY DEVIATION FROM THE APPROVED LOCATION WILL VOID THE PERMIT. It shall be the responsibility of the applicant for the permit to notify the Office of the Building Official that the installation is ready for inspection.

In connection with your request for a soil review/septic permit, you are hereby giving us permission to enter upon your property during normal business hours for the purpose of determining the suitability of the location, which may include minor excavation or soil borings.

Signature of Applicant (Owner or Builder) _____ Date _____

FOR OFFICE USE ONLY

REVIEWS: PLANNER _____ INSPECTOR Planner DATE 11-16

SITE EVALUATION:
Soil Boring Evaluation: Depth of Water Table, Seasonal Water Table (Mottled Soil), Impervious Layer or Bedrock:

Soil Map Data:	Percolation Test Evaluation:				
	Required (circle appropriate item(s))	Actual			
Well (including adjacent property)	30'	75'	100'	150'	
Wetland, Pond, Lake, Stream, River, or Bluffline	20'	40'	75'	100'	150'

CONCLUSIONS: Site Suitable: _____ Site Unsuitable: _____ Additional Tests Required: _____ Verify Use: _____

NOTES: Lot Size 9.00 acres Year Built _____
generally silt over sand or brick
approx 250' E of Pond silt over coarse sand

SOIL Boring Log Sheet

SOIL BORING LOG SHEET

Location: PANAMA & 110TH
 Date of Borings: 10/15/94
 Borings Made By: Jeff Childers - Certification # 2122

DEPTH IN FEET	Boring # Elevation:	B1	DEPTH IN FEET	Boring # Elevation:	B2
0			0		
1		BLACK LOAM TOP SOIL	1		TOP SOIL
2			2		
3		BROWN SILT TRACE SAND	3		BROWN SILT TRACE SAND
4			4		BROWN SAND TRACE SILT
5		BROWN SILTY SAND	5		
6			6		LIGHT BROWN SAND/ROCKS
7			7		BEDROCK
8		LIGHT BROWN SAND	8		

END OF BORING @ 8.00 FEET. END OF BORING @ 6.25 FEET.
 WATER TABLE OR MOTTLED SOIL- NO WATER TABLE OR MOTTLED SOIL- NO
 OBSERVATIONS AND COMMENTS: BORING MADE WITH BACKHOE.

SOIL BORING LOG SHEET

Location: PANAMA & 110TH

Date of Borings: 10/15/94

Boring Made By: Jeff Childers - Certification # 2122

DEPTH IN FEET	Boring #	B3	Elevation:	DEPTH IN FEET	Boring #	B4	Elevation:
0				0			
1		TOP SOIL		1		TOP SOIL	
2				2		BROWN SILTY SAND	
3		BROWN SAND & ROCK		3		BROWN SAND & ROCK	
4				4		SAND/BROKEN BDRCK	
5		BROKEN LIMESTONE & SAND		5		BEDROCK	
6		BEDROCK		6			
7				7			
8				8			

END OF BORING @ 5.50 FEET.

WATER TABLE OR MOTTLED SOIL- NO

OBSERVATIONS AND COMMENTS:

END OF BORING @ 5.25 FEET.

WATER TABLE OR MOTTLED SOIL- NO

BORINGS MADE WITH BACKHOE.

SOIL BORING LOG SHEET

Location: PANAMA & 110TH

Date of Borings: 10/15/94

Boring Made By: Jeff Childers - Certification # 2122

DEPTH IN FEET	Boring # Elevation:	DEPTH IN FEET	Boring # Elevation:
0	B5	0	
1	TOP SOIL	1	
2		2	
3	BROWN SILTY SAND	3	
4		4	
5	BROWN SAND/TRACE SILT	5	
6	SAND W/ROCKS	6	
7		7	
8	BROKEN BEDROCK	8	

END OF BORING @ 7.50 FEET.

WATER TABLE OR MOTTLED SOIL- NO

OBSERVATIONS AND COMMENTS- BORINGS MADE BACKHOE.

END OF BORING @ FEET.

WATER TABLE OR MOTTLED SOIL- NO



WASHINGTON COUNTY, MINNESOTA
Department of Health, Environment & Land Management

INSPECTION REQUEST DETAIL

date SEP 3 1995

DATE 8/30/95

Requested Date 8/31/95 Requested Time 1:00 Priority 91

Application Number 82 95038

Owner Name RICHARD/MARIJO MCCARTHY

Project Address 11055 PANAMA AVE S
Municipality DENMARK TOWNSHIP

Inspection Type SEPTIC For VALLEY ENTERPRISES

Special Instructions

Inspector *JK* Date _____ Time _____

Corrections *OK*
 pleant RI - OK
 Heat RI - OK, add from fiberial heat
 Signature *Russ onoutest walto*

INSPECTION RECORD

BUILDING	DATE	INSP.	COMMENTS
Foundation			
Foundation Wall			
Plumbing (Groundwork)			
Heating (Groundwork)			
Rough Plumbing			
Rough Gas Piping			
Rough Heating and Ventilation			
Framing			
Insulation			
Fireplace			
Chimney			
Wallboard or Lath and Plaster			
Final Electrical			
Final Plumbing			
Final Gas Piping			
Final Heating and Ventilation			
Final Building			

SEWAGE TREATMENT SYSTEM	DATE	INSP.	COMMENTS
Installation	8-31-95	X	Tank Size: 1000/1000 Treatment Area: 1200 sq-ft
As Built			Installer: Valley

DRIVEWAY	DATE	INSP.	COMMENTS
Access			
Installation			

NOTES: